

Accessories for vacuum technology

FESTO

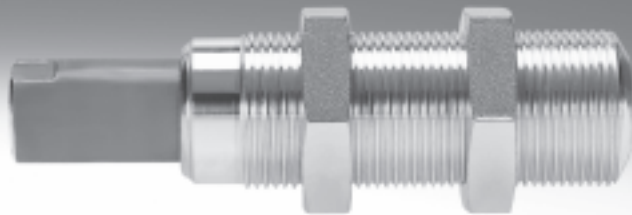

Accessories for vacuum technology

Technical data

Height compensator VAL

Temperature range
-10 ... +60 °C

Note

For suction cup VAS/VASB
→ Internet: vas



General technical data			
Size	5	10	20
Design	Vacuum port on top		
Operating medium	Atmospheric air based on ISO 8573-1:2010 [7:-:-]		
Mounting position	Any		
Type of mounting	Mounting on the male thread or via the female air connection thread of the housing		
Vacuum port	M5	G1/8	G1/4
Operating pressure [bar]	-0.95 ... 8		

Ambient conditions			
Size	5	10	20
Housing	Aluminium		
Seals	Nitrile rubber		
Note on material	Free of copper, PTFE and silicone		
Ambient temperature [°C]	-10 ... +60		

Gentle handling of the workpieces by compensating for any excess stroke of the handling device or tolerance differences in the workpiece thickness.

- 1 Vacuum generator
- 2 Distributor
- 4 Suction cup
- 5 Height compensator

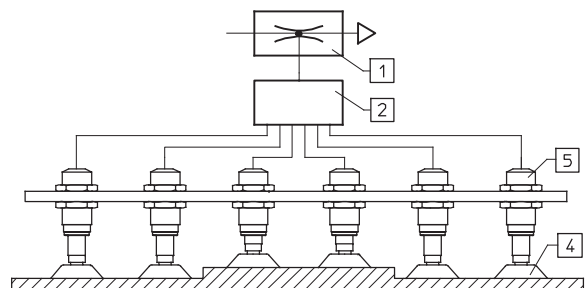

Accessories for vacuum technology

Technical data

Dimensions

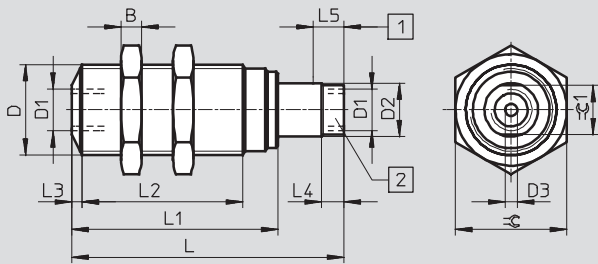

- 1 Spring travel for height compensator
- 2 Suction cup connector

Type	B	D	D1	D2 Ø	D3 Ø	L	L1	L2	L3	L4	L5	≡C	≡C 1
VAL-M5-5	5	M16x1	M5	8	2	46	35	25.5	2	4.5	5	19	7
VAL-1/8-10	6	M22x1.5	G1/8	13	3	66	50	39	2.5	5.5	10	27	12
VAL-1/4-20	8	M26x1.5	G1/4	17	4	100	73	60	2.5	6.5	20	32	16

Ordering data

Height compensator [mm]	Vacuum port	Part No.	Type
5	M5	151209	VAL-M5-5 ¹⁾
10	G1/8	151210	VAL-1/8-10 ¹⁾
20	G1/4	151211	VAL-1/4-20 ¹⁾

1) Free of copper, PTFE and silicone

Accessories for vacuum technology

Technical data

Angle compensator ESWA

Temperature range
0 ... +60 °C

Note on materials:
RoHS-compliant

Note

For suction gripper ESG, between suction cup and suction cup holder
→ Internet: esg



General technical data			
Holder size	3	4	5
Design	Ball joint with ± 15° swivel angle		
Operating medium	Atmospheric air based on ISO 8573-1:2010 [7:-:-]		
Mounting position	Any		
Type of mounting	With threaded connection		

Ambient conditions			
Holder size	3	4	5
Housing	Aluminium		
Seals	Nitrile rubber		
Ambient temperature [°C]	0 ... +60		
Corrosion resistance CRC ¹⁾	1		

1) Corrosion resistance class 1 according to Festo standard 940 070
Components requiring low corrosion resistance. Transport and storage protection. Parts that do not have primarily decorative surface requirements, e.g. in internal areas that are not visible or behind covers.

Weights [g]			
Holder size	3	4	5
ESWA- ...	9	19	57

Dimensions

Type	D1 Ø	D2	L1	L2
ESWA-3	15	M4x0.7	23	4
ESWA-4	20	M6x1	28.5	6
ESWA-5	28	M10x1.5	40.5	10

Ordering data		
Holder size	Part No.	Type
3	191205	ESWA-3
4	191206	ESWA-4
5	191207	ESWA-5

Product Range and Company Overview

A Complete Suite of Automation Services

Our experienced engineers provide complete support at every stage of your development process, including: conceptualization, analysis, engineering, design, assembly, documentation, validation, and production.



Custom Automation Components
Complete custom engineered solutions



Custom Control Cabinets
Comprehensive engineering support and on-site services



Complete Systems
Shipment, stocking and storage services

The Broadest Range of Automation Components

With a comprehensive line of more than 30,000 automation components, Festo is capable of solving the most complex automation requirements.



Electromechanical
Electromechanical actuators, motors, controllers & drives



Pneumatics
Pneumatic linear and rotary actuators, valves, and air supply



PLCs and I/O Devices
PLC's, operator interfaces, sensors and I/O devices

Supporting Advanced Automation... As No One Else Can!

Festo is a leading global manufacturer of pneumatic and electromechanical systems, components and controls for industrial automation, with more than 12,000 employees in 56 national headquarters serving more than 180 countries. For more than 80 years, Festo has continuously elevated the state of manufacturing with innovations and optimized motion control solutions that deliver higher performing, more profitable automated manufacturing and processing equipment. Our dedication to the advancement of automation extends beyond technology to the education and development of current and future automation and robotics designers with simulation tools, teaching programs, and on-site services.

Quality Assurance, ISO 9001 and ISO 14001 Certifications

Festo Corporation is committed to supply all Festo products and services that will meet or exceed our customers' requirements in product quality, delivery, customer service and satisfaction.

To meet this commitment, we strive to ensure a consistent, integrated, and systematic approach to management that will meet or exceed the requirements of the ISO 9001 standard for Quality Management and the ISO 14001 standard for Environmental Management.



© Copyright 2008, Festo Corporation. While every effort is made to ensure that all dimensions and specifications are correct, Festo cannot guarantee that publications are completely free of any error, in particular typing or printing errors. Accordingly, Festo cannot be held responsible for the same. For Liability and Warranty conditions, refer to our "Terms and Conditions of Sale", available from your local Festo office. All rights reserved. No part of this publication may be reproduced, distributed, or transmitted in any form or by any means, electronic, mechanical, photocopying or otherwise, without the prior written permission of Festo. All technical data subject to change according to technical update.



Printed on recycled paper at New Horizon Graphic, Inc., FSC certified as an environmentally friendly printing plant.

Festo North America

Festo Regional Contact Center

5300 Explorer Drive
Mississauga, Ontario L4W 5G4
Canada

USA Customers:

For ordering assistance,

Call: 1.800.99.FESTO (1.800.993.3786)

Fax: 1.800.96.FESTO (1.800.963.3786)

Email: customer.service@us.festo.com

For technical support,

Call: 1.866.GO.FESTO (1.866.463.3786)

Fax: 1.800.96.FESTO (1.800.963.3786)

Email: product.support@us.festo.com

Canadian Customers:

Call: 1.877.GO.FESTO (1.877.463.3786)

Fax: 1.877.FX.FESTO (1.877.393.3786)

Email: festo.canada@ca.festo.com

USA Headquarters

Festo Corporation
395 Moreland Road
P.O. Box 18023
Hauppauge, NY 11788, USA
www.festo.com/us

USA Sales Offices

Appleton

North 922 Tower View Drive, Suite N
Greenville, WI 54942, USA

Boston

120 Presidential Way, Suite 330
Woburn, MA 01801, USA

Chicago

1441 East Business Center Drive
Mt. Prospect, IL 60056, USA

Dallas

1825 Lakeway Drive, Suite 600
Lewisville, TX 75057, USA

Detroit – Automotive Engineering Center

2601 Cambridge Court, Suite 320
Auburn Hills, MI 48326, USA

New York

395 Moreland Road
Hauppauge, NY 11788, USA

Silicon Valley

4935 Southfront Road, Suite F
Livermore, CA 94550, USA

United States



USA Headquarters, East: Festo Corp., 395 Moreland Road, Hauppauge, NY 11788

Phone: 1.631.435.0800; Fax: 1.631.435.8026;

Email: info@festo-usa.com

www.festo.com/us

Canada



Headquarters: Festo Inc., 5300 Explorer Drive, Mississauga, Ontario L4W 5G4

Phone: 1.905.624.9000; Fax: 1.905.624.9001;

Email: festo.canada@ca.festo.com

www.festo.ca

Mexico



Headquarters: Festo Pneumatic, S.A., Av. Ceylán 3, Col. Tequesquahuac,
54020 Tlalneantla, Edo. de México

Phone: 011 52 [55] 53 21 66 00; Fax: 011 52 [55] 53 21 66 65;

Email: festo.mexico@mx.festo.com

www.festo.com/mx

Central USA

Festo Corporation
1441 East Business
Center Drive
Mt. Prospect, IL 60056, USA
Phone: 1.847.759.2600
Fax: 1.847.768.9480



Western USA

Festo Corporation
4935 Southfront Road,
Suite F
Livermore, CA 94550, USA
Phone: 1.925.371.1099
Fax: 1.925.245.1286



Festo Worldwide

Argentina Australia Austria Belarus Belgium Brazil Bulgaria Canada Chile China Colombia Croatia Czech Republic Denmark
Estonia Finland France Germany Great Britain Greece Hong Kong Hungary India Indonesia Iran Ireland Israel Italy Japan Latvia
Lithuania Malaysia Mexico Netherlands New Zealand Norway Peru Philippines Poland Romania Russia Serbia Singapore
Slovakia Slovenia South Africa South Korea Spain Sweden Switzerland Taiwan Thailand Turkey Ukraine United States Venezuela

www.festo.com