



- Permits easy adjustment
- Wide choice of mounting options

Adjusting units HMXY

Key features

FESTO

Key features at a glance

Mounting options

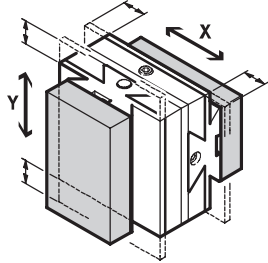

- Precision adjusting unit in X and Y directions
- Allows easy adjustment of grippers to obtain precise gripping position
- Versatile precision interfaces using centring sleeves
- Wide choice of mounting options:
 - Direct mounting
 - Dovetail mounting

Combination with drives and grippers

Mounting on the basic components → 5

Linear modules
HMP/HMPL



Mini slides
DGSL



Mini slides
SLT



Adapter kits

- Direct mounting
- Dovetail mounting

Adjusting unit HMXY

- Interface between basic component and attachment component

Adapter kits

- Direct mounting
- Dovetail mounting



Mounting the attachment component → 8



Mini slides
DGSL



Mini slides
SLT



Semi-rotary drives
DRQD



Grippers
HGD, HGDT, HGP, HGR, HGW
HGPP, HGPPi
Parallel grippers, micro
HGPM, HGWM

531.Adjusting units HMX

Technical data

FESTO

Adjusting unit



General technical data		HMX-1	HMX-3
Adjustment travel	y [mm]	7.5	7.5
	z [mm]	7.5	7.5
Max. static characteristic load values → Fig. 1	Forces		
	F_x [N]	50	160
	F_z [N]	50	160
	Torques		
	M_x [Nm]	1.4	20
	M_y [Nm]	1.4	20
Mass moment of inertia → Fig. 2	J_x [kgm ² ×10 ⁻⁴]	0.499	8.650
	J_y [kgm ² ×10 ⁻⁴]	0.361	5.121
	J_z [kgm ² ×10 ⁻⁴]	0.361	5.121
Weights	[g]	155	2,324
Ambient temperature	[°C]	5 ... 60	
Corrosion resistance class CRC ¹⁾		2	
Materials		Anodised aluminium	
Note on materials		Free of copper, PTFE and silicone	

1) Corrosion resistance class 2 to Festo standard 940 070

Components subject to moderate corrosion stress. Externally visible parts with primarily decorative surface requirements which are in direct contact with a normal industrial environment or media such as coolants or lubricating agents.

Max. permissible static characteristic load values

Fig. 1

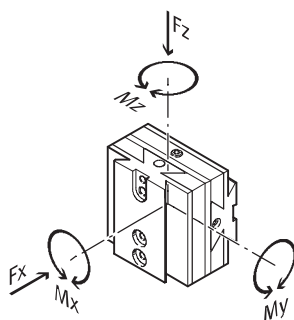

Mass moments of inertia

Fig. 2

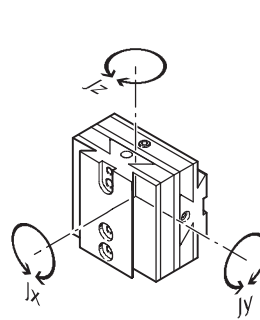

532.Adjusting units HMX

Technical data

FESTO

Dimensions

Download CAD data → www.festo.com

HMX-1

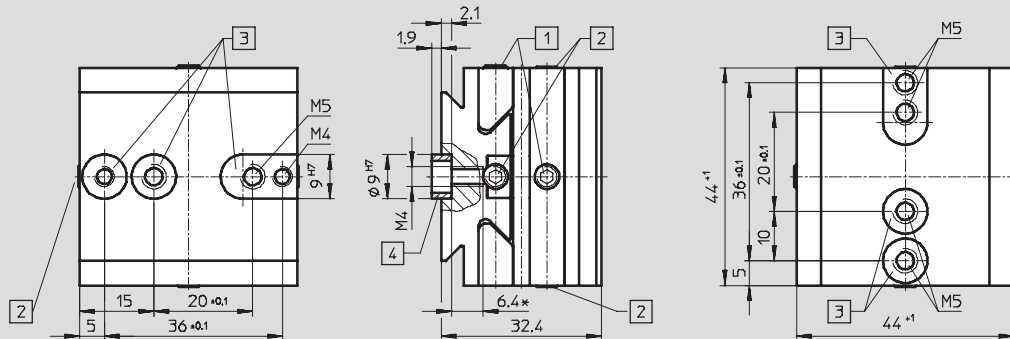

- 1 Locking screw
- 2 Adjusting screw

- 3 Centring hole/slot
- 4 For centring sleeve ZBH-9
(2 pieces included in scope of delivery)

* For M4 and M5 threads

HMX-3

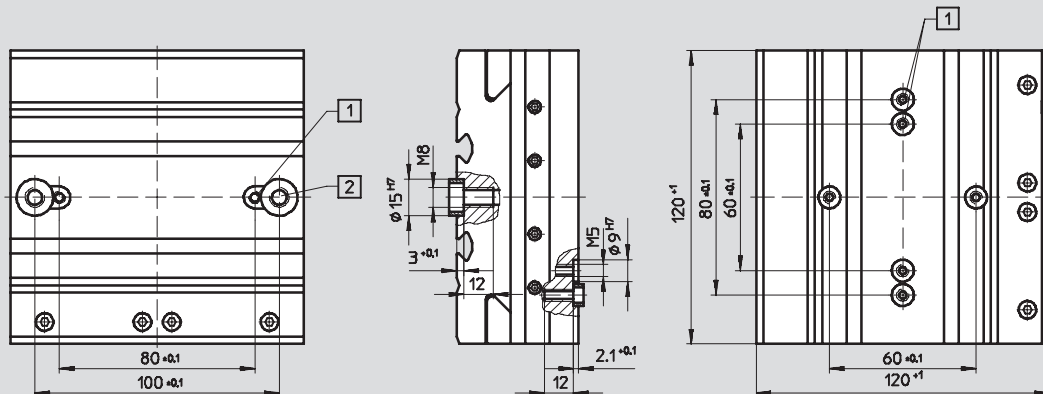

- 1 For centring sleeve ZBH-9
(2 pieces included in scope of delivery)

- 2 For centring sleeve ZBH-15
(2 pieces included in scope of delivery)

Ordering data

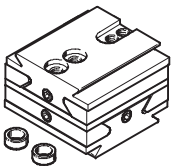
	Part No.	Type
	187 582	HMX-1
	526 030	HMX-3

533.Adjusting units HMXY

FESTO

Technical data – Mounting on the basic component

Mounting on linear module HMP/HMPL

Material:

Adapter kit HMSV: Wrought aluminium alloy

Free of copper, PTFE and silicone

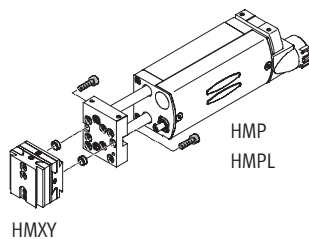

Direct mounting

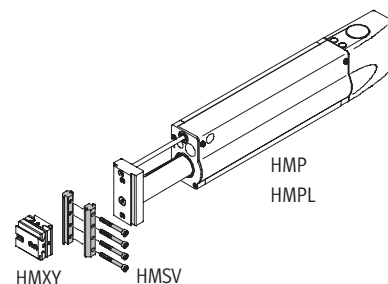

Dovetail mounting

Dimensions and ordering data

Download CAD data → www.festo.com

Direct mounting

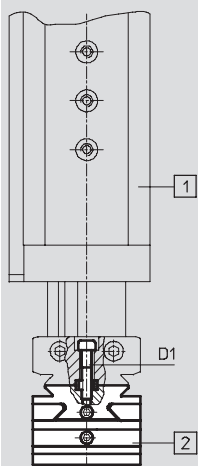

- 1 Linear module HMP/HMPL
- 2 Adjusting unit HMXY

Basic component	Adjusting unit	Screws ¹⁾
HMP-16/20	HMXY-3	D1
HMP-25/32		2x M5x25
		2x M5x30
HMPL-12/16/20	HMXY-1	2x M5x16

1) The screws listed are not included with the adjusting unit.

534.Adjusting units HMX

Technical data – Mounting on the basic component

FESTO

Mounting on linear module HMP/HMPL

Dimensions and ordering data

Download CAD data → www.festo.com

Dovetail mounting

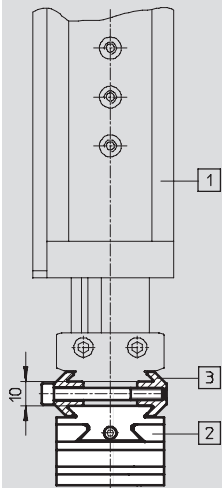

- 1 Linear module HMP
- 2 Adjusting unit HMX
- 3 Adapter kit HMSV

Basic component	Adjusting unit	Part No.	Type
HMP-16/20/25/32	HMX-1	177 647	HMSV-1
HMP-16/20/25/32	HMX-3	177 649	HMSV-3

535.Adjusting units HMXY

Technical data – Mounting on the basic component

FESTO

Mounting on mini slide SLT

Material:

Adapter kit HAPG: Wrought aluminium alloy

Free of copper, PTFE and silicone

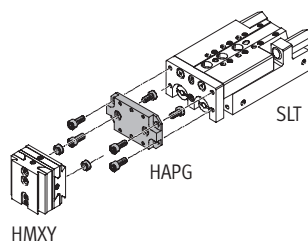

Direct mounting

Dimensions and ordering data

Download CAD data → www.festo.com

Direct mounting

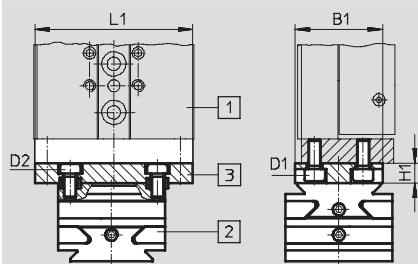

- 1 Mini slide SLT
- 2 Adjusting unit HMXY
- 3 Adapter kit HAPG

Basic component	Adjusting unit	B1	H1	L1	Screws D1	Screws D2	Part No.	Type
SLT-16	HMXY-1	36	8	65	M5x10	M5x12	191 266	HAPG-48
SLT-20		44	10	80	M5x12	M5x14	191 268	HAPG-50
SLT-25	HMXY-1/3	44	12	91	M6x16	M5x14	191 270	HAPG-52

536.Adjusting units HMXY

Technical data – Mounting the attachment components

FESTO

Mounting on mini slide DGSL

Material:

Adapter kit HMSV:

Wrought aluminium alloy

Free of copper, PTFE and silicone

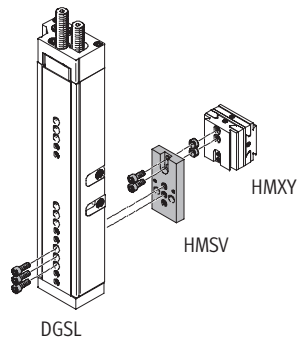

Direct mounting

Dimensions and ordering data

Download CAD data → www.festo.com

Direct mounting

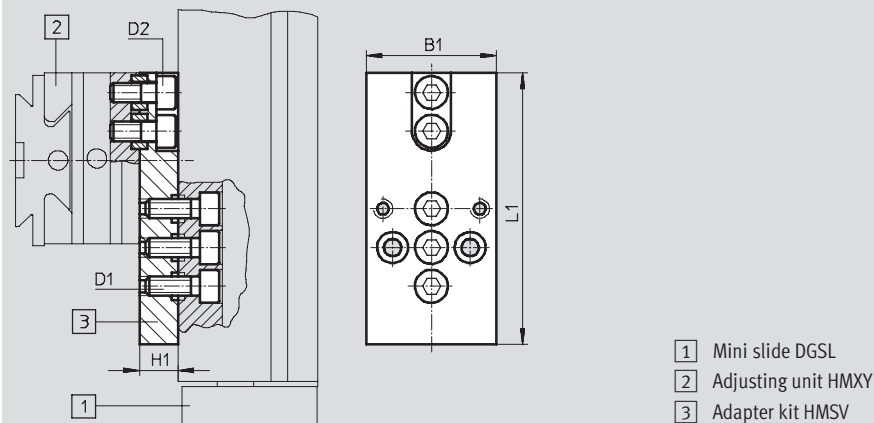

Attachment component	Adjusting unit	B1	D1	D2	H1	L1	Part No.	Type
DGSL-4/6	HMXY-1	33.6	M3	M5	10	87	548 787	HMSV-57
DGSL-8/10	HMXY-1	33.6	M4	M5	10	87		
DGSL-12/16	HMXY-1	33.6	M5	M5	10	70	548 782	HMSV-52
DGSL-20/25	HMXY-3	40	M6	M5	10	100	548 929	HMSV-60

537.Adjusting units HMX

Technical data – Mounting the attachment component

FESTO

Mounting on mini slide SLT

Material:

Adapter kit HMSV: Wrought aluminium alloy

Free of copper, PTFE and silicone

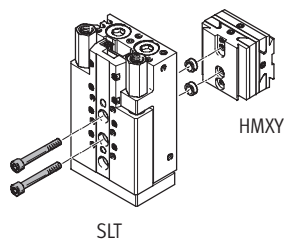

SLT

Direct mounting

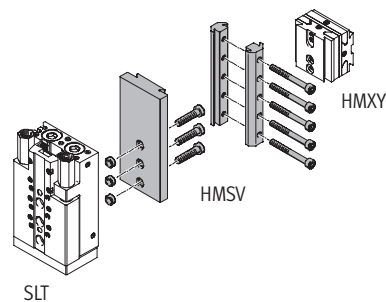

SLT

Dovetail mounting

Dimensions and ordering data

Download CAD data → www.festo.com

Direct mounting

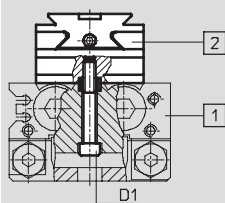

- 1 Mini slide SLT
- 2 Adjusting unit HMX

Attachment component	Adjusting unit	Screws ¹⁾
SLT-16	HMX-1	D1 2x M5x38

1) The screws listed are not included with the adjusting unit.

Dovetail mounting

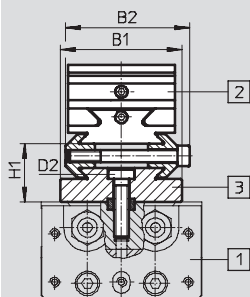

- 1 Mini slide SLT
- 2 Adjusting unit HMX
- 3 Adapter kit HMSV

Attachment component	Adjusting unit	B1	B2	H1	Screws D2	Part No.	Type
SLT-6	HMX-1/3	40	51	22	M3x20	178 329	HMSV-34
SLT-10		40	51	22	M4x30	178 330	HMSV-35
SLT-16		50	51	24	M6x25	178 331	HMSV-36
SLT-20		80	51	26	M6x25	178 332	HMSV-37
SLT-25	HMX-3	80	51	26	M8x25		

538.Adjusting units HMXY

Technical data – Mounting the attachment component

FESTO

Mounting on semi-rotary drive DRQD

Material:

Adapter kit HAPG, HMSV:

Wrought aluminium alloy

Free of copper, PTFE and silicone

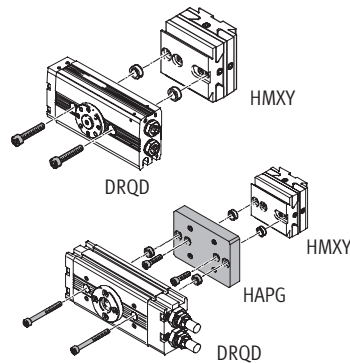

Direct mounting

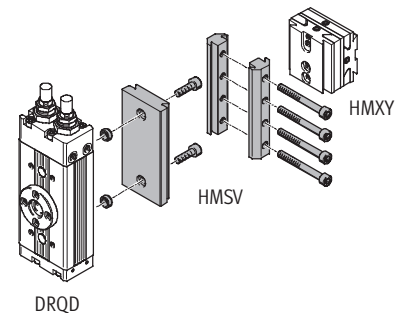

Dovetail mounting

Dimensions and ordering data

Download CAD data → www.festo.com

Direct mounting

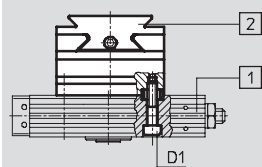

- 1 Semi-rotary drive DRQD
- 2 Adjusting unit HMXY

Attachment component	Adjusting unit	Screws ¹⁾ D1	Part No.	Type
DRQD-8	HMXY-1	2x M4x20	—	
DRQD-12		2x M4x25	—	
DRQD-B-16/20		—	192 707	HAPG-38
DRQD-B-32	HMXY-3	2x M5x55	—	
DRQD-40		2x M8x75 ²⁾	—	
DRQD-50		2x M8x90 ³⁾	—	

1) The screws listed are not included with the adjusting unit.

2) The terminal length should be 60 mm.

3) The terminal length should be 75 mm.

Dovetail mounting

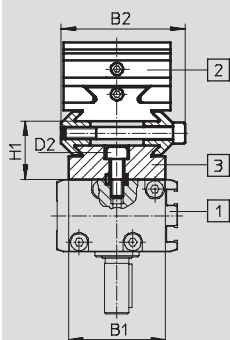

- 1 Semi-rotary drive DRQD
- 2 Adjusting unit HMXY
- 3 Adapter kit HMSV

Attachment component	Adjusting unit	B1	B2	H1	Screws D2	Part No.	Type
DRQD-B-16/20	HMXY-1/3	40	51	22	M5x16	177 656	HMSV-10
DRQD-B-25	HMXY-3	50	51	24	M5x10	177 657	HMSV-11
						177 649	HMSV-3
DRQD-B-32						177 663	HMSV-17
						177 653	HMSV-7

539.Adjusting units HMX

FESTO

Technical data – Mounting the attachment component

Mounting on gripper HGD/HGP/HGR/HGW

Material:

Adapter kit HAPG:

Wrought aluminium alloy

Free of copper, PTFE and silicone

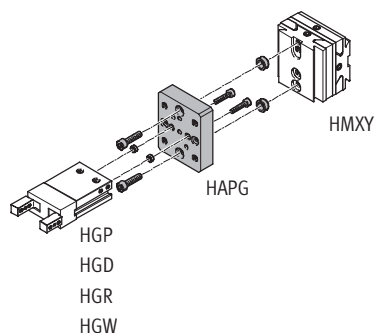

Direct mounting

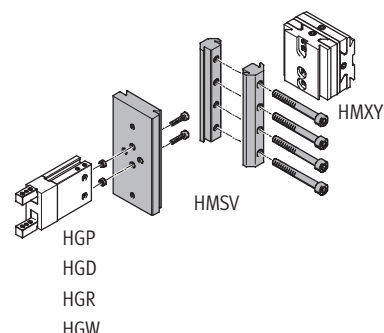

Dovetail mounting

Dimensions and ordering data

Download CAD data → www.festo.com

Direct mounting

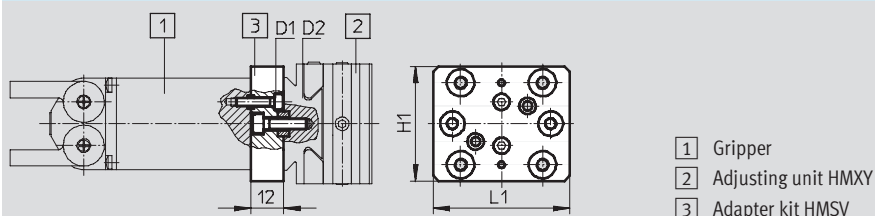

Attachment component	Adjusting unit	H1	L1	Screws D1	Screws D2	Part No.	Type
HGP-6, HGR-10, HGW-10	HMX-1	42	50	M3x14	M4x16	192 706	HAPG-37-S1
HGD-16		42	50	M3x20	M4x16	193 921	HAPG-36-S3
HGP-10, HGR-16, HGW-16		42	50	M3x14	M4x16	192 705	HAPG-36-S1
HGP-16, HGR-25, HGW-25		42	50	M4x14	M4x16	193 922	HAPG-37-S4

540.Adjusting units HMXY

Technical data – Mounting the attachment component

FESTO

Mounting on gripper HGD/HGP/HGR/HGW

Dimensions and ordering data

Download CAD data → www.festo.com

Dovetail mounting

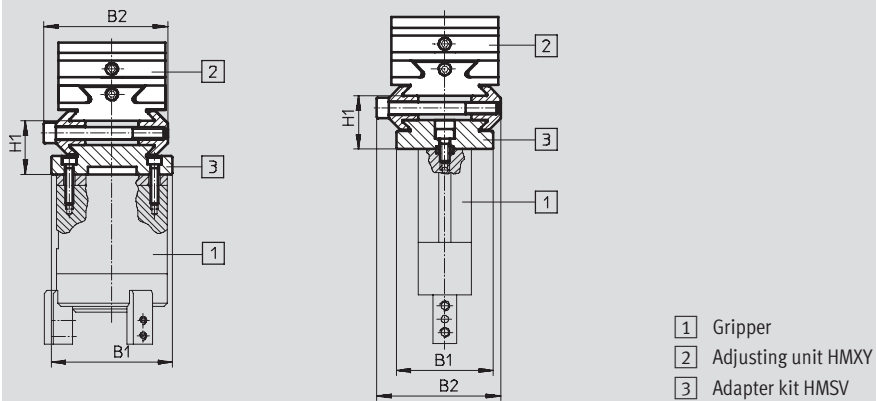

Attachment component	Adjusting unit	B1	B2	H1	Part No.	Type
HGP-10, HGR-16, HGW-16	HMXY-1/3	40	51	22	177 767	HMSV-27
HGP-16, HGR-25, HGW-25					177 768	HMSV-28
HGP-25, HGR-32, HGW-32	HMXY-1/3	50	51	24	177 769	HMSV-29
HGD-32	HMXY-3	50	51	22	178 212	HMSV-32
HGP-35, HGR-40, HGW-40	HMXY-3	60	51	28	177 770	HMSV-30
HGD-50	HMXY-3	70	51	24	178 213	HMSV-33

541.Adjusting units HMXY

Technical data – Mounting the attachment component

FESTO

Mounting on parallel gripper HGPP

Material:

Adapter kit HAVB, HMSV, HAPG:

Wrought aluminium alloy

Free of copper, PTFE and silicone

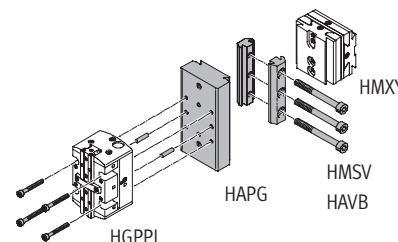

Dovetail mounting

Dimensions and ordering data

Download CAD data → www.festo.com

Dovetail mounting

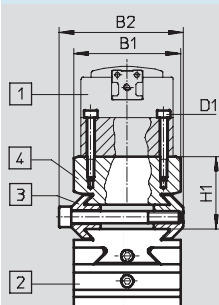

- 1 Parallel gripper HGPP
- 2 Adjusting unit HMXY
- 3 Adapter kit HMSV; HAVB
- 4 Adapter kit HAPG

Attachment component	Adjusting unit	B1	B2	H1	Screws D1	Part No.	Type	Part No.	Type
HGPP-12	HMXY-1	44	51	27.5	M5x30	163 239	HAVB-3	191 262	HAPG-44
	HMXY-3	44	51	30	M5x30	177 649	HMSV-3	191 262	HAPG-44
HGPP-16	HMXY-1	44	51	27.5	M5x30	163 239	HAVB-3	191 263	HAPG-45
	HMXY-3	44	51	30	M5x30	177 649	HMSV-3	191 263	HAPG-45
HGPP-20	HMXY-1	50	51	19.5	M5x30	163 239	HAVB-3	191 265	HAPG-47
	HMXY-3	50	51	22	M5x30	177 649	HMSV-3	191 265	HAPG-47
HGPP-25	HMXY-1	60	51	25.5	M5x40	163 239	HAVB-3	529 019	HAPG-59
	HMXY-3	60	51	28	M5x40	177 649	HMSV-3	529 019	HAPG-59
HGPP-32	HMXY-3	60	51	28	M5x50	177 653	HMSV-7	529 020	HAPG-61

542.Adjusting units HMXY

Technical data – Mounting the attachment component

FESTO

Mounting on three-point gripper HGDT

Material:

Adapter kit HAPG:

Wrought aluminium alloy

Free of copper, PTFE and silicone

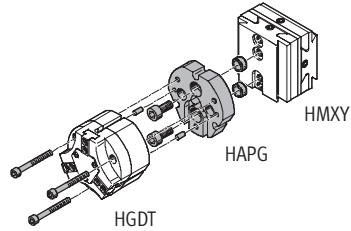

Direct mounting

Dimensions and ordering data

Download CAD data → www.festo.com

Direct mounting

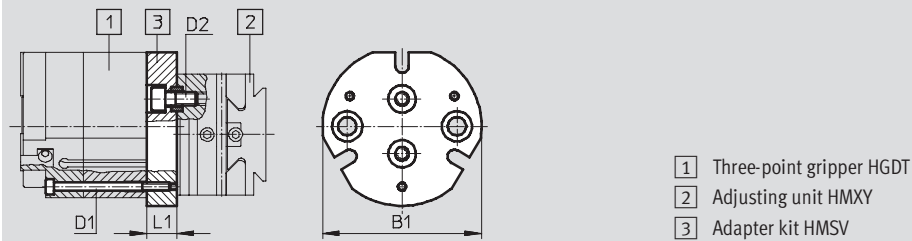

Attachment component	Adjusting unit	B1	D1	D2	L1	Part No.	Type
HGDT-25	HMXY-1	48	M3	M5	10	542 439	HAPG-SD2-32
HGDT-32		58	M3	M5	11	542 436	HAPG-94

Product Range and Company Overview

A Complete Suite of Automation Services

Our experienced engineers provide complete support at every stage of your development process, including: conceptualization, analysis, engineering, design, assembly, documentation, validation, and production.



Custom Automation Components
Complete custom engineered solutions



Custom Control Cabinets
Comprehensive engineering support and on-site services



Complete Systems
Shipment, stocking and storage services

The Broadest Range of Automation Components

With a comprehensive line of more than 30,000 automation components, Festo is capable of solving the most complex automation requirements.



Electromechanical
Electromechanical actuators, motors, controllers & drives



Pneumatics
Pneumatic linear and rotary actuators, valves, and air supply



PLCs and I/O Devices
PLC's, operator interfaces, sensors and I/O devices

Supporting Advanced Automation... As No One Else Can!

Festo is a leading global manufacturer of pneumatic and electromechanical systems, components and controls for industrial automation, with more than 12,000 employees in 56 national headquarters serving more than 180 countries. For more than 80 years, Festo has continuously elevated the state of manufacturing with innovations and optimized motion control solutions that deliver higher performing, more profitable automated manufacturing and processing equipment. Our dedication to the advancement of automation extends beyond technology to the education and development of current and future automation and robotics designers with simulation tools, teaching programs, and on-site services.

Quality Assurance, ISO 9001 and ISO 14001 Certifications

Festo Corporation is committed to supply all Festo products and services that will meet or exceed our customers' requirements in product quality, delivery, customer service and satisfaction.

To meet this commitment, we strive to ensure a consistent, integrated, and systematic approach to management that will meet or exceed the requirements of the ISO 9001 standard for Quality Management and the ISO 14001 standard for Environmental Management.



© Copyright 2008, Festo Corporation. While every effort is made to ensure that all dimensions and specifications are correct, Festo cannot guarantee that publications are completely free of any error, in particular typing or printing errors. Accordingly, Festo cannot be held responsible for the same. For Liability and Warranty conditions, refer to our "Terms and Conditions of Sale", available from your local Festo office. All rights reserved. No part of this publication may be reproduced, distributed, or transmitted in any form or by any means, electronic, mechanical, photocopying or otherwise, without the prior written permission of Festo. All technical data subject to change according to technical update.



Printed on recycled paper at New Horizon Graphic, Inc., FSC certified as an environmentally friendly printing plant.

Festo North America

Festo Regional Contact Center

5300 Explorer Drive
Mississauga, Ontario L4W 5G4
Canada

USA Customers:

For ordering assistance,

Call: 1.800.99.FESTO (1.800.993.3786)

Fax: 1.800.96.FESTO (1.800.963.3786)

Email: customer.service@us.festo.com

For technical support,

Call: 1.866.GO.FESTO (1.866.463.3786)

Fax: 1.800.96.FESTO (1.800.963.3786)

Email: product.support@us.festo.com

Canadian Customers:

Call: 1.877.GO.FESTO (1.877.463.3786)

Fax: 1.877.FX.FESTO (1.877.393.3786)

Email: festo.canada@ca.festo.com

USA Headquarters

Festo Corporation
395 Moreland Road
P.O. Box 18023
Hauppauge, NY 11788, USA
www.festo.com/us

USA Sales Offices

Appleton

North 922 Tower View Drive, Suite N
Greenville, WI 54942, USA

Boston

120 Presidential Way, Suite 330
Woburn, MA 01801, USA

Chicago

1441 East Business Center Drive
Mt. Prospect, IL 60056, USA

Dallas

1825 Lakeway Drive, Suite 600
Lewisville, TX 75057, USA

Detroit – Automotive Engineering Center

2601 Cambridge Court, Suite 320
Auburn Hills, MI 48326, USA

New York

395 Moreland Road
Hauppauge, NY 11788, USA

Silicon Valley

4935 Southfront Road, Suite F
Livermore, CA 94550, USA

United States



USA Headquarters, East: Festo Corp., 395 Moreland Road, Hauppauge, NY 11788

Phone: 1.631.435.0800; Fax: 1.631.435.8026;

Email: info@festo-usa.com

www.festo.com/us

Canada



Headquarters: Festo Inc., 5300 Explorer Drive, Mississauga, Ontario L4W 5G4

Phone: 1.905.624.9000; Fax: 1.905.624.9001;

Email: festo.canada@ca.festo.com

www.festo.ca

Mexico



Headquarters: Festo Pneumatic, S.A., Av. Ceylán 3, Col. Tequesquahuac,
54020 Tlalneapantla, Edo. de México

Phone: 011 52 [55] 53 21 66 00; Fax: 011 52 [55] 53 21 66 65;

Email: festo.mexico@mx.festo.com

www.festo.com/mx

Central USA

Festo Corporation
1441 East Business
Center Drive
Mt. Prospect, IL 60056, USA
Phone: 1.847.759.2600
Fax: 1.847.768.9480



Western USA

Festo Corporation
4935 Southfront Road,
Suite F
Livermore, CA 94550, USA
Phone: 1.925.371.1099
Fax: 1.925.245.1286



Festo Worldwide

Argentina Australia Austria Belarus Belgium Brazil Bulgaria Canada Chile China Colombia Croatia Czech Republic Denmark
Estonia Finland France Germany Great Britain Greece Hong Kong Hungary India Indonesia Iran Ireland Israel Italy Japan Latvia
Lithuania Malaysia Mexico Netherlands New Zealand Norway Peru Philippines Poland Romania Russia Serbia Singapore
Slovakia Slovenia South Africa South Korea Spain Sweden Switzerland Taiwan Thailand Turkey Ukraine United States Venezuela

www.festo.com