

Common supply manifold
PAL-3/8-3-B
Part number: 30693

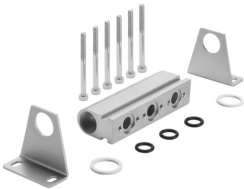

Data sheet

Feature	Value
Mounting position	Any
Max. no. of valve positions	3
LABS (PWIS) conformity	VDMA24364-B1/B2-L
Product weight	610 g
Type of mounting	With mounting bracket
Pneumatic connection 1	G3/4
Note on materials	RoHS-compliant
Material of sub-base	Aluminum Anodized