

Protective conduit

**FESTO**

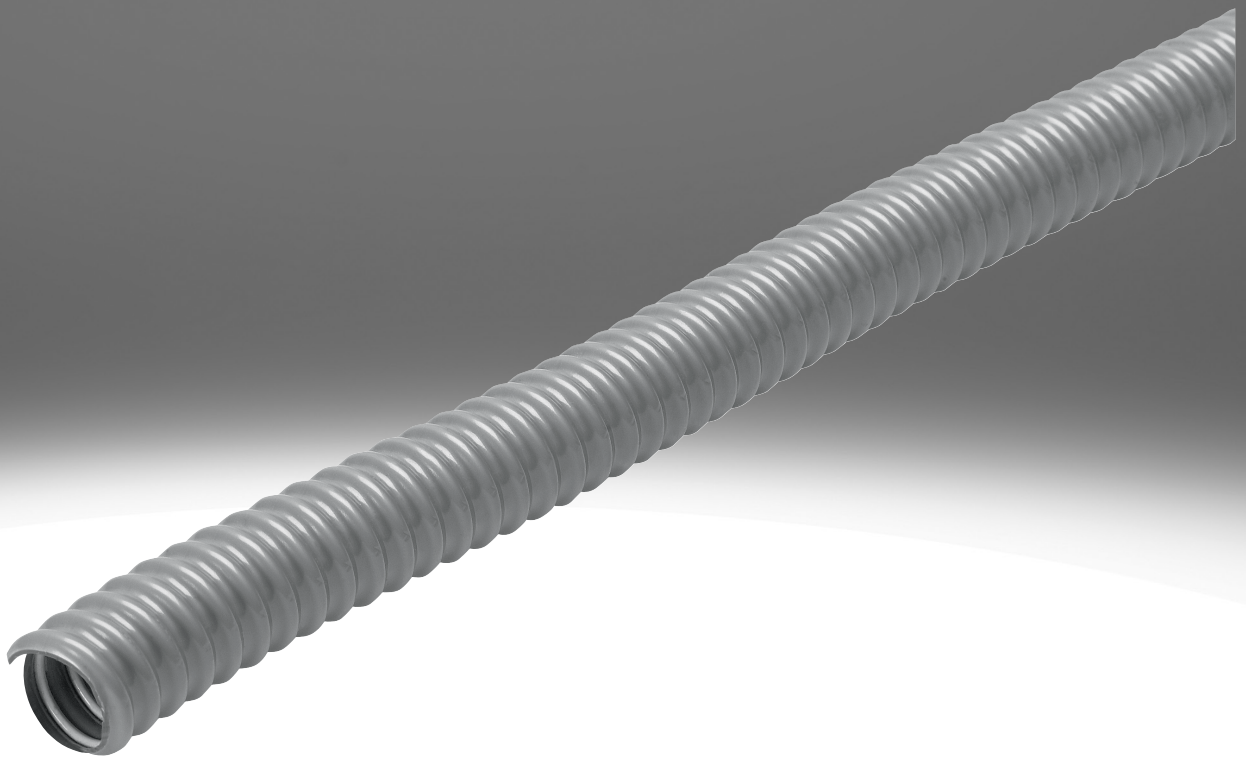

### Characteristics

#### At a glance

Our protective conduit systems for pneumatic tubing consist of protective conduits and tube fittings. Protective conduits are flexible pipes made of metal or polymer and are used to protect pneumatic tubing and electrical cables on machines and installations. It is recommended that suitable fittings be used for optimum use of the protective conduits.

#### Series

##### [MKV] Protective conduit PVC

- Flexible
- Can be stretched and compressed
- Waterproof
- Largely oil and acid resistant
- Suitable for protective conduit fitting MKVV
- Polyvinyl chloride, spring steel

##### [MKG] Protective conduit, two-piece

- Inner and outer tubing can be separated from each other
- Polypropylene

##### [MKR] Protective conduit PA

- Flexible
- For protecting electrical cables and pneumatic tubing
- Suitable for protective conduit fitting MKRV/MKRL
- Polyamide

##### [MK] Metal protective conduit

- Extremely flexible
- High tensile strength
- Can withstand lateral pressure
- Can be used up to 220 °C
- Galvanised steel

## Type code

001	Series
<b>MK</b>	Metal protective conduit
<b>MKG</b>	Protective conduit, two-piece
<b>MKR</b>	Protective conduit PA
<b>MKV</b>	Protective conduit PVC

002	Inside tubing diameter
<b>4</b>	4 mm
<b>6</b>	6 mm
<b>10</b>	10 mm
<b>12</b>	12 mm
<b>16,5</b>	16.5 mm
<b>23</b>	23 mm
<b>29</b>	29 mm
<b>36</b>	36 mm

003	Connection size
<b>9</b>	9
<b>11</b>	11
<b>13,5</b>	13.5
<b>16</b>	16
<b>21</b>	21
<b>29</b>	29
<b>36</b>	36
<b>48</b>	48

004	Generation
<b>B</b>	Second generation

Datasheet

Technical data – Protective conduit				
Short type code	MK	MKG	MKR	MKV
Mounting position	–	optional		
Ambient temperature	–	-20 ... 100°C	–	
Corrosion resistance class CRC <sup>1)</sup>	–	2 - Moderate corrosion stress		
Material conduit	–	PP	–	
Note on materials	–	RoHS-compliant	–	RoHS-compliant
LABS (PWIS) conformity	VDMA24364-B1/B2-L	VDMA24364-B2-L		VDMA24364-B1/B2-L

1) More information: [www.festo.com/x/topic/crc](http://www.festo.com/x/topic/crc)

## Ordering data

Ordering data – MK (flexible metal conduit, spiral-wound)			
	LABS (PWIS) conformity	Part no.	Type
	VDMA24364-B1/B2-L	2203	MK-4
		2204	MK-6

Ordering data – MKV (suitable for protective conduit fitting MKVV)				
	Corrosion resistance class CRC <sup>1)</sup>	LABS (PWIS) conformity	Part no.	Type
	2 - Moderate corrosion stress	VDMA24364-B1/B2-L	7148	MKV-PG-48
			7550	MKV-PG-29
			7404	MKV-PG-13,5
			7147	MKV-PG-36
			7549	MKV-PG-21

1) More information: [www.festo.com/x/topic/crc](http://www.festo.com/x/topic/crc)

Ordering data – MKR (suitable for protective conduit fitting MKRV/MKRL)				
	Corrosion resistance class CRC <sup>1)</sup>	LABS (PWIS) conformity	Part no.	Type
	2 - Moderate corrosion stress	VDMA24364-B2-L	177564	MKR-10-PG-9
			177566	MKR-16,5-PG-16
			177565	MKR-12-PG-11
			177567	MKR-23-PG-21
			177568	MKR-29-PG-29

1) More information: [www.festo.com/x/topic/crc](http://www.festo.com/x/topic/crc)

Ordering data – MKG (inner and outer tubing can be separated)				
	Corrosion resistance class CRC <sup>1)</sup>	LABS (PWIS) conformity	Part no.	Type
	2 - Moderate corrosion stress	VDMA24364-B2-L	3156319	MKG-36-PG-29
			3156318	MKG-23-PG-29-B

1) More information: [www.festo.com/x/topic/crc](http://www.festo.com/x/topic/crc)