

Proximity sensors SMT-10M, for C-slot

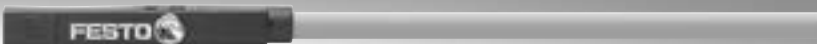

★/☆	Festo core product range Covers 80% of your automation tasks	★ Generally ready for dispatch from the factory within 24 hours In stock at 13 Service Centres worldwide More than 2200 products
Worldwide:	Always in stock	☆ Generally ready for dispatch from the factory within 5 days
Superb:	Festo quality at an attractive price	Assembled for you at 4 Service Centres worldwide
Easy:	Simplified procurement and warehousing	Up to 6×10^{12} variants per product family

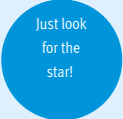

Product range overview

Design	Type of mounting	Measuring principle	Type	Operating voltage range	Switching output	Switching element function	→ Page/ Internet
For C-slot	Standard						
	Inserted in the slot from above, flush with the cylinder profile	Magneto-resistive	SMT-10M	5 ... 30 V DC	PNP	N/O contact	6
					NPN		
					Non-contacting, 2-wire		
		Magnetic reed	SME-10M	5 ... 30 V AC/DC	Contacting, bipolar	N/O contact	–
	Inserted in the slot lengthwise	Magneto-resistive	SMT-10G	10 ... 30 V DC	PNP, NPN	N/O contact	–
Magnetic reed		SME-10	12 ... 27 V AC/DC	Contacting	N/O contact	–	
For T-slot	Standard						
	Inserted in the slot from above, flush with the cylinder profile	Magneto-resistive	SMT-8M	10 ... 30 V DC	PNP	N/O contact	T-slot
					N/C contact		
		NPN	N/O contact				
		Magnetic reed	SME-8M	5 ... 30 V AC/DC	Contacting, bipolar	N/O contact	
	N/C contact						
	Inserted in the slot lengthwise, flush with the cylinder profile	Magneto-resistive	SMT-8	10 ... 30 V DC	PNP	N/O contact	
					NPN		
	Inserted in the slot lengthwise, flush with the cylinder profile	Magnetic reed	SME-8	12 ... 30 V AC/DC	Contacting, bipolar	N/O contact	
						N/C contact	
						3 ... 230 V AC/DC	
						5 ... 250 V AC/DC	
	Inserted in the slot lengthwise	Magneto-resistive	SMT-8G	10 ... 30 V DC	PNP	N/O contact	
		Magneto-resistive	SMT-8-SL	10 ... 30 V DC	PNP	N/O contact	
		Magnetic reed	SME-8-SL	10 ... 30 V AC/DC	Contacting, bipolar	N/O contact	
	Via accessories	Magneto-resistive	SMT0-8E	10 ... 30 V DC	PNP	N/O contact	
					NPN		
		Magnetic reed	SME0-8E	12 ... 30 V DC	Contacting, bipolar	N/O contact	
				3 ... 250 V DC			
	3 ... 230 V AC						
	Corrosion-resistant						
	Inserted in the slot lengthwise, flush with the cylinder profile	Magneto-resistive	CRSMT-8	10 ... 30 V DC	PNP	N/O contact	T-slot
	Welding field immune						
	Via accessories	Magneto-inductive	SMTSO-8E	10 ... 30 V DC	PNP	N/O contact	T-slot
					NPN		
	Heat resistant up to 120°C						
	Inserted in the slot lengthwise, flush with the cylinder profile	Magnetic reed	SME-8-...S6	0 ... 30 V AC/DC	Contacting, bipolar	N/O contact	T-slot
	Via accessories	Magnetic reed	SME0-8E-...S6	0 ... 30 V DC	Contacting	N/O contact	T-slot
				0 ... 30 V AC			

Product range overview

T-slot sensors can be used for drives with T-slot

Exceptions

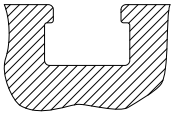

- DFM-B: SMT0-8E, SMTSO-8E, SME0-8E, SMP0-8E cannot be used
- DHDS: SME-8M can only be used on $\varnothing 50$
- DHPS: SME-8M can only be used on $\varnothing 20 \dots 35$
- HGDD-63-A: SMT-8M-A cannot be used
- HGPT-B: only SMT-8G can be used for size 40 and upwards
- SDBT-BSW- ... -PU/NU can only be used on a limited number of drive series

C-slot sensors can be used for drives with C-slot

Exceptions

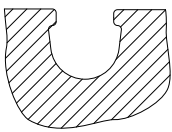

- ADVC $\varnothing 100$: SMT-10M and SME-10M cannot be used (ADVC has a T-slot and a C-slot)
- DSM/DSM-B-6/8/10: SME-10M cannot be used
- DSM/DSM-B-10/16: SMT-10M cannot be used
- HGPT-B: only SMT-10G can be used for sizes up to and including size 35

For drives with sensor rail: these are available with 2 cylinder barrel contours

Only T-slot sensors CRSMT-8M and SMT-8M-A can be used, and only with the suitable profile identified below.

Example: DSBF

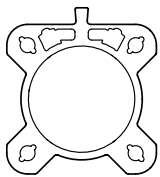

Suitable

Example: CDC

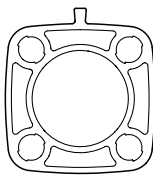

Not suitable

Peripherals overview

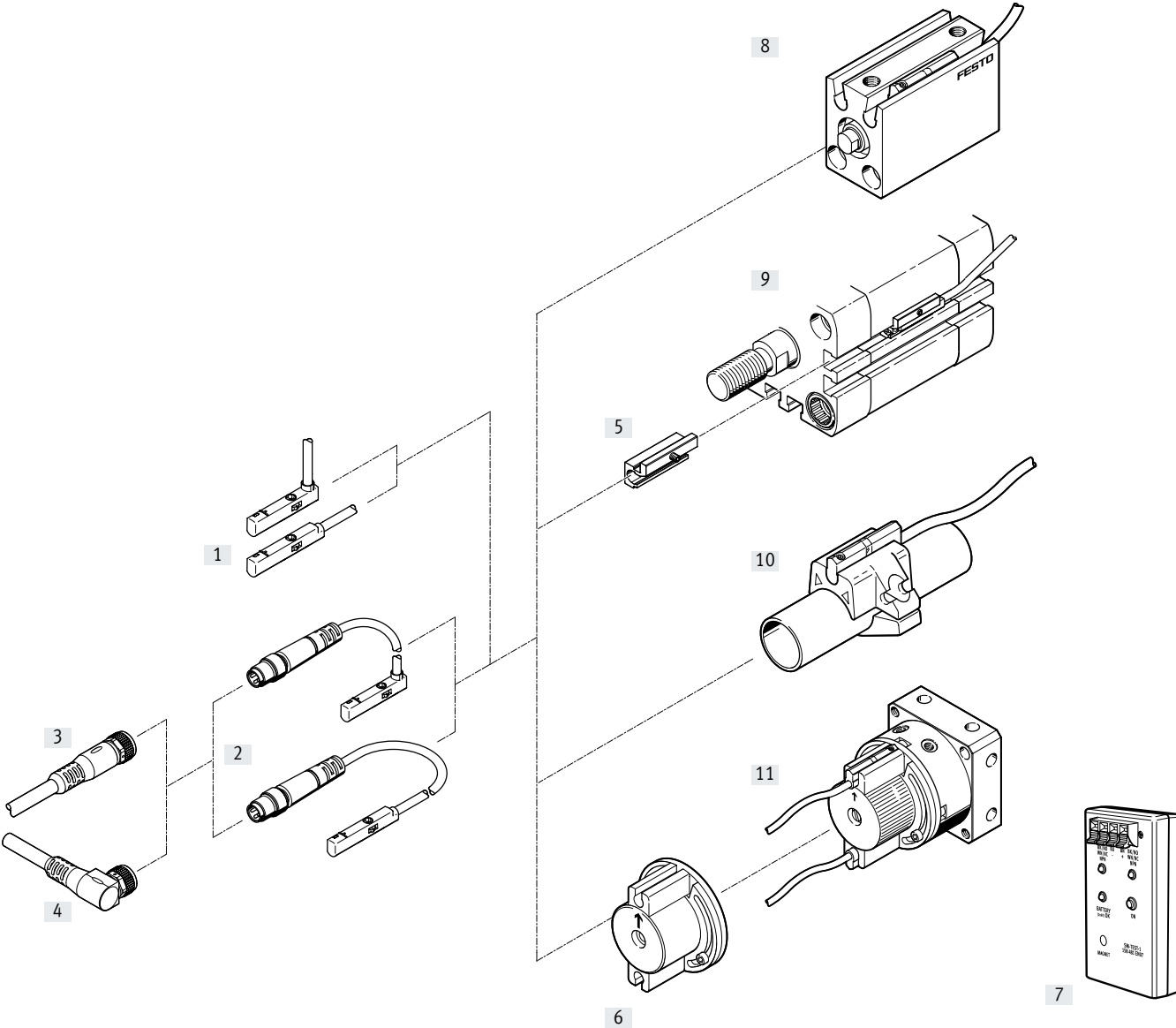

Mounting attachments and accessories		→ Page/ Internet
Proximity sensors		
[1]	SMT-10M-...-OE, with cable	6
[2]	SMT-10M-...-M..., with cable and plug	6
Connecting cables		
[3]	Connecting cable NEBU-M...G...	13
[4]	Connecting cable NEBU-M...W...	13
Mounting kits		
[5]	Mounting kit SMBN-10	12
[6]	Mounting kit WSM-...SME-10	13

Mounting attachments and accessories		→ Page/ Internet
Accessories		
[7]	Sensor tester SM-TEST-1	13
-	Positioning element SMM-10	12
-	Clip SMBK-10	13
-	Inscription label ASLR	13
-	Safety clip NEAU	13
Drives		
[8]	Drives with C-slot	-
[9]	Drives with T-slot	-
[10]	Round cylinder	-
[11]	Semi-rotary drive DSM	-

Type codes

001	Series	
SMT	Proximity sensor	

002	Design type	
10M	For C-slot, inserted in slot from above	

003	Switching output	
NS	3-wire NPN N/O contact	
PS	3-wire PNP N/O contact	
ZS	2-wire PNP N/O contact	

004	Rated operating voltage	
24V	24 V	

005	Cable characteristic	
E	Suitable for energy chains/robot applications	

006	Cable length [m]	
0.2	0.2	
0.3	0.3	
2.5	2.5	
30	30	

007	Display	
L	LED	

008	Cable outlet	
L	Longitudinal	
Q	Transverse	

009	Cable identification	
	With label holder	
N	Without label holder	

010	Connection technology	
OE	Open end	
M8	M8, snap-on flange	
M8D	M8, rotatable thread	
M12	M12, rotatable thread	

Data sheet – Magneto-resistive

Function

e.g. PNP, N/O contact, with cable



e.g. NPN, N/O contact, with cable

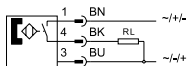

- Magneto-resistive measuring principle
- Inserted in the slot from above, does not protrude beyond the cylinder profile
- Cable clip and retaining bracket for inscription labels holders included in the scope of delivery



General technical data

Design	For C-slot
Conforms to standard	EN 60947-5-2
Certification	RCM compliance mark c UL us - Listed (OL)
KC mark	KC EMC
CE mark (see declaration of conformity)	To EU EMC Directive ¹⁾ To EU RoHS Directive
Special characteristics	Oil resistant
Note on materials	Cable free of halogen Free of copper and PTFE RoHS-compliant

¹⁾ For information about the area of use, see the EC declaration of conformity at: www.festo.com/sp → Certificates.

If the devices are subject to usage restrictions in residential, commercial or light-industrial environments, further measures for the reduction of the emitted interference may be necessary.

Input signal/measuring element	PS	NS	ZS
Measured variable	Position		
Measuring principle	Magneto-resistive		
Ambient temperature [°C]	−40 ... +70		
Fused switching field strength			
at −40 ... +70°C [mT]	1.6 ... 3.0		1.95 ... 2.6
at 25°C [mT]	1.8 ... 2.8		2.0 ... 2.5

Switching output	PS	NS	ZS
Type SMT-10M	PNP	NPN	Non-contacting, 2-wire
Switching output	N/O contact		
Switching element function	N/O contact		
Switching output repetition accuracy in ± mm	0.2		
Switch-on time [ms]	≤ 1.3	≤ 1.3	≤ 1.0
Switch-off time [ms]	≤ 1.4	≤ 1.4	≤ 1.0
Max. switching frequency [Hz]	150		
Max. output current [mA]	100		
Max. output current in mounting kits [mA]	50		
Max. switching capacity DC [W]	2.8	2.8	2.4
Max. switching capacity DC in mounting kits [W]	1.5		1.2
Voltage drop [V]	≤ 1.7	≤ 1.5	≤ 6
Devices can be switched in parallel	5	3	5
Minimum load current [mA]	0		
Residual current (in new condition at room temperature) [mA]	< 0.05	< 0.15	< 1.5

Data sheet – Magneto-resistive

Additional output data									
Short circuit current rating		Yes							
Overload protection		Present							
Electronics									
		PS/NS				ZS			
Rated operating voltage		[V DC]	24						
Operating voltage range		[V DC]	5 ... 30						
Ready-state delay		[ms]	< 45				< 17.2		
Reverse polarity protection		For all electrical connections							
Electromechanical components									
Type SMT-10M		PS/NS				ZS			
Electrical connection		OE	M8D	M8	M12	OE	M8D	M8	M12
Electrical connection		Cable, 3-wire	Cable with plug, 3-pin			Cable, 2-wire	Cable with plug, 2-pin		
			M8x1	M8x1	M12x1		M8x1	M8x1	M12x1
			Rotatable thread	Snap-on flange	Rotatable thread		Rotatable thread	Snap-on flange	Rotatable thread
Outlet direction of connection		In-line Lateral							
Cable test conditions		Energy chain: 5 million cycles, bending radius 28 mm							
		Torsional resistance: 300,000 cycles, ±270°/0.1 m							
		Resistance to bending: to Festo standard; test conditions on request							
Cable length		[m]	0.2 ... 30						
Cable characteristic		Energy chain + robot							
Information on materials: Cable sheath		TPE-U(PUR)							
Mechanical system									
Type of mounting		Screw-clamped, inserted in the slot from above							
Max. tightening torque		[Nm]	0.4						
Mounting position		Any							
Housing		PA-reinforced							
		High-alloy stainless steel							
Display/operation									
Switching status indication		Yellow LED							
Immission/emission									
Ambient temperature with flexible cable installation		[°C]	−20 ... +70						
Degree of protection		IP65							
		IP68							

Data sheet – Magneto-resistive

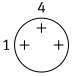
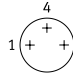
Pin allocation to EN 60947-5-2 M8x1, 2-pin N/O contact				Pin allocation to EN 60947-5-2 M8x1, 3-pin N/O contact			
	Pin	Wire colour	Allocation		Pin	Wire colour	Allocation
	1	Brown	+		1	Brown	+
	4	Black	Output		3	Blue	-
					4	Black	Output

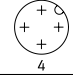
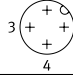
Pin allocation to EN 60947-5-2 M12x1, 2-pin N/O contact				Pin allocation to EN 60947-5-2 M12x1, 3-pin N/O contact			
	Pin	Wire colour	Allocation		Pin	Wire colour	Allocation
	1	Brown	+		1	Brown	+
	4	Black	Output		3	Blue	-
					4	Black	Output

Dimensions

Download CAD data → www.festo.com

SMT-10M-...-L, in-line connection direction

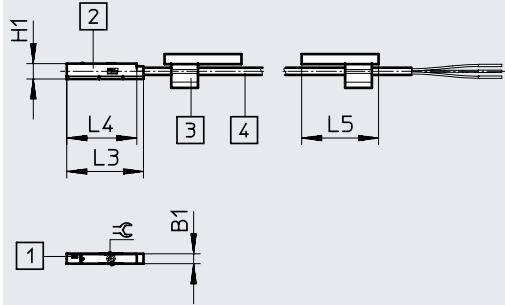

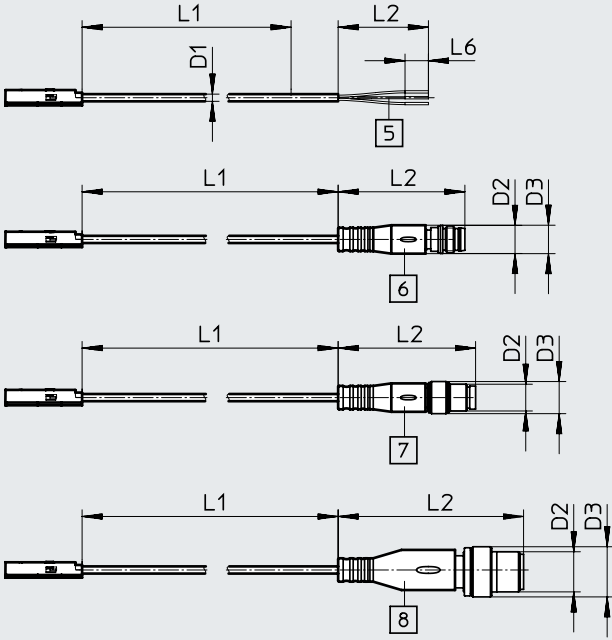

[1] Yellow LED

[2] SMT-10M

[3] Inscription label holder

[4] Connecting cable

[5] Cable with open end

[6] Plug M8x1, snap-on flange

[7] Plug M8x1, rotatable thread

[8] Plug M12x1

L1 Cable length

Type	B1	D1	D2	D3	H1	L2	L3	L4	L5	L6	L7	⌀
SMT-10M-...-OE	2.9	2.15	-	-	4.6	50	22.9	20.9	23	50	7	1.5
SMT-10M-...-M8D			M8x1	8.5		32.7					-	
SMT-10M-...-M8			M8x1	9.6		41.1					-	
SMT-10M-...-M12			M12x1	15		55.5					-	

Data sheet – Magneto-resistive

Dimensions

Download CAD data → www.festo.com

SMT-10M-...-Q, lateral connection direction

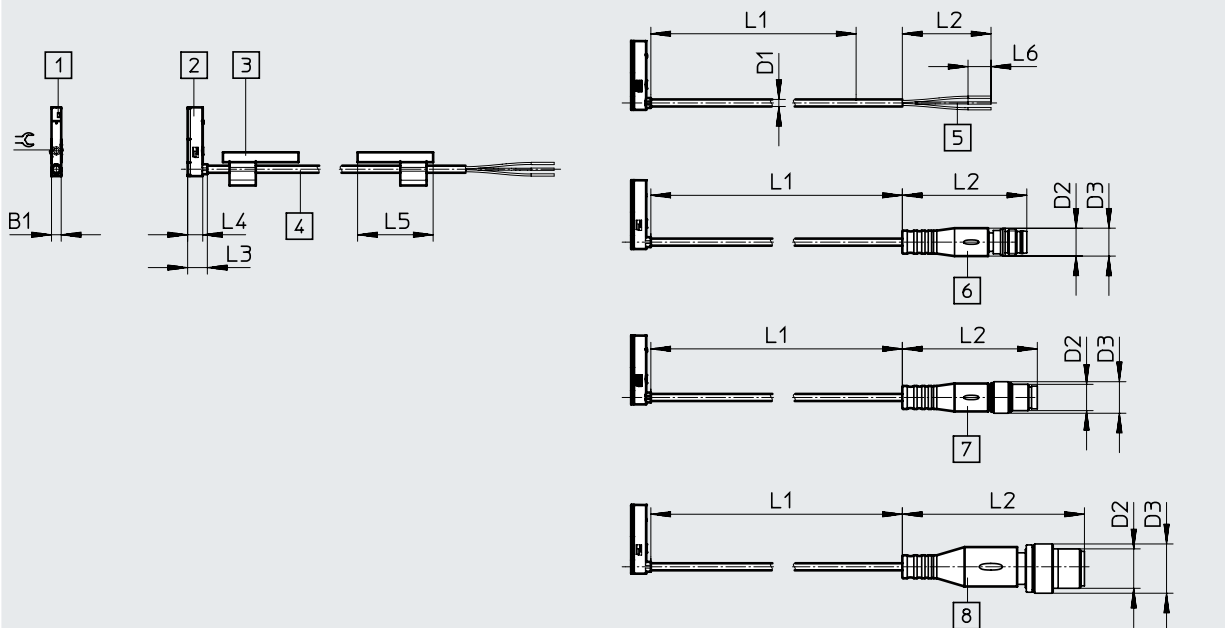

- [1] Yellow LED
 [2] SMT-10M
 [3] Inscription label holder
 [4] Connecting cable
 [5] Cable with open end
 [6] Plug M8x1, snap-on flange
 [7] Plug M8x1, rotatable thread
 [8] Plug M12x1
 L1 Cable length

Type	B1	D1	D2	D3	H1	L2	L3	L4	L5	L6	L7	±
SMT-10M-...-OE	2.9	2.15	–	–	20.9	50	6	4.6	23	50	7	1.5
SMT-10M-...-M8D			M8x1	8.5		32.7					–	
SMT-10M-...-M8			M8x1	9.6		41.1					–	
SMT-10M-...-M12			M12x1	15		55.5					–	

★ Core product range

Ordering data

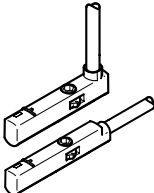
Ordering data	Switching output	Electrical connection		Cable length [m]	Weight [g]	Part no.	Type
		Cable	Cable with plug, rotatable thread				
	N/O contact						
	PNP	3-wire	–	2.5	16.8	★ 551373	SMT-10M-PS-24V-E-2,5-L-OE
		–	M8x1, 3-pin	0.3	6.7	★ 551375	SMT-10M-PS-24V-E-0,3-L-M8D
	NPN	3-wire	–	2.5	16.8	★ 551377	SMT-10M-NS-24V-E-2,5-L-OE
		–	M8x1, 3-pin	0.3	6.7	★ 551379	SMT-10M-NS-24V-E-0,3-L-M8D
	Non-contacting, 2-wire	2-wire	–	2.5	14.6	★ 551382	SMT-10M-ZS-24V-E-2,5-L-OE

Festo core product range



Generally ready for dispatch from the factory within 24 hours

Generally ready for dispatch from the factory within 5 days

Data sheet – Magneto-resistive

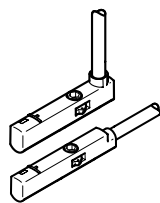
Ordering data	Switching output	Electrical connection		Cable length [m]	Weight [g]	Part no.	Type
		Cable	Cable with plug, rotatable thread				
	N/O contact						
	PNP	3-wire	–	2.5	16.8	551374	SMT-10M-PS-24V-E-2,5-Q-OE
		–	M8x1, 3-pin	0.3	6.7	551376	SMT-10M-PS-24V-E-0,3-Q-M8D
	NPN	3-wire	–	2.5	16.8	551378	SMT-10M-NS-24V-E-2,5-Q-OE
		–	M8x1, 3-pin	0.3	6.7	551380	SMT-10M-NS-24V-E-0,3-Q-M8D
	Non-contacting, 2-wire	2-wire	–	2.5	14.6	551383	SMT-10M-ZS-24V-E-2,5-Q-OE

Modular products – Magneto-resistive

Ordering table				
Size	10	Conditions	Code	Enter code
Module no.	551372			
Function	Proximity sensor for C-slot, non-contacting		SMT-10M	SMT-10M
			–	–
Switching output	3-wire PNP N/O contact		PS	
	3-wire NPN N/O contact		NS	
	2-wire N/O contact		ZS	
			–	–
Rated operating voltage [V DC]	24		24V	24V
			–	–
Cable characteristic	Energy chain + robot		E	E
			–	–
Cable length [m]	0.2 ... 30 (0.2 ... 5.0 m in 0.1 m increments, 5.0 ... 30 m in 0.5 m increments)		...	
			–	–
Cable outlet	In-line		L	
	Lateral		Q	
			–	–
Cable designation	With inscription label holder		–	
	Without inscription label holder		N	
			–	–
Connection technology	Open end		OE	
	M8, rotatable thread		M8D	
	M8, snap-on flange		M8	
	M12, rotatable thread		M12	

Accessories

Mounting SMBN-10

For mounting proximity sensors
SME/SMT-10 on drives with T-slot

Material:

Rail: Anodised wrought aluminium alloy

Screws: High-alloy stainless steel

Note on materials:

Free of copper and PTFE

RoHS-compliant

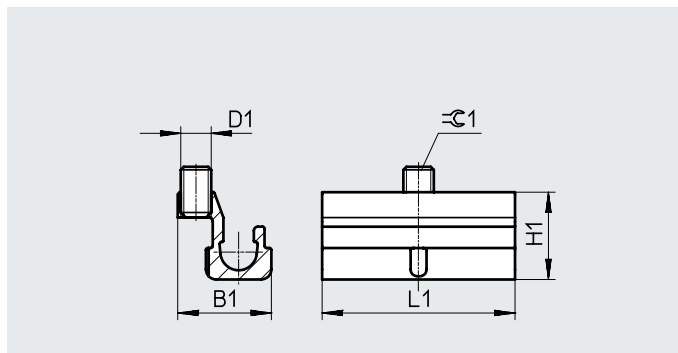

Dimensions and ordering data

For piston Ø	D1	B1	H1	L1	⌀1	Part no.	Type
125 ... 320	M3	9.3	8.6	19	1.5	537809	SMBN-10

Positioning element SMM

Inserted in the slot lengthwise

Ambient temperature: -40 ... +120°C

Materials:

Housing: Anodised wrought aluminium alloy

Screws: High-alloy stainless steel

Note on materials:

RoHS-compliant

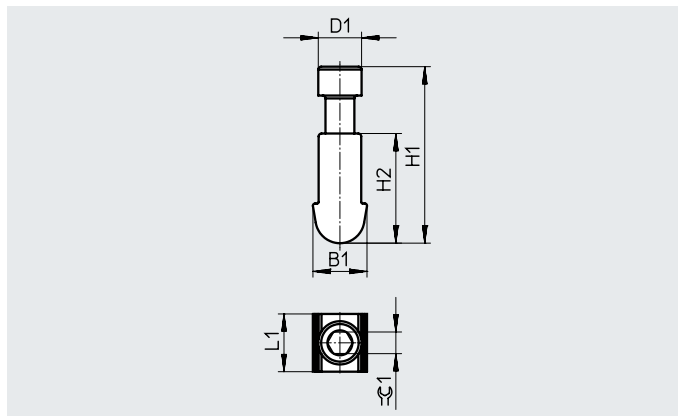

Dimensions and ordering data

B1	D1	H1	H2	L1	⌀1	CRC ¹⁾	Part no.	Type	PU ²⁾
3.75	3.0	12.23	7.6	4.0	1.5	3	547942	SMM-10	10

1) Corrosion resistance class CRC 3 to Festo standard FN 940070



High corrosion stress. Outdoor exposure under moderate corrosive conditions. Externally visible parts with primarily functional surface requirements which are in direct contact with a normal industrial environment.

2) Packaging unit



Accessories

Ordering data – Connecting cables

Data sheets → Internet: nebu

	Type	Number of wires	Cable length [m]	Part no.	Type
Socket M8x1, 3-pin					
	For SMT/SME-10...	3	2.5	★ 541333	NEBU-M8G3-K-2.5-LE3
			5	★ 541334	NEBU-M8G3-K-5-LE3
	For SMT/SME-10...	3	2.5	★ 541338	NEBU-M8W3-K-2.5-LE3
			5	★ 541341	NEBU-M8W3-K-5-LE3

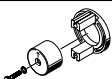
Ordering data – Mounting components

	For Ø	Description	Part no.	Type
	6	Mounting kit for mounting proximity sensors on semi-rotary drive DSM	173205	WSM-6-SME-10
	8		173206	WSM-8-SME-10
	10		173207	WSM-10-SME-10
	–	For fixing connecting cables in place	534255	SMBK-10

Ordering data – Safety clips for ATEX zone

	Size	Description	Part no.	Type	PU ¹⁾
	M8	<ul style="list-style-type: none"> Protects "equipment that is not intrinsically safe" in zones 2 and 22 against simple disconnection ATEX category: gas: II 3G / dust: II 3D 	548067	NEAU-M8-GD	1
	M12		548068	NEAU-M12-GD	1

1) Packaging unit

Ordering data – Sensor testers

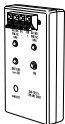
	Description	Part no.	Type
	<ul style="list-style-type: none"> Testing the functionality of proximity sensors using the integrated voltage supply Adjusting the proximity sensors on the cylinder 	158481	SM-TEST-1

Ordering data – Inscription labels

	Size	Part no.	Type	PU ¹⁾
	23x4 mm	541598	ASLR-L-423	34

1) Packaging unit

Festo core product range



Generally ready for dispatch from the factory within 24 hours

Generally ready for dispatch from the factory within 5 days