

Plastic tubing, standard I.D.

FESTO



Plastic tubing, standard I.D.

Product range overview and type codes

FESTO

Product range overview											
Version	Type	I.D.	Colour			Operating medium			Resistance	Shore hardness ²⁾	→ Page/ Internet
			Blue	Black	Natural	Compressed air	Vacuum	Water (not drinking water)	Hydrolysis		
	PU	9	-	■	-	■	-	-	+	A 93 ±3	3
	TPE-U(PU) ¹⁾	13.1					■				
	PCN	4	-	-	■	■	■	■		A 76 ±3	4
	PVC										
	P	6, 9	■	-	-	■	■	■		A 68 ±5	5
	NBR										
	P	13, 19	-	■						A 71 ±5	5
	EPDM, SBR										

- 1) Fibre-reinforced
 2) Values are determined using test boards. Values determined using tubing may vary.
 + Limited suitability (on request)
 - Not suitable

Type codes						
		PCN	—	4	—	NT
Material						
PU	TPE-U(PU)					
PCN	PVC					
P	NBR (I.D. 6/9 mm)					
	EPDM, SBR (I.D. 13/19 mm)					
I.D. [mm]						
Colour						
SW	Black					
BL	Blue					
NT	Natural					

Method of measurement

Flow-relevant bending radius R_d

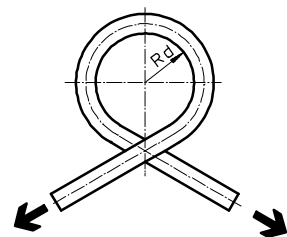

The tube is bent in the direction of its own curve until the tubing outer diameter is flattened by 5%. R_d is then calculated mathematically. The flow rate is not reduced until R_d is reached.

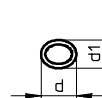

Cross section flattened by bending the tube.

d = non-deformed tubing O.D.

$d1$ = deformed tubing O.D.

Minimum bending radius R_{min}

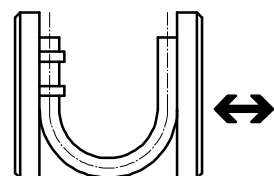

The tube fixed to the base plate is bent until the deformation results in a kink. The measured value is the minimum bending radius R_{min} . This R_{min} results in significant reductions in flow rate.

Plastic tubing PU

Technical data

FESTO

Plastic tubing PU

Highly flexible fibre-reinforced plastic tubing distinguished by its great resistance to abrasion and to kinks.



Operating and environmental conditions		
Type	PU-9	PU-13
Operating pressure for entire temperature range [bar]	0 ... +10	-0.95 ... +10
Operating medium	Compressed air to ISO 8573-1:2010 [7:-:-]	
Note on operating/pilot medium	Lubricated operation possible	
Ambient temperature [°C]	-35 ... +60	

Possible fittings



Quick connector CK

→ Internet: ck

Materials	
Shore hardness	A 93 ±3
Tube	TPE-U(PU)
Note on materials	RoHS-compliant
	Free of copper and PTFE

Dimensions and ordering data						
O.D.	I.D.	Flow-relevant bending radius	Weight	Colour	Part No.	Type
[mm]	[mm]	[mm]	[kg/m]			PU ¹⁾
11.6	9	76	0.056	Black	12134	PU-9-SW 50
18	13.1	83	0.133	Black	12133	PU-13-SW 50

1) Packaging unit

- 1 - Type discontinued
Available up until 2017

Plastic tubing PCN

Technical data

FESTO

Plastic tubing PCN

For draining condensate in service
units series D and MS



Operating and environmental conditions						
Operating pressure for entire temperature range		[bar]	−0.5 ... +0.25			
Ambient temperature		[°C]	−10 ... +60			
Materials						
Shore hardness		A 76 ±3				
Tube		PVC				
Note on materials		RoHS-compliant				
Dimensions and ordering data						
O.D. [mm]	I.D. [mm]	Weight [kg/m]	Colour	Part No.	Type	PU ¹⁾ [m]
6.5	4	0.025	Natural	7134	PCN-4-NT	50

1) Packaging unit

- 2 - Type discontinued
Available up until 2017

FESTO

Rubber tubing P

Technical data

Rubber tubing P, with fibre reinforcement

Highly flexible tubing with fibre reinforcement for barbed hose fitting N-...-P and hose clip SK



Operating and environmental conditions		
Operating pressure for entire temperature range	[bar]	-0.95 ... +16
Operating medium		Compressed air to ISO 8573-1:2010 [7:-:-]
Ambient temperature	[°C]	-20 ... +80

Materials				
Type	P-6	P-9	P-13	P-19
Shore hardness	A 68 ±5		A 71 ±5	
Tube	NBR		EPDM, SBR	
Note on materials	RoHS-compliant			
	Free of copper and PTFE			

Dimensions and ordering data								
O.D.	I.D.	Min. bending radius	Flow-relevant bending radius	Weight	Colour	Part No.	Type	PU ¹⁾
[mm]	[mm]	[mm]	[mm]	[kg/m]				[m]
13	6	20	45	0.144	Blue	2231	P-6-BL	40
16	9	30	60	0.186	Blue	2232	P-9-BL	40
23	13	50	100	0.40	Black	2234	P-13-SW	40
31	19	60	200	0.649	Black	2235	P-19-SW	40

1) Packaging unit