

## Push-in fittings NPQP

**FESTO**



## Push-in fittings NPQP

Features

**FESTO**

### Application



Effortless selection of the right fitting. Quick Star offers a secure solution for every connection. The convenient push-in fitting system includes well over 1000 types of standard and function fittings.

Overview of tubing/fitting combination			
Applications	Fitting	Tubing	Description
Economical	QS-B	PEN	The universal combination at an attractive price. The high resistance of PEN tubing makes it suitable for use in a wide variety of applications. Easy to install thanks to optimised bending radii. Limited reset effect.
	NPQM	PEN	Attractively priced: the universal solution for metal fittings. Perfect for standard pneumatic applications – in many different fields.
Wide range of variants	QS	PUN	Over 1000 types for maximum flexibility in standard applications.
Resistant to hydrolysis	QS	PUN-H	For applications in damp environments or in contact with water at up to 60 °C. PUN-H – microbe-resistant thanks to modified plastic.
Resistant to pressure	QS	PAN	Secure connection when used with pressure ranges of up to 14 bar. Economical for pneumatic installations in the high-pressure range.
	QS-F	PAN-R	The powerful combination for applications involving pressure ranges up to 16 bar: for example, for applications with the pressure booster DPA.
Resistant to heat	QS-F	PFAN	For reliable compressed air supply in elevated temperature ranges. Whether with 10 bar at 80 °C or 6 bar at 150 °C – always delivers maximum process reliability.
Anti-static	NPQM	PUN-CM	Electrically conductive tubing combined with a solid-metal fitting.
For food industry	QS-F	PUN-H	Food and Drug Administration certification for use in the food industry: the hydrolysis-resistant combination with increased functions.
	CRQS	PFAN	Designed to meet the highest demands, thanks to maximum corrosion protection: this combination shines in applications which require the highest possible hygiene standards for foods.
Resistant to cleaning agents	NPQP	PLN	The cost-effective alternative to stainless steel, perfect for e.g. critical environments such as the splash zone: resistant to practically all common cleaning agents, with maximum corrosion protection.
Resistant to media	NPQP	PFAN	Completely resistant to all cleaning agents and lubricants and even permits the transportation of acids and lyes without any problems.
Flame-retardant	NPQM	PUN-V0	Safe in areas where there is a risk of fire thanks to flame retardant properties to UL94.
Resistant to welding spatter	QS-F	PUN-V0-C	The economical combination for applications in the immediate vicinity of welding applications. Reliable thanks to a tubing wall thickness of 2 mm for all diameters.
	QS-V0	PAN-V0	Also reliable for applications in direct proximity to welding splatter. Double-sheathed tube and special fitting.

## Push-in fittings NPQP

Features

### Push-in fittings product range

QSM, Quick Star, mini

Technical data → Internet: qsm



Miniature push-in fittings for maximum assembly in confined spaces. For pneumatic applications with a temperature range up to 80 °C and a pressure range up to 14 bar. Tubing O.D. of 2, 3, 4 and 6 mm with connecting threads M3, M5, M6, M7, R1/8 and G1/8.

QS, Quick Star, standard

Technical data → Internet: qs



Wide selection of push-in fittings for pneumatic applications with a temperature range up to 80 °C and a pressure range up to 14 bar. Tubing O.D. of 4, 6, 8, 10, 12 and 16 mm with connecting threads R1/8 ... R1/2 and G1/8 ... G1/2.

QSM-B, Quick Star, mini

Technical data → Internet: qsm-b



Miniature push-in fittings for maximum assembly in confined spaces. For core pneumatic applications with a temperature range up to 60 °C and a pressure range up to 10 bar. Tubing O.D. of 3, 4 and 6 mm with connecting threads M3, M5, M7 and R1/8.

QS-B, Quick Star, standard

Technical data → Internet: qs-b



Push-in fittings for core pneumatic applications with a temperature range up to 60°C and a pressure range up to 10 bar. Tubing O.D. of 4, 6, 8, 10, 12 and 16 mm with connecting threads M5 and R1/8 ... R1/2.

QS-F, Quick Star, metal

Technical data → Internet: qs-f



Solid metal push-in fitting with chrome-plated surface coating. High corrosion resistance (CRC3) and chemical resistance with approval for use in the food and packaging industry. For pneumatic applications with a temperature range up to 150 °C and a pressure range up to 16 bar. Tubing O.D. of 4, 6, 8, 10, 12 and 14 mm with connecting threads M5, M7 and G1/8 ... G1/2 .

CRQS, Quick Star, stainless steel

Technical data → Internet: crqs



Stainless steel push-in fitting. High corrosion resistance (CRC4) and chemical resistance with approval for use in the food and packaging industry. For pneumatic applications with a temperature range up to 120 °C and a pressure range up to 10 bar. Tubing O.D. of 4, 6, 8, 10, 12 and 16 mm with connecting threads M5 and R1/8 ... R1/2 .

QS-V0, Quick Star, flame-retardant

Technical data → Internet: qs-v0







Flame-retardant push-in fitting for use in all areas where there is a risk of fire, for example welding systems in the automotive industry and in the construction industry. For pneumatic applications with a temperature range up to 60 °C and a pressure range up to 10 bar. Tubing O.D. of 4, 6, 8, 10 and 12 mm with connecting threads R1/8 ... R1/2 and G1/8 ... G1/2 .

## Push-in fittings NPQP

Features

**FESTO**

Push-in fittings product range			
NPQM	Technical data → Internet: npqm	NPQP	Technical data → Internet: npqp
	Attractively priced metal push-in fitting for pneumatic applications with a temperature range up to 70 °C and a pressure range up to 16 bar. Tubing O.D. of 3, 4, 6, 8, 10, 12 and 14 mm with connecting threads M5, M7 and G1/8 ... G1/2 .		Polypropylene fitting for use in applications with extreme influence of media. For pneumatic applications with a temperature range up to 60 °C and a pressure range up to 10 bar. Tubing O.D. of 4, 6, 8, 10 and 12 mm with connecting threads R1/8 ... R1/2.
Functional push-in fittings product range			
QSK, Quick Star, self-sealing push-in fitting	Technical data → Internet: qsk	QSR, Quick Star, rotary push-in fitting	Technical data → Internet: qsr
	Push-in fitting that blocks the air flow after the tubing is disconnected. For pneumatic applications with a temperature range up to 60 °C and a pressure range up to 14 bar. Tubing O.D. of 4, 6, 8, 10 and 12 mm with connecting threads M5, R1/8 ... R1/2 and G1/8 ... G1/2.		Push-in fitting with swivel connection, rotatable by 360°. The ball bearing enables rotating movements in the application up to max. 500 rpm. For pneumatic applications with a temperature range up to 60 °C and a pressure range up to 14 bar. Tubing O.D. of 4, 6, 8, 10 and 12 mm with connecting threads M5, R1/8 ... R1/2 and G1/8 ... G1/2.

# Push-in fittings NPQP

Technical data

FESTO

General technical data	
Size	Standard
Design	Push-pull principle

Operating and environmental conditions	
Temperature-dependent operating pressure [bar]	−0.95 ... +10
Operating medium	Compressed air in accordance with ISO 8573-1:2010 [7:−:−]
Note on operating/pilot medium	Operation with lubricated medium possible
Ambient temperature [°C]	−20 ... +60
	Extended temperature range on request
Corrosion resistance class CRC <sup>1)</sup>	4
Suitable for use in the food industry	As per manufacturer's declaration

- 1) CRC4: Corrosion resistance class to Festo standard 940 070  
Components with very heavy corrosion exposure. Components in contact with aggressive media, e.g. in food or chemical industries. These applications must, if necessary, be verified by special tests with the media concerned.

Materials	
Housing	PP
Tube retaining claw	High-alloy stainless steel
Note on materials	RoHS-compliant
	Contains PWIS (paint-wetting impairment substances)

Operating pressure p as a function of temperature t

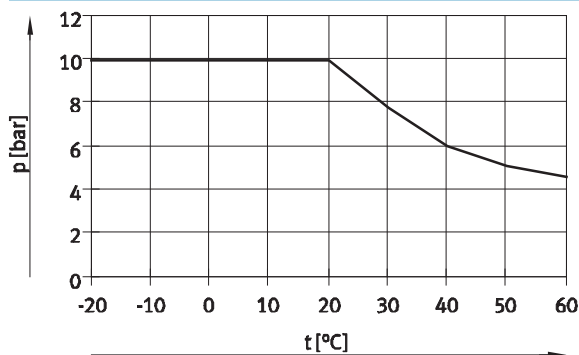









## Note

Leaks can occur with large temperature fluctuations due to the high expansion coefficient of polypropylene in combination with the R thread. To avoid this it is recommended to seal the thread with Loctite® 55 pipe sealing cord.

## Push-in fittings NPQP

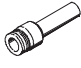
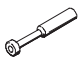



Product range overview

**FESTO**

Design	Version	Type	Connection D1			Connection D2			→ Page/ Internet
			R thread	Tubing O.D.	Push-in sleeve Ø	Tubing O.D.	Push-in sleeve Ø		
Inline	Push-in fitting – Male thread with external hex								
		NPQP-D	R1/8	–	–	4, 6, 8	–	8	
			R1/4			4, 6, 8, 10			
			R3/8			10, 12			
			R1/2			12			
	Push-in connector								
		NPQP-D	–	4	–	4	–	9	
				6		6			
				8		8			
				10		10			
				12		12			
		NPQP-D reducing	–	6	–	4	–	9	
				8		6			
				10		8			
				12		10			
	Push-in bulkhead connector								
		NPQP-H	–	4	–	–	–	10	
				6					
				8					
				10					
				12					
	Push-in connector with push-in sleeve								
	NPQP-D-...-S	–	4	–	–	6, 8	10		
			6			8, 10			
			8			10, 12			
			10			12			
Blanking plug									
	NPQP-P	–	–	4	–	–	11		
				6					
				8					
				10					
				12					
L-shape	Push-in L-fitting – Male thread with external hex								
		NPQP-L	R1/8	–	–	4, 6, 8	–	12	
			R1/4			4, 6, 8, 10			
			R3/8			10, 12			
			R1/2			12			
	Push-in L-fitting – Male thread with external hex								
		NPQP-LQ	R1/8	–	–	4, 6, 8	–	12	
			R1/4			4, 6, 8, 10			
			R3/8			10, 12			
			R1/2			12			
	Push-in L-connector								
		NPQP-L	–	4	–	4	–	13	
				6		6			
				8		8			
				10		10			
				12		12			

# Push-in fittings NPQP

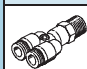
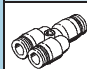
Product range overview

Design	Version	Type	Connection D1			Connection D2		→ Page/ Internet
			R thread	Tubing O.D.	Push-in sleeve Ø	Tubing O.D.	Push-in sleeve Ø	
T-shape	Push-in T-fitting – Male thread with external hex							
		NPQP-T	R1/8	–	–	4, 6, 8	–	14
			R1/4			4, 6, 8, 10		
			R3/8			10, 12		
			R1/2			12		
	Push-in T-connector							
		NPQP-T	–	4	–	4	–	15
			6	6				
			8	8				
			10	10				
			12	12				
		NPQP-T reducing	–	6	–	4	–	15
			8	6				
			10	8				
			12	10				
Y-shape	Push-in Y-fitting – Male thread with external hex							
		NPQP-Y	R1/8	–	–	4, 6, 8	–	16
			R1/4			4, 6, 8, 10		
			R3/8			10, 12		
			R1/2			12		
	Push-in Y-connector							
		NPQP-Y	–	4	–	4	–	17
			6	6				
			8	8				
			10	10				
			12	12				
		NPQP-Y reducing	–	6	–	4	–	17
			8	6				
			10	8				
			12	10				

## Push-in fittings NPQP

Technical data

**FESTO**

### Push-in fitting NPQP-D

Male thread  
with external hex

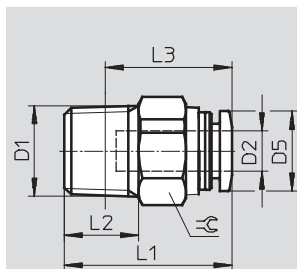

Dimensions and ordering data											
Connection	Nominal size	Tubing O.D.	D5	L1	L2	L3	$\approx \varnothing$	Weight/piece	Part No.	Type	PU <sup>1)</sup>
D1	[mm]	D2						[g]			
R1/8	2.1	4	9.9	21.1	8	17.1	12	2.5	133041	NPQP-D-R18-Q4-FD-P10	10
	3.4	6	11.8	22.8	8	18.8	14	3.0	133043	NPQP-D-R18-Q6-FD-P10	10
	5.3	8	13.8	27.9	8	23.9	17	4.5	133045	NPQP-D-R18-Q8-FD-P10	10
R1/4	2.1	4	9.9	22.3	11	16.3	14	3.5	133042	NPQP-D-R14-Q4-FD-P10	10
	3.4	6	11.8	24.8	11	18.8	14	3.5	133044	NPQP-D-R14-Q6-FD-P10	10
	5.3	8	13.8	26.6	11	20.6	17	4.5	133046	NPQP-D-R14-Q8-FD-P10	10
	6.2	10	16.8	32.6	11	26.6	19	7.0	133047	NPQP-D-R14-Q10-FD-P10	10
R3/8	6.2	10	16.8	33.6	12	27.3	19	8.0	133048	NPQP-D-R38-Q10-FD-P10	10
	7.2	12	19.8	37.6	12	31.3	22	12.0	133049	NPQP-D-R38-Q12-FD-P10	10
R1/2	7.2	12	19.8	34.1	15	25.9	22	12.0	133050	NPQP-D-R12-Q12-FD	1

1) Packaging unit

## Push-in fittings NPQP

Technical data

FESTO

### Push-in connector NPQD-D

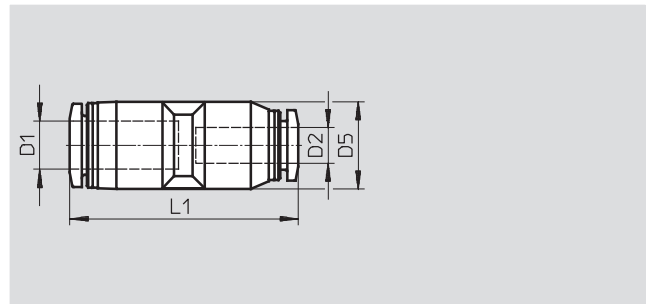
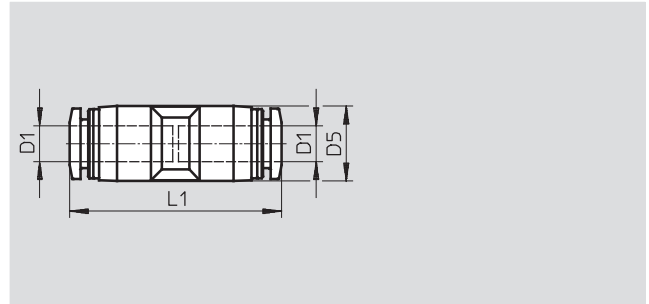

Reducing

Dimensions and ordering data								
Tubing O.D. D1	Nominal size [mm]	Tubing O.D. D2	D5 Ø	L1	Weight/piece [g]	Part No.	Type	PU <sup>1)</sup>
4	2.6	–	10.0	31.0	4.0	133091	NPQP-D-Q4-E-FD-P10	10
6	4.0	–	12.5	35.2	5.5	133092	NPQP-D-Q6-E-FD-P10	10
8	5.0	–	14.5	37.8	8.0	133093	NPQP-D-Q8-E-FD-P10	10
10	6.7	–	17.5	43.8	13.0	133094	NPQP-D-Q10-E-FD-P10	10
12	8.7	–	21.0	48.2	19.0	133095	NPQP-D-Q12-E-FD-P10	10
Reducing								
6	2.6	4	12.5	34.6	5.5	133096	NPQP-D-Q6-Q4-FD-P10	10
8	4.0	6	14.5	38.0	7.0	133097	NPQP-D-Q8-Q6-FD-P10	10
10	5.0	8	17.5	43.3	12.0	133098	NPQP-D-Q10-Q8-FD-P10	10
12	6.7	10	21.0	48.0	18.0	133099	NPQP-D-Q12-Q10-FD-P10	10

1) Packaging unit

## Push-in fittings NPQP

Technical data

**FESTO**

### Push-in bulkhead connector NPQP-H

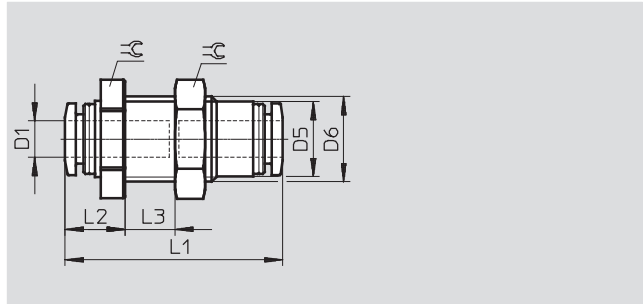

Dimensions and ordering data											
Tubing O.D.	Nominal size	D5	D6	L1	L2	L3	≅	Weight/piece	Part No.	Type	PU <sup>1)</sup>
D1	[mm]	Ø				max.		[g]			
4	2.3	10	M12x1.5	31.6	9.3	6.5	14	7.2	<b>133100</b>	<b>NPQP-H-Q4-E-FD</b>	<b>1</b>
6	3.7	12.3	M14x1.5	35.8	9.9	9.5	17	10.2	<b>133101</b>	<b>NPQP-H-Q6-E-FD</b>	<b>1</b>
8	4.9	14.2	M16x1.5	38.4	10.7	9	19	14.3	<b>133102</b>	<b>NPQP-H-Q8-E-FD</b>	<b>1</b>
10	7.1	17.5	M20x2	43.4	13.2	12	24	24.4	<b>133103</b>	<b>NPQP-H-Q10-E-FD</b>	<b>1</b>
12	7.8	21	M24x2	48.8	13.4	14	27	30.4	<b>133104</b>	<b>NPQP-H-Q12-E-FD</b>	<b>1</b>

1) Packaging unit

### Push-in connector NPQP-D

with push-in sleeve

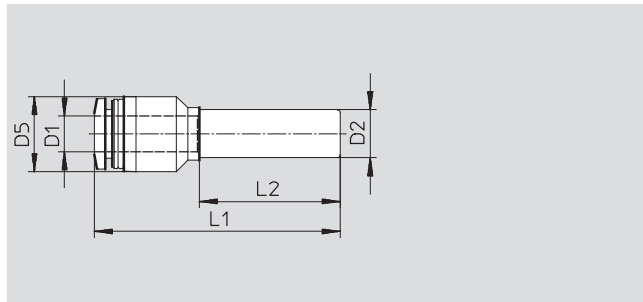

Dimensions and ordering data										
Tubing O.D.	Nominal size	Push-in sleeve Ø	D5	L1	L2	Weight/piece	Part No.	Type	PU <sup>1)</sup>	
D1	[mm]	D2	Ø			[g]				
4	2.5	6	10.0	37.8	22.3	2.4	<b>133133</b>	<b>NPQP-D-Q4-S6-FD-P10</b>	<b>10</b>	
	2.4	8	12.5	40.3	23.3	3.0	<b>133134</b>	<b>NPQP-D-Q4-S8-FD-P10</b>	<b>10</b>	
6	3.8	8	12.5	40.9	23.3	3.2	<b>133135</b>	<b>NPQP-D-Q6-S8-FD-P10</b>	<b>10</b>	
	3.8	10	12.5	43.9	28.3	3.6	<b>133136</b>	<b>NPQP-D-Q6-S10-FD-P10</b>	<b>10</b>	
8	5.4	10	14.5	43.7	24.8	4.7	<b>133137</b>	<b>NPQP-D-Q8-S10-FD-P10</b>	<b>10</b>	
	5.4	12	14.5	49.7	33.5	5.4	<b>133138</b>	<b>NPQP-D-Q8-S12-FD-P10</b>	<b>10</b>	
10	6.3	12	17.5	50.2	28.8	7.9	<b>133139</b>	<b>NPQP-D-Q10-S12-FD-P10</b>	<b>10</b>	

1) Packaging unit

## Push-in fittings NPQP

Technical data

### Blanking plug NPQP-P

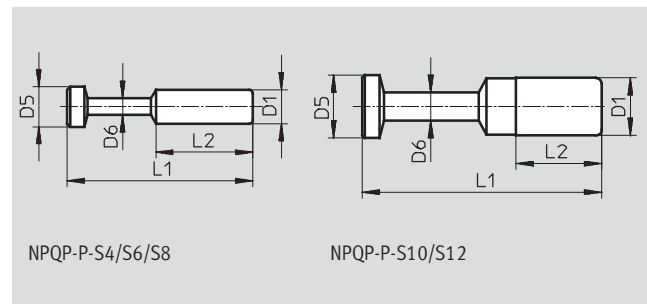

Dimensions and ordering data								
Push-in sleeve Ø D1	D5 Ø	D6 Ø	L1	L2	Weight/piece [g]	Part No.	Type	PU <sup>1)</sup>
4	5	3	27.5	15.0	0.5	133128	NPQP-P-S4-FD-P10	10
6	7	3	32.5	17.0	0.5	133129	NPQP-P-S6-FD-P10	10
8	9	4	36.5	18.1	1.0	133130	NPQP-P-S8-FD-P10	10
10	11	5	42.0	20.2	2.0	133131	NPQP-P-S10-FD-P10	10
12	13	6	44.0	23.4	2.5	133132	NPQP-P-S12-FD-P10	10

1) Packaging unit

## Push-in fittings NPQP

Technical data

**FESTO**

### Push-in L-fitting NPQP-L

Male thread  
with external hex

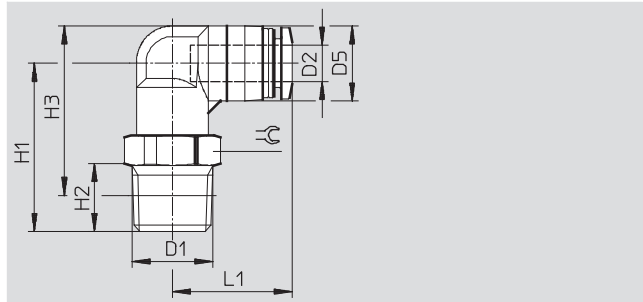

Dimensions and ordering data												
Connection	Nominal size	Tubing O.D.	D5	H1	H2	H3	L1	⌀	Weight/piece	Part No.	Type	PU <sup>1)</sup>
D1	[mm]	D2							[g]			
R <sup>1</sup> / <sub>8</sub>	2.1	4	10.0	23.3	8	24.3	18.1	10	4.0	133051	NPQP-L-R18-Q4-FD-P10	10
	3.3	6	12.5	25.0	8	27.3	19.9	12	5.0	133053	NPQP-L-R18-Q6-FD-P10	10
	4.7	8	14.5	28.0	8	31.3	22.7	14	7.0	133055	NPQP-L-R18-Q8-FD-P10	10
R <sup>1</sup> / <sub>4</sub>	2.1	4	10.0	26.3	11	25.3	18.1	14	4.5	133052	NPQP-L-R14-Q4-FD-P10	10
	3.3	6	12.5	28.0	11	28.2	19.9	14	5.5	133054	NPQP-L-R14-Q6-FD-P10	10
	4.7	8	14.5	31.0	11	32.2	22.7	14	7.5	133056	NPQP-L-R14-Q8-FD-P10	10
	5.7	10	17.5	36.0	11	38.7	26.4	17	12.0	133057	NPQP-L-R14-Q10-FD-P10	10
R <sup>3</sup> / <sub>8</sub>	5.7	10	17.5	37.0	12	39.4	26.4	17	13.0	133058	NPQP-L-R38-Q10-FD-P10	10
	6.9	12	21.0	39.0	12	43.2	29.6	22	18.0	133059	NPQP-L-R38-Q12-FD-P10	10
R <sup>1</sup> / <sub>2</sub>	6.9	12	21.0	42.0	15	44.3	29.6	22	19.0	133060	NPQP-L-R12-Q12-FD	1

1) Packaging unit

### Push-in L-fitting NPQP-LQ

Male thread  
with external hex

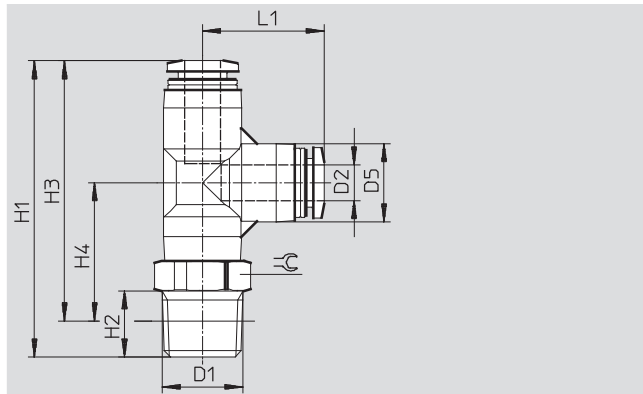

Dimensions and ordering data												
Connection	Nominal size	Tubing O.D.	D5	H1	H2	H3	H4	L1	⌀	Weight/piece	Part No.	Type
D1	[mm]	D2								[g]		PU <sup>1)</sup>
R <sup>1</sup> / <sub>8</sub>	2.0	4	10.0	40.2	8	36.2	19.2	17.0	10	6.0	133061	NPQP-LQ-R18-Q4-FD-P10
	3.3	6	13.0	46.3	8	42.3	22.0	20.2	12	8.0	133063	NPQP-LQ-R18-Q6-FD-P10
	4.8	8	15.0	50.4	8	46.4	24.2	22.2	14	11.0	133065	NPQP-LQ-R18-Q8-FD-P10
R <sup>1</sup> / <sub>4</sub>	2.0	4	10.0	43.2	11	37.2	20.2	17.0	14	6.5	133062	NPQP-LQ-R14-Q4-FD-P10
	3.3	6	13.0	49.3	11	43.3	23.0	20.2	14	8.5	133064	NPQP-LQ-R14-Q6-FD-P10
	4.8	8	15.0	53.4	11	47.4	25.2	22.2	14	12.0	133066	NPQP-LQ-R14-Q8-FD-P10
	5.8	10	17.5	61.4	11	55.4	30.0	25.4	17	18.0	133067	NPQP-LQ-R14-Q10-FD-P10
R <sup>3</sup> / <sub>8</sub>	5.8	10	17.5	62.4	12	56.1	30.7	25.4	17	19.0	133068	NPQP-LQ-R38-Q10-FD-P10
	6.9	12	21.0	67.8	12	61.5	32.9	28.4	22	26.0	133069	NPQP-LQ-R38-Q12-FD-P10
R <sup>1</sup> / <sub>2</sub>	6.9	12	21.0	70.8	15	62.6	34.0	28.4	22	28.0	133070	NPQP-LQ-R12-Q12-FD

1) Packaging unit

# Push-in fittings NPQP

Technical data

## Push-in L-connector NPQP-L

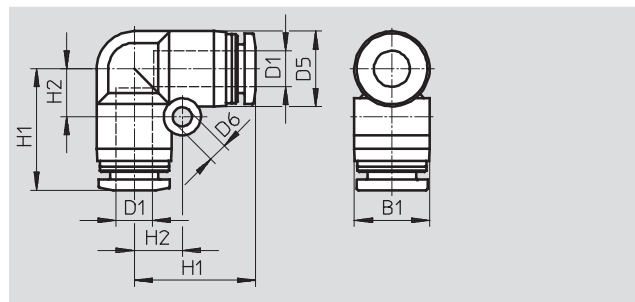

Dimensions and ordering data											
Tubing O.D.	Nominal size	Tubing O.D.	D5	D6	B1	H1	H2	Weight/piece	Part No.	Type	PU <sup>1)</sup>
D1	[mm]	D1	Ø					[g]			
4	2.3	4	10.0	3.2	10.0	17.0	6.5	4.5	133105	NPQP-L-Q4-E-FD-P10	10
6	3.6	6	12.5	3.2	12.5	20.2	8.0	6.0	133106	NPQP-L-Q6-E-FD-P10	10
8	4.6	8	15.0	4.2	15.6	22.4	10.0	9.0	133107	NPQP-L-Q8-E-FD-P10	10
10	6.2	10	17.5	4.2	18.2	26.4	12.0	14.0	133108	NPQP-L-Q10-E-FD-P10	10
12	7.7	12	21.0	4.2	21.7	29.6	14.0	20.0	133109	NPQP-L-Q12-E-FD-P10	10

1) Packaging unit

## Push-in fittings NPQP

Technical data

**FESTO**

### Push-in T-fitting NPQP-T

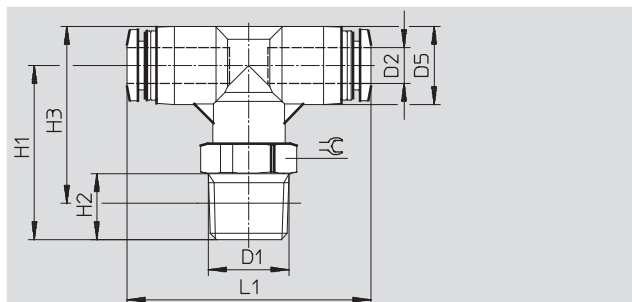

Dimensions and ordering data												
Connection	Nominal size	Tubing O.D.	D5	H1	H2	H3	L1		Weight/ piece	Part No.	Type	PU <sup>1)</sup>
D1	[mm]	D2							[g]			
R1/8	2.0	4	10.0	23.2	8	24.2	34.0	10	6.0	<b>133071</b>	<b>NPQP-T-R18-Q4-FD-P10</b>	<b>10</b>
	3.2	6	13.0	26.0	8	28.5	40.6	12	8.0	<b>133073</b>	<b>NPQP-T-R18-Q6-FD-P10</b>	<b>10</b>
	4.7	8	15.0	26.3	8	29.8	44.8	14	11.0	<b>133075</b>	<b>NPQP-T-R18-Q8-FD-P10</b>	<b>10</b>
R1/4	2.0	4	10.0	26.2	11	25.2	34.0	14	6.5	<b>133072</b>	<b>NPQP-T-R14-Q4-FD-P10</b>	<b>10</b>
	3.2	6	13.0	29.0	11	29.5	40.6	14	8.5	<b>133074</b>	<b>NPQP-T-R14-Q6-FD-P10</b>	<b>10</b>
	4.7	8	15.0	29.3	11	30.8	44.8	14	12.0	<b>133076</b>	<b>NPQP-T-R14-Q8-FD-P10</b>	<b>10</b>
	5.8	10	17.5	36.0	11	38.7	50.8	17	18.0	<b>133077</b>	<b>NPQP-T-R14-Q10-FD-P10</b>	<b>10</b>
R3/8	5.8	10	17.5	37.0	12	39.4	50.8	17	19.0	<b>133078</b>	<b>NPQP-T-R38-Q10-FD-P10</b>	<b>10</b>
	6.9	12	21.0	39.0	12	43.2	57.2	22	26.0	<b>133079</b>	<b>NPQP-T-R38-Q12-FD-P10</b>	<b>10</b>
R1/2	6.9	12	21.0	42.0	15	44.3	57.2	22	28.0	<b>133080</b>	<b>NPQP-T-R12-Q12-FD</b>	<b>1</b>

1) Packaging unit

# Push-in fittings NPQP

Technical data

## Push-in T-connector NPQP-T

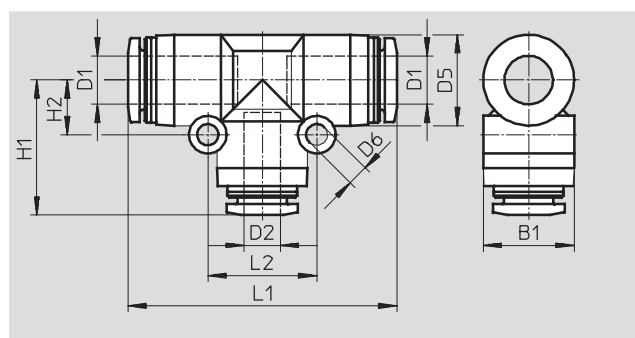
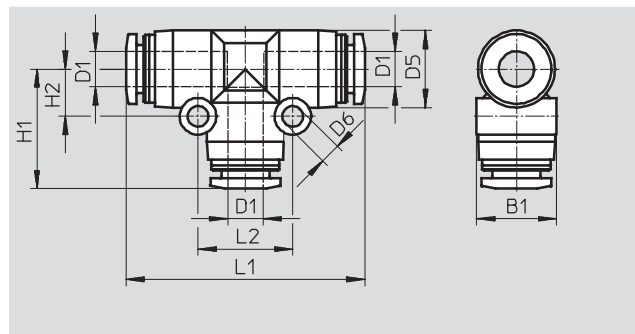

Reducing

Dimensions and ordering data													
Tubing O.D.	Nominal size	Tubing O.D.	D5	D6	B1	H1	H2	L1	L2	Weight/piece	Part No.	Type	PU <sup>1)</sup>
D1	[mm]	D2	Ø							[g]			
4	2.6	–	10.0	3.2	10.0	17.0	6.5	34.0	13.0	6.5	133110	NPQP-T-Q4-E-FD-P10	10
6	4.0	–	13.0	3.2	13.5	20.2	8.0	40.4	16.0	9.0	133111	NPQP-T-Q6-E-FD-P10	10
8	5.0	–	15.0	3.2	15.6	22.2	9.0	44.4	18.0	13.0	133112	NPQP-T-Q8-E-FD-P10	10
10	6.7	–	17.5	4.2	18.2	25.4	12.0	50.8	24.0	21.0	133113	NPQP-T-Q10-E-FD-P10	10
12	8.7	–	21.0	4.2	21.7	28.4	14.0	57.2	28.0	30.0	133114	NPQP-T-Q12-E-FD-P10	10
Reducing													
6	2.3	4	13.0	3.2	13.5	19.6	8.0	40.4	16.0	9.0	133115	NPQP-T-Q6-Q4-FD-P10	10
8	3.6	6	15.0	3.2	15.6	22.4	9.0	44.4	18.0	12.0	133116	NPQP-T-Q8-Q6-FD-P10	10
10	5.0	8	17.5	4.2	18.2	24.9	12.0	50.8	24.0	19.5	133117	NPQP-T-Q10-Q8-FD-P10	10
12	6.4	10	21.0	4.2	21.7	28.2	14.0	57.2	28.0	28.0	133118	NPQP-T-Q12-Q10-FD-P10	10

1) Packaging unit

## Push-in fittings NPQP

Technical data

**FESTO**

### Push-in Y-fitting NPQP-Y

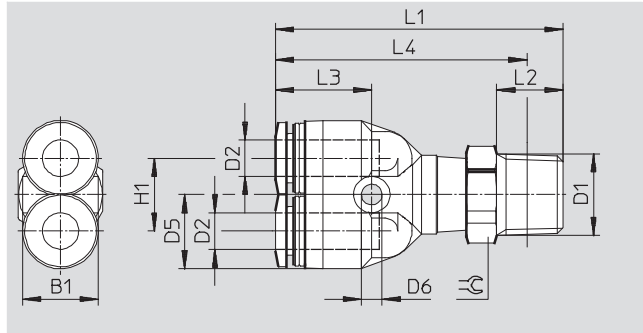

Dimensions and ordering data															
Connection	Nominal size	Tubing O.D.	D5	D6	B1	H1	L1	L2	L3	L4	≈	Weight/piece	Part No.	Type	PU <sup>1)</sup>
D1	[mm]	D2										[g]			
R thread															
R <sup>1</sup> / <sub>8</sub>	2.0	4	10.0	3.2	10.4	11	40.7	8	14.2	36.7	10	6.5	<b>133081</b>	<b>NPQP-Y-R18-Q4-FD-P10</b>	<b>10</b>
	2.8	6	12.5	3.4	13.5	12	44.5	8	15.9	40.5	12	8.0	<b>133083</b>	<b>NPQP-Y-R18-Q6-FD-P10</b>	<b>10</b>
	4.5	8	14.5	3.4	14.5	14	48.7	8	17.2	44.7	14	12.0	<b>133085</b>	<b>NPQP-Y-R18-Q8-FD-P10</b>	<b>10</b>
R <sup>1</sup> / <sub>4</sub>	2.0	4	10.0	3.2	10.4	11	43.7	11	14.2	37.7	14	7.0	<b>133082</b>	<b>NPQP-Y-R14-Q4-FD-P10</b>	<b>10</b>
	2.8	6	12.5	3.4	13.5	12	47.5	11	15.9	41.5	14	8.5	<b>133084</b>	<b>NPQP-Y-R14-Q6-FD-P10</b>	<b>10</b>
	4.5	8	14.5	3.4	14.5	14	51.7	11	17.2	45.7	14	12.0	<b>133086</b>	<b>NPQP-Y-R14-Q8-FD-P10</b>	<b>10</b>
	5.3	10	18.0	4.5	18.0	18	58.5	11	19.7	52.5	17	20.0	<b>133087</b>	<b>NPQP-Y-R14-Q10-FD-P10</b>	<b>10</b>
R <sup>3</sup> / <sub>8</sub>	5.3	10	18.0	4.5	18.0	18	59.5	12	19.7	53.2	17	21.0	<b>133088</b>	<b>NPQP-Y-R38-Q10-FD-P10</b>	<b>10</b>
	6.2	12	21.0	4.2	21.0	20	64.7	12	22.4	58.4	22	28.0	<b>133089</b>	<b>NPQP-Y-R38-Q12-FD-P10</b>	<b>10</b>
R <sup>1</sup> / <sub>2</sub>	6.2	12	21.0	4.2	21.0	20	67.7	15	22.4	59.5	22	30.0	<b>133090</b>	<b>NPQP-Y-R12-Q12-FD</b>	<b>1</b>

1) Packaging unit

# Push-in fittings NPQP

Technical data

## Push-in Y-connector NPQP-Y

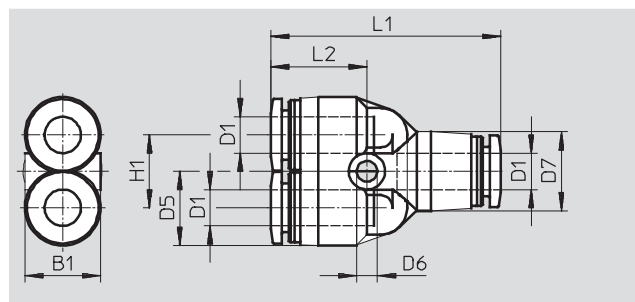

Reducing

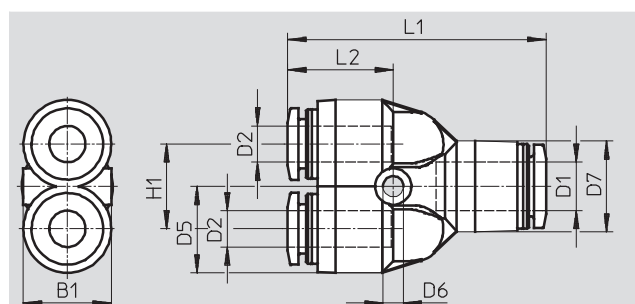

Dimensions and ordering data													
Tubing O.D. D1	Nominal size [mm]	Tubing O.D. D2	D5 Ø	D6	D7	B1	H1	L1	L2	Weight/piece [g]	Part No.	Type	PU <sup>1)</sup>
4	2.3	–	10.0	3.2	10.0	10.4	11.0	33.0	14.2	6.5	133119	NPQP-Y-Q4-E-FD-P10	10
6	3.6	–	12.5	3.4	13.0	13.5	12.0	38.0	15.9	9.0	133120	NPQP-Y-Q6-E-FD-P10	10
8	4.6	–	14.5	3.4	15.0	14.5	14.0	42.4	17.2	13.0	133121	NPQP-Y-Q8-E-FD-P10	10
10	5.9	–	18.0	4.5	18.0	18.0	18.0	48.8	19.7	22.0	133122	NPQP-Y-Q10-E-FD-P10	10
12	7.0	–	21.0	4.2	21.5	21.0	20.0	55.2	22.4	31.0	133123	NPQP-Y-Q12-E-FD-P10	10
Reducing													
6	2.3	4	12.5	3.4	13.0	13.5	12.0	37.4	15.3	8.5	133124	NPQP-Y-Q6-Q4-FD-P10	10
8	3.6	6	14.5	3.4	15.0	15.1	14.0	42.6	17.4	11.5	133125	NPQP-Y-Q8-Q6-FD-P10	10
10	4.7	8	18.0	4.5	18.0	18.0	18.0	48.3	19.2	18.5	133126	NPQP-Y-Q10-Q8-FD-P10	10
12	5.9	10	21.0	4.2	21.5	21.0	20.0	55.0	22.2	28.5	133127	NPQP-Y-Q12-Q10-FD-P10	10

1) Packaging unit

## Product Range and Company Overview

### A Complete Suite of Automation Services

Our experienced engineers provide complete support at every stage of your development process, including: conceptualization, analysis, engineering, design, assembly, documentation, validation, and production.



**Custom Automation Components**  
Complete custom engineered solutions



**Custom Control Cabinets**  
Comprehensive engineering support and on-site services



**Complete Systems**  
Shipment, stocking and storage services

### The Broadest Range of Automation Components

With a comprehensive line of more than 30,000 automation components, Festo is capable of solving the most complex automation requirements.



**Electromechanical**  
Electromechanical actuators, motors, controllers & drives



**Pneumatics**  
Pneumatic linear and rotary actuators, valves, and air supply



**PLCs and I/O Devices**  
PLC's, operator interfaces, sensors and I/O devices

### Supporting Advanced Automation... As No One Else Can!

Festo is a leading global manufacturer of pneumatic and electromechanical systems, components and controls for industrial automation, with more than 12,000 employees in 56 national headquarters serving more than 180 countries. For more than 80 years, Festo has continuously elevated the state of manufacturing with innovations and optimized motion control solutions that deliver higher performing, more profitable automated manufacturing and processing equipment. Our dedication to the advancement of automation extends beyond technology to the education and development of current and future automation and robotics designers with simulation tools, teaching programs, and on-site services.

### Quality Assurance, ISO 9001 and ISO 14001 Certifications

Festo Corporation is committed to supply all Festo products and services that will meet or exceed our customers' requirements in product quality, delivery, customer service and satisfaction.

To meet this commitment, we strive to ensure a consistent, integrated, and systematic approach to management that will meet or exceed the requirements of the ISO 9001 standard for Quality Management and the ISO 14001 standard for Environmental Management.



© Copyright 2008, Festo Corporation. While every effort is made to ensure that all dimensions and specifications are correct, Festo cannot guarantee that publications are completely free of any error, in particular typing or printing errors. Accordingly, Festo cannot be held responsible for the same. For Liability and Warranty conditions, refer to our "Terms and Conditions of Sale", available from your local Festo office. All rights reserved. No part of this publication may be reproduced, distributed, or transmitted in any form or by any means, electronic, mechanical, photocopying or otherwise, without the prior written permission of Festo. All technical data subject to change according to technical update.



Printed on recycled paper at New Horizon Graphic, Inc., FSC certified as an environmentally friendly printing plant.

# Festo North America

## Festo Regional Contact Center

5300 Explorer Drive  
Mississauga, Ontario L4W 5G4  
Canada

### USA Customers:

For ordering assistance,

**Call:** 1.800.99.FESTO (1.800.993.3786)

**Fax:** 1.800.96.FESTO (1.800.963.3786)

**Email:** [customer.service@us.festo.com](mailto:customer.service@us.festo.com)

For technical support,

**Call:** 1.866.GO.FESTO (1.866.463.3786)

**Fax:** 1.800.96.FESTO (1.800.963.3786)

**Email:** [product.support@us.festo.com](mailto:product.support@us.festo.com)

### Canadian Customers:

**Call:** 1.877.GO.FESTO (1.877.463.3786)

**Fax:** 1.877.FX.FESTO (1.877.393.3786)

**Email:** [festo.canada@ca.festo.com](mailto:festo.canada@ca.festo.com)

## USA Headquarters

Festo Corporation  
395 Moreland Road  
P.O. Box 18023  
Hauppauge, NY 11788, USA  
[www.festo.com/us](http://www.festo.com/us)

## USA Sales Offices

### Appleton

North 922 Tower View Drive, Suite N  
Greenville, WI 54942, USA

### Boston

120 Presidential Way, Suite 330  
Woburn, MA 01801, USA

### Chicago

1441 East Business Center Drive  
Mt. Prospect, IL 60056, USA

### Dallas

1825 Lakeway Drive, Suite 600  
Lewisville, TX 75057, USA

### Detroit – Automotive Engineering Center

2601 Cambridge Court, Suite 320  
Auburn Hills, MI 48326, USA

### New York

395 Moreland Road  
Hauppauge, NY 11788, USA

### Silicon Valley

4935 Southfront Road, Suite F  
Livermore, CA 94550, USA

## United States



**USA Headquarters, East:** Festo Corp., 395 Moreland Road, Hauppauge, NY 11788

Phone: 1.631.435.0800; Fax: 1.631.435.8026;

Email: [info@festo-usa.com](mailto:info@festo-usa.com)

[www.festo.com/us](http://www.festo.com/us)

## Canada



**Headquarters:** Festo Inc., 5300 Explorer Drive, Mississauga, Ontario L4W 5G4

Phone: 1.905.624.9000; Fax: 1.905.624.9001;

Email: [festo.canada@ca.festo.com](mailto:festo.canada@ca.festo.com)

[www.festo.ca](http://www.festo.ca)

## Mexico



**Headquarters:** Festo Pneumatic, S.A., Av. Ceylán 3, Col. Tequesquahuac,  
54020 Tlalneapantla, Edo. de México

Phone: 011 52 [55] 53 21 66 00; Fax: 011 52 [55] 53 21 66 65;

Email: [festo.mexico@mx.festo.com](mailto:festo.mexico@mx.festo.com)

[www.festo.com/mx](http://www.festo.com/mx)

## Central USA

Festo Corporation  
1441 East Business  
Center Drive  
Mt. Prospect, IL 60056, USA  
Phone: 1.847.759.2600  
Fax: 1.847.768.9480



## Western USA

Festo Corporation  
4935 Southfront Road,  
Suite F  
Livermore, CA 94550, USA  
Phone: 1.925.371.1099  
Fax: 1.925.245.1286



## Festo Worldwide

Argentina Australia Austria Belarus Belgium Brazil Bulgaria Canada Chile China Colombia Croatia Czech Republic Denmark  
Estonia Finland France Germany Great Britain Greece Hong Kong Hungary India Indonesia Iran Ireland Israel Italy Japan Latvia  
Lithuania Malaysia Mexico Netherlands New Zealand Norway Peru Philippines Poland Romania Russia Serbia Singapore  
Slovakia Slovenia South Africa South Korea Spain Sweden Switzerland Taiwan Thailand Turkey Ukraine United States Venezuela

[www.festo.com](http://www.festo.com)