

Push-in fittings CRQS, Quick Star, stainless steel

FESTO



Push-in fittings CRQS, Quick Star, stainless steel

FESTO

Features

Application



Effortless selection of the right fitting. Quick Star offers a secure solution for every connection. The convenient push-in fitting system includes well over 1000 types of standard and function fittings.

Overview of tubing/fitting combination			
Applications	Fitting	Tubing	Description
Economical	QS-B	PEN	The universal combination at an attractive price. The high resistance of PEN tubing makes it suitable for use in a wide variety of applications. Easy to install thanks to optimised bending radii. Limited reset effect.
	NPQM	PEN	Attractively priced: the universal solution for metal fittings. Perfect for standard pneumatic applications – in many different fields.
Wide range of variants	QS	PUN	Over 1000 types for maximum flexibility in standard applications.
Resistant to hydrolysis	QS	PUN-H	For applications in damp environments or in contact with water at up to 60 °C. PUN-H – microbe-resistant thanks to modified plastic.
Resistant to pressure	QS	PAN	Secure connection when used with pressure ranges of up to 14 bar. Economical for pneumatic installations in the high-pressure range.
	QS-F	PAN-R	The powerful combination for applications involving pressure ranges up to 16 bar: for example, for applications with the pressure booster DPA.
Resistant to heat	QS-F	PFAN	For reliable compressed air supply in elevated temperature ranges. Whether with 10 bar at 80 °C or 6 bar at 150 °C – always delivers maximum process reliability.
Anti-static	NPQM	PUN-CM	Electrically conductive tubing combined with a solid-metal fitting.
For food industry	QS-F	PUN-H	Food and Drug Administration certification for use in the food industry: the hydrolysis-resistant combination with increased functions.
	CRQS	PFAN	Designed to meet the highest demands, thanks to maximum corrosion protection: this combination shines in applications which require the highest possible hygiene standards for foods.
Resistant to cleaning agents	NPQP	PLN	The cost-effective alternative to stainless steel, perfect for e.g. critical environments such as the splash zone: resistant to practically all common cleaning agents, with maximum corrosion protection.
Resistant to media	NPQP	PFAN	Completely resistant to all cleaning agents and lubricants and even permits the transportation of acids and lyes without any problems.
Flame-retardant	NPQM	PUN-V0	Safe in areas where there is a risk of fire thanks to flame retardant properties to UL94.
Resistant to welding spatter	QS-F	PUN-V0-C	The economical combination for applications in the immediate vicinity of welding applications. Reliable thanks to a tubing wall thickness of 2 mm for all diameters.
	QS-V0	PAN-V0	Also reliable for applications in direct proximity to welding splatter. Double-sheathed tube and special fitting.

Push-in fittings CRQS, Quick Star, stainless steel

FESTO

Features

Push-in fittings product range

QSM, Quick Star, mini

Technical data → Internet: qsm



Miniature push-in fittings for maximum assembly in confined spaces. For pneumatic applications with a temperature range up to 80 °C and a pressure range up to 14 bar. Tubing O.D. of 2, 3, 4 and 6 mm with connecting threads M3, M5, M6, M7, R1/8 and G1/8.

QS, Quick Star, standard

Technical data → Internet: qs



Wide selection of push-in fittings for pneumatic applications with a temperature range up to 80 °C and a pressure range up to 14 bar. Tubing O.D. of 4, 6, 8, 10, 12 and 16 mm with connecting threads R1/8 ... R1/2 and G1/8 ... G1/2.

QSM-B, Quick Star, mini

Technical data → Internet: qsm-b



Miniature push-in fittings for maximum assembly in confined spaces. For core pneumatic applications with a temperature range up to 60 °C and a pressure range up to 10 bar. Tubing O.D. of 3, 4 and 6 mm with connecting threads M3, M5, M7 and R1/8.

QS-B, Quick Star, standard

Technical data → Internet: qs-b



Push-in fittings for core pneumatic applications with a temperature range up to 60°C and a pressure range up to 10 bar. Tubing O.D. of 4, 6, 8, 10, 12 and 16 mm with connecting threads M5 and R1/8 ... R1/2.

QS-F, Quick Star, metal

Technical data → Internet: qs-f



Solid metal push-in fitting with chrome-plated surface coating. High corrosion resistance (CRC3) and chemical resistance with approval for use in the food and packaging industry. For pneumatic applications with a temperature range up to 150 °C and a pressure range up to 16 bar. Tubing O.D. of 4, 6, 8, 10, 12 and 14 mm with connecting threads M5, M7 and G1/8 ... G1/2 .

CRQS, Quick Star, stainless steel

Technical data → Internet: crqs



Stainless steel push-in fitting. High corrosion resistance (CRC4) and chemical resistance with approval for use in the food and packaging industry. For pneumatic applications with a temperature range up to 120 °C and a pressure range up to 10 bar. Tubing O.D. of 4, 6, 8, 10, 12 and 16 mm with connecting threads M5 and R1/8 ... R1/2 .

QS-V0, Quick Star, flame-retardant

Technical data → Internet: qs-v0







Flame-retardant push-in fitting for use in all areas where there is a risk of fire, for example welding systems in the automotive industry and in the construction industry. For pneumatic applications with a temperature range up to 60 °C and a pressure range up to 10 bar. Tubing O.D. of 4, 6, 8, 10 and 12 mm with connecting threads R1/8 ... R1/2 and G1/8 ... G1/2 .

Push-in fittings CRQS, Quick Star, stainless steel

FESTO

Features

Push-in fittings product range			
NPQM	Technical data → Internet: npqm	NPQP	Technical data → Internet: npqp
	Attractively priced metal push-in fitting for pneumatic applications with a temperature range up to 70 °C and a pressure range up to 16 bar. Tubing O.D. of 3, 4, 6, 8, 10, 12 and 14 mm with connecting threads M5, M7 and G1/8 ... G1/2 .		Polypropylene fitting for use in applications with extreme influence of media. For pneumatic applications with a temperature range up to 60 °C and a pressure range up to 10 bar. Tubing O.D. of 4, 6, 8, 10 and 12 mm with connecting threads R1/8 ... R1/2.
Functional push-in fittings product range			
QSK, Quick Star, self-sealing push-in fitting	Technical data → Internet: qsk	QSR, Quick Star, rotary push-in fitting	Technical data → Internet: qsr
	Push-in fitting that blocks the air flow after the tubing is disconnected. For pneumatic applications with a temperature range up to 60 °C and a pressure range up to 14 bar. Tubing O.D. of 4, 6, 8, 10 and 12 mm with connecting threads M5, R1/8 ... R1/2 and G1/8 ... G1/2.		Push-in fitting with swivel connection, rotatable by 360°. The ball bearing enables rotating movements in the application up to max. 500 rpm. For pneumatic applications with a temperature range up to 60 °C and a pressure range up to 14 bar. Tubing O.D. of 4, 6, 8, 10 and 12 mm with connecting threads M5, R1/8 ... R1/2 and G1/8 ... G1/2.

Push-in fittings CRQS, Quick Star, stainless steel

FESTO

Features

CRQS, the stainless steel fitting

Highest process reliability in every case

Highest corrosion resistance and maximum robustness: the CRQS stays leak-proof even when subjected to extreme temperature, pressure and resistance.

Unlimited use in the food industry

The push-in fitting CRQS can be used in combination with the plastic tubing PFAN, which is approved for use in the food industry, in all areas of the Food & Packaging industry, e.g. wherever

the use of stainless steel is stipulated. Used together, they easily resist all cleaning agents and lubricants and can also be used with highly aggressive acids and lyes.

Simply "plug and work"

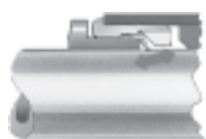

The stainless steel retaining claw within the fitting holds the tubing securely without damaging its surface. Vibration and pressure surges are safely absorbed.

Reliably connected



A fluoro elastomer sealing ring guarantees a perfect seal between the standard tubing and the body of the fitting. Standard tubing is suitable for use with compressed air and vacuum.

Rotatable 360°



The fitting can be aligned after assembly.

Tube assembly/disassembly

Mounting

The prerequisite for ensuring that the inside seal [3] is securely held and protected against damage is that the tube be cut to straight lengths and deburred.

- 1) Pull out releasing ring [1].
 - 2) Insert tubing until the end stop [2].
- It is important to ensure that the tubing is inserted into the inside

- seal [3]. Depending on the tolerance position of the tubing and the seal, the contact of the tubing with the seal may be wrongly interpreted as the end stop.
- 3) Check that the tubing connector is securely held by pulling gently on the tube.

Dismantling

- 1) The tubing can be detached easily by pressing down and holding the releasing ring [1]. Remove the tubing carefully from the threaded connector.
- 2) Before re-using the tubing, remove the damaged part by cutting it off.

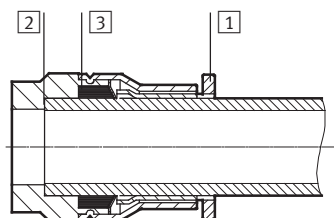

Push-in fittings CRQS, Quick Star, stainless steel

FESTO

Features

Which fitting fits which thread?

Metric thread

- Shorter thread
- Constant installation depth
- Replaceable sealing ring
- Sealing on front face
- Can be re-used a number of times thanks to replaceable sealing ring
- Sealing is guaranteed as the O-ring sits in a groove that seals against the tube

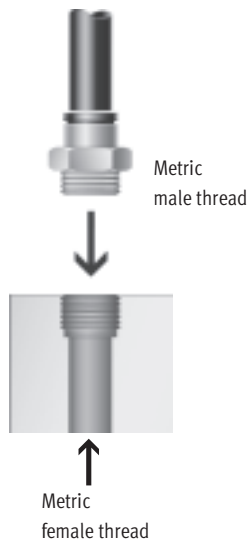

R thread to EN 10226-1 and ISO 7/1

- Self-sealing thread
- No additional sealing surface required
- Smaller installation dimensions since there is no need for an offset for the sealing surface
- Can be reused up to 5 times

Note

An appropriate sealing material is required to seal the push-in fitting CRQS with R thread.

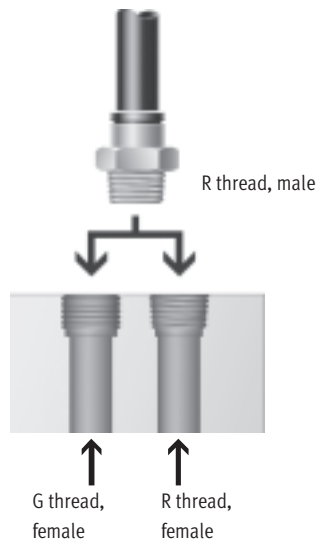

Push-in fittings CRQS, Quick Star, stainless steel

FESTO

Technical data

General technical data	
Size	Standard
Design	Push-pull principle
Mounting position	Any
Type of seal on threaded plug	Sealing ring (metric thread)
	Coating (R thread)
Usable lines	PFAN

Operating and environmental conditions	
Operating pressure [bar]	−0.95 ... +10
complete temperature range	
Operating medium	Compressed air to ISO 8573-1:2010 [7:-:-]
Note about the operating/pilot medium	Operation with lubricated medium possible
Ambient temperature [°C]	−15 ... +120
Corrosion resistance class CRC ¹⁾	4
Suitable for use in the food industry	As per manufacturer's declaration
Approval	Germanischer Lloyd

1) CRC4: Corrosion resistance class to Festo standard 940 070

Components with very heavy corrosion exposure. Components in contact with aggressive media, e.g. in food or chemical industries. These applications must, if necessary, be verified by special tests with the media concerned.

Materials

Sectional view

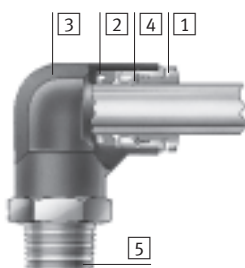

Push-in fitting CRQS		
1	Releasing ring	High-alloy stainless steel
2	Tubing seal	Fluoro elastomer
3	Housing	High-alloy stainless steel
4	Tube retaining claw	High-alloy stainless steel
5	Threaded coupling	High-alloy stainless steel
Note on materials		RoHS-compliant

Push-in fittings CRQS, Quick Star, stainless steel

FESTO

Technical data

Recommended tightening torque/screw-in depth



When using Quick Star push-in fittings with internal hex, ensure that the Allen key is not inserted too far into

the fitting to prevent the risk of damage to components behind the fitting.

 **Note**

Malfunctions may occur with function fittings when screwed too far into the connecting thread. The screw-in depth and the recommended tightening torque must therefore be observed. If the recommended tightening torque is exceeded by more than 50%, damage may occur.

Connecting thread	Tightening torque [Nm]	Approx. screw-in depth [mm]
M thread		
M5	1.5	3
R thread		
R1/8	7	4
R1/4	12	6
R3/8	22	6.5
R1/2	28	8

Tubing insertion depth



Tubing O.D. [mm]	4	6	8	10	12	16
Tubing insertion depth [mm]	18	19.5	21.5	25.5	27	32

Possible push-in fitting/tubing combinations

Thread	Tubing O.D. [mm]					
	4	6	8	10	12	16
M5	++	+	–	–	–	–
R1/8	+	++	+	–	–	–
R1/4	–	+	++	+	–	–
R3/8	–	–	–	++	+	–
R1/2	–	–	–	–	++	+





+ Possible thread/tubing O.D. combinations

++ Optimum thread/tubing O.D. combinations (with regard to flow)

Push-in fittings CRQS, Quick Star, stainless steel

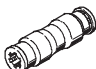
FESTO



Product range overview

Design	Version	Type	Connection D1		Connection D2		→ Page/ Internet
			M thread	R thread	Tubing O.D.	Tubing O.D.	
Straight design	Push-in fitting – Male thread with internal/external hex						
		CRQS	M5x0.8	–	–	4, 6	11
			–	R1⁄8		4, 6, 8	
			–	R1⁄4		6, 8, 10	
			–	R3⁄8		10, 12	
			–	R1⁄2		12, 16	
	Push-in connector						
		CRQS	–	–	4	4	13
					6	6	
					8	8	
					10	10	
					12	12	
		CRQS reducing	–	–	6	4	13
					8	6	
					10	8	
					12	10	
					16	12	
	Push-in bulkhead connector						
		CRQSS	–	–	4	4	13
					6	6	
					8	8	
					10	10	
					12	12	
L-shape	Push-in L-fitting, rotatable 360° – male thread with external hex						
		CRQSL	M5x0.8	–	–	4, 6	14
			–	R1⁄8		4, 6, 8	
			–	R1⁄4		6, 8, 10	
			–	R3⁄8		10, 12	
			–	R1⁄2		12, 16	
	Push-in L-connector						
		CRQSL	–	–	4	–	15
					6		
					8		
					10		
					12		
					16		

Push-in fittings CRQS, Quick Star, stainless steel

Product range overview

FESTO

Design	Version	Type	Connection D1			Connection D2		→ Page/ Internet
			M thread	R thread	Tubing O.D.	Tubing O.D.		
T-shape	Push-in T-fitting, rotatable 360° – male thread with external hex							
		CRQST	M5x0.8	–	–	4, 6	16	
			–	R1/8		6, 8		
				R1/4		8, 10		
				R3/8		10, 12		
				R1/2		12, 16		
	Push-in T-connector							
		CRQST	–	–	4	–	17	
					6			
					8			
					10			
					12			
16								
Y-shape	Push-in Y-connector							
		CRQSY	–	–	4	–	17	
					6			
					8			
					10			
					12			
					16			

Push-in fittings CRQS, Quick Star, stainless steel

FESTO

Technical data

Push-in fitting CRQS

Male thread
with external hex

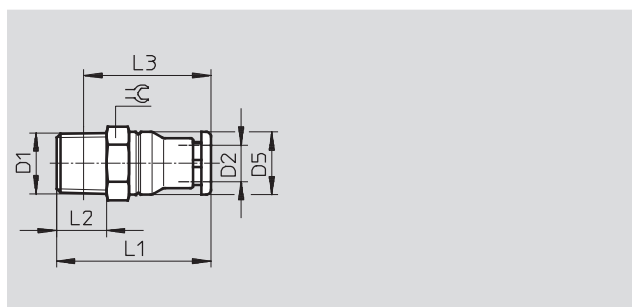
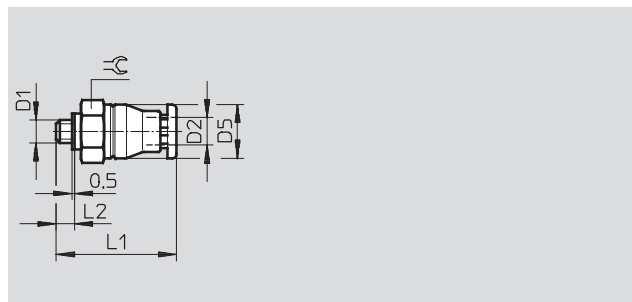

Dimensions and ordering data											
Connection	Nominal size [mm]	Tubing O.D.	D5 Ø	L1	L2	L3	≈	Weight/piece [g]	Part No.	Type	PU*
D1		D2									
Metric thread with sealing ring											
M5x0.8	2	4	9.8	24.2	3	–	10	6	162860	CRQS-M5-4	1
	2	6	11.8	25.6	3	–	12	8.4	162861	CRQS-M5-6	1
R thread											
R $\frac{1}{8}$	2.5	4	9.8	27.2	8	23.3	10	8.7	132643	CRQS- $\frac{1}{8}$ -4	1
	4.1	6	11.8	27.6	8	23.7	12	9.9	162862	CRQS- $\frac{1}{8}$ -6	1
	5.1	8	13.8	30.7	8	26.8	14	13	162863	CRQS- $\frac{1}{8}$ -8	1
R $\frac{1}{4}$	4.2	6	11.8	31.6	11	25.6	14	18	132644	CRQS- $\frac{1}{4}$ -6	1
	5.8	8	13.8	33.7	11	27.7	14	18	162864	CRQS- $\frac{1}{4}$ -8	1
	5.9	10	16.8	36	11	29.9	17	22	162865	CRQS- $\frac{1}{4}$ -10	1
R $\frac{3}{8}$	6	10	16.8	38	12	31.6	17	29	162866	CRQS- $\frac{3}{8}$ -10	1
	7.6	12	19.8	39.8	12	33.4	21	38	162867	CRQS- $\frac{3}{8}$ -12	1
R $\frac{1}{2}$	8.1	12	19.8	42.8	15	34.6	22	55	162868	CRQS- $\frac{1}{2}$ -12	1
	10.1	16	23.7	49.9	15	41.6	24	59	162869	CRQS- $\frac{1}{2}$ -16	1

* Packaging unit quantity

Push-in fittings CRQS, Quick Star, stainless steel

FESTO

Technical data

Push-in fitting CRQS-...-I

Male thread
with internal hex

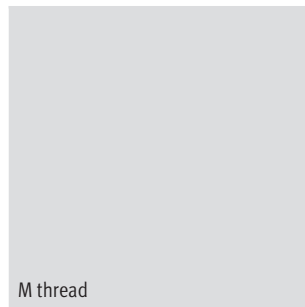

M thread



R thread

Dimensions and ordering data											
Connection	Nominal size	Tubing O.D.	D5 Ø	L1	L2	L3	⌀	Weight/piece [g]	Part No.	Type	PU*
D1	[mm]	D2									
Metric thread with sealing ring											
M5	2	4	10	22.7	3	–	2	5	132328	CRQS-M5-4-I	1
	2	6	12	25.1	3	–	2	7.7	132329	CRQS-M5-6-I	1
R thread											
R1/8	4.1	6	12	26.1	8	22.2	4	8.4	132330	CRQS-1/8-6-I	1
	5.1	8	14	30.2	8	26.3	5	12	132331	CRQS-1/8-8-I	1
R1/4	5.8	8	14	31.2	11	25.2	6	15	132332	CRQS-1/4-8-I	1
	5.9	10	17	36.0	11	29.9	6	21	132333	CRQS-1/4-10-I	1
R3/8	6	10	17	34.0	12	27.6	6	24	132334	CRQS-3/8-10-I	1
	7.6	12	20	36.3	12	29.9	8	28	132335	CRQS-3/8-12-I	1
R1/2	8.1	12	22	39.3	15	31.1	8	45	132336	CRQS-1/2-12-I	1
	10.1	16	24	46.7	15	38.6	12	47	132337	CRQS-1/2-16-I	1

* Packaging unit quantity

Push-in fittings CRQS, Quick Star, stainless steel

FESTO

Technical data

Push-in connector CRQS

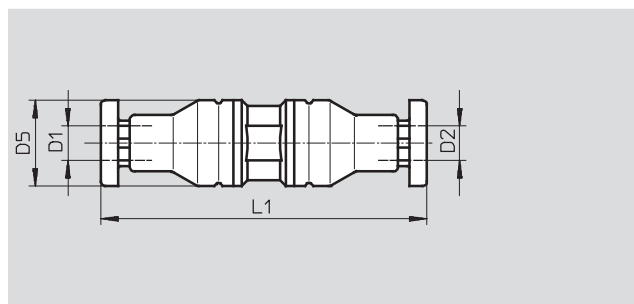

Dimensions and ordering data								
Tubing O.D.	Nominal size	Tubing O.D.	D5	L1	Weight/piece	Part No.	Type	PU*
D1	[mm]	D2	Ø		[g]			
4	2.4	4	9.8	37.4	9.2	130645	CRQS-4	1
6	3.7	6	11.8	40.3	14	130646	CRQS-6	1
8	5.8	8	13.8	44.5	18	130647	CRQS-8	1
10	6.6	10	16.8	51.9	29	130648	CRQS-10	1
12	7.9	12	19.8	55.6	45	130649	CRQS-12	1
16	10.5	16	23.7	66.4	64	130650	CRQS-16	1
Reducing								
6	2.3	4	11.8	38.7	11	130651	CRQS-6-4	1
8	3.7	6	13.8	42.2	15	130652	CRQS-8-6	1
10	5.4	8	16.8	48.2	22	130653	CRQS-10-8	1
12	6.1	10	19.8	53.8	34	130654	CRQS-12-10	1
16	7.3	12	23.7	61	50	130655	CRQS-16-12	1

* Packaging unit quantity

Push-in bulkhead connector CRQSS



M thread

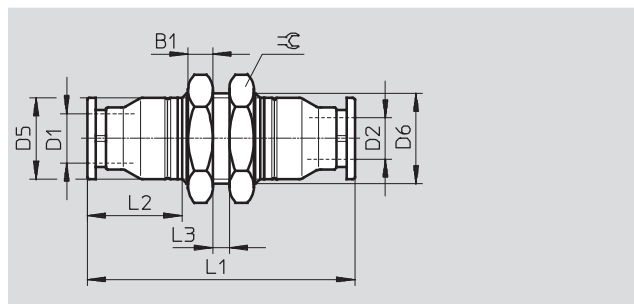

Dimensions and ordering data													
Tubing O.D.	Nominal size	Tubing O.D.	B1	D5	D6	L1	L2	L3	☞	Weight/piece	Part No.	Type	PU*
D1	[mm]	D2		Ø	Ø			max.		[g]			
Metric thread with sealing ring													
4	2.4	4	4	9.8	M12x1	43.4	15.2	4	14	19	164210	CRQSS-4	1
6	3.7	6	4	11.8	M14x1	46.3	15.6	6	17	28	164211	CRQSS-6	1
8	5.7	8	4	13.8	M16x1	50.5	17.7	6	19	35	164213	CRQSS-8	1
10	6.7	10	5	16.8	M20x1	56.9	20	6	24	60	164215	CRQSS-10	1
12	7.9	12	6	19.8	M22x1	62.6	21.8	6	27	87	164217	CRQSS-12	1
16	10.4	16	6	23.7	M27x1.5	72.4	26.7	6	32	118	164219	CRQSS-16	1

* Packaging unit quantity

Push-in fittings CRQS, Quick Star, stainless steel

FESTO

Technical data

Push-in L-fitting CRQSL

Rotatable 360°

Male thread
with external hex

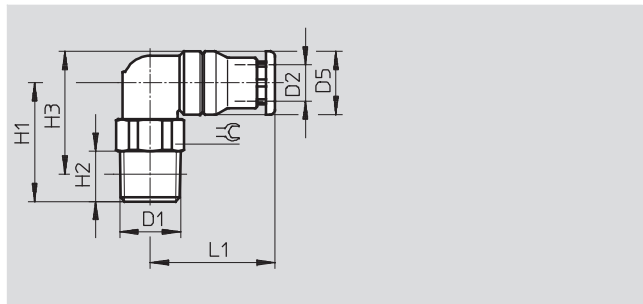
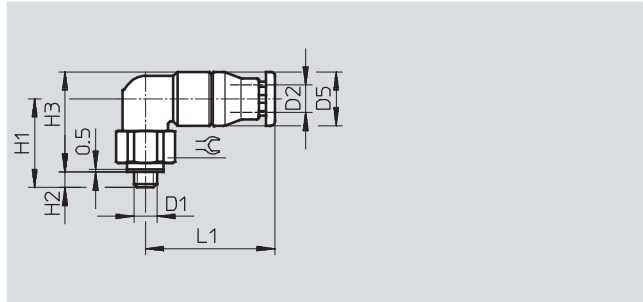

Dimensions and ordering data												
Connection	Nominal size	Tubing O.D.	D5	H1	H2	H3	L1	≅	Weight/piece	Part No.	Type	PU*
D1	[mm]	D2	Ø						[g]			
Metric thread with sealing ring												
M5x0.8	2	4	9.8	17	3	18.9	22.4	10	12	162870	CRQSL-M5-4	1
	2	6	11.8	19	3	21.9	23.6	12	18	162871	CRQSL-M5-6	1
R thread												
R1/8	2.2	4	9.8	19	8	19.9	22.4	10	14	132598	CRQSL-1/8-4	1
	3.9	6	11.8	20.5	8	22.4	23.6	12	19	162872	CRQSL-1/8-6	1
	5.2	8	13.8	23	8	25.9	26.4	14	26	162873	CRQSL-1/8-8	1
R1/4	3.6	6	11.8	23	11	22.9	23.6	14	26	132599	CRQSL-1/4-6	1
	5.1	8	13.8	25	11	25.9	26.4	14	30	162874	CRQSL-1/4-8	1
	6	10	16.8	28.5	11	30.9	30.5	17	42	162875	CRQSL-1/4-10	1
R3/8	6	10	16.8	28.5	12	30.6	30.5	17	49	162876	CRQSL-3/8-10	1
	8.1	12	19.8	30	12	33.6	33.4	21	65	162877	CRQSL-3/8-12	1
R1/2	7.9	12	19.8	34	15	35.7	33.4	22	85	162878	CRQSL-1/2-12	1
	9.4	16	23.7	36	15	39.7	40.7	24	99	162879	CRQSL-1/2-16	1

* Packaging unit quantity

Push-in fittings CRQS, Quick Star, stainless steel

FESTO

Technical data

Push-in L-connector CRQSL

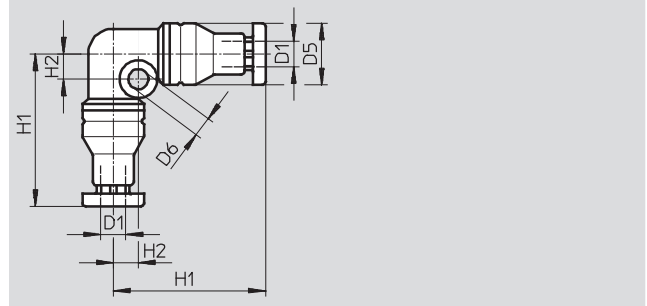

Dimensions and ordering data									
Tubing O.D.	Nominal size	D5 Ø	D6 Ø	H1	H2	Weight/piece [g]	Part No.	Type	PU*
D1	[mm]								
4	2.1	9.8	3.2	24.2	4	13	130662	CRQSL-4	1
6	3.5	11.8	3.2	26.6	5	20	130663	CRQSL-6	1
8	5.1	13.8	3.2	29.7	6	27	130664	CRQSL-8	1
10	6.1	16.8	4.2	35	7	43	130665	CRQSL-10	1
12	7.8	19.8	4.2	37.8	8	62	130666	CRQSL-12	1
16	9.4	23.7	4.2	45.2	9.5	91	130667	CRQSL-16	1

* Packaging unit quantity

Push-in fittings CRQS, Quick Star, stainless steel

FESTO

Technical data

Push-in T-fitting CRQST

Rotatable 360°

Male thread
with external hex

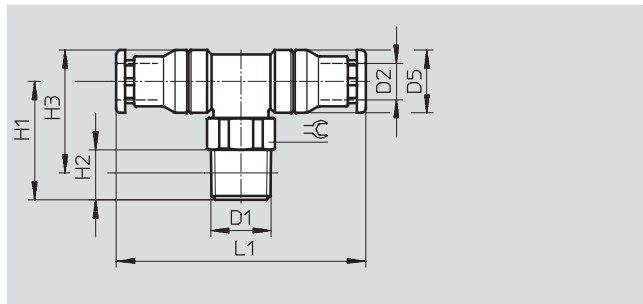
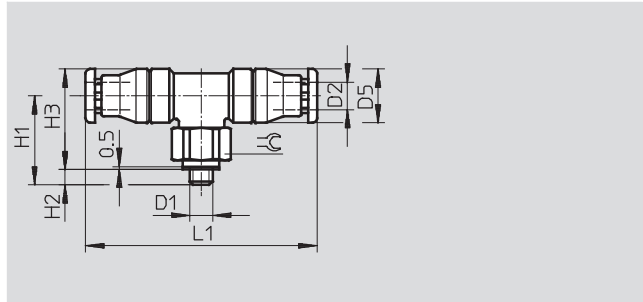

Dimensions and ordering data												
Connection	Nominal size	Tubing O.D.	D5	H1	H2	H3	L1	≈	Weight/piece	Part No.	Type	PU*
D1	[mm]	D2	Ø						[g]			
Metric thread with sealing ring												
M5x0.8	2	4	9.8	18.9	3	17	44.4	10	17	164200	CRQST-M5-4	1
	2	6	11.8	21.9	3	19	47.3	12	25	164201	CRQST-M5-6	1
R thread												
R1/8	3.7	6	11.8	22.4	8	20.5	47.3	12	26	164202	CRQST-1/8-6	1
	5	8	13.8	25.9	8	23	52.5	14	34	164203	CRQST-1/8-8	1
R1/4	5	8	13.8	25.9	11	25	52.5	14	38	164204	CRQST-1/4-8	1
	5.9	10	16.8	30.9	11	28.5	61	17	56	164205	CRQST-1/4-10	1
R3/8	5.9	10	16.8	30.6	12	28.5	61	17	62	164206	CRQST-3/8-10	1
	8.1	12	19.8	33.6	12	30	66.6	21	85	164207	CRQST-3/8-12	1
R1/2	8.1	12	19.8	35.7	15	34	66.6	22	106	164208	CRQST-1/2-12	1
	9.5	16	23.7	39.7	15	36	81.4	24	128	164209	CRQST-1/2-16	1

* Packaging unit quantity

Push-in fittings CRQS, Quick Star, stainless steel

FESTO

Technical data

Push-in T-connector CRQST

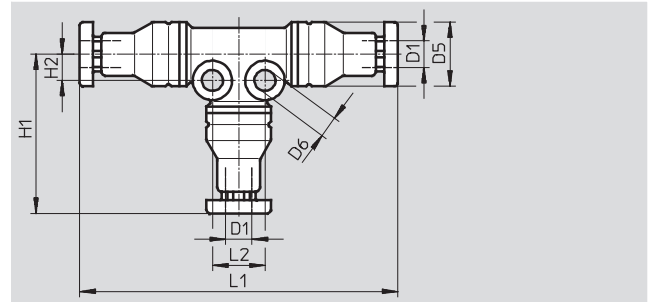

Dimensions and ordering data											
Tubing O.D.	Nominal size	D5 Ø	D6 Ø	H1	H2	L1	L2	Weight/piece [g]	Part No.	Type	PU*
D1	[mm]										
4	2.1	9.8	3.2	24.2	4	48.4	8	19	130668	CRQST-4	1
6	3.5	11.8	3.2	26.7	5	53.3	10	28	130669	CRQST-6	1
8	5	13.8	3.2	29.8	6	59.5	12	38	130670	CRQST-8	1
10	6.1	16.8	4.2	35	7	69.9	14	60	130671	CRQST-10	1
12	8	19.8	4.2	37.8	8	75.6	16	87	130672	CRQST-12	1
16	9.7	23.7	4.2	45.2	9.5	90.4	19	126	130673	CRQST-16	1

* Packaging unit quantity

Push-in Y-connector CRQSY

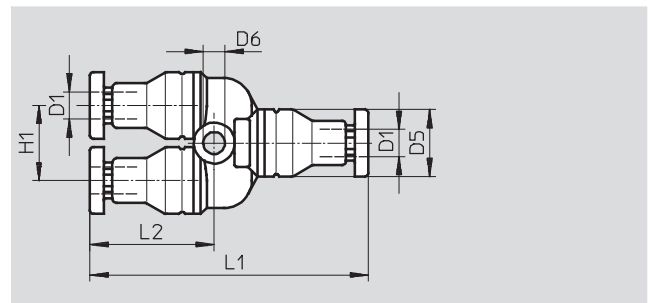

Dimensions and ordering data									
Tubing O.D.	Nominal size	D5 Ø	D6 Ø	H1	L1	Weight/piece [g]	Part No.	Type	PU*
D1	[mm]								
4	2	9.8	3.2	11	40.8	15	130656	CRQSY-4	1
6	3.3	11.8	3.2	13	44.3	24	130657	CRQSY-6	1
8	4.9	13.8	3.2	15	51	34	130658	CRQSY-8	1
10	5.6	16.8	4.3	18	58.5	52	130659	CRQSY-10	1
12	7	19.8	4.3	21	64.6	79	130660	CRQSY-12	1
16	8.2	23.7	4.3	25	78.4	121	130661	CRQSY-16	1

* Packaging unit quantity

Product Range and Company Overview

A Complete Suite of Automation Services

Our experienced engineers provide complete support at every stage of your development process, including: conceptualization, analysis, engineering, design, assembly, documentation, validation, and production.



Custom Automation Components
Complete custom engineered solutions



Custom Control Cabinets
Comprehensive engineering support and on-site services



Complete Systems
Shipment, stocking and storage services

The Broadest Range of Automation Components

With a comprehensive line of more than 30,000 automation components, Festo is capable of solving the most complex automation requirements.



Electromechanical
Electromechanical actuators, motors, controllers & drives



Pneumatics
Pneumatic linear and rotary actuators, valves, and air supply



PLCs and I/O Devices
PLC's, operator interfaces, sensors and I/O devices

Supporting Advanced Automation... As No One Else Can!

Festo is a leading global manufacturer of pneumatic and electromechanical systems, components and controls for industrial automation, with more than 12,000 employees in 56 national headquarters serving more than 180 countries. For more than 80 years, Festo has continuously elevated the state of manufacturing with innovations and optimized motion control solutions that deliver higher performing, more profitable automated manufacturing and processing equipment. Our dedication to the advancement of automation extends beyond technology to the education and development of current and future automation and robotics designers with simulation tools, teaching programs, and on-site services.

Quality Assurance, ISO 9001 and ISO 14001 Certifications

Festo Corporation is committed to supply all Festo products and services that will meet or exceed our customers' requirements in product quality, delivery, customer service and satisfaction.

To meet this commitment, we strive to ensure a consistent, integrated, and systematic approach to management that will meet or exceed the requirements of the ISO 9001 standard for Quality Management and the ISO 14001 standard for Environmental Management.



© Copyright 2008, Festo Corporation. While every effort is made to ensure that all dimensions and specifications are correct, Festo cannot guarantee that publications are completely free of any error, in particular typing or printing errors. Accordingly, Festo cannot be held responsible for the same. For Liability and Warranty conditions, refer to our "Terms and Conditions of Sale", available from your local Festo office. All rights reserved. No part of this publication may be reproduced, distributed, or transmitted in any form or by any means, electronic, mechanical, photocopying or otherwise, without the prior written permission of Festo. All technical data subject to change according to technical update.



Printed on recycled paper at New Horizon Graphic, Inc., FSC certified as an environmentally friendly printing plant.

Festo North America

Festo Regional Contact Center

5300 Explorer Drive
Mississauga, Ontario L4W 5G4
Canada

USA Customers:

For ordering assistance,

Call: 1.800.99.FESTO (1.800.993.3786)

Fax: 1.800.96.FESTO (1.800.963.3786)

Email: customer.service@us.festo.com

For technical support,

Call: 1.866.GO.FESTO (1.866.463.3786)

Fax: 1.800.96.FESTO (1.800.963.3786)

Email: product.support@us.festo.com

Canadian Customers:

Call: 1.877.GO.FESTO (1.877.463.3786)

Fax: 1.877.FX.FESTO (1.877.393.3786)

Email: festo.canada@ca.festo.com

USA Headquarters

Festo Corporation
395 Moreland Road
P.O. Box 18023
Hauppauge, NY 11788, USA
www.festo.com/us

USA Sales Offices

Appleton

North 922 Tower View Drive, Suite N
Greenville, WI 54942, USA

Boston

120 Presidential Way, Suite 330
Woburn, MA 01801, USA

Chicago

1441 East Business Center Drive
Mt. Prospect, IL 60056, USA

Dallas

1825 Lakeway Drive, Suite 600
Lewisville, TX 75057, USA

Detroit – Automotive Engineering Center

2601 Cambridge Court, Suite 320
Auburn Hills, MI 48326, USA

New York

395 Moreland Road
Hauppauge, NY 11788, USA

Silicon Valley

4935 Southfront Road, Suite F
Livermore, CA 94550, USA

United States



USA Headquarters, East: Festo Corp., 395 Moreland Road, Hauppauge, NY 11788

Phone: 1.631.435.0800; Fax: 1.631.435.8026;

Email: info@festo-usa.com

www.festo.com/us

Canada



Headquarters: Festo Inc., 5300 Explorer Drive, Mississauga, Ontario L4W 5G4

Phone: 1.905.624.9000; Fax: 1.905.624.9001;

Email: festo.canada@ca.festo.com

www.festo.ca

Mexico



Headquarters: Festo Pneumatic, S.A., Av. Ceylán 3, Col. Tequesquahuac,
54020 Tlalnepantla, Edo. de México

Phone: 011 52 [55] 53 21 66 00; Fax: 011 52 [55] 53 21 66 65;

Email: festo.mexico@mx.festo.com

www.festo.com/mx

Central USA

Festo Corporation
1441 East Business
Center Drive
Mt. Prospect, IL 60056, USA
Phone: 1.847.759.2600
Fax: 1.847.768.9480



Western USA

Festo Corporation
4935 Southfront Road,
Suite F
Livermore, CA 94550, USA
Phone: 1.925.371.1099
Fax: 1.925.245.1286



Festo Worldwide

Argentina Australia Austria Belarus Belgium Brazil Bulgaria Canada Chile China Colombia Croatia Czech Republic Denmark
Estonia Finland France Germany Great Britain Greece Hong Kong Hungary India Indonesia Iran Ireland Israel Italy Japan Latvia
Lithuania Malaysia Mexico Netherlands New Zealand Norway Peru Philippines Poland Romania Russia Serbia Singapore
Slovakia Slovenia South Africa South Korea Spain Sweden Switzerland Taiwan Thailand Turkey Ukraine United States Venezuela

www.festo.com