

Guide units EAGF for electric cylinders

FESTO



Guide units EAGF for electric cylinders

Key features

FESTO

At a glance

The guide unit EAGF is used to protect electric cylinders from torsion when these are subjected to high torque loads.

It offers high precision guidance for workpiece handling and other handling applications.

For electric cylinder ESBF



Type codes

		EAGF	–	V2	–	KF	–	63	–	100
Type										
EAGF	Guide unit									
Design										
V2	For electric cylinder ESBF									
Guide										
KF	Recirculating ball bearing guide									
Size										
63	63 mm									
80	80 mm									
100	100 mm									
Stroke [mm]										
100	100 mm									
200	200 mm									
320	320 mm									
400	400 mm									
...	1 ... 500 mm									

Guide units EAGF for electric cylinders

Technical data



63 ... 100 mm

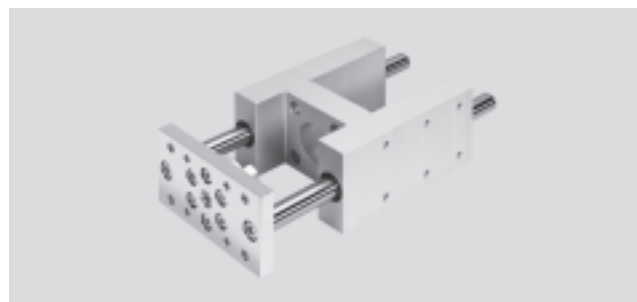
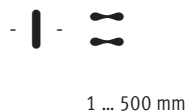

General technical data			
Size	63	80	100
Stroke [mm]	1 ... 500		
Design	Guide		
Guide	Recirculating ball bearing guide		
Reversing backlash [μm]	0		
Type of mounting	Via female thread		
Mounting position	Any		
Ambient temperature [°C]	-20 ... +80 °C		

Weight [g]			
Size	63	80	100
Basic weight with 0 mm stroke	5,525	10,517	13,263
Additional weight per 10 mm stroke	49	76	76
Moving load with 0 mm stroke	2,560	5,166	6,148
Additional load per 10 mm stroke	49	76	76

Materials

Sectional view

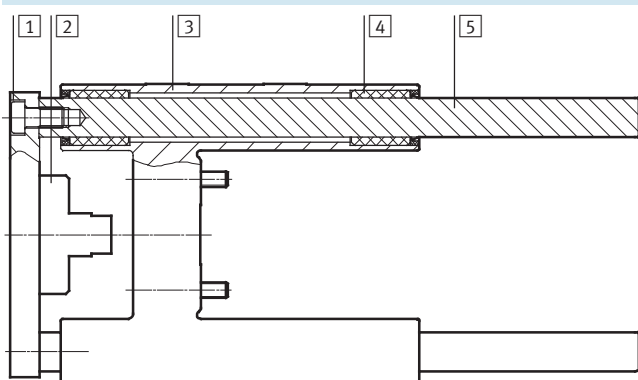

Guide unit	
1 Yoke plate	Steel
2 Guide element	Steel
3 Housing	Anodised wrought aluminium alloy
4 Bearing	Steel
5 Guide rod	Steel
– Note on materials	Free of copper and PTFE
	RoHS-compliant

Guide units EAGF for electric cylinders

Technical data

FESTO

Max. effective load F as a function of projection A

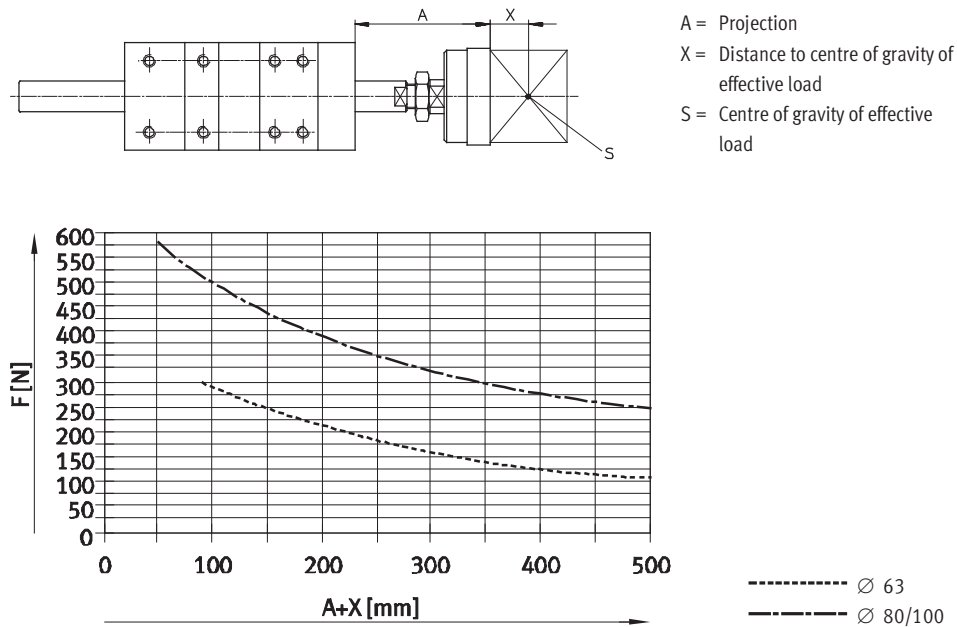

Dimensions

Download CAD data → www.festo.com

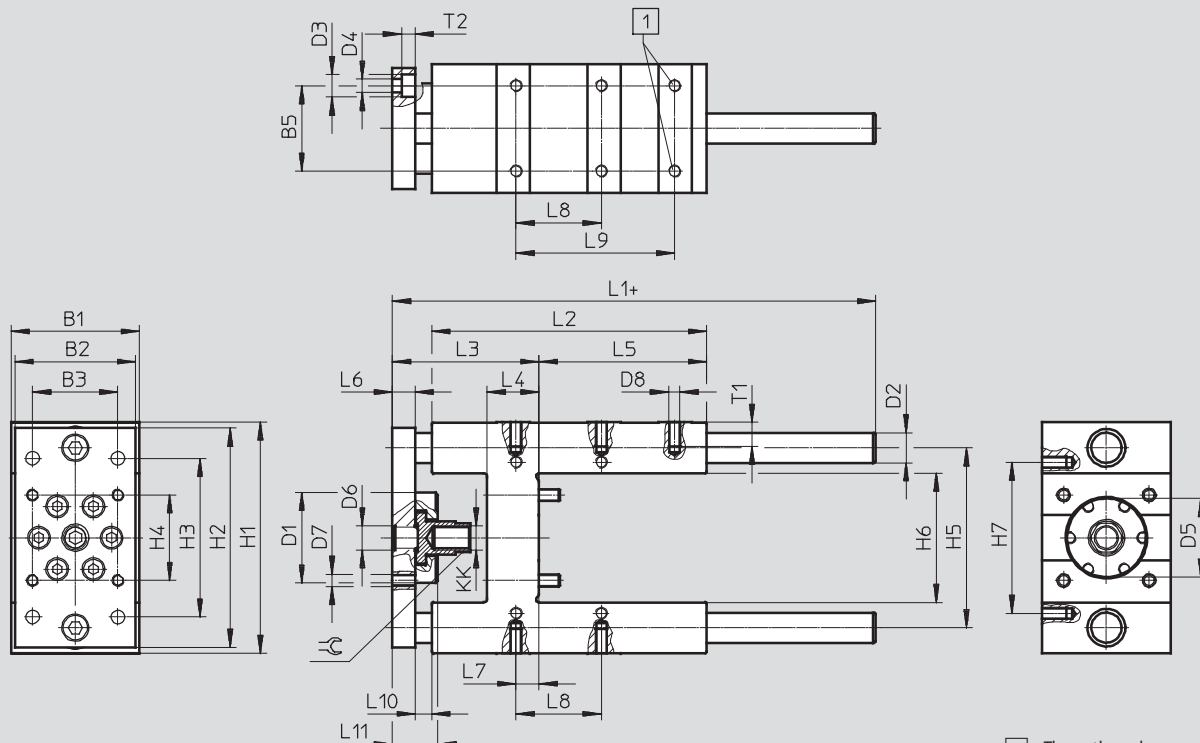

1 These threads are omitted for sizes 80 and 100.

Guide units EAGF for electric cylinders

Technical data

Size	B1 -0.3	B2	B3 ±0.2	B5 ±0.2	D1 Ø	D2 Ø h6	D3 Ø	D4 Ø	D5 Ø H8	D6	D7
63	85	80	56.5	56.5	60	20	15	9	52	M16	M8
80	105	100	72	72	78	25	18	11	60	M18	M10
100	130	120	89	89	78	25	18	11	70	M18	M10

Size	D8	H1 -0.5	H2	H3 ±0.2	H4 ±0.2	H5 ±0.2	H6	H7 ±0.2	KK	L1 ±1	L2
63	M8	153	145	105	56.5	119	85.5±0.3	100	M16x1.5	219.8	182
80	M10	189	180	130	72	148	106+1/-0.6	130	M20x1.5	257.8	215
100	M10	213	200	150	89	172	131+1/-0.6	150	M20x1.5	262.8	220

Size	L3	L4	L5	L6	L7	L8 ±0.2	L9 ±0.2	L10	L11	T1	T2	≈C1
63	96.6	34	111	15	15.3	56.5	105	11	30	16	9	19
80	121.6	40	128	20	21	72	-	15	39	20	11	27
100	126.6	40	128	20	24.5	89	-	15	39	20	11	27

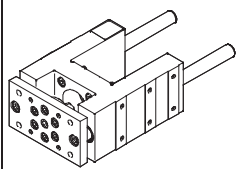
Ordering data												
Guide unit	Size	Stroke [mm]	Part No.	Type								
	63	100	1725842	EAGF-V2-KF-63-100								
		200	1725843	EAGF-V2-KF-63-200								
		320	1725844	EAGF-V2-KF-63-320								
		400	1725845	EAGF-V2-KF-63-400								
		1 ... 500	2608521	EAGF-V2-KF-63-								
	80	100	1725846	EAGF-V2-KF-80-100								
		200	1725847	EAGF-V2-KF-80-200								
		320	1725848	EAGF-V2-KF-80-320								
		400	1725849	EAGF-V2-KF-80-400								
		1 ... 500	2608528	EAGF-V2-KF-80-								
	100	100	1725850	EAGF-V2-KF-100-100								
		200	1725851	EAGF-V2-KF-100-200								
		320	1725852	EAGF-V2-KF-100-320								
		400	1725853	EAGF-V2-KF-100-400								
		1 ... 500	2608532	EAGF-V2-KF-100-								

Product Range and Company Overview

A Complete Suite of Automation Services

Our experienced engineers provide complete support at every stage of your development process, including: conceptualization, analysis, engineering, design, assembly, documentation, validation, and production.



Custom Automation Components
Complete custom engineered solutions



Custom Control Cabinets
Comprehensive engineering support and on-site services



Complete Systems
Shipment, stocking and storage services

The Broadest Range of Automation Components

With a comprehensive line of more than 30,000 automation components, Festo is capable of solving the most complex automation requirements.



Electromechanical
Electromechanical actuators, motors, controllers & drives



Pneumatics
Pneumatic linear and rotary actuators, valves, and air supply



PLCs and I/O Devices
PLC's, operator interfaces, sensors and I/O devices

Supporting Advanced Automation... As No One Else Can!

Festo is a leading global manufacturer of pneumatic and electromechanical systems, components and controls for industrial automation, with more than 12,000 employees in 56 national headquarters serving more than 180 countries. For more than 80 years, Festo has continuously elevated the state of manufacturing with innovations and optimized motion control solutions that deliver higher performing, more profitable automated manufacturing and processing equipment. Our dedication to the advancement of automation extends beyond technology to the education and development of current and future automation and robotics designers with simulation tools, teaching programs, and on-site services.

Quality Assurance, ISO 9001 and ISO 14001 Certifications

Festo Corporation is committed to supply all Festo products and services that will meet or exceed our customers' requirements in product quality, delivery, customer service and satisfaction.

To meet this commitment, we strive to ensure a consistent, integrated, and systematic approach to management that will meet or exceed the requirements of the ISO 9001 standard for Quality Management and the ISO 14001 standard for Environmental Management.



© Copyright 2008, Festo Corporation. While every effort is made to ensure that all dimensions and specifications are correct, Festo cannot guarantee that publications are completely free of any error, in particular typing or printing errors. Accordingly, Festo cannot be held responsible for the same. For Liability and Warranty conditions, refer to our "Terms and Conditions of Sale", available from your local Festo office. All rights reserved. No part of this publication may be reproduced, distributed, or transmitted in any form or by any means, electronic, mechanical, photocopying or otherwise, without the prior written permission of Festo. All technical data subject to change according to technical update.



Printed on recycled paper at New Horizon Graphic, Inc., FSC certified as an environmentally friendly printing plant.

Festo North America

Festo Regional Contact Center

5300 Explorer Drive
Mississauga, Ontario L4W 5G4
Canada

USA Customers:

For ordering assistance,

Call: 1.800.99.FESTO (1.800.993.3786)

Fax: 1.800.96.FESTO (1.800.963.3786)

Email: customer.service@us.festo.com

For technical support,

Call: 1.866.GO.FESTO (1.866.463.3786)

Fax: 1.800.96.FESTO (1.800.963.3786)

Email: product.support@us.festo.com

Canadian Customers:

Call: 1.877.GO.FESTO (1.877.463.3786)

Fax: 1.877.FX.FESTO (1.877.393.3786)

Email: festo.canada@ca.festo.com

USA Headquarters

Festo Corporation
395 Moreland Road
P.O. Box 18023
Hauppauge, NY 11788, USA
www.festo.com/us

USA Sales Offices

Appleton

North 922 Tower View Drive, Suite N
Greenville, WI 54942, USA

Boston

120 Presidential Way, Suite 330
Woburn, MA 01801, USA

Chicago

1441 East Business Center Drive
Mt. Prospect, IL 60056, USA

Dallas

1825 Lakeway Drive, Suite 600
Lewisville, TX 75057, USA

Detroit – Automotive Engineering Center

2601 Cambridge Court, Suite 320
Auburn Hills, MI 48326, USA

New York

395 Moreland Road
Hauppauge, NY 11788, USA

Silicon Valley

4935 Southfront Road, Suite F
Livermore, CA 94550, USA

United States



USA Headquarters, East: Festo Corp., 395 Moreland Road, Hauppauge, NY 11788

Phone: 1.631.435.0800; Fax: 1.631.435.8026;

Email: info@festo-usa.com

www.festo.com/us

Canada



Headquarters: Festo Inc., 5300 Explorer Drive, Mississauga, Ontario L4W 5G4

Phone: 1.905.624.9000; Fax: 1.905.624.9001;

Email: festo.canada@ca.festo.com

www.festo.ca

Mexico



Headquarters: Festo Pneumatic, S.A., Av. Ceylán 3, Col. Tequesquahuac,
54020 Tlalneapantla, Edo. de México

Phone: 011 52 [55] 53 21 66 00; Fax: 011 52 [55] 53 21 66 65;

Email: festo.mexico@mx.festo.com

www.festo.com/mx

Central USA

Festo Corporation
1441 East Business
Center Drive
Mt. Prospect, IL 60056, USA
Phone: 1.847.759.2600
Fax: 1.847.768.9480



Western USA

Festo Corporation
4935 Southfront Road,
Suite F
Livermore, CA 94550, USA
Phone: 1.925.371.1099
Fax: 1.925.245.1286



Festo Worldwide

Argentina Australia Austria Belarus Belgium Brazil Bulgaria Canada Chile China Colombia Croatia Czech Republic Denmark
Estonia Finland France Germany Great Britain Greece Hong Kong Hungary India Indonesia Iran Ireland Israel Italy Japan Latvia
Lithuania Malaysia Mexico Netherlands New Zealand Norway Peru Philippines Poland Romania Russia Serbia Singapore
Slovakia Slovenia South Africa South Korea Spain Sweden Switzerland Taiwan Thailand Turkey Ukraine United States Venezuela

www.festo.com