

## Front panel valves SV

**FESTO**



## Front panel valves and actuator attachments

Key features

FESTO



### Actuator attachments

#### Pushbutton T

Pushbuttons return to their initial switching position after they are actuated.

#### Switch N, H, Q

Switches have several switching positions that can be alternated between as desired. Key actuators can only be activated using the key. The key can be removed in any switching position.

#### Mushroom pushbutton/mushroom pushbutton with detent P

Mushroom pushbuttons return to their initial switching position after they are actuated. Mushroom pushbuttons with detent are actuated by pressing them and return to their initial switching position after they are unlocked:

- Type PR: the actuator is unlocked by turning the detent ring on the mushroom head.
- Type PRS: the actuator can only be unlocked using the key. The key can be removed in either switching position.

### Basic valves

#### 3/2-way valve SV-3-M5

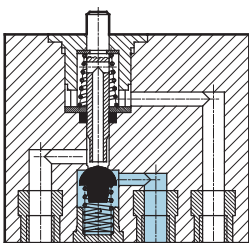

#### 5/2-way valve SV-5-M5-B

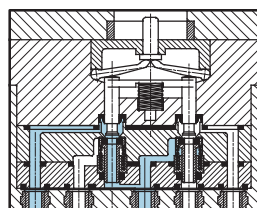

#### Key features

The two basic valves are poppet valves that work without any overlap:

- No overflow between the channels during switching
- Limited self-cleaning by air flow during operation

## Front panel valves and actuator attachments

**FESTO**

Technical data

 - Temperature range  
 -10 ... +60 °C



**General technical data – Actuator attachments with 22.5 mm installation diameter**

	T-22-SW	T-22-GE	T-22-RT	N-22-SW	H-22-SW	Q-22 B	P-22-SW	PR-22-RT	PRS-22-RT B
Actuating force [N]	14	14	14	–	–	23	14	25	23
Actuating torque [Nm]	–	–	–	0.4	0.14	–	–	–	–
Product weight [g]	14	14	14	21	19	80	20	26	82
Colour	Black	Yellow	Red	Black	Black	Black	Black	Red	Red
Note on materials	–	–	–	–	–	RoHS-compliant	–	–	RoHS-compliant

**General technical data – Actuator attachments with 30.5 mm installation diameter**

	T-30-SW	T-30-GE	T-30-RT	N-30-SW	H-30-SW	Q-30	P-30-SW	PR-30-RT	PRS-30-RT
Actuating force [N]	14	14	14	–	–	23	14	25	23
Actuating torque [Nm]	–	–	–	0.4	0.14	–	–	–	–
Product weight [g]	22	22	22	30	27	88	28	37	91
Colour	Black	Yellow	Red	Black	Black	–	Black	Red	Red
Note on materials	–	–	–	–	–	–	–	–	–

# Front panel valves and actuator attachments

Technical data

**FESTO**

## Dimensions – Actuator attachments

Download CAD Data → [www.festo.com/us/cad](http://www.festo.com/us/cad)

Pushbutton actuator T

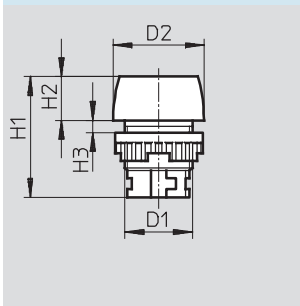

Selector switch N

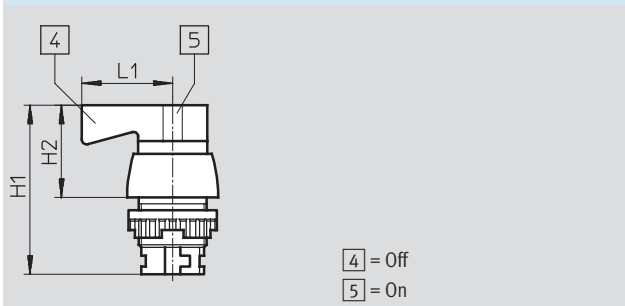

Toggle switch H

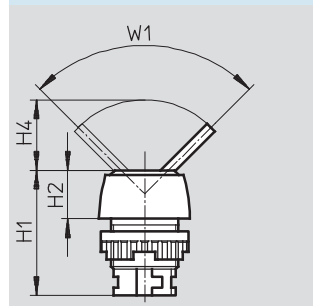

Key actuator Q,  
installation Ø 22.5 mm

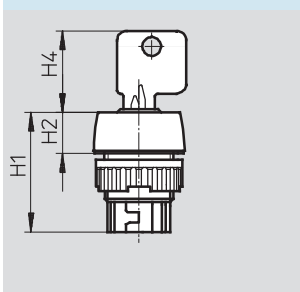

Key actuator Q,  
installation Ø 30.5 mm

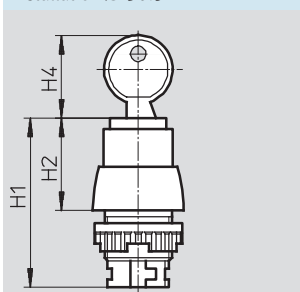

Mushroom pushbutton P

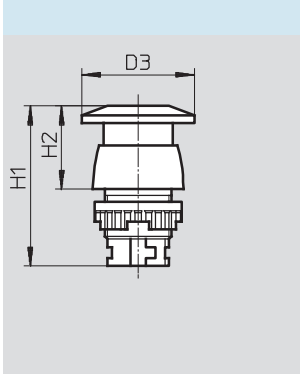

Mushroom pushbutton with detent  
PR

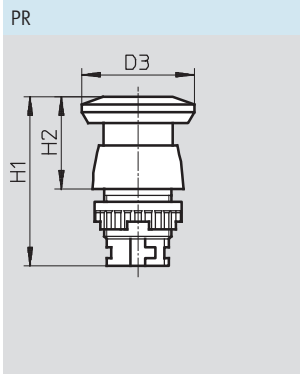

Mushroom pushbutton with detent  
PRS, installation Ø 22.5 mm

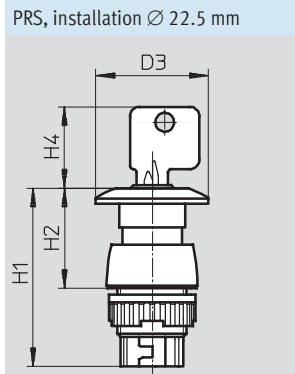

Mushroom pushbutton with detent  
PRS, installation Ø 30.5 mm

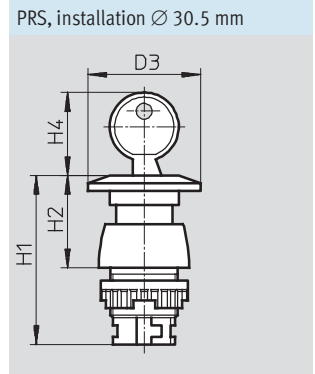



	Installation Ø	Ø D1	Ø D2	Ø D3	H1	H2	H3	H4	L1	W1
Pushbutton actuator T	22.5	M22x1.5	29	–	38.5	14	1 ... 6	–	–	–
	30.5	M30x1.5	36	–	39	8.5	1 ... 12	–	–	–
Selector switch N	22.5	M22x1.5	29	–	54	29.5	1 ... 6	–	29	–
	30.5	M30x1.5	36	–	54.5	24	1 ... 12	–	29	–
Toggle switch H	22.5	M22x1.5	29	–	40	15.5	1 ... 6	22.5	–	90°
	30.5	M30x1.5	36	–	40	9.5	1 ... 12	22.5	–	90°
Key actuator Q	22.5	M22x1.5	29	–	38.2	13.2	1 ... 6	26	–	–
	30.5	M30x1.5	36	–	54.5	24	1 ... 12	26.5	–	–
Mushroom pushbutton P	22.5	M22x1.5	29	36	51	26.5	1 ... 6	–	–	–
	30.5	M30x1.5	36	36	51.5	21	1 ... 12	–	–	–
Mushroom pushbutton with detent PR	22.5	M22x1.5	29	36	54	29.5	1 ... 6	–	–	–
	30.5	M30x1.5	36	36	54.5	24	1 ... 12	–	–	–
Mushroom pushbutton with detent, lockable PRS	22.5	M22x1.5	29	36	57	32	1 ... 6	26	–	–
	30.5	M30x1.5	36	36	56	25.5	1 ... 12	26.5	–	–

# Front panel valves and actuator attachments

FESTO

Technical data

-  - Flow rate  
65 ... 95 l/min

-  -   
-0.9 ... +8 bar  
0 ... 8 bar

-  - Temperature range  
-10 ... +60 °C

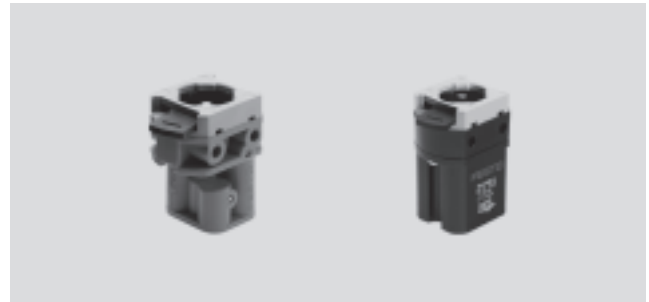

General technical data – Basic valves		
	3/2-way valve	5/2-way valve
Valve function	3/2-way single solenoid valve, closed	5/2-way single solenoid valve
Actuation type	Manual	
Operating medium	Filtered compressed air, lubricated or unlubricated, vacuum <sup>1)</sup>	
Design	Poppet valve with spring return	
Reset method	Mechanical spring	
Sealing principle	Soft	
Mounting position	Any	
Type of control	Direct	
Type of mounting	Front panel mounting, with through-hole	
Pneumatic connection	M5	
Nominal size [mm]	2	2.3
Standard nominal flow rate [l/min]	65	95
Actuating force at 6 bar [N]	12	17
Weight [g]	40	53

1) SV-3-M5: Vacuum connection at port 1

Materials	
Housing	Plastic
Valve stem	Brass
Seals	Nitrile rubber

Operating and environmental conditions		
	3/2-way valve	5/2-way valve
Operating pressure [bar]	-0.95 ... +8	0 ... +8
Ambient temperature [°C]	-10 ... +60	

# Front panel valves and actuator attachments

Technical data – Basic valves

FESTO

## Dimensions – Basic valves

Download CAD Data → [www.festo.com/us/cad](http://www.festo.com/us/cad)

### SV-3-M5

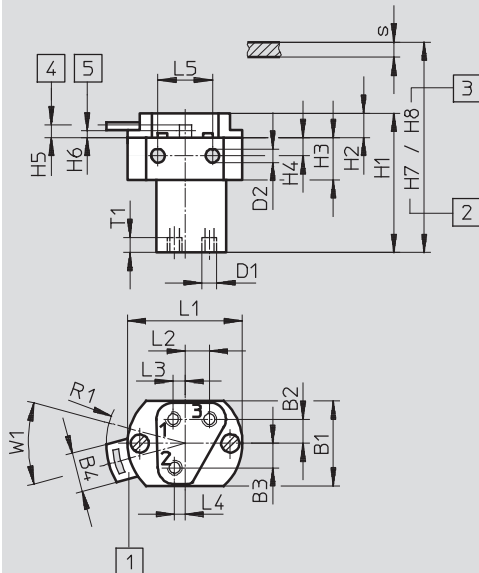

- 1 Quick latching coupler for actuator attachments
- 2 Installation dimensions for  $\varnothing 22.5$
- 3 Installation dimensions for  $\varnothing 30.5$
- 4 Max. stroke
- 5 Start of opening
- 6 Max. opening
- s Front panel thickness

### SV-5-M5-B

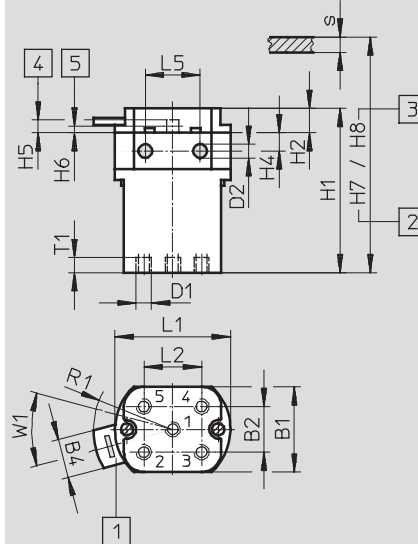

- 1 Supply port
- 2, 4 Working line
- 3, 5 Exhaust port

	B1	B2	B3	B4	D1	D2	H1	H2	H3	H4	H5	H6	H7	H8	L1	L2	L3	L4	L5	R1	T1	W1
SV-3-M5	28	8	8.2	13	M5	4.5	46	8	14	6	4.2	2	63.5	69.5	38	8	4	3.5	18	26	5	30°
SV-5-M5-B		15	–				54		–				71.5	77.5		19	–	–				

## Mounting aperture

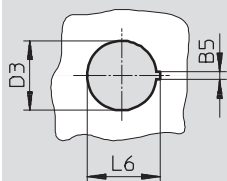







	B5	D3	L6
Mounting aperture, $\varnothing 22.5$	2.6	22.3	23.5
Mounting aperture, $\varnothing 30.5$	3.1	30.3	31.5

# Front panel valves and actuator attachments

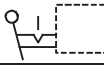
Accessories

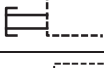
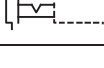
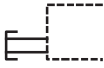
**FESTO**

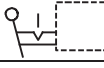
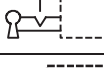
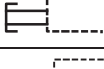
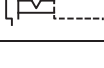
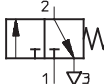
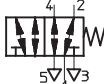
Ordering data				
Circuit symbol	Description		Part No.	Type
Actuator attachments, installation Ø 22.5 mm				
	Pushbutton actuator	Black	9289	T-22-SW
		Yellow	9290	T-22-GE
		Red	9997	T-22-RT
	Selector switch	Black	9301	N-22-SW
	Toggle switch	Black	9305	H-22-SW
	Key actuator with key	Black	573107	Q-22 B
	Mushroom pushbutton	Black	9293	P-22-SW
	Mushroom pushbutton with detent	Red, not lockable	9297	PR-22-RT
		Red, lockable	573108	PRS-22-RT B
Actuator attachments, installation Ø 30.5 mm				
	Pushbutton actuator	Black	9291	T-30-SW
		Yellow	9292	T-30-GE
		Red	10014	T-30-RT
	Selector switch	Black	9302	N-30-SW
	Toggle switch	Black	9306	H-30-SW
	Key actuator with key	–	9304	Q-30
	Mushroom pushbutton	Black	9295	P-30-SW
	Mushroom pushbutton with detent	Red, not lockable	9298	PR-30-RT
		Red, lockable	9300	PRS-30-RT
Basic valves				
	3/2-way valve		6817	SV-3-M5
	5/2-way valve		11914	SV-5-M5-B

## Product Range and Company Overview

### A Complete Suite of Automation Services

Our experienced engineers provide complete support at every stage of your development process, including: conceptualization, analysis, engineering, design, assembly, documentation, validation, and production.



**Custom Automation Components**  
Complete custom engineered solutions



**Custom Control Cabinets**  
Comprehensive engineering support and on-site services



**Complete Systems**  
Shipment, stocking and storage services

### The Broadest Range of Automation Components

With a comprehensive line of more than 30,000 automation components, Festo is capable of solving the most complex automation requirements.



**Electromechanical**  
Electromechanical actuators, motors, controllers & drives



**Pneumatics**  
Pneumatic linear and rotary actuators, valves, and air supply



**PLCs and I/O Devices**  
PLC's, operator interfaces, sensors and I/O devices

### Supporting Advanced Automation... As No One Else Can!

Festo is a leading global manufacturer of pneumatic and electromechanical systems, components and controls for industrial automation, with more than 12,000 employees in 56 national headquarters serving more than 180 countries. For more than 80 years, Festo has continuously elevated the state of manufacturing with innovations and optimized motion control solutions that deliver higher performing, more profitable automated manufacturing and processing equipment. Our dedication to the advancement of automation extends beyond technology to the education and development of current and future automation and robotics designers with simulation tools, teaching programs, and on-site services.

### Quality Assurance, ISO 9001 and ISO 14001 Certifications

Festo Corporation is committed to supply all Festo products and services that will meet or exceed our customers' requirements in product quality, delivery, customer service and satisfaction.

To meet this commitment, we strive to ensure a consistent, integrated, and systematic approach to management that will meet or exceed the requirements of the ISO 9001 standard for Quality Management and the ISO 14001 standard for Environmental Management.



© Copyright 2008, Festo Corporation. While every effort is made to ensure that all dimensions and specifications are correct, Festo cannot guarantee that publications are completely free of any error, in particular typing or printing errors. Accordingly, Festo cannot be held responsible for the same. For Liability and Warranty conditions, refer to our "Terms and Conditions of Sale", available from your local Festo office. All rights reserved. No part of this publication may be reproduced, distributed, or transmitted in any form or by any means, electronic, mechanical, photocopying or otherwise, without the prior written permission of Festo. All technical data subject to change according to technical update.



Printed on recycled paper at New Horizon Graphic, Inc., FSC certified as an environmentally friendly printing plant.



# Festo North America

## Festo Regional Contact Center

5300 Explorer Drive  
Mississauga, Ontario L4W 5G4  
Canada

### USA Customers:

For ordering assistance,

**Call:** 1.800.99.FESTO (1.800.993.3786)

**Fax:** 1.800.96.FESTO (1.800.963.3786)

**Email:** [customer.service@us.festo.com](mailto:customer.service@us.festo.com)

For technical support,

**Call:** 1.866.GO.FESTO (1.866.463.3786)

**Fax:** 1.800.96.FESTO (1.800.963.3786)

**Email:** [product.support@us.festo.com](mailto:product.support@us.festo.com)

### Canadian Customers:

**Call:** 1.877.GO.FESTO (1.877.463.3786)

**Fax:** 1.877.FX.FESTO (1.877.393.3786)

**Email:** [festo.canada@ca.festo.com](mailto:festo.canada@ca.festo.com)

## USA Headquarters

Festo Corporation  
395 Moreland Road  
P.O. Box 18023  
Hauppauge, NY 11788, USA  
[www.festo.com/us](http://www.festo.com/us)

## USA Sales Offices

### Appleton

North 922 Tower View Drive, Suite N  
Greenville, WI 54942, USA

### Boston

120 Presidential Way, Suite 330  
Woburn, MA 01801, USA

### Chicago

1441 East Business Center Drive  
Mt. Prospect, IL 60056, USA

### Dallas

1825 Lakeway Drive, Suite 600  
Lewisville, TX 75057, USA

### Detroit – Automotive Engineering Center

2601 Cambridge Court, Suite 320  
Auburn Hills, MI 48326, USA

### New York

395 Moreland Road  
Hauppauge, NY 11788, USA

### Silicon Valley

4935 Southfront Road, Suite F  
Livermore, CA 94550, USA

## United States



**USA Headquarters, East:** Festo Corp., 395 Moreland Road, Hauppauge, NY 11788

Phone: 1.631.435.0800; Fax: 1.631.435.8026;

Email: [info@festo-usa.com](mailto:info@festo-usa.com)

[www.festo.com/us](http://www.festo.com/us)

## Canada



**Headquarters:** Festo Inc., 5300 Explorer Drive, Mississauga, Ontario L4W 5G4

Phone: 1.905.624.9000; Fax: 1.905.624.9001;

Email: [festo.canada@ca.festo.com](mailto:festo.canada@ca.festo.com)

[www.festo.ca](http://www.festo.ca)

## Mexico



**Headquarters:** Festo Pneumatic, S.A., Av. Ceylán 3, Col. Tequesquahuac,  
54020 Tlalneapantla, Edo. de México

Phone: 011 52 [55] 53 21 66 00; Fax: 011 52 [55] 53 21 66 65;

Email: [festo.mexico@mx.festo.com](mailto:festo.mexico@mx.festo.com)

[www.festo.com/mx](http://www.festo.com/mx)

## Central USA

Festo Corporation  
1441 East Business  
Center Drive  
Mt. Prospect, IL 60056, USA  
Phone: 1.847.759.2600  
Fax: 1.847.768.9480



## Western USA

Festo Corporation  
4935 Southfront Road,  
Suite F  
Livermore, CA 94550, USA  
Phone: 1.925.371.1099  
Fax: 1.925.245.1286



## Festo Worldwide

Argentina Australia Austria Belarus Belgium Brazil Bulgaria Canada Chile China Colombia Croatia Czech Republic Denmark  
Estonia Finland France Germany Great Britain Greece Hong Kong Hungary India Indonesia Iran Ireland Israel Italy Japan Latvia  
Lithuania Malaysia Mexico Netherlands New Zealand Norway Peru Philippines Poland Romania Russia Serbia Singapore  
Slovakia Slovenia South Africa South Korea Spain Sweden Switzerland Taiwan Thailand Turkey Ukraine United States Venezuela

[www.festo.com](http://www.festo.com)