

# Pressure sensors SPBA, for valves

Technical data

## Pressure sensor SPBA

- Pressure sensor with permanently set switching point
- Electrical connection: Plug M12x1 to EN 60947-5-2
- Mounting: Screw-in

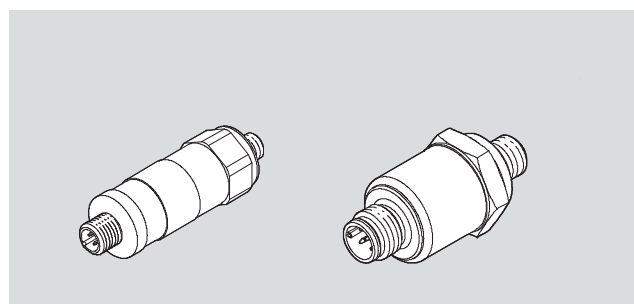

General technical data			
Type		SPBA-P2R-G18-2P-...	SPBA-P2R-G18-W-...
Electrical connection		Plug to EN 60947-5-2, M12x1, 4-pin, round	
Operating voltage range	[V DC]	21.6 ... 26.4	
Max. output current	[mA]	500	1,000
Minimum load current (at 24 V)	[mA]	–	2
Protection against short circuit		Yes	–
Reverse polarity protection		For all electrical connections	–
Type of mounting		Screw-in, 22 mm A/F	Screw-in, 24 mm A/F
Mounting position		Any	
Pneumatic connection		G1/8	
Weight	[g]	50	80
Protection class to EN 60529		IP65	

Materials			
Type		SPBA-P2R-G18-2P-...	SPBA-P2R-G18-W-...
Housing		High-alloy stainless steel	Steel
Plug		PBT	POM
Note on materials		RoHS-compliant	

Operating and environmental conditions			
Type		SPBA-P2R-G18-2P-...	SPBA-P2R-G18-W-...
Operating medium		Compressed air to ISO 8573:2010 [7:4:4]	
Note about the operating/pilot medium		Lubricated operation possible	
Ambient temperature	[°C]	–5 ... +50	
Operating pressure	[bar]	–1 ... +10	
Corrosion resistance class CRC <sup>1)</sup>		4	0
CE marking (see declaration of conformity)		To EU EMC Directive <sup>2)</sup>	–
		To EU Machinery Directive	To EU Machinery Directive

- 1) Corrosion resistance class 4 according to Festo standard 940 070  
Components subject to particularly high corrosion stress. Parts used with aggressive media, e.g. in the food or chemical industry. These applications should be supported with special tests with the media if required.
- 2) For information about the applicability of the component see the manufacturer's EC declaration of conformity at: [www.festo.com](http://www.festo.com) → Support → User documentation.  
If the component is subject to restrictions on usage in residential, office or commercial environments or small businesses, further measures to reduce the emitted interference may be necessary.

## Pressure sensors SPBA, for valves

Technical data

**FESTO**

Input signal/measuring element		
Type	SPBA-P2R-G18-2P-...	SPBA-P2R-G18-W-...
Measured variable	Relative pressure	Relative pressure
Method of measurement	Thin-film metal pressure sensor	Pneumatic/electrical pressure transducer

Electrical data		
Type	SPBA-P2R-G18-2P-...	SPBA-P2R-G18-W-...
Switching output	2x PNP	Contacting
Switching function	Threshold value - fixed hysteresis	
Switching element function	Antivalent	Changeover switch
Switch-on point	[bar]	0.25, permanently set
Max. switch-on point	[bar]	0.40
Min. switch-off point	[bar]	0.05

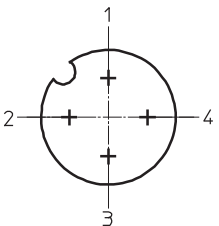
Pin allocation to EN 60947-5-2			
Plug, 4-pin			
M12x1	Pin	SPBA-P2R-G18-2P-...	SPBA-P2R-G18-W-... <sup>1)</sup>
	1	Operating voltage +24 V DC	Operating voltage +24 V DC
	2	N/C contact	N/C contact
	3	0 V	n.c.
	4	N/O contact	N/O contact

1) Allocation applies to PNP switching logic, other connection types possible

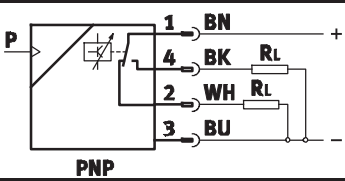
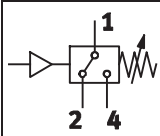
Circuit symbol	
SPBA-P2R-G18-2P-...	SPBA-P2R-G18-W-...
 <p><b>PNP</b></p>	

# Pressure sensors SPBA, for valves

Technical data

## Dimensions

Download CAD Data → [www.festo.com/us/cad](http://www.festo.com/us/cad)

### SPBA-P2R-G18-2P-...

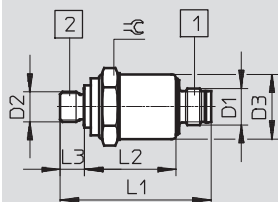

- 1 Plug M12x1
- 2 Pressure supply port G $\frac{1}{8}$

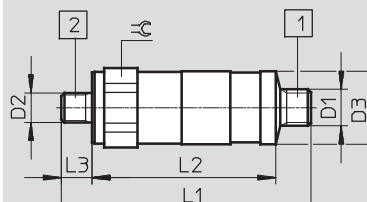

### SPBA-P2R-G18-W-...



- 1 Plug M12x1
- 2 Pressure supply port G $\frac{1}{8}$

Type	D1	D2	D3	L1	L2	L3	≡
SPBA-P2R-G18-2P-M12-0,25X	M12x1	G $\frac{1}{8}$	21.3	49.6	38.1	8	22
SPBA-P2R-G18-W-M12-0,25X	M12x1	G $\frac{1}{8}$	25	82	60.5	10	24

## Ordering data

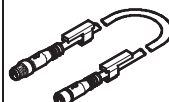
	Description	Part No.	Type
Pressure switch			
	Mechanical pressure switch, pneumatic/electrical pressure transducer, contacting switching output	8000033	SPBA-P2R-G18-W-M12-0,25X
	Electrical pressure switch, thin-film metal pressure sensor, 2xPNP switching output	8000210	SPBA-P2R-G18-2P-M12-0,25X
Connecting cable			
	Socket M12x1, 5-pin; plug M12x1, 4-pin; for connecting pressure sensor	0.5 m	8000208 NEBU-M12G5-K-0.5-M12G4

## Product Range and Company Overview

### A Complete Suite of Automation Services

Our experienced engineers provide complete support at every stage of your development process, including: conceptualization, analysis, engineering, design, assembly, documentation, validation, and production.



**Custom Automation Components**  
Complete custom engineered solutions



**Custom Control Cabinets**  
Comprehensive engineering support and on-site services



**Complete Systems**  
Shipment, stocking and storage services

### The Broadest Range of Automation Components

With a comprehensive line of more than 30,000 automation components, Festo is capable of solving the most complex automation requirements.



**Electromechanical**  
Electromechanical actuators, motors, controllers & drives



**Pneumatics**  
Pneumatic linear and rotary actuators, valves, and air supply



**PLCs and I/O Devices**  
PLC's, operator interfaces, sensors and I/O devices

### Supporting Advanced Automation... As No One Else Can!

Festo is a leading global manufacturer of pneumatic and electromechanical systems, components and controls for industrial automation, with more than 12,000 employees in 56 national headquarters serving more than 180 countries. For more than 80 years, Festo has continuously elevated the state of manufacturing with innovations and optimized motion control solutions that deliver higher performing, more profitable automated manufacturing and processing equipment. Our dedication to the advancement of automation extends beyond technology to the education and development of current and future automation and robotics designers with simulation tools, teaching programs, and on-site services.

### Quality Assurance, ISO 9001 and ISO 14001 Certifications

Festo Corporation is committed to supply all Festo products and services that will meet or exceed our customers' requirements in product quality, delivery, customer service and satisfaction.

To meet this commitment, we strive to ensure a consistent, integrated, and systematic approach to management that will meet or exceed the requirements of the ISO 9001 standard for Quality Management and the ISO 14001 standard for Environmental Management.



© Copyright 2008, Festo Corporation. While every effort is made to ensure that all dimensions and specifications are correct, Festo cannot guarantee that publications are completely free of any error, in particular typing or printing errors. Accordingly, Festo cannot be held responsible for the same. For Liability and Warranty conditions, refer to our "Terms and Conditions of Sale", available from your local Festo office. All rights reserved. No part of this publication may be reproduced, distributed, or transmitted in any form or by any means, electronic, mechanical, photocopying or otherwise, without the prior written permission of Festo. All technical data subject to change according to technical update.



Printed on recycled paper at New Horizon Graphic, Inc., FSC certified as an environmentally friendly printing plant.

# Festo North America

## Festo Regional Contact Center

5300 Explorer Drive  
Mississauga, Ontario L4W 5G4  
Canada

### USA Customers:

For ordering assistance,

**Call:** 1.800.99.FESTO (1.800.993.3786)

**Fax:** 1.800.96.FESTO (1.800.963.3786)

**Email:** [customer.service@us.festo.com](mailto:customer.service@us.festo.com)

For technical support,

**Call:** 1.866.GO.FESTO (1.866.463.3786)

**Fax:** 1.800.96.FESTO (1.800.963.3786)

**Email:** [product.support@us.festo.com](mailto:product.support@us.festo.com)

### Canadian Customers:

**Call:** 1.877.GO.FESTO (1.877.463.3786)

**Fax:** 1.877.FX.FESTO (1.877.393.3786)

**Email:** [festo.canada@ca.festo.com](mailto:festo.canada@ca.festo.com)

## USA Headquarters

Festo Corporation  
395 Moreland Road  
P.O. Box 18023  
Hauppauge, NY 11788, USA  
[www.festo.com/us](http://www.festo.com/us)

## USA Sales Offices

### Appleton

North 922 Tower View Drive, Suite N  
Greenville, WI 54942, USA

### Boston

120 Presidential Way, Suite 330  
Woburn, MA 01801, USA

### Chicago

1441 East Business Center Drive  
Mt. Prospect, IL 60056, USA

### Dallas

1825 Lakeway Drive, Suite 600  
Lewisville, TX 75057, USA

### Detroit – Automotive Engineering Center

2601 Cambridge Court, Suite 320  
Auburn Hills, MI 48326, USA

### New York

395 Moreland Road  
Hauppauge, NY 11788, USA

### Silicon Valley

4935 Southfront Road, Suite F  
Livermore, CA 94550, USA

## United States



**USA Headquarters, East:** Festo Corp., 395 Moreland Road, Hauppauge, NY 11788

Phone: 1.631.435.0800; Fax: 1.631.435.8026;

Email: [info@festo-usa.com](mailto:info@festo-usa.com)

[www.festo.com/us](http://www.festo.com/us)

## Canada



**Headquarters:** Festo Inc., 5300 Explorer Drive, Mississauga, Ontario L4W 5G4

Phone: 1.905.624.9000; Fax: 1.905.624.9001;

Email: [festo.canada@ca.festo.com](mailto:festo.canada@ca.festo.com)

[www.festo.ca](http://www.festo.ca)

## Mexico



**Headquarters:** Festo Pneumatic, S.A., Av. Ceylán 3, Col. Tequesquahuac,  
54020 Tlalneapantla, Edo. de México

Phone: 011 52 [55] 53 21 66 00; Fax: 011 52 [55] 53 21 66 65;

Email: [festo.mexico@mx.festo.com](mailto:festo.mexico@mx.festo.com)

[www.festo.com/mx](http://www.festo.com/mx)

## Central USA

Festo Corporation  
1441 East Business  
Center Drive  
Mt. Prospect, IL 60056, USA  
Phone: 1.847.759.2600  
Fax: 1.847.768.9480



## Western USA

Festo Corporation  
4935 Southfront Road,  
Suite F  
Livermore, CA 94550, USA  
Phone: 1.925.371.1099  
Fax: 1.925.245.1286



## Festo Worldwide

Argentina Australia Austria Belarus Belgium Brazil Bulgaria Canada Chile China Colombia Croatia Czech Republic Denmark  
Estonia Finland France Germany Great Britain Greece Hong Kong Hungary India Indonesia Iran Ireland Israel Italy Japan Latvia  
Lithuania Malaysia Mexico Netherlands New Zealand Norway Peru Philippines Poland Romania Russia Serbia Singapore  
Slovakia Slovenia South Africa South Korea Spain Sweden Switzerland Taiwan Thailand Turkey Ukraine United States Venezuela

[www.festo.com](http://www.festo.com)