

Proximity sensors, round design

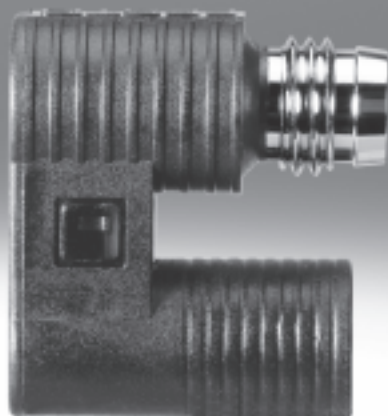

FESTO



Proximity sensors, round design

Product range overview

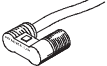
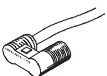
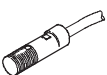
FESTO

Measuring principle	Version	Type	Assembly	Switching element function		Switch output	Electrical connection	
				N/O contact	N/C contact		Cable	Plug
Magneto-inductive	Operating voltage range 10 ... 30 V DC							
		SMT0-4U	Via accessories	■	–	PNP	3-wire	M8x1, 3-pin
				■	–	NPN	3-wire	M8x1, 3-pin
Magnetic reed	Operating voltage range 12 ... 30 V AC/DC							
		SME0-4U	Via accessories	■	–	Contacting	3-wire	M8x1, 3-pin
		CRSME0-4 Corrosion resistant	Via accessories	■	–	Contacting	3-wire	–
Operating voltage range 12 ... 250 V AC/DC								
	SME0-4U	Via accessories	■	–	Contacting	2-wire	–	

Proximity sensors, round design

Product range overview

FESTO

Type	Connection direction		Switching status display via LED	Free of copper and PTFE	➔ Page/Internet
	In-line	Lateral			
Operating voltage range 10 ... 30 V DC					
SMT0-4U	■	–	■	■	6
	■	–	■	–	
Operating voltage range 12 ... 30 V AC/DC					
SME0-4U	■	–	■	■	9
CRSME0-4 Corrosion resistant	■	–	■	–	12
Operating voltage range 12 ... 250 V AC/DC					
SME0-4U	■	–	■	–	9

Proximity sensors, round design

Peripherals overview

FESTO

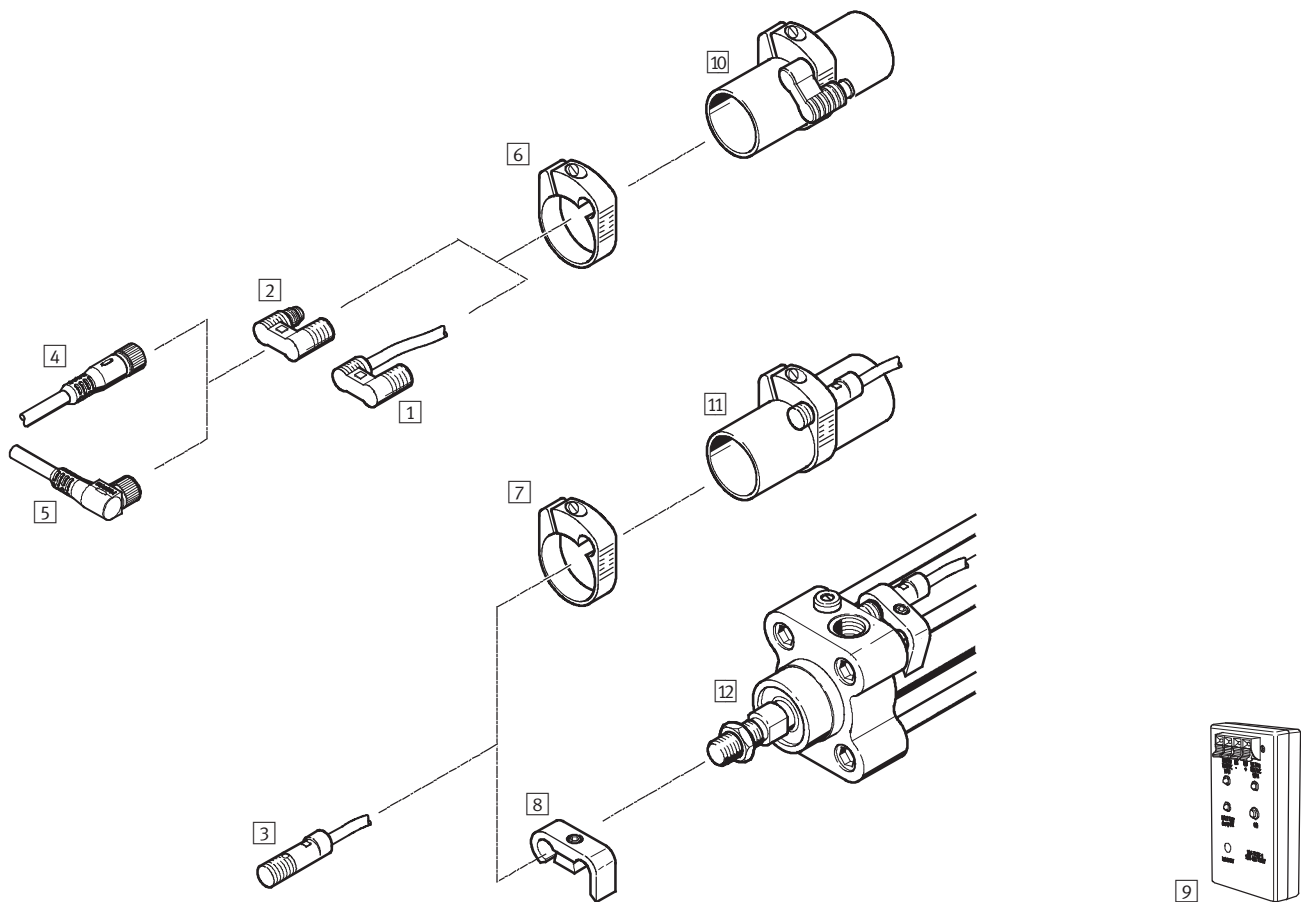

Mounting attachments and accessories		
	Brief description	→ Page/Internet
Proximity sensors		
1	SMT0-4U-K SME0-4U-K	Magneto-inductive, with cable Magnetic reed, with cable
2	SMT0-4U-S SME0-4U-S	Magneto-inductive, with plug M8x1 Magnetic reed, with plug M8x1
3	CRSMEO-4	Magnetic reed, corrosion resistant, with cable
Accessories		
4	Plug socket with cable NEBU-M83GD-...	Straight socket, M8x1, 3-pin
5	Plug socket with cable NEBU-M83WD-...	Angled socket, M8x1, 3-pin
6	Mounting kit SMBR-...	For round cylinders
7	Mounting kit CRSMBR-...	Corrosion resistant, for round cylinders
8	Mounting kit CRSMB-...	Corrosion resistant
9	Sensor tester SM-TEST-1	
Drives		
10	Round cylinders	Ø 8 ... 25 mm
11	Round cylinders CRDG, CRDSW, CRDSNU, stainless steel	Ø 12 ... 63 mm
12	Standard cylinders CRDNG, CRDNGS, stainless steel	Ø 32 ... 125 mm

Proximity sensors, round design

Type codes

FESTO

Drive accessories
Cylinder sensors

10.2

		SMT0	—	4U	—	PS	—	K	—	LED	—	24	—	
Function														
SMT0	Proximity sensor, magneto-inductive													
SME0	Proximity sensor, magnetic reed													
CRSME0	Proximity sensor, magnetic reed, corrosion resistant													
Design														
4U	Round design, U-shaped housing													
4	Round design, straight housing													
Switch output, switching element function														
PS	PNP, N/O contact, 3-wire													
NS	NPN, N/O contact, 3-wire													
	N/O contact, 2- or 3-wire													
Electrical connection, cable length														
K	Cable, 2.5 m													
K5	Cable, 5 m													
S	Plug M8x1													
Switching status display														
LED	Yellow LED													
Rated operating voltage														
24	24 V DC													
230	230 V AC													
Generation														
B	B series													

Proximity sensors SMT0-4U, round design, magneto-inductive

FESTO

Technical data

Function

e.g. PNP, N/O contact, with plug

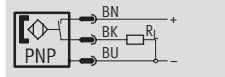

- Magneto-inductive measuring principle

e.g. NPN, N/O contact, with plug

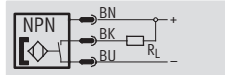

General technical data	
Design	Round
Certification	C-Tick
CE marking (see declaration of conformity)	To EU EMC Directive ¹⁾
Note on materials	Free of copper and PTFE

- 1) For information about the applicability of the component see the manufacturer's EC declaration of conformity at: www.festo.com → Support → User documentation.
If the component is subject to restrictions on usage in residential, office or commercial environments or small businesses, further measures to reduce the emitted interference may be necessary.

Input signal/measuring element	
Measuring principle	Magneto-inductive
Ambient temperature [°C]	−25 ... +70

Switching output		
Type	SMT0-4U-...-K	SMT0-4U-...-S
Switching output	NPN	NPN
	PNP	PNP
Switching element function	N/O contact	N/O contact
Reproducibility of switching point ¹⁾ [mm]	±0.1	±0.1
Switch-on time [ms]	0 ... 5	0.5
Switch-off time [ms]	0 ... 5	0.5
Max. output current [mA]	200	200
Max. contact rating DC [W]	6	6
Voltage drop [V]	2	0 ... 2
Residual current [mA]	0 ... 0.01	0 ... 0.01

- 1) Only applicable to drives secured against rotation.

Output, additional data	
Protection against short circuit	Pulsed
Protection against overloading	Yes

Electronic components	
Operating voltage range DC [V]	10 ... 30
Reverse polarity protection	For all electrical connections

Proximity sensors SMT0-4U, round design, magneto-inductive

FESTO

Technical data

Electromechanical components		
Type	SMT0-4U-...-K	SMT0-4U-...-S
Electrical connection	Cable, 3-wire	Plug M8x1, 3-pin
Connection direction	In-line	–
Max. tightening torque, plug [Nm]	–	0.3
Cable length [m]	2.5	–
Cable characteristics	Standard	–
Cable sheath materials	PVC	–

Mechanical components		
Type	SMT0-4U-...-K	SMT0-4U-...-S
Type of mounting	Via accessories	
Max. tightening torque [Nm]	0.8	0.8
Product weight [g]	70	6
Housing materials	PET	PET
	–	PA
	–	PUR

Display/operation	
Switching status display	Yellow LED

Immissions/emissions		
Type	SMT0-4U-...-K	SMT0-4U-...-S
Ambient temperature with flexible cable installation [°C]	–5 ... +70	–
Protection class	IP67	
Corrosion resistance class CRC ¹⁾	2	

1) Corrosion resistance class 2 according to Festo standard 940 070

Components subject to moderate corrosion stress. Externally visible parts with primarily decorative surface requirements which are in direct contact with a normal industrial environment or media such as coolants or lubricating agents.

Dimensions Download CAD Data → www.festo.com/us/cad

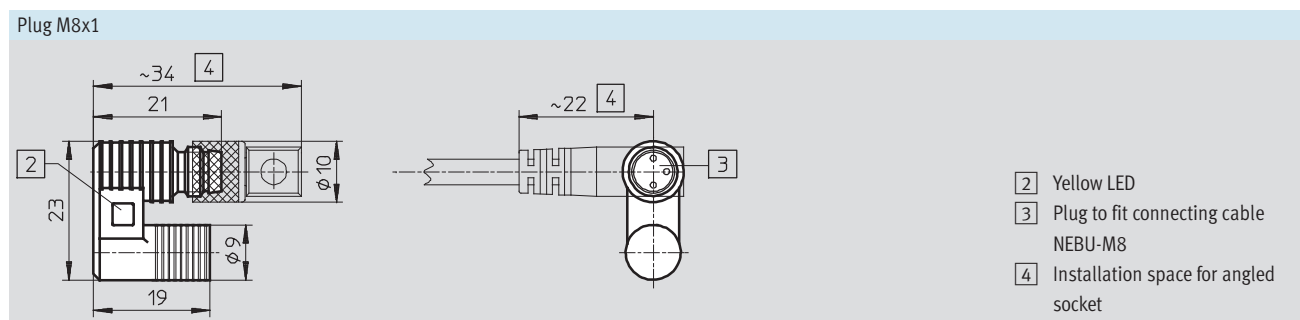
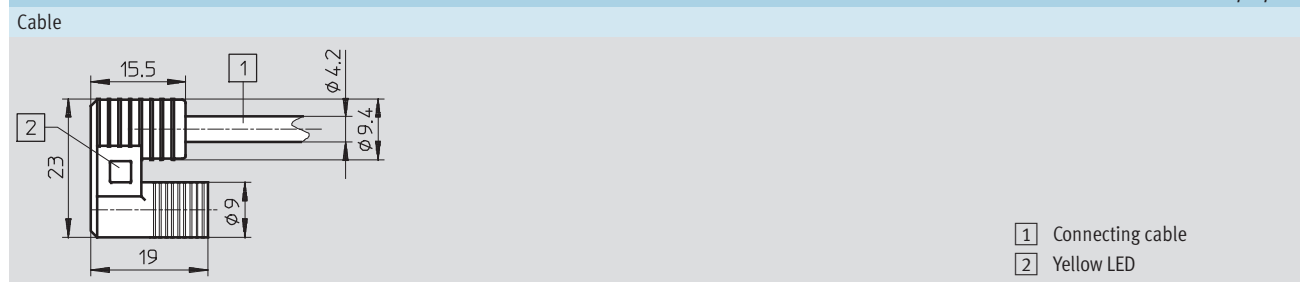

Proximity sensors SMT0-4U, round design, magneto-inductive

Technical data

FESTO

Ordering data						
	Switching output	Electrical connection		Cable length [m]	Part No.	Type
		Cable	Plug M8x1			
	N/O contact					
	PNP	3-wire	–	2.5	152836	SMT0-4U-PS-K-LED-24
		–	3-pin	–	152742	SMT0-4U-PS-S-LED-24
	NPN	3-wire	–	2.5	152837	SMT0-4U-NS-K-LED-24
		–	3-pin	–	152743	SMT0-4U-NS-S-LED-24

Proximity sensors SMEO-4U, round design, magnetic reed

FESTO

Technical data

Function

e.g. N/O contact, 3-wire, with cable

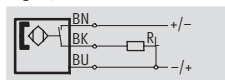

e.g. N/O contact, 2-wire, with cable

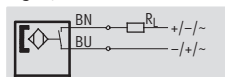

- Magnetic reed measuring principle



General technical data		
Type	SMEO-4U-...-24	SMEO-4U-...-230
Design	Round	Round
Conforms to	–	EN 60947-5-2
Certification	C-Tick	C-Tick
CE marking (see declaration of conformity)	To EU EMC Directive ¹⁾ –	To EU EMC Directive ¹⁾ To EU Low Voltage Directive
Note on materials	Free of copper and PTFE	Free of copper and PTFE

- 1) For information about the applicability of the component see the manufacturer's EC declaration of conformity at: www.festo.com → Support → User documentation.
If the component is subject to restrictions on usage in residential, office or commercial environments or small businesses, further measures to reduce the emitted interference may be necessary.

Input signal/measuring element	
Measuring principle	Magnetic reed
Ambient temperature [°C]	–20 ... +60

Switching output		
Type	SMEO-4U-...-24	SMEO-4U-...-230
Switching output	Contacting, bipolar –	Contacting, bipolar Without LED function
Switching element function	N/O contact	N/O contact
Reproducibility of switching point ¹⁾ [mm]	±0.1	±0.1
Switch-on time [ms]	0 ... 0.5	0 ... 2
Switch-off time [ms]	0.03	0.05
Max. switching frequency [Hz]	–	500
Max. output current [mA]	500	500
Max. output current DC [mA]	–	120
Max. output current AC [mA]	–	250
Max. contact rating DC [W]	10	10
Max. contact rating AC [VA]	–	10
Voltage drop [V]	–	0 ... 4.5

- 1) Only applicable to drives secured against rotation.

Output, additional data	
Protection against short circuit	No
Protection against overloading	No

Electronic components		
Type	SMEO-4U-...-24	SMEO-4U-...-230
Operating voltage range DC [V]	12 ... 27	12 ... 250
Operating voltage range AC [V]	–	12 ... 250
Reverse polarity protection	No	No

Proximity sensors SMEO-4U, round design, magnetic reed

Technical data

FESTO

Electromechanical components			
Type	SMEO-4U-K-...-24	SMEO-4U-S-...-24	SMEO-4U-K-...-230
Electrical connection	Cable, 3-wire	Plug M8x1, 3-pin	Cable, 2-wire
Connection direction	–	–	In-line
Cable length [m]	2.5	–	2.5
	5		–
Cable sheath materials	PVC	–	PVC

Mechanical components		
Type	SMEO-4U-...-24	SMEO-4U-...-230
Type of mounting	Via accessories	
Tightening torque [Nm]	–	0.8
Housing materials	PET	PET
	–	TPE-O

Display/operation	
Switching status display	Yellow LED

Immissions/emissions			
Type	SMEO-4U-K-...-24	SMEO-4U-S-...-24	SMEO-4U-...-230
Ambient temperature with flexible cable installation [°C]	–5 ... +60	–	–
Protection class	IP67		
Surge capacity [kV]	–	–	4
Degree of contamination	–	–	3

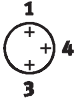
Pin allocation to EN 60947-5-2			
M8x1, 3-pin			
N/O contact			
	Pin	Wire colour	Allocation
	1	Brown	+
	3	Blue	–
	4	Black	Output

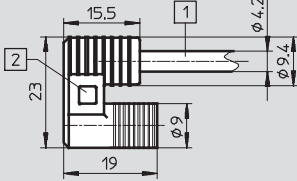
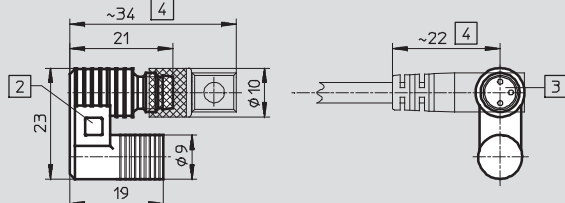
Dimensions		Download CAD Data → www.festo.com/us/cad	
SMEO-4U-K – Cable		SMEO-4U-S – Plug M8x1	
			
1	Connecting cable	2	Yellow LED
2	Yellow LED	3	Plug to fit connecting cable NEBU-M8
		4	Installation space for angled socket

Proximity sensors SMEO-4U, round design, magnetic reed

Technical data

FESTO

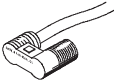
Ordering data							
	Electrical connection		Cable length [m]	Switching status display	Product weight [g]	Part No.	Type
	Cable	Plug M8x1					
	N/O contact						
	Operating voltage range 12 ... 27 V DC						
	3-wire	–	2.5	■	70	36198	SMEO-4U-K-LED-24
			5	■	130	175401	SMEO-4U-K5-LED-24
	–	3-pin	–	■	6	151526	SMEO-4U-S-LED-24-B
	Operating voltage range 12 ... 250 V AC/DC						
	2-wire	–	2.5	■	70	150011	SMEO-4U-K-LED-230

Proximity sensors CRSMEO-4, round design, magnetic reed

FESTO

Technical data

Function

e.g. N/O contact, 3-wire, with cable

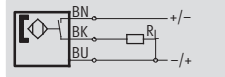

- Corrosion-resistant
- Magnetic reed measuring principle



General technical data	
Design	Round
Certification	C-Tick
CE marking (see declaration of conformity)	To EU EMC Directive ¹⁾
Note on materials	Free of copper and PTFE

- 1) For information about the applicability of the component see the manufacturer's EC declaration of conformity at: www.festo.com → Support → User documentation.
If the component is subject to restrictions on usage in residential, office or commercial environments or small businesses, further measures to reduce the emitted interference may be necessary.

Input signal/measuring element	
Measuring principle	Magnetic reed
Ambient temperature [°C]	−20 ... +60

Switching output	
Switching output	Contacting, bipolar
Switching element function	N/O contact
Reproducibility of switching point [mm]	±0.1
Switch-on time [ms]	0 ... 0.5
Switch-off time [ms]	0.03
Max. output current [mA]	500
Max. contact rating DC [W]	10

Output, additional data	
Protection against short circuit	No

Electronic components	
Operating voltage range DC [V]	12 ... 30
Reverse polarity protection	No

Electromechanical components	
Electrical connection	Cable, 3-wire
Cable length [m]	2.5
Cable sheath materials	TPE-O

Mechanical components	
Type of mounting	Via accessories
Product weight [g]	70
Housing	PP

Display/operation	
Switching status display	Yellow LED

Proximity sensors CRSMEO-4, round design, magnetic reed

FESTO

Technical data

Immissions/emissions	
Ambient temperature with flexible cable installation	–5 ... +60
Protection class	IP67

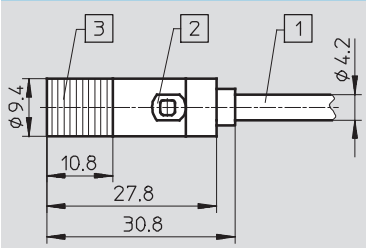
Dimensions	Download CAD Data → www.festo.com/us/cad
 <div style="float: right;"> <p>1 Connecting cable</p> <p>2 Yellow LED</p> <p>3 Clamping range</p> </div>	

Ordering data			
	Electrical connection	Cable length [m]	Part No. Type
	N/O contact		
	Corrosion-resistant		
	Cable, 3-wire	2.5	161775 CRSMEO-4-K-LED-24

Proximity sensors, round design

Accessories

FESTO

Mounting kit SMBR

Material:
Polyacetate

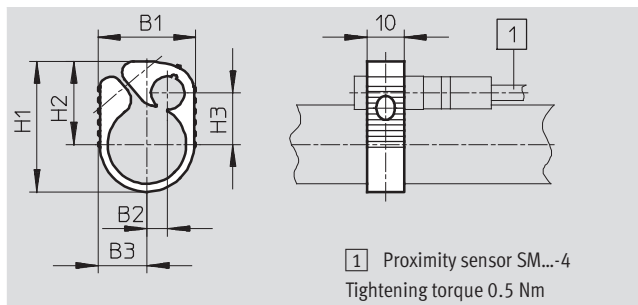

Dimensions and ordering data								
For piston Ø	B1	B2	B3	H1	H2	H3	Part No.	Type
8	21	–	14	23.5	16.5	9	19272	SMBR-8
10	22	0.5	14	26	18.5	10	19273	SMBR-10
12	22	4	11	28.5	20	10.2	19274	SMBR-12
16	22.5	4	11.5	33.5	22.5	12.4	19275	SMBR-16
20	26.5	5.5	13.5	35.5	22.5	14	19276	SMBR-20
25	31.5	7.5	16	40.5	25	16	19277	SMBR-25

Mounting kit CRSMBR

Material:
Polypropylene

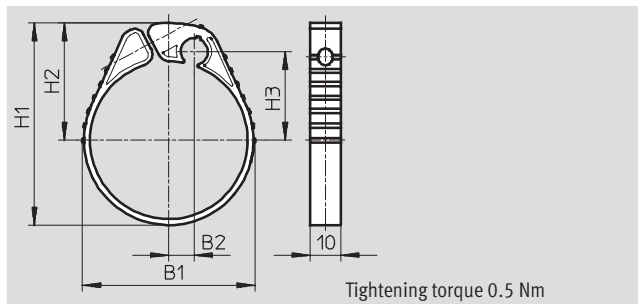

Dimensions and ordering data							
For piston Ø	B1	B2	H1	H2	H3	Part No.	Type
12	22	4.1	28.6	20	10.2	164581	CRSMBR-12
16	22.3	4	33.2	22.5	12.4	164582	CRSMBR-16
20	26.5	5.6	35.25	22.5	14	164583	CRSMBR-20
25	31.5	7.4	40.2	25	16	164584	CRSMBR-25
32	38.6	7.9	47.8	29	19.7	163888	CRSMBR-32
40	46.6	8.1	55.8	33	23.8	163889	CRSMBR-40
50	57.4	8.2	67.2	39	29.5	163890	CRSMBR-50
63	70.4	8.2	80.8	45.9	36.2	163891	CRSMBR-63

Proximity sensors, round design

Accessories

FESTO

Mounting kit CRSMB

Material:

High-alloy stainless steel

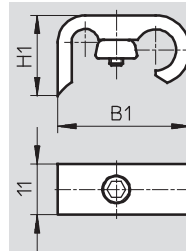

Dimensions and ordering data				
For piston Ø	B1	H1	Part No.	Type
32	29	17.6	161763	CRSMB-32
40	29	15.1	161764	CRSMB-40
50	31.1	17.4	161765	CRSMB-50
63	31.1	18.1	161766	CRSMB-63
80	33	24.2	161767	CRSMB-80
100	33	27.5	161768	CRSMB-100
125	36.5	31.1	185365	CRSMB-125

Product Range and Company Overview

A Complete Suite of Automation Services

Our experienced engineers provide complete support at every stage of your development process, including: conceptualization, analysis, engineering, design, assembly, documentation, validation, and production.



Custom Automation Components
Complete custom engineered solutions



Custom Control Cabinets
Comprehensive engineering support and on-site services



Complete Systems
Shipment, stocking and storage services

The Broadest Range of Automation Components

With a comprehensive line of more than 30,000 automation components, Festo is capable of solving the most complex automation requirements.



Electromechanical
Electromechanical actuators, motors, controllers & drives



Pneumatics
Pneumatic linear and rotary actuators, valves, and air supply



PLCs and I/O Devices
PLC's, operator interfaces, sensors and I/O devices

Supporting Advanced Automation... As No One Else Can!

Festo is a leading global manufacturer of pneumatic and electromechanical systems, components and controls for industrial automation, with more than 12,000 employees in 56 national headquarters serving more than 180 countries. For more than 80 years, Festo has continuously elevated the state of manufacturing with innovations and optimized motion control solutions that deliver higher performing, more profitable automated manufacturing and processing equipment. Our dedication to the advancement of automation extends beyond technology to the education and development of current and future automation and robotics designers with simulation tools, teaching programs, and on-site services.

Quality Assurance, ISO 9001 and ISO 14001 Certifications

Festo Corporation is committed to supply all Festo products and services that will meet or exceed our customers' requirements in product quality, delivery, customer service and satisfaction.

To meet this commitment, we strive to ensure a consistent, integrated, and systematic approach to management that will meet or exceed the requirements of the ISO 9001 standard for Quality Management and the ISO 14001 standard for Environmental Management.

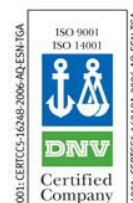

© Copyright 2008, Festo Corporation. While every effort is made to ensure that all dimensions and specifications are correct, Festo cannot guarantee that publications are completely free of any error, in particular typing or printing errors. Accordingly, Festo cannot be held responsible for the same. For Liability and Warranty conditions, refer to our "Terms and Conditions of Sale", available from your local Festo office. All rights reserved. No part of this publication may be reproduced, distributed, or transmitted in any form or by any means, electronic, mechanical, photocopying or otherwise, without the prior written permission of Festo. All technical data subject to change according to technical update.



Printed on recycled paper at New Horizon Graphic, Inc., FSC certified as an environmentally friendly printing plant.

Festo North America

Festo Regional Contact Center

5300 Explorer Drive
Mississauga, Ontario L4W 5G4
Canada

USA Customers:

For ordering assistance,

Call: 1.800.99.FESTO (1.800.993.3786)

Fax: 1.800.96.FESTO (1.800.963.3786)

Email: customer.service@us.festo.com

For technical support,

Call: 1.866.GO.FESTO (1.866.463.3786)

Fax: 1.800.96.FESTO (1.800.963.3786)

Email: product.support@us.festo.com

Canadian Customers:

Call: 1.877.GO.FESTO (1.877.463.3786)

Fax: 1.877.FX.FESTO (1.877.393.3786)

Email: festo.canada@ca.festo.com

USA Headquarters

Festo Corporation
395 Moreland Road
P.O. Box 18023
Hauppauge, NY 11788, USA
www.festo.com/us

USA Sales Offices

Appleton

North 922 Tower View Drive, Suite N
Greenville, WI 54942, USA

Boston

120 Presidential Way, Suite 330
Woburn, MA 01801, USA

Chicago

1441 East Business Center Drive
Mt. Prospect, IL 60056, USA

Dallas

1825 Lakeway Drive, Suite 600
Lewisville, TX 75057, USA

Detroit – Automotive Engineering Center

2601 Cambridge Court, Suite 320
Auburn Hills, MI 48326, USA

New York

395 Moreland Road
Hauppauge, NY 11788, USA

Silicon Valley

4935 Southfront Road, Suite F
Livermore, CA 94550, USA

United States



USA Headquarters, East: Festo Corp., 395 Moreland Road, Hauppauge, NY 11788

Phone: 1.631.435.0800; Fax: 1.631.435.8026;

Email: info@festo-usa.com

www.festo.com/us

Canada



Headquarters: Festo Inc., 5300 Explorer Drive, Mississauga, Ontario L4W 5G4

Phone: 1.905.624.9000; Fax: 1.905.624.9001;

Email: festo.canada@ca.festo.com

www.festo.ca

Mexico



Headquarters: Festo Pneumatic, S.A., Av. Ceylán 3, Col. Tequesquahuac,
54020 Tlalneapantla, Edo. de México

Phone: 011 52 [55] 53 21 66 00; Fax: 011 52 [55] 53 21 66 65;

Email: festo.mexico@mx.festo.com

www.festo.com/mx

Central USA

Festo Corporation
1441 East Business
Center Drive
Mt. Prospect, IL 60056, USA
Phone: 1.847.759.2600
Fax: 1.847.768.9480



Western USA

Festo Corporation
4935 Southfront Road,
Suite F
Livermore, CA 94550, USA
Phone: 1.925.371.1099
Fax: 1.925.245.1286



Festo Worldwide

Argentina Australia Austria Belarus Belgium Brazil Bulgaria Canada Chile China Colombia Croatia Czech Republic Denmark
Estonia Finland France Germany Great Britain Greece Hong Kong Hungary India Indonesia Iran Ireland Israel Italy Japan Latvia
Lithuania Malaysia Mexico Netherlands New Zealand Norway Peru Philippines Poland Romania Russia Serbia Singapore
Slovakia Slovenia South Africa South Korea Spain Sweden Switzerland Taiwan Thailand Turkey Ukraine United States Venezuela

www.festo.com