

Flow sensors SFAM

FESTO



Flow sensors SFAM

Key features

FESTO

At a glance

Threaded mounting of individual device with stabilising zone

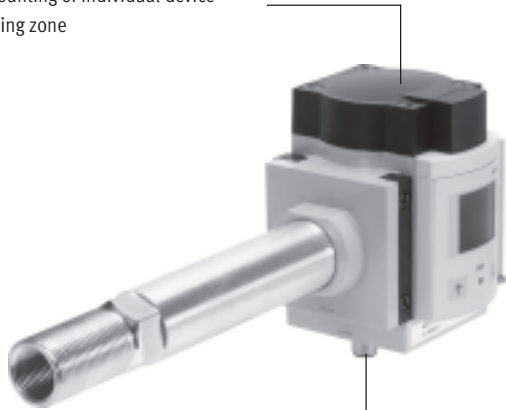

Central electrical connection via M12 plug

Can be combined with MS6 or MS9 series service units



- Illuminated LCD display with blue background and white 9-segment display
- Bar graph visualises the current measured value
- Switching point-dependent colour change

Compact and capable of high flow rates

This modular flow sensor can operate either as a standalone unit or can be easily combined with the MS series service units.

The sensor provides:

- Absolute flow rate information
 - with threshold values and
 - convenient switching point adjustment via a display
- Cumulative air consumption measurement
- Patented – adjustable consumption-based switching pulse for cumulative air consumption measurement via the switching output

Systematically more reliable

The sensor covers a large measuring range with a specified accuracy thanks to its high dynamic response of 1:100.

It can provide precise information even when flow conditions are fluctuating and unreliable.

Easy to operate

- A large, illuminated LCD display increases the operational safety and makes the currently displayed flow rate or consumption values easy to read
- Measured values outside the measuring range are visualised: flow rates are shown flashing
- Switching outputs (NPN/PNP) can be switched over via the menu
- Values that fall below or exceed the threshold values can also be identified from a distance or if the sensor is in an inaccessible location by means of the display changing colour
- Simple checking of the current sensor settings in SHOW mode
- Simple switching between consumption and flow rate indication
- Values shown on the display:
 - can be shown for different standard conditions (DIN 1343, ISO 2533, ISO 6358)
 - can be filtered/averaged independently of the analogue output in the case of high measuring dynamics

Convenient

- Plug and work solution
- Quick and easy menu prompting
- Fast commissioning thanks to easy-to-use, intuitive teach-in function
- Manual consumption measurement with start/stop and reset functionality

Easy to combine

With MS6 or MS9 series service unit combination thanks to innovative prism clamping technology. This saves additional installation time.

Flexible installation

The SFAM has an extremely compact, space-saving design optimised for flow performance.

Right or left?

The fluid stream of the unidirectional flow sensor can be selected: either from left to right or from right to left.

Flow sensors SFAM

Peripherals overview

SFAM-62-...-M for manifold assembly in MS6 series service unit combination
with laminar flow cartridge

SFAM-62-...-T/-W for individual assembly
with connecting plates and stabilising zone

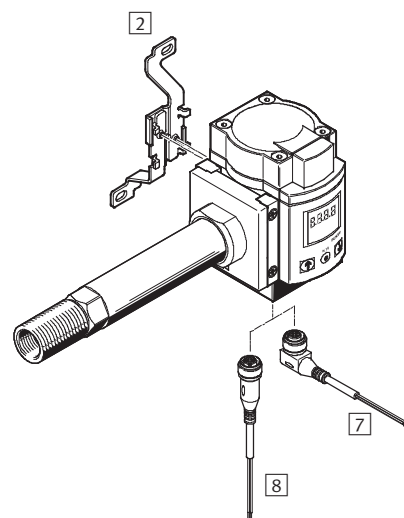
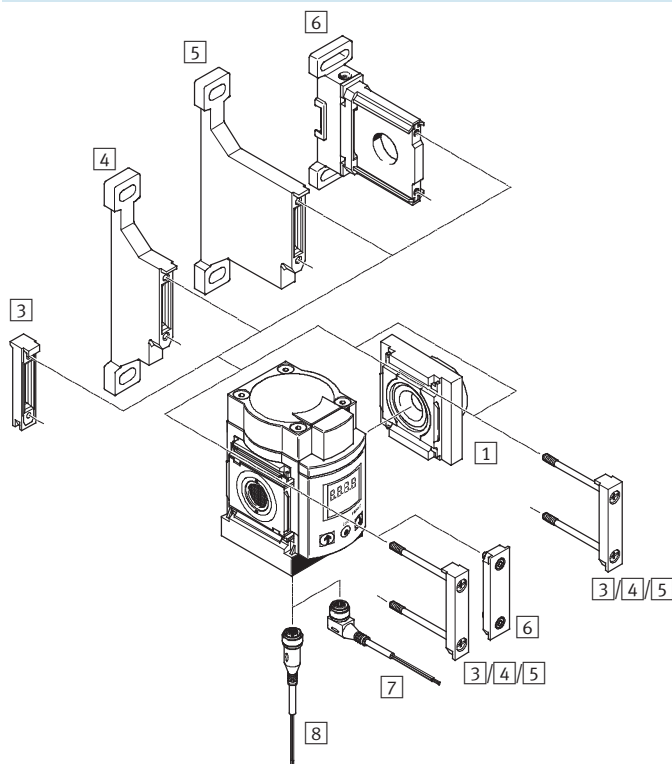

Mounting attachments and accessories		In MS6 series service unit combination	Individual device	→ Page/Internet
1	Connecting plate MS6-AG...	■	■ Included in the scope of delivery	ms6-ag
2	Mounting bracket MS6-WB	–	■ Included in the scope of delivery with mounting type -W	ms6-wb
3	Module connector MS6-MV	■	–	ms6-mv
4	Mounting bracket MS6-WP	■	–	ms6-wp
5	Mounting bracket MS6-WPB	■	–	ms6-wpb
6	Mounting bracket MS6-WPM	■	–	ms6-wpm
7	Connecting cable NEBU-M12W5, angled socket	■	■	14
8	Connecting cable NEBU-M12G5, straight socket	■	■	14

Note

Additional accessories:

- Module connector for combination with size MS4/MS6 or size MS9
→ Internet: amv, rmv, armv
- Adapter for mounting on profiles
→ Internet: ipm-80, ipm-40-80, ipm-80-80

Flow sensors SFAM

Peripherals overview

FESTO

SFAM-90-...-M for manifold assembly in MS9 series service unit combination
with laminar flow cartridge

SFAM-90-...-T for individual assembly
with connecting plates and stabilising zone

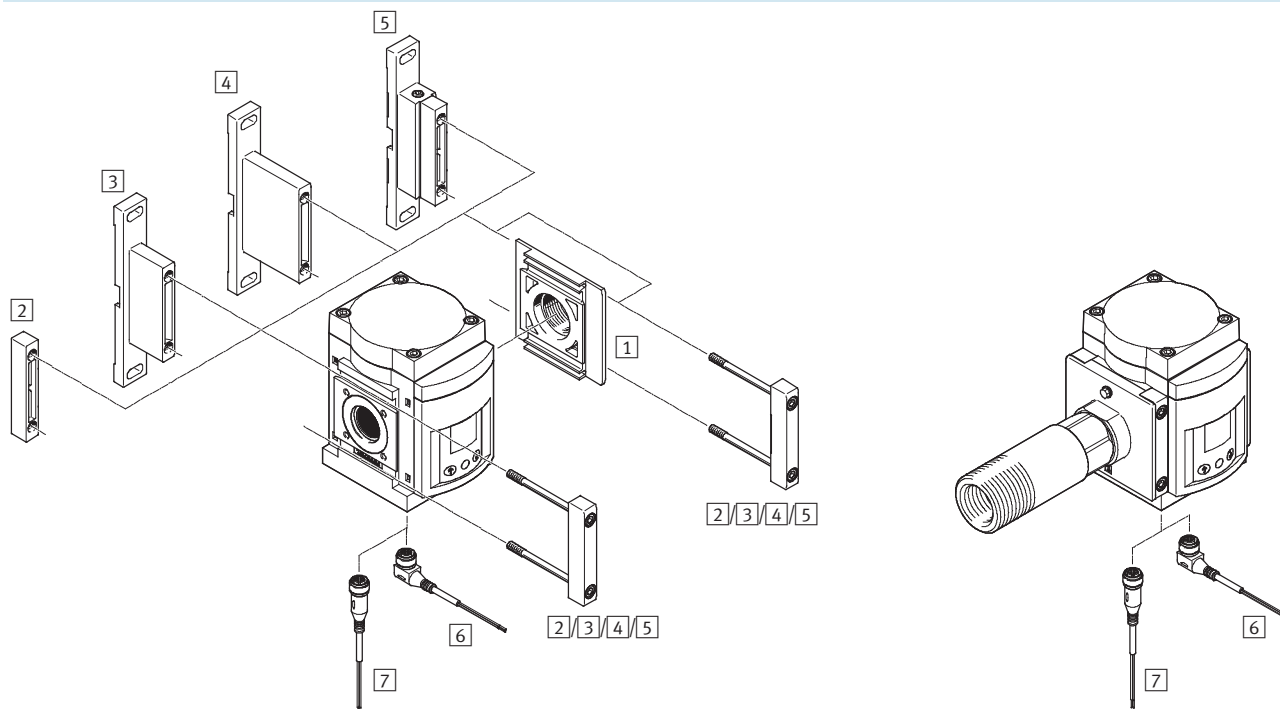

Mounting attachments and accessories			
	In MS9 series service unit combination	Individual device	→ Page/Internet
1 Connecting plate MS9-AG...	■	■ Included in the scope of delivery	ms9-ag
2 Module connector MS9-MV	■	–	ms9-mv
3 Mounting bracket MS9-WP	■	–	ms9-wp
4 Mounting bracket MS9-WPB	■	–	ms9-wpb
5 Mounting bracket MS9-WPM	■	–	ms9-wpm
6 Connecting cable NEBU-M12W5, angled socket	■	■	14
7 Connecting cable NEBU-M12G5, straight socket	■	■	14

Note

Additional accessories:

- Module connector for combinations with size MS6, MS9 or MS12

→ Internet: rmv, armv

Flow sensors SFAM

Type codes

		SFAM	-	62	-	1000	L	-	T	G12	-	2SA	-	M12
Type														
SFAM	Flow sensor													
Grid dimension														
62	Grid dimension 62 mm													
90	Grid dimension 90 mm													
Flow measuring range [l/min]														
SFAM-62														
1000	Max. 1,000													
3000	Max. 3,000													
5000	Max. 5,000													
SFAM-90														
5000	Max. 5,000													
10000	Max. 10,000													
15000	Max. 15,000													
Flow input														
L	Unidirectional, from left to right													
Type of mounting														
M	Manifold assembly													
T	Threaded mounting													
Pneumatic connection														
SFAM-62														
G12	Female thread G1½													
SFAM-90-5000L														
G1	Female thread G1													
SFAM-90-10000L/15000L														
G1½	Female thread G1½													
Electrical output														
2SA	2x PNP or NPN, 1 analogue output 4 ... 20 mA													
2SV	2x PNP or NPN, 1 analogue output 0 ... 10 V													
Electrical connection														
M12	Straight plug, M12x1, 5-pin													

Additional variants can be ordered using the modular product system → 13

- Flow input
- Type of mounting
- Pneumatic connection
- Electrical accessories
- EU certification (ATEX)

Flow sensors SFAM

Technical data

Function

Current output 2SA

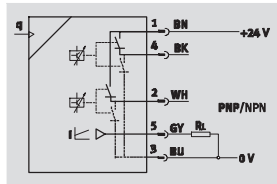

Voltage output 2SV

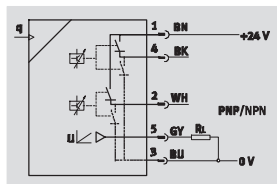

- Analogue output 0 ... 10 V, adjustable switching outputs 2x PNP or 2x NPN
- Analogue output 4 ... 20 mA, adjustable switching outputs 2x PNP or 2x NPN
- Freely selectable pulse output for consumption measurement

Flow rate

10 ... 1,000 l/min
30 ... 3,000 l/min
50 ... 5,000 l/min
100 ... 10,000 l/min
150 ... 15,000 l/min

Temperature range

0 ... +50 °C

Pressure

0 ... 16 bar

- Analogue filter for setting the rise time
- Digital filter for smoothing the display values

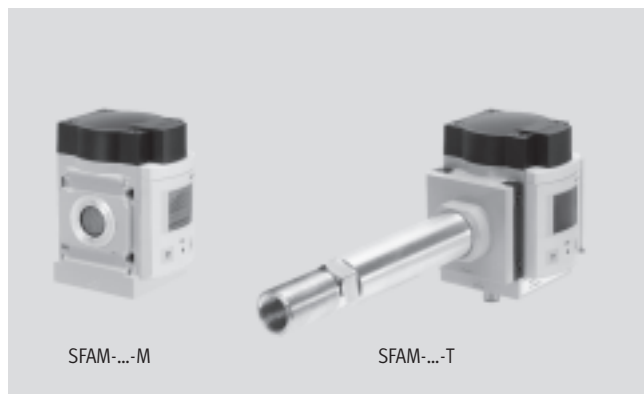

Note

To comply with the specified accuracies, the SFAM must be supplied via the following connections:

- SFAM-62-...-M via a pneumatic connection of at least G $\frac{1}{2}$,
- SFAM-90-...-M via a pneumatic connection of at least G $\frac{3}{4}$.
- SFAM-62-...-T/W via a connection with an inside diameter of at least 10 mm, SFAM-90-...-T via a connection with an inside diameter of at least 20 mm.

Note

When using a filter regulator MS-LFR or a pressure regulator MS-LR, a branching module MS6-FRM- $\frac{1}{2}$ (with size MS6) or MS9-FRM-G (with size MS9) must be installed between the filter regulator or pressure regulator and the (downstream) flow sensor SFAM in order to maintain the specified accuracies.

General technical data	
Certification	C-Tick cULus recognized (OL)
CE marking (see declaration of conformity)	To EU EMC Directive ¹⁾
Note on materials	RoHS-compliant

1) For information about the applicability of the component see the manufacturer's EC declaration of conformity at: www.festo.com → Support → User documentation.
If the component is subject to restrictions on usage in residential, office or commercial environments or small businesses, further measures to reduce the emitted interference may be necessary.

ATEX	
EU certification	EX2
ATEX category for gas	II 3G
Explosion ignition protection type for gas	Ex nA II T5 X
ATEX category for dust	II 3D
Explosion ignition protection type for dust	Ex tD A22 IP54 T80°C X
Explosion-proof temperature rating	0 °C ≤ Ta ≤ +50 °C
CE marking (see declaration of conformity)	To EU Explosion Protection Directive (ATEX)

Flow sensors SFAM

Technical data

Input signal/measuring element						
Type	SFAM-62			SFAM-90		
Flow measuring range	-1000	-3000	-5000	-5000	-10000	-15000
Measured variable	Flow rate, consumption					
Direction of flow	-L	Unidirectional P1 → P2				
	-R	Unidirectional P2 ← P1				
Measuring principle	Thermal					
Flow measuring range	[l/min]	10 ... 1,000	30 ... 3,000	50 ... 5,000	50 ... 5,000	100 ... 10,000
Operating pressure	[bar]	0 ... 16				
Nominal pressure	[bar]	6				
Operating medium	Air quality class 5:4:3 to DIN ISO 8573-1					
	Nitrogen					
Temperature of medium	[°C]	0 ... +50				
Ambient temperature	[°C]	0 ... +50				
Nominal temperature	[°C]	23				

Output, general ^{1), 2)}		
Accuracy of zero point in ±%FS	[%FS]	0.3
Accuracy of margin in ±%FS	[%FS]	3
Repetition accuracy of zero point in ±%FS	[%FS]	0.2
Repetition accuracy of margin in ±%FS	[%FS]	0.8
Temperature coefficient of margin in ±%FS/K	[%FS/K]	Typically 0.1
Pressure dependence of margin in ±%FS/bar	[%FS/bar]	0.5

1) Accuracy with nominal conditions (6 bar, 23 °C and horizontal installation position)

2) % FS = % of the measuring range final value (full scale)

Switching output	
Switching output	2x PNP or 2x NPN, adjustable
Switching function	Window comparator or threshold value comparator, adjustable
Switching element function	N/C or N/O contact, adjustable
Switch-on time	Adjustable (factory setting: approx. 60 ms)
Switch-off time	Adjustable (factory setting: approx. 60 ms)
Max. output current	[mA] 100
Voltage drop	[V] Max. 1.5
Inductive protective circuit	Adapted to MZ, MY, ME coils

Analogue output						
Type	SFAM-62			SFAM-90		
Flow measuring range	-1000	-3000	-5000	-5000	-10000	-15000
Characteristic curve for flow rate	[l/min]	0 ... 1,000	0 ... 3,000	0 ... 5,000	0 ... 10,000	0 ... 15,000
Output characteristic curve for current	[mA]	4 ... 20				
Output characteristic curve for voltage	[V]	0 ... 10				
Rise time	[ms]	Possible settings: 15, 30, 60 (factory setting), 125, 250, 500, 999				
Max. load resistance at current output	[ohms]	500				
Min. load resistance at voltage output	[kohms]	10				

Output, additional data	
Protection against short circuit	Yes
Protection against overloading	Yes

Flow sensors SFAM

Technical data

FESTO

Electronic components		
Operating voltage range DC	[V]	15 ... 30
Reverse polarity protection		For all electrical connections

Electromechanical components		
Electrical connection		Straight plug, M12x1, 5-pin
Max. connecting cable length	[m]	30

Mechanical components								
Type	SFAM-62				SFAM-90			
Type of mounting	-M	-TG12/-WG12	-TN12/-WN12		-M	-TG1	-TN1	-TG112 -TN112
Mounting position	Horizontal ±5°							
Pneumatic connection	–	G1/2	NPT1/2		–	G1	NPT1	G1½ NPT1½
Product weight	[g]	600	1,100	1,100	1,500	2,400	2,400	2,750 2,750
Housing materials	PA-reinforced, die-cast aluminium							

Display/operation						
Type	SFAM-62			SFAM-90		
Flow measuring range	-1000	-3000	-5000	-5000	-10000	-15000
Display type	Illuminated LCD, blue					
Displayable units	l/min, scfm, l, m³, scf					
Setting range for flow rate threshold values	[%FS] 1 ... 100					
Setting range for consumption pulse threshold values	[l]	3 ... 19,999	10 ... 19,999	15 ... 19,999	15 ... 19,999	30 ... 19,999 50 ... 19,999
	[m³]	1 ... 19,999				
	[scf]	0.1 ... 1,999.9	0.4 ... 1,999.9	0.5 ... 1,999.9	0.5 ... 1,999.9	1 ... 1,999.9 2 ... 1,999.9
Hysteresis setting range	[%FS]	0 ... 90				

Immissions/emissions						
Type	SFAM-62			SFAM-90		
Flow measuring range	-1000	-3000	-5000	-5000	-10000	-15000
Storage temperature	[°C] -20 ... +80					
Protection class	IP65					
Pressure drop at 50 %FS flow rate and 6 bar with mounting type -M	[mbar] 0 ... 100	0 ... 100	0 ... 100	0 ... 40	0 ... 100	0 ... 200
Pressure drop at 50 %FS flow rate with mounting type -T/-W	[mbar] 0 ... 100	0 ... 100	0 ... 100	0 ... 100	0 ... 100	0 ... 100
Electrical protection class	III					
Corrosion resistance class CRC ¹⁾	2					

1) Corrosion resistance class 2 according to Festo standard 940 070

Components subject to moderate corrosion stress. Externally visible parts with primarily decorative surface requirements which are in direct contact with a normal industrial environment or media such as coolants or lubricating agents.

Flow sensors SFAM

Technical data

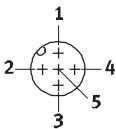
Pin allocation		
Plug M12x1, 5-pin	Pin	Meaning
	1	Operating voltage +24 V DC
	2	Binary output B
	3	0 V
	4	Binary output A
	5	Analogue output C

Flow measuring range¹⁾ q_n as a function of operating pressure p_1

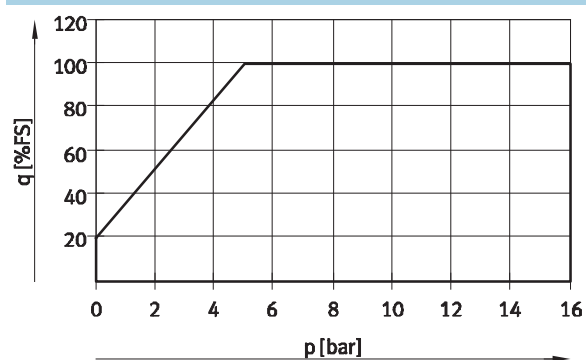

- 1) For an operating pressure of more than 5 bar, the flow sensor can determine measured values with the specified accuracy over the entire measuring range. For an operating pressure below 5 bar, the measuring range with the specified accuracy is reduced as shown in the graph.

Flow sensors SFAM

Technical data

FESTO

Dimensions – SFAM-62

Download CAD Data → www.festo.com/us/cad

SFAM-62-...-M for manifold assembly in MS6 series service unit combination

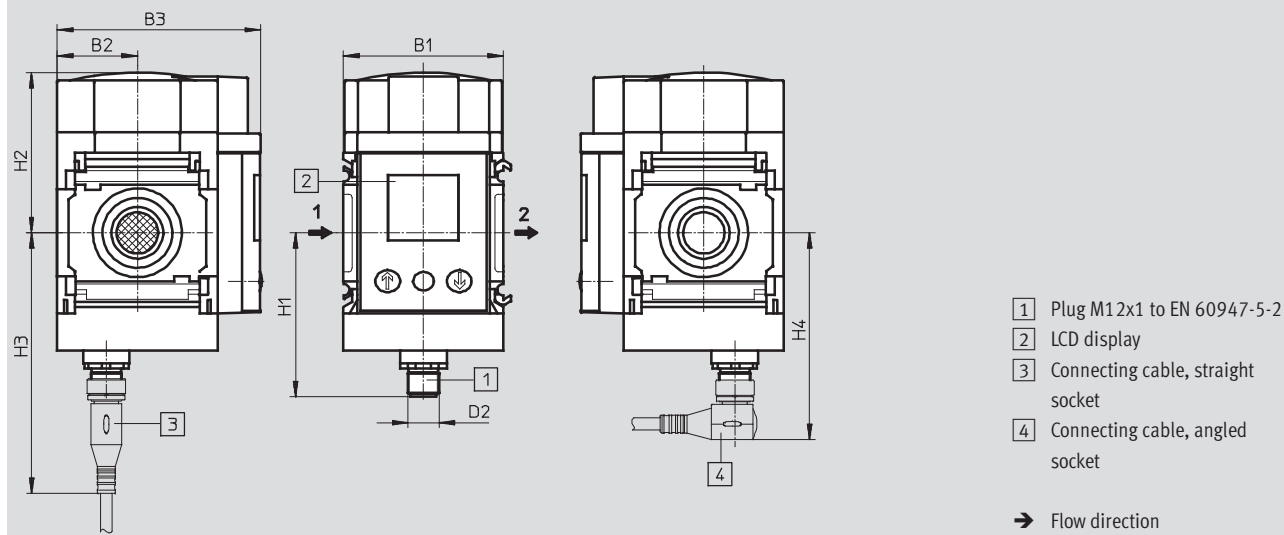

SFAM-62-...-T/W for individual assembly

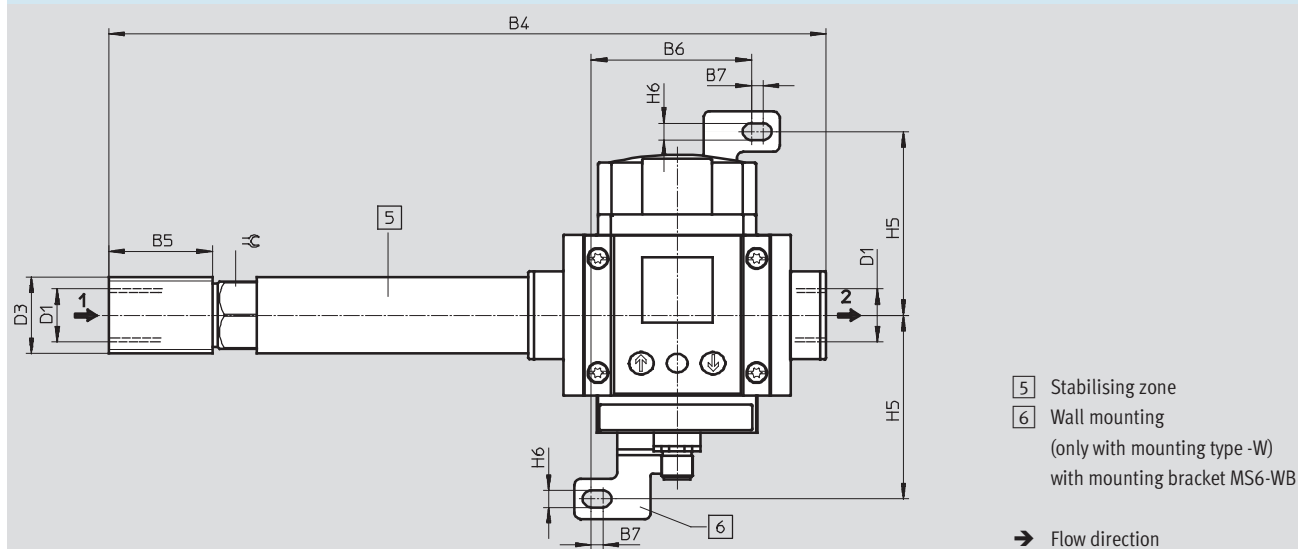

Type	B1	B2	B3	B4	B5	B6	B7	D1	D2	D3	H1	H2	H3	H4	H5	H6	⌀
SFAM-62-...-M	62	31	78.7	—	—	—	—	—	M12x1	—	63.5	62.1	101	80	—	—	—
SFAM-62-...-TG12	62	31	78.7	277	40	—	—	G½	M12x1	G¾	63.5	62.1	101	80	—	—	26
SFAM-62-...-WG12						61.9	4.5								71	6.6	
SFAM-62-...-TN12	62	31	78.7	277	40	—	—	NPT½	M12x1	NPT¾	63.5	62.1	101	80	—	—	26
SFAM-62-...-WN12						61.9	4.5								71	6.6	

Flow sensors SFAM

Technical data

FESTO

Dimensions – SFAM-90

Download CAD Data → www.festo.com/us/cad

SFAM-90-...-M for manifold assembly in MS9 series service unit combination

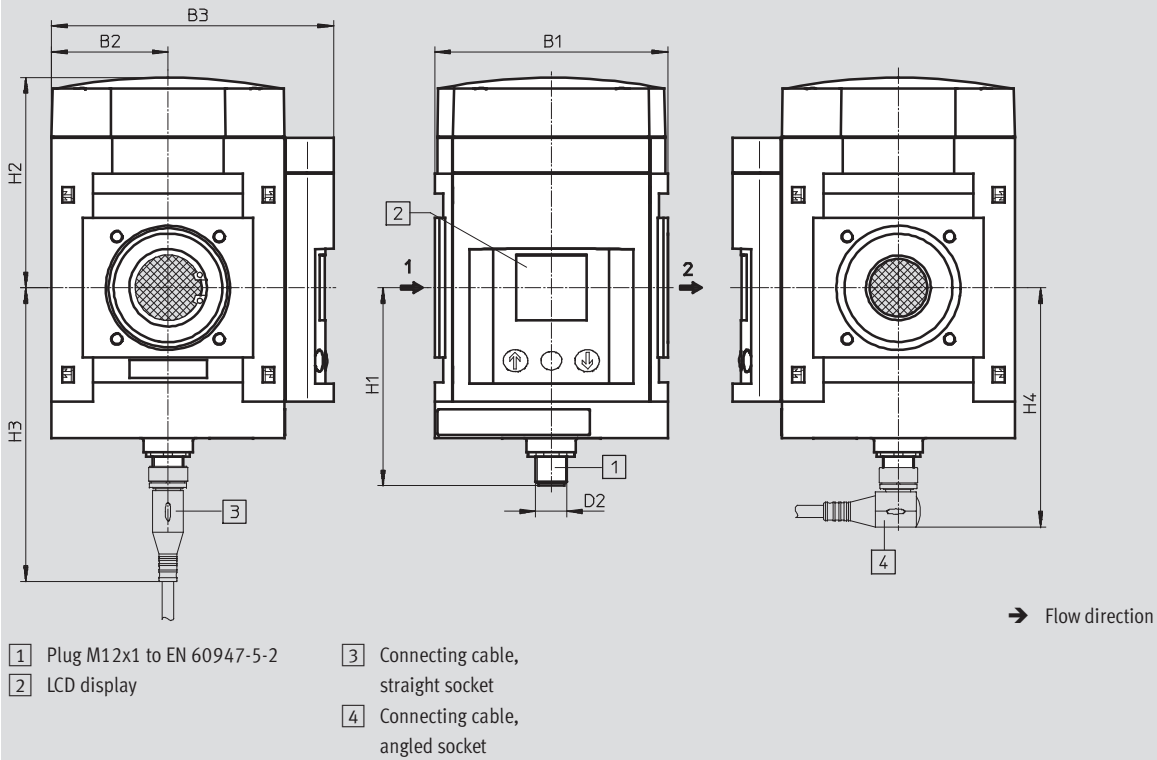

SFAM-90-...-T for individual assembly

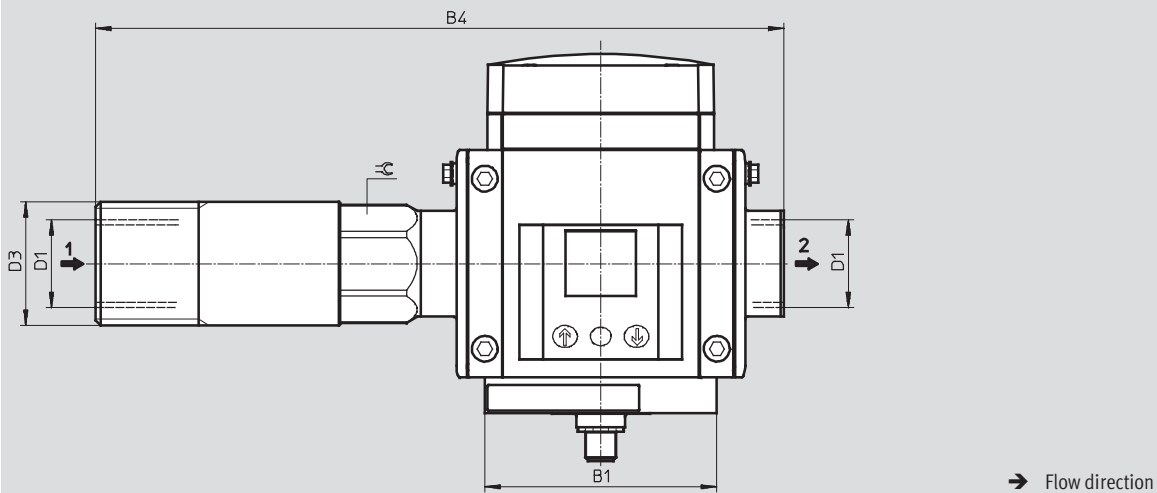

Type	B1	B2	B3	B4	D1	D2	D3	H1	H2	H3	H4	≙
SFAM-90-...-M	90	45	109	–	–	M12x1	–	76.5	81.3	114	93	–
SFAM-90-...-TG1	90	45	109	267	G1	M12x1	G1½	76.5	81.3	114	93	41
SFAM-90-...-TG112				301	G1½		G2					55
SFAM-90-...-TN1	90	45	109	267	NPT1	M12x1	NPT1½	76.5	81.3	114	93	41
SFAM-90-...-TN112				301	NPT1½		NPT2					55

Flow sensors SFAM

Technical data

FESTO

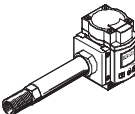
Ordering data					
Version	Grid dimension [mm]	Electrical output	Flow measuring range [l/min]	Part No.	Type
Manifold assembly in MS series service unit combination					
	62	2x PNP or NPN, 1 analogue output 4 ... 20 mA	10 ... 1,000	564930	SFAM-62-1000L-M-2SA-M12
			30 ... 3,000	564934	SFAM-62-3000L-M-2SA-M12
			50 ... 5,000	564938	SFAM-62-5000L-M-2SA-M12
		2x PNP or NPN, 1 analogue output 0 ... 10 V	10 ... 1,000	564932	SFAM-62-1000L-M-2SV-M12
			30 ... 3,000	564936	SFAM-62-3000L-M-2SV-M12
			50 ... 5,000	564940	SFAM-62-5000L-M-2SV-M12
	90	2x PNP or NPN, 1 analogue output 4 ... 20 mA	50 ... 5,000	573346	SFAM-90-5000L-M-2SA-M12
			100 ... 10,000	573348	SFAM-90-10000L-M-2SA-M12
			150 ... 15,000	573350	SFAM-90-15000L-M-2SA-M12
		2x PNP or NPN, 1 analogue output 0 ... 10 V	50 ... 5,000	573347	SFAM-90-5000L-M-2SV-M12
			100 ... 10,000	573349	SFAM-90-10000L-M-2SV-M12
			150 ... 15,000	573351	SFAM-90-15000L-M-2SV-M12
Threaded mounting of individual device					
	62	2x PNP or NPN, 1 analogue output 4 ... 20 mA	10 ... 1,000	565375	SFAM-62-1000L-TG12-2SA-M12
			30 ... 3,000	565379	SFAM-62-3000L-TG12-2SA-M12
			50 ... 5,000	565383	SFAM-62-5000L-TG12-2SA-M12
		2x PNP or NPN, 1 analogue output 0 ... 10 V	10 ... 1,000	565376	SFAM-62-1000L-TG12-2SV-M12
			30 ... 3,000	565380	SFAM-62-3000L-TG12-2SV-M12
			50 ... 5,000	565384	SFAM-62-5000L-TG12-2SV-M12
	90	2x PNP or NPN, 1 analogue output 4 ... 20 mA	50 ... 5,000	573352	SFAM-90-5000L-TG1-2SA-M12
			100 ... 10,000	573354	SFAM-90-10000L-TG112-2SA-M12
			150 ... 15,000	573356	SFAM-90-15000L-TG112-2SA-M12
		2x PNP or NPN, 1 analogue output 0 ... 10 V	50 ... 5,000	573353	SFAM-90-5000L-TG1-2SV-M12
			100 ... 10,000	573355	SFAM-90-10000L-TG112-2SV-M12
			150 ... 15,000	573357	SFAM-90-15000L-TG112-2SV-M12

Flow sensors SFAM

Ordering data – Modular products

Ordering table				Conditions	Code	Enter code
[M]	Module No.	563796				
	Function	Flow sensor			SFAM	-SFAM
	Grid dimension	62 mm			-62	
		90 mm			-90	
	Flow measuring range	Max. 1,000 l/min	[1]		-1000	
		Max. 3,000 l/min	[1]		-3000	
		Max. 5,000 l/min			-5000	
		Max. 10,000 l/min	[2]		-10000	
		Max. 15,000 l/min	[2]		-15000	
	Flow input	Unidirectional, from left to right			L	
		Unidirectional, from right to left			R	
	Type of mounting	Manifold assembly			-M	
		Threaded mounting			-T	
		Wall mounting	[1] [4]		-W	
[O]	Pneumatic connection	Not specified				
		G½	[1] [3]		G12	
		G1	[2] [3]		G1	
		G1½	[2] [3]		G112	
		½" NPT	[1] [3]		N12	
		1" NPT	[2] [3]		N1	
		1½" NPT	[2] [3]		N112	
[M]	Electrical output	2x PNP or NPN, 1 analogue output 4 ... 20 mA			-2SA	
		2x PNP or NPN, 1 analogue output 0 ... 10 V			-2SV	
	Electrical connection	Plug M12, A-coded			-M12	M12
[O]	Electrical accessories	Not specified				
		Angled socket, 2.5 m cable			-2.5A	
		Straight socket, 2.5 m cable			-2.5S	
		Angled socket, 5 m cable			-5A	
		Straight socket, 5 m cable			-5S	
	EU certification	Not specified				
		II 3GD			-EX2	

[1] 1000, 3000, G12, N12, W

Not with grid dimension 90

[2] 10000, 15000, G1, G112, N1, N112

Not with grid dimension 62

[3] G12, G1, G112, N12, N1, N112

Not with mounting type M

Mandatory data for mounting type T, W

[4] W

Not with EX2



Transfer order code

563796 **SFAM** - - - - - **M12** - - - - -

Flow sensors SFAM

Accessories

FESTO

Ordering data – Connecting cables				Technical data ➔ Internet: nebu	
	Number of wires	Cable length [m]	Part No.	Type	
M12x1, straight socket					
	5	2.5	541330	NEBU-M12G5-K-2.5-LE5	
		5	541331	NEBU-M12G5-K-5-LE5	
M12x1, angled socket					
	5	2.5	567843	NEBU-M12W5-K-2.5-LE5	
		5	567844	NEBU-M12W5-K-5-LE5	

Product Range and Company Overview

A Complete Suite of Automation Services

Our experienced engineers provide complete support at every stage of your development process, including: conceptualization, analysis, engineering, design, assembly, documentation, validation, and production.



Custom Automation Components
Complete custom engineered solutions



Custom Control Cabinets
Comprehensive engineering support and on-site services



Complete Systems
Shipment, stocking and storage services

The Broadest Range of Automation Components

With a comprehensive line of more than 30,000 automation components, Festo is capable of solving the most complex automation requirements.



Electromechanical
Electromechanical actuators, motors, controllers & drives



Pneumatics
Pneumatic linear and rotary actuators, valves, and air supply



PLCs and I/O Devices
PLC's, operator interfaces, sensors and I/O devices

Supporting Advanced Automation... As No One Else Can!

Festo is a leading global manufacturer of pneumatic and electromechanical systems, components and controls for industrial automation, with more than 12,000 employees in 56 national headquarters serving more than 180 countries. For more than 80 years, Festo has continuously elevated the state of manufacturing with innovations and optimized motion control solutions that deliver higher performing, more profitable automated manufacturing and processing equipment. Our dedication to the advancement of automation extends beyond technology to the education and development of current and future automation and robotics designers with simulation tools, teaching programs, and on-site services.

Quality Assurance, ISO 9001 and ISO 14001 Certifications

Festo Corporation is committed to supply all Festo products and services that will meet or exceed our customers' requirements in product quality, delivery, customer service and satisfaction.

To meet this commitment, we strive to ensure a consistent, integrated, and systematic approach to management that will meet or exceed the requirements of the ISO 9001 standard for Quality Management and the ISO 14001 standard for Environmental Management.



© Copyright 2008, Festo Corporation. While every effort is made to ensure that all dimensions and specifications are correct, Festo cannot guarantee that publications are completely free of any error, in particular typing or printing errors. Accordingly, Festo cannot be held responsible for the same. For Liability and Warranty conditions, refer to our "Terms and Conditions of Sale", available from your local Festo office. All rights reserved. No part of this publication may be reproduced, distributed, or transmitted in any form or by any means, electronic, mechanical, photocopying or otherwise, without the prior written permission of Festo. All technical data subject to change according to technical update.



Printed on recycled paper at New Horizon Graphic, Inc., FSC certified as an environmentally friendly printing plant.

Festo North America

Festo Regional Contact Center

5300 Explorer Drive
Mississauga, Ontario L4W 5G4
Canada

USA Customers:

For ordering assistance,

Call: 1.800.99.FESTO (1.800.993.3786)

Fax: 1.800.96.FESTO (1.800.963.3786)

Email: customer.service@us.festo.com

For technical support,

Call: 1.866.GO.FESTO (1.866.463.3786)

Fax: 1.800.96.FESTO (1.800.963.3786)

Email: product.support@us.festo.com

Canadian Customers:

Call: 1.877.GO.FESTO (1.877.463.3786)

Fax: 1.877.FX.FESTO (1.877.393.3786)

Email: festo.canada@ca.festo.com

USA Headquarters

Festo Corporation
395 Moreland Road
P.O. Box 18023
Hauppauge, NY 11788, USA
www.festo.com/us

USA Sales Offices

Appleton

North 922 Tower View Drive, Suite N
Greenville, WI 54942, USA

Boston

120 Presidential Way, Suite 330
Woburn, MA 01801, USA

Chicago

1441 East Business Center Drive
Mt. Prospect, IL 60056, USA

Dallas

1825 Lakeway Drive, Suite 600
Lewisville, TX 75057, USA

Detroit – Automotive Engineering Center

2601 Cambridge Court, Suite 320
Auburn Hills, MI 48326, USA

New York

395 Moreland Road
Hauppauge, NY 11788, USA

Silicon Valley

4935 Southfront Road, Suite F
Livermore, CA 94550, USA

United States



USA Headquarters, East: Festo Corp., 395 Moreland Road, Hauppauge, NY 11788

Phone: 1.631.435.0800; Fax: 1.631.435.8026;

Email: info@festo-usa.com

www.festo.com/us

Canada



Headquarters: Festo Inc., 5300 Explorer Drive, Mississauga, Ontario L4W 5G4

Phone: 1.905.624.9000; Fax: 1.905.624.9001;

Email: festo.canada@ca.festo.com

www.festo.ca

Mexico



Headquarters: Festo Pneumatic, S.A., Av. Ceylán 3, Col. Tequesquahuac,
54020 Tlalneapantla, Edo. de México

Phone: 011 52 [55] 53 21 66 00; Fax: 011 52 [55] 53 21 66 65;

Email: festo.mexico@mx.festo.com

www.festo.com/mx

Central USA

Festo Corporation
1441 East Business
Center Drive
Mt. Prospect, IL 60056, USA
Phone: 1.847.759.2600
Fax: 1.847.768.9480



Western USA

Festo Corporation
4935 Southfront Road,
Suite F
Livermore, CA 94550, USA
Phone: 1.925.371.1099
Fax: 1.925.245.1286



Festo Worldwide

Argentina Australia Austria Belarus Belgium Brazil Bulgaria Canada Chile China Colombia Croatia Czech Republic Denmark
Estonia Finland France Germany Great Britain Greece Hong Kong Hungary India Indonesia Iran Ireland Israel Italy Japan Latvia
Lithuania Malaysia Mexico Netherlands New Zealand Norway Peru Philippines Poland Romania Russia Serbia Singapore
Slovakia Slovenia South Africa South Korea Spain Sweden Switzerland Taiwan Thailand Turkey Ukraine United States Venezuela

www.festo.com