

Accessories, MS series

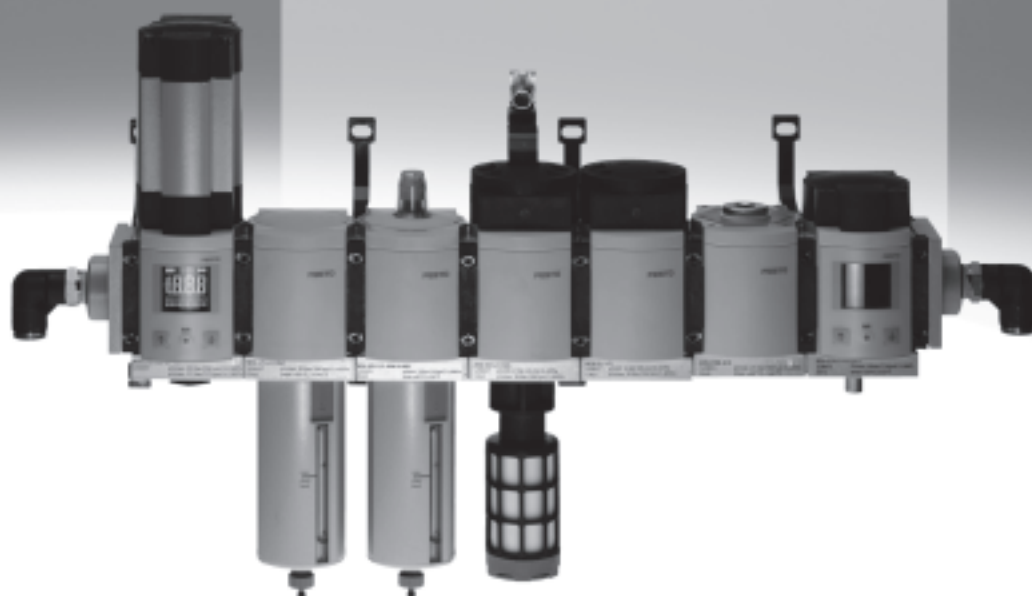











FESTO

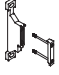

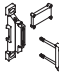
Accessories, MS series

Product range overview









FESTO

Type		Accessories for size			
		MS4	MS6	MS9	MS12
Mounting attachments for individual devices					
Mounting bracket MS-WB		■ → 4	■ → 4	–	–
Mounting bracket MS-WBM		■ → 4	–	–	–
Mounting bracket MS-WR		■ → 5	■ → 5	–	–
Hex nut MS-WRS		■ → 5	■ → 5	–	–
Mounting attachments for individual devices/combinations					
Mounting bracket MS-WP		■ → 7	■ → 7	■ → 13	■ → 15
Mounting bracket MS-WPB		■ → 8	■ → 8	■ → 13	–
Mounting bracket MS-WPM		■ → 9	■ → 9	■ → 14	–
Mounting bracket MS-WPE		■ → 10	■ → 10	–	–
Connectors					
Module connector MS-MV		■ → 10	■ → 10	■ → 14	■ → 15
Module connector MS-MVM		■ → 10	■ → 10	–	–
Module connector MS-RMV		■ → 16	■ → 16	■ → 19	–
Module connector MS-AMV		■ → 16	■ → 16	–	–
Module connector MS-ARMV		–	■ → 19	■ → 19, 21	■ → 21

Accessories, MS series

Product range overview

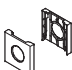
FESTO

Type		Accessories for size			
		MS4	MS6	MS9	MS12
Adapters for mounting on profiles					
Power supply modules MS-E-IPM-40-80		■ → 24	■ → 24	–	–
Power supply modules MS-E-IPM-80-80		■ → 24	■ → 24	–	–
Branching modules MS-A-IPM-80		■ → 24	■ → 24	–	–
Branching modules MS-A-RMV-IPM-80		■ → 24	■ → 24	–	–
Sealing rings MS-NNR		■ → 24	■ → 24	–	–
Cover plates					
Connecting plate MS-AG...		■ → 30	■ → 30	■ → 32	■ → 33
Cover plate MS-END		■ → 31	■ → 31	–	–
Mounting plate MS-AEND		■ → 31	■ → 31	–	–
Security components					
Padlock LRVS-D		■ → 34	■ → 34	■ → 34	■ → 34

Accessories, MS series

FESTO

Mounting attachments MS4/MS6

Mounting bracket MS4/6-WB

(order code: WB)

- For wall mounting

Material:

Steel

Note on materials:

RoHS-compliant (MS6-WB only)

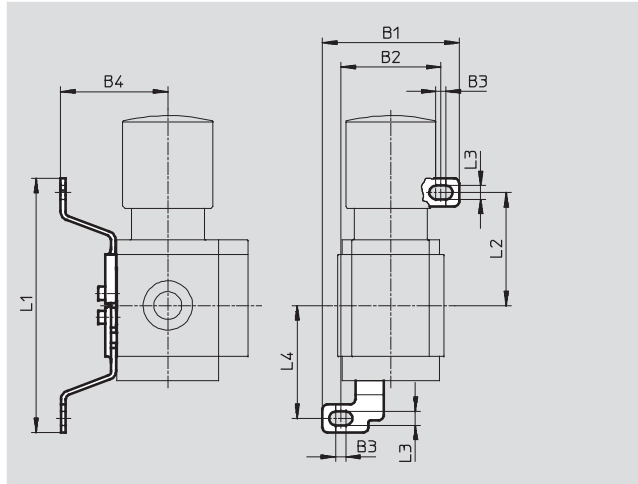

Dimensions and ordering data											
Size	B1	B2	B3	B4	L1	L2	L3	L4	Weight [g]	Part No.	Type
MS4	56.2	41.2	4	44.2	104.6	46.6	5.6	46.5	46	532185	MS4-WB
MS6	79.4	61.9	4.5	55	157.6	71	6.6	71	121	532196	MS6-WB

Mounting bracket MS4-WBM

(order code: WBM)

- For wall mounting

Material:

Steel

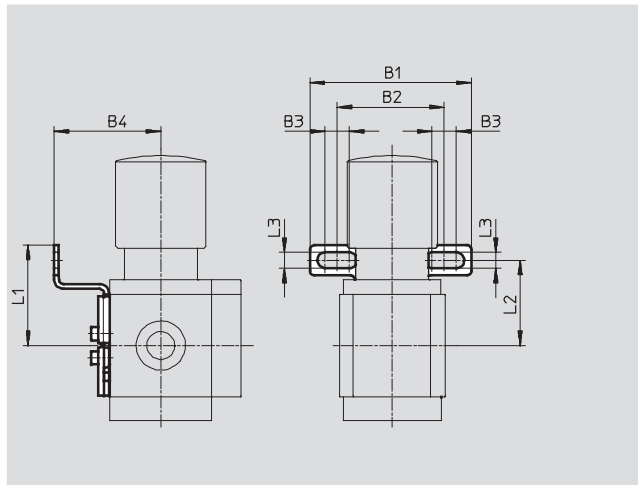

Dimensions and ordering data										
Size	B1	B2	B3	B4	L1	L2	L3	Weight [g]	Part No.	Type
MS4	66.5	44	10	44	41.3	35	6.5	48	526062	MS4-WBM

Accessories, MS series

FESTO

Mounting attachments MS4/MS6

Mounting bracket MS4/6-WR

(order code: WR)

- For wall mounting
- For filter regulator, pressure regulator

Material:

Steel

Note on materials:

RoHS-compliant (MS6-WR only)

Note

The hex nut for attaching components to this bracket must be ordered separately.

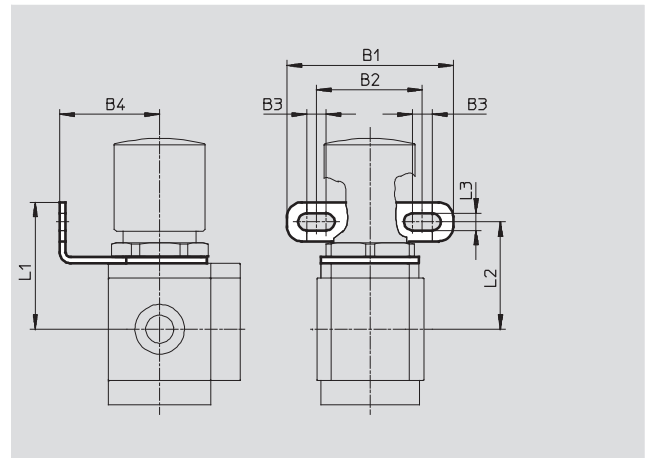

Dimensions and ordering data										
Size	B1	B2	B3	B4	L1	L2	L3	Weight [g]	Part No.	Type
MS4	68	44	8	41	52	44	7	49	526064	MS4-WR
MS6	70	42	8.2	40	67	57	7.1	90	526075	MS6-WR

Hex nut MS4/6-WRS

- For front panel mounting
- For attaching the mounting bracket MS...-WR

Material:

Aluminium

Note on materials:

RoHS-compliant (MS6-WRS only)

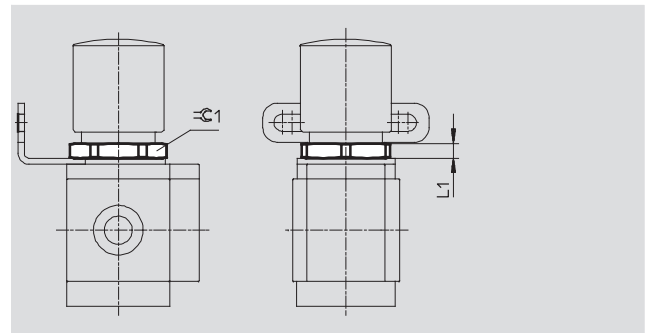

Dimensions and ordering data					
Size	L1	1	Weight [g]	Part No.	Type
MS4	6	36	6.9	532187	MS4-WRS
MS6	7	55	20.9	532188	MS6-WRS

Accessories, MS series

FESTO

Mounting attachments MS4/MS6

Mounting bracket MS4/6-WP...

Clearances for mounting service unit combinations

Size MS4

- 1 service unit with MS4-WP... :
40.2 mm (20.1 mm)¹⁾
- 2 service units with MS4-WP... :
80.4 mm (40.2 mm)¹⁾

Size MS6

- 1 service unit with
 - MS6-WP/WPB/WPE: 62 mm
(31 mm)¹⁾
 - MS6-WPM-D: 69 mm (38 mm)¹⁾
- 2 service units with
 - MS6-WP/WPB/WPE: 124 mm
(62 mm)¹⁾
 - MS6-WPM-2D: 138 mm
(76 mm)¹⁾

Number of units

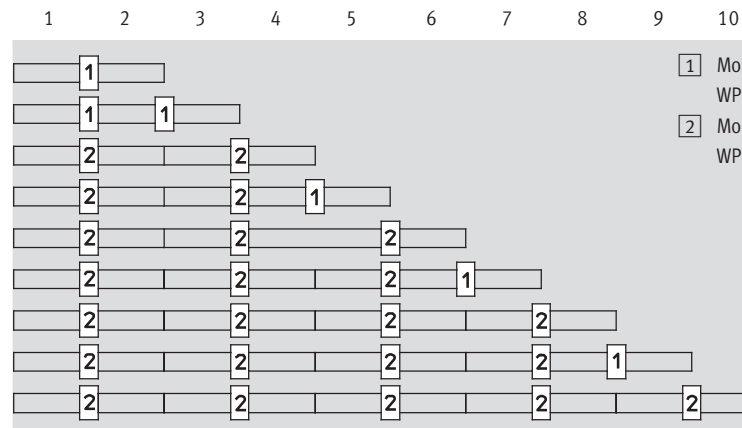

- 1 Mounting bracket WP, WPB, WPE or WPM-D
- 2 Mounting bracket WP, WPB, WPE or WPM-2D

1) With distributor block MS-FRM-FRZ

Mounting dimensions

Note

The distributor block MS4/6-FRM-FRZ has a dimension of half grid width.

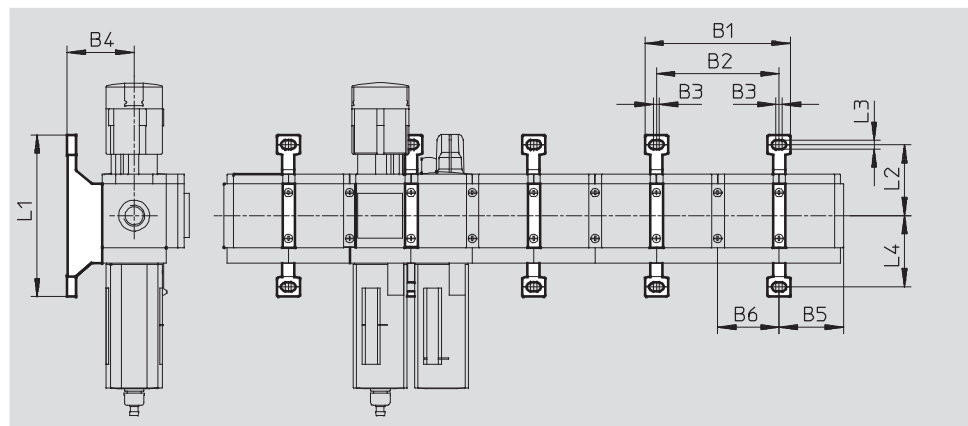

	2 service units with grid dimension		1 service unit with grid dimension and 1 distributor block MS-FRM-FRZ		2 distributor blocks MS-FRM-FRZ				Service unit with grid dimension		Distributor block MS-FRM-FRZ					
Type	B1	B2	B1	B2	B1	B2	B3	B4	B5 ¹⁾	B6	B5 ¹⁾	B6	L1	L2	L3	L4
MS4-WP	95.4	80.4	75.3	60.3	55.2	40.2	4	44	41.9	40.2	21.8	20.1	106	46.5	5.6	46.7
MS4-WPB/WPE								66					92.8	34.8		45.2
MS4-WPM-...D								44								
MS6-WP	141	124	110	93	79	62	4.5	54.1	64.5	62	33.5	31	158	71	6.6	71
MS6-WPB/WPE								90.5					98.6	41.3		41.3
MS6-WPM-...D								168					138	137		107

1) With accessory cover plate MS-END

Accessories, MS series

Mounting attachments MS4/MS6

FESTO

Mounting bracket MS4/6-WP

(order code: WP)

- For connecting modules via wall mounting
- In combination with a connecting plate MS4/6-AG... for individual wall mounting
- In combination with mounting plate MS4/6-AEND for individual wall mounting via direct thread
- For pressure regulator LRB with angled outlet block B... at rear

Material:

Die-cast aluminium

Note on materials:

RoHS-compliant (MS6-WP only)

Free of copper and PTFE

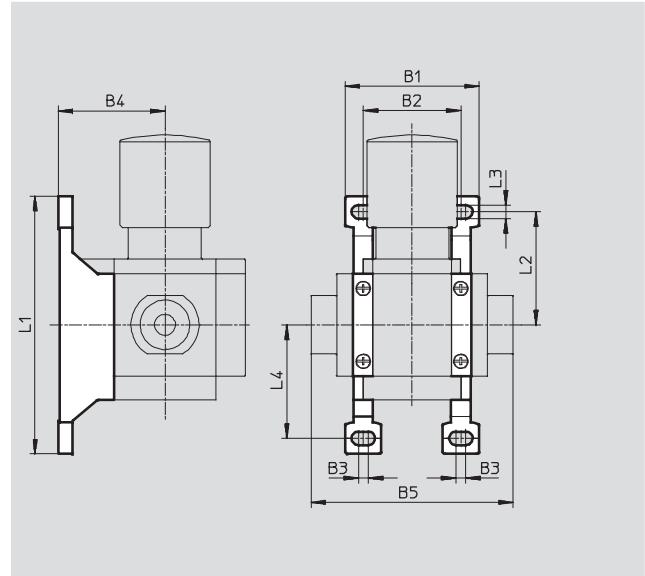

Dimensions and ordering data												
Size	B1	B2	B3	B4	B5	L1	L2	L3	L4	CRC ¹⁾	Weight [g]	Part No. Type
MS4	55.2	40.2	4	44	83.4	106	46.5	5.6	46.7	2	39	532184 MS4-WP
MS6	79	62	4.5	54.1	115	158	71	6.6	71	2	76	532195 MS6-WP
For use in explosive areas in zones 2 and 22												
MS4	55.2	40.2	4	44	83.4	106	46.5	5.6	46.7	2	39	541554 MS4-WP-EX
MS6	79	62	4.5	54.1	115	158	71	6.6	71	2	76	541544 MS6-WP-EX

1) Corrosion resistance class 2 as per Festo standard 940 070

Components subject to moderate corrosion stress. Externally visible parts with primarily decorative surface requirements which are in direct contact with a normal industrial environment or media such as coolants or lubricating agents.

Accessories, MS series

Mounting attachments MS4/MS6

FESTO

Mounting bracket MS4/6-WPB

(order code: WPB)

- For connecting modules via wall mounting
- In combination with a connecting plate MS4/6-AG... for individual wall mounting
- In combination with mounting plate MS4/6-AEND for individual wall mounting via direct thread
- Provides large wall gap for pressure regulator

Material:

Die-cast aluminium

Note on materials:

RoHS-compliant (MS6-WPB only)

Free of copper and PTFE

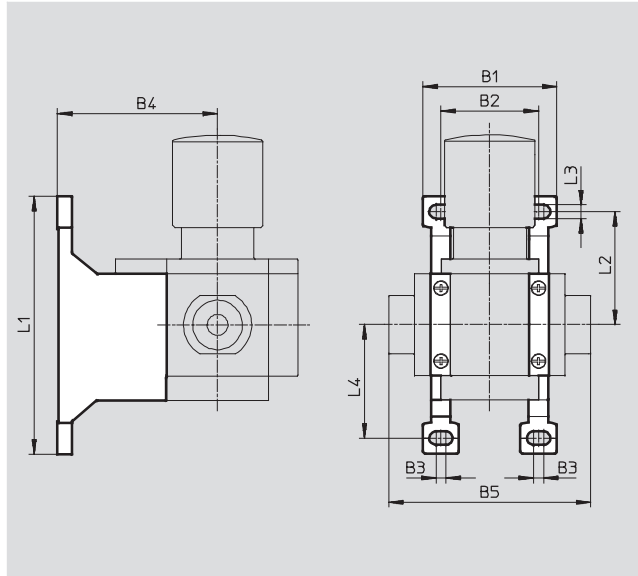

Dimensions and ordering data												
Size	B1	B2	B3	B4	B5	L1	L2	L3	L4	CRC ¹⁾	Weight [g]	Part No. Type
MS4	55.2	40.2	4	66	83.4	106	46.5	5.6	46.7	2	55	526063 MS4-WPB
MS6	79	62	4.5	90.5	115	158	71	6.6	71	2	115	526074 MS6-WPB
For use in explosive areas in zones 2 and 22												
MS4	55.2	40.2	4	66	83.4	106	46.5	5.6	46.7	2	55	541552 MS4-WPB-EX
MS6	79	62	4.5	90.5	115	158	71	6.6	71	2	115	541542 MS6-WPB-EX

1) Corrosion resistance class 2 as per Festo standard 940 070

Components subject to moderate corrosion stress. Externally visible parts with primarily decorative surface requirements which are in direct contact with a normal industrial environment or media such as coolants or lubricating agents.

Accessories, MS series

Mounting attachments MS4/MS6

FESTO

Mounting bracket MS4/6-WPM

(order code: WPM)

- For connecting modules via wall mounting
- In combination with a connecting plate MS4/6-AG... for individual wall mounting
- Speedy attachment and detachment
- For installation of modules with regulating knob pointing downwards

The distance piece D or 2D (designated in the type code) is included in the scope of delivery and ensures the correct clearance

Material:

Die-cast aluminium

Note on materials:

RoHS-compliant (MS6-WPM only)

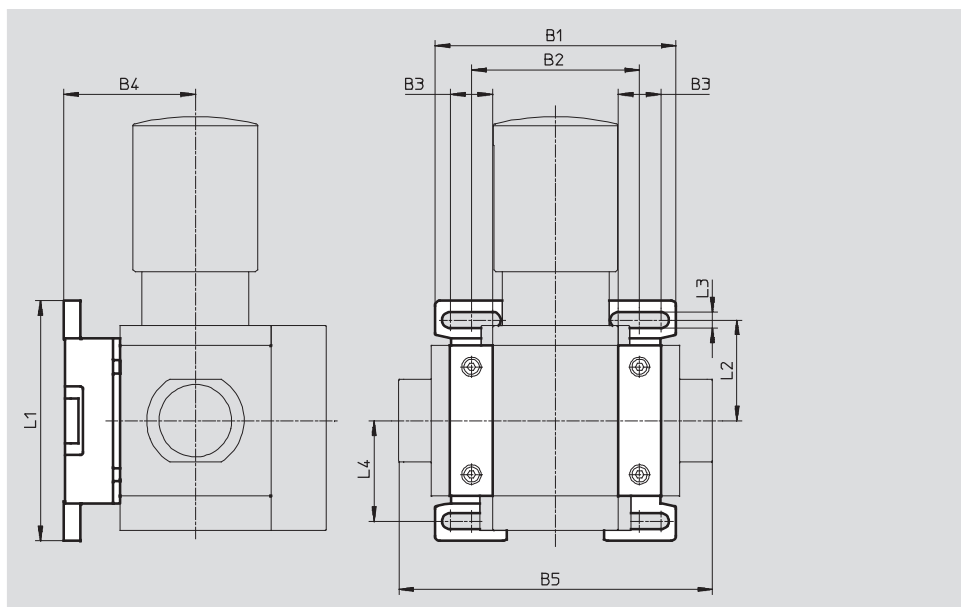
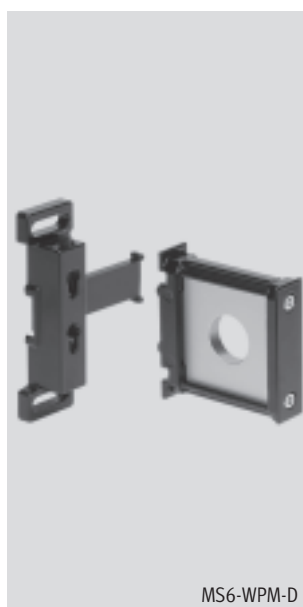
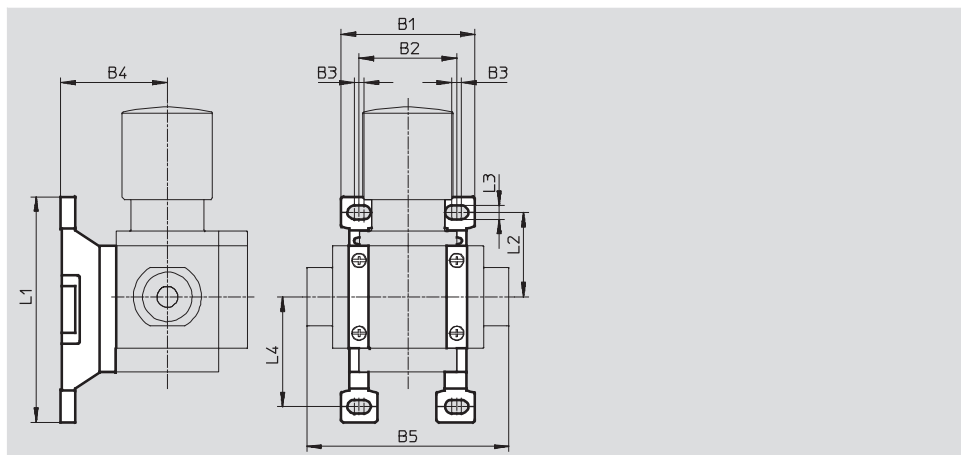

Dimensions and ordering data													
Size	B1	B2	B3	B4	B5	L1	L2	L3	L4	Clearance	Weight [g]	Part No.	Type
MS4	55.2	40.2	4	44	83.4	92.8	34.8	5.6	45.2	40.2	45	526060	MS4-WPM-D
	95.4	80.4			123.4					80.4	55	526061	MS4-WPM-2D
MS6	99	69	17.5	54.1	129	98.6	41.3	6.6	41.3	69	144	526073	MS6-WPM-D
	168	138			198					138	154	532186	MS6-WPM-2D

Accessories, MS series

Mounting attachments MS4/MS6

FESTO

Mounting bracket MS4/6-WPE

- Inexpensive alternative to mounting bracket MS4/6-WPB

Note on materials:

RoHS-compliant

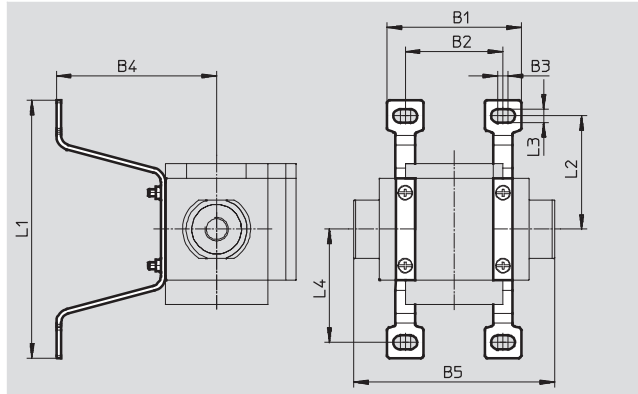

Dimensions and ordering data												
Size	B1	B2	B3	B4	B5	L1	L2	L3	L4	CRC ¹⁾	Part No.	Type
MS4	55.2	40.2	4.2	66	83.4	106	46.6	5.7	46.6	2	558869	MS4-WPE
MS6	79	62	4.3	90.5	115	158	71	6.5	71	2	1025936	MS6-WPE

1) Corrosion resistance class 2 as per Festo standard 940 070

Components subject to moderate corrosion stress. Externally visible parts with primarily decorative surface requirements which are in direct contact with a normal industrial environment or media such as coolants or lubricating agents.

Module connector MS4/6-MV

- For connecting modules

Material:

Stainless steel/polyacetal

Note on materials:

RoHS-compliant (MS6-MV only)

Free of copper and PTFE



Ordering data				
Size	CRC ¹⁾	Weight [g]	Part No.	Type
MS4	2	36	532798	MS4-MV
MS6	2	54	532799	MS6-MV
For use in explosive areas in zones 2 and 22				
MS4	2	36	541553	MS4-MV-EX
MS6	2	54	541543	MS6-MV-EX

1) Corrosion resistance class 2 as per Festo standard 940 070

Components subject to moderate corrosion stress. Externally visible parts with primarily decorative surface requirements which are in direct contact with a normal industrial environment or media such as coolants or lubricating agents.

Accessories, MS series

Mounting attachments MS4/MS6

FESTO

Module connector MS4/6-MVM

- For installation of modules with regulating knob pointing downwards

Material:
Die-cast aluminium

Note on materials:
RoHS-compliant (MS6-MVM only)



Ordering data		
Size	Part No.	Type
MS4	532800	MS4-MVM
MS6	532801	MS6-MVM

Accessories, MS series

Mounting attachments MS9

FESTO

Mounting bracket MS9-WP...

Clearances for mounting service unit combinations

1 service unit: 90 mm

2 service units: 180 mm

Number of units

1 2 3 4 5 6 7 8 9 10

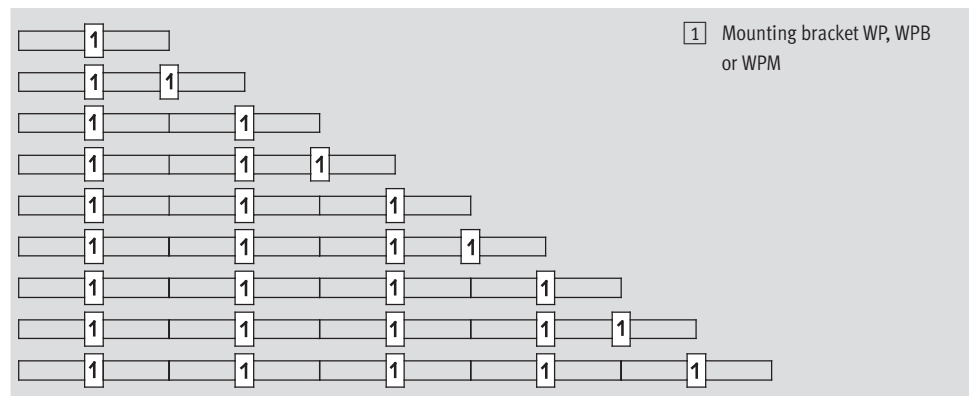

Mounting dimensions

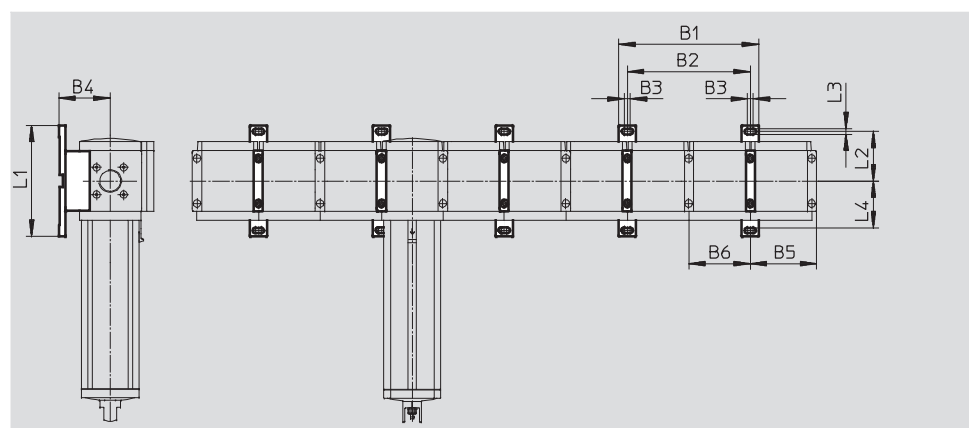

Type	B1	B2	B3	B4	B5	B6	L1	L2	L3	L4
MS9-WP	205	180	8.5	75	97	90	162	72.75	8.3	72.25
MS9-WPB				99						
MS9-WPM				90.5						

Accessories, MS series

Mounting attachments MS9

Mounting bracket MS9-WP

(order code: WP)

- For connecting modules via wall mounting
- In combination with a connecting plate MS9-AG... for individual wall mounting

Material:

Module connector, bracket,
hollow bolt: Die-cast aluminium

Screws: Steel

Seals: Nitrile rubber

RoHS-compliant

Free of copper and PTFE

Temperature of medium:

-10 ... +60 °C

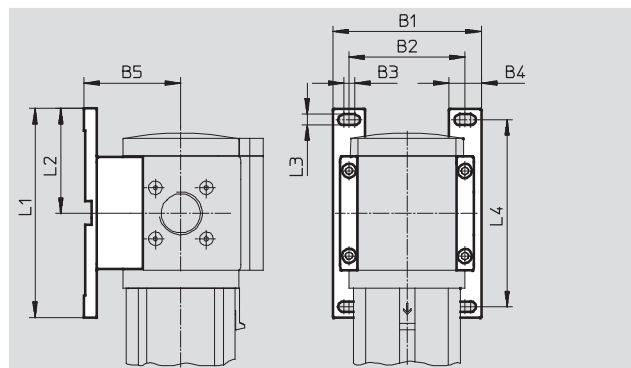

Dimensions and ordering data

Size	B1	B2	B3	B4	B5	L1	L2	L3	L4	CRC ¹⁾	Weight [g]	Part No.	Type
MS9	115	90	8.5	25	75	162	81.25	8.3	145	2	180	552947	MS9-WP

1) Corrosion resistance class 2 as per Festo standard 940 070

Components subject to moderate corrosion stress. Externally visible parts with primarily decorative surface requirements which are in direct contact with a normal industrial environment or media such as coolants or lubricating agents.

Mounting bracket MS9-WPB

(order code: WPB)

- For connecting modules via wall mounting
- In combination with a connecting plate MS9-AG... for individual wall mounting
- Same wall gap for combination with MS12 series using the mounting bracket MS12-WP

Material:

Module connector, bracket,
hollow bolt: Die-cast aluminium

Screws: Steel

Seals: Nitrile rubber

RoHS-compliant

Free of copper and PTFE

Temperature of medium:

-10 ... +60 °C

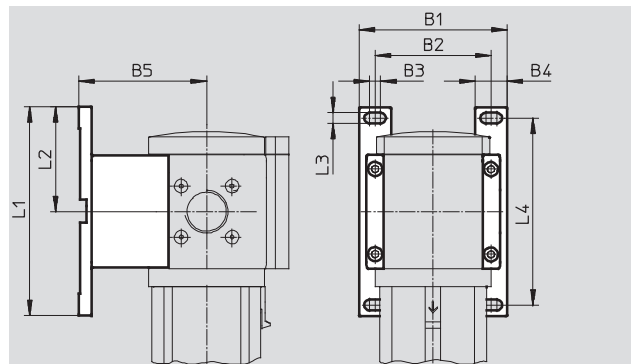

Dimensions and ordering data

Size	B1	B2	B3	B4	B5	L1	L2	L3	L4	CRC ¹⁾	Weight [g]	Part No.	Type
MS9	115	90	8.5	25	99	162	81.25	8.3	145	2	210	552949	MS9-WPB

1) Corrosion resistance class 2 as per Festo standard 940 070

Components subject to moderate corrosion stress. Externally visible parts with primarily decorative surface requirements which are in direct contact with a normal industrial environment or media such as coolants or lubricating agents.

Accessories, MS series

Mounting attachments MS9

FESTO

Mounting bracket MS9-WPM

(order code: WPM)

- For connecting modules via wall mounting
- In combination with a connecting plate MS9-AG... for individual wall mounting

- Speedy attachment and detachment
- Same wall gap for combination with MS6 series using the mounting bracket MS6-WPB

The distance pieces included in the scope of delivery ensure the correct clearance.

Material:

Module connector, bracket, hollow

bolt: Die-cast aluminium

Screws: Steel

Seals: Nitrile rubber

RoHS-compliant

Free of copper and PTFE

Temperature of medium:

-10 ... +60 °C

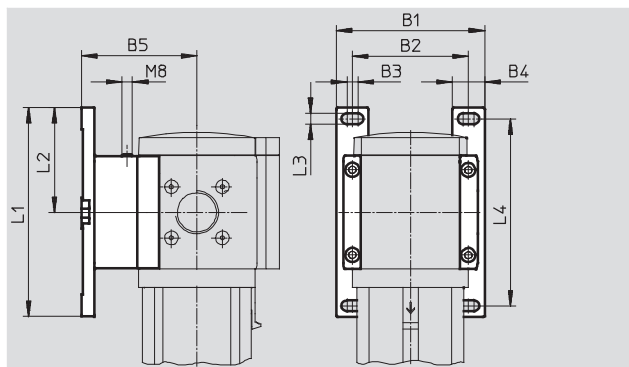

Dimensions and ordering data

Size	B1	B2	B3	B4	B5	L1	L2	L3	L4	CRC ¹⁾	Weight [g]	Part No.	Type
MS9	115	90	8.5	25	90.5	162	81.25	8.3	145	2	220	552948	MS9-WPM

1) Corrosion resistance class 2 as per Festo standard 940 070

Components subject to moderate corrosion stress. Externally visible parts with primarily decorative surface requirements which are in direct contact with a normal industrial environment or media such as coolants or lubricating agents.

Module connector MS9-MV

- For connecting modules

Material:

Module connector, hollow bolt:

Die-cast aluminium

Screws: Steel

Seals: Nitrile rubber

RoHS-compliant

Free of copper and PTFE

Temperature of medium:

-10 ... +60 °C

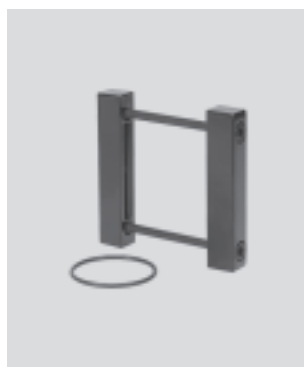

Ordering data

Size	CRC ¹⁾	Weight [g]	Part No.	Type
MS9	2	110	552950	MS9-MV

1) Corrosion resistance class 2 as per Festo standard 940 070

Components subject to moderate corrosion stress. Externally visible parts with primarily decorative surface requirements which are in direct contact with a normal industrial environment or media such as coolants or lubricating agents.

Accessories, MS series



Mounting attachments MS12

Mounting bracket MS12-WP (order code: WP)

- For connecting modules via wall mounting
- In combination with a connecting plate for individual wall mounting

Material:
Die-cast aluminium
Free of copper and PTFE

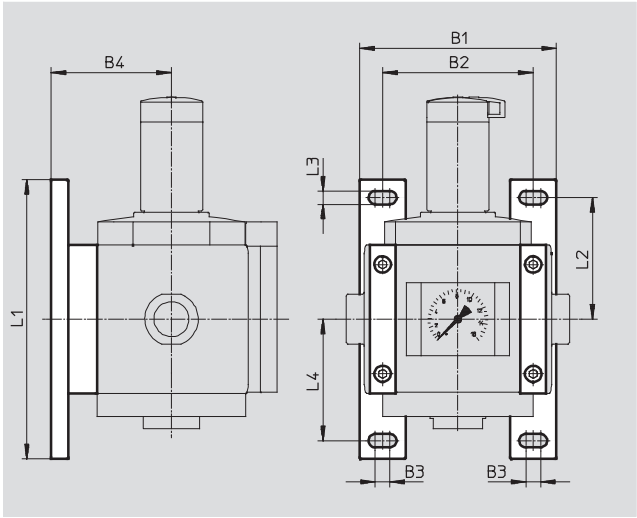

Dimensions and ordering data											
Size	B1	B2	B3	B4	L1	L2	L3	L4	Weight [g]	Part No.	Type
MS12	162	124	12	99	230	100	11	100	700	537133	MS12-WP

Module connector MS12-MV

- For connecting modules

Material:
Die-cast aluminium
Free of copper and PTFE



Ordering data			
Size	Weight [g]	Part No.	Type
MS12	500	537134	MS12-MV

Accessories, MS series

Mounting attachments MS4/MS6

FESTO

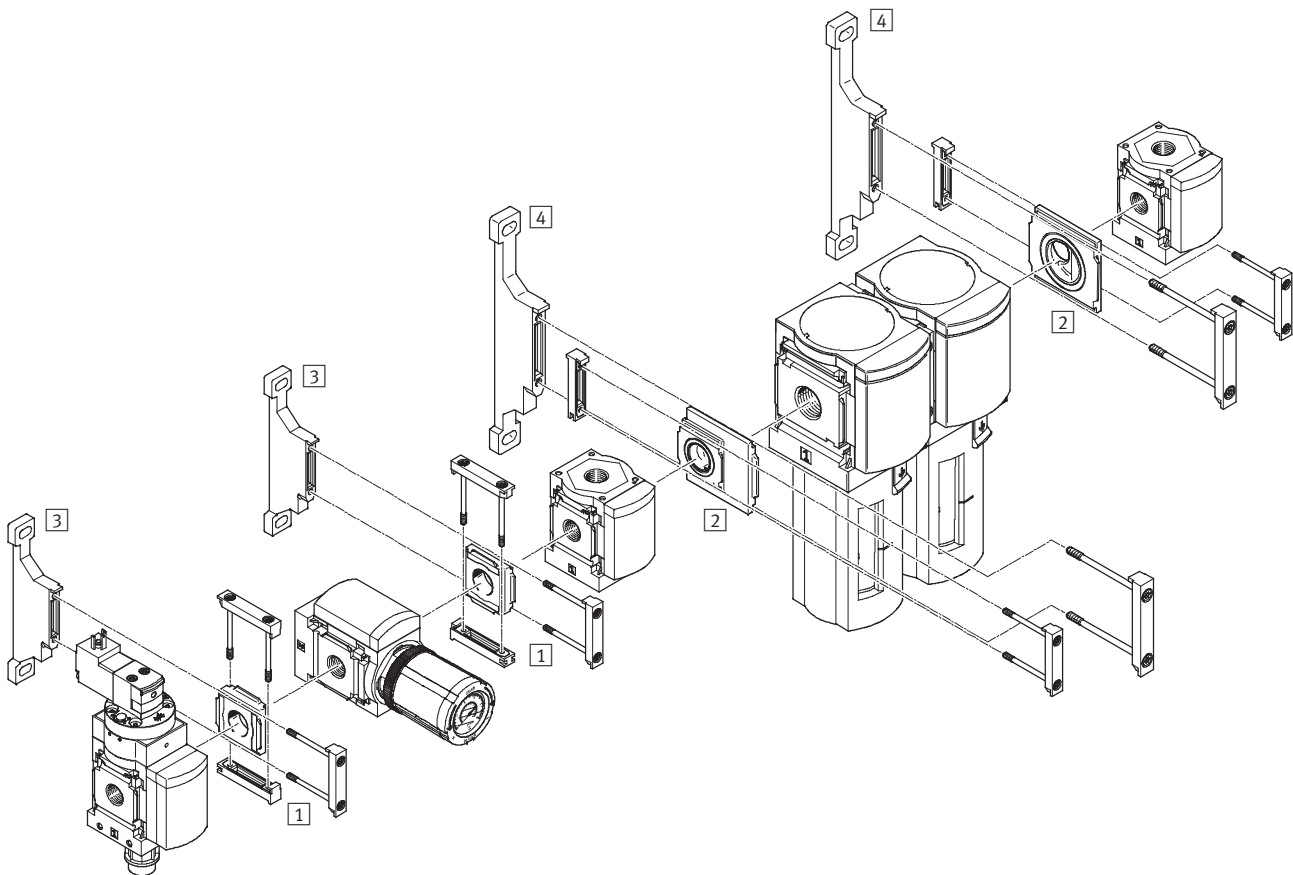

Mounting attachments		→ Page/Internet
1	Module connector MS4/6-RMV	17
2	Module connector MS4-6-AMV	18
3	Mounting bracket MS4-WP	7
4	Mounting bracket MS6-WP	7

Note

Mounting attachments for wall
mounting → 6

Accessories, MS series

Mounting attachments MS4/MS6

FESTO

Module connector MS4/6-RMV

- For connecting service units at right angles to the axis of connection

Material:

Connecting plate, module connector:

Die-cast aluminium

Sealing ring: Nitrile rubber

RoHS-compliant

Temperature of medium:

-10 ... +60 °C

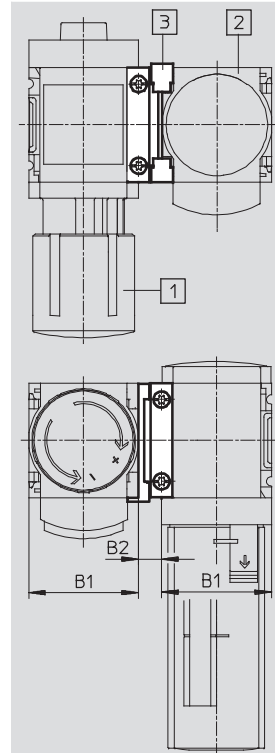

- 1 Service unit of same size at right angles to the axis of connection
- 2 Service unit size MS4/6
- 3 Module connector MS4/6-RMV

Dimensions and ordering data						
Size	B1	B2	CRC ¹⁾	Weight [g]	Part No.	Type
MS4	40.2	8.5	2	42	543490	MS4-RMV
MS6	62	11	2	112	543491	MS6-RMV
For use in explosive areas in zones 2 and 22						
MS4	40.2	8.5	2	42	563393	MS4-RMV-EX
MS6	62	11	2	112	563394	MS6-RMV-EX

1) Corrosion resistance class 2 as per Festo standard 940 070

Components subject to moderate corrosion stress. Externally visible parts with primarily decorative surface requirements which are in direct contact with a normal industrial environment or media such as coolants or lubricating agents.

Accessories, MS series

Mounting attachments MS4/MS6

FESTO

Module connector MS4-6-AMV

- For connecting MS4 and MS6 service units into one unit

Material:

Connecting plate, module connector:

Die-cast aluminium

Sealing ring: Nitrile rubber

RoHS-compliant

Temperature of medium:

-10 ... +60 °C



Note

The larger mounting bracket must always be used on the module connector. The mounting bracket must be ordered separately.

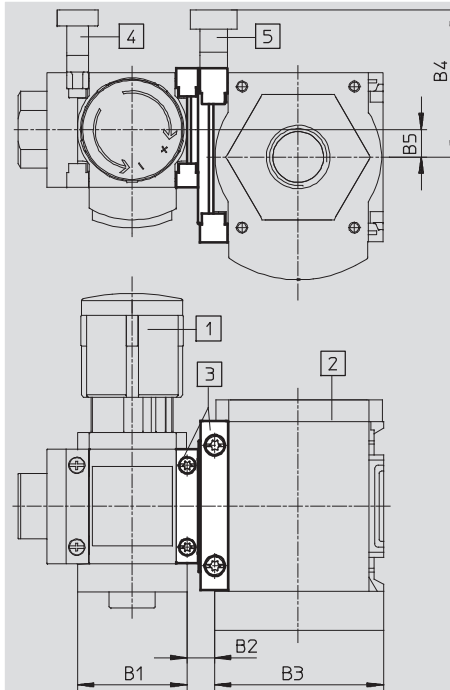

- 1 Service unit size MS4
- 2 Service unit size MS6
- 3 Module connector MS4-6-AMV
- 4 Mounting bracket MS4-WP
- 5 Mounting bracket MS6-WP

Dimensions and ordering data

Size	B1	B2	B3	B4	B5	CRC ¹⁾	Weight [g]	Part No.	Type
MS4/6	40.2	10	62	54.1	10	2	77	543489	MS4-6-AMV
For use in explosive areas in zones 2 and 22									
MS4/6	40.2	10	62	54.1	10	2	77	563392	MS4-6-AMV-EX

1) Corrosion resistance class 2 as per Festo standard 940 070

Components subject to moderate corrosion stress. Externally visible parts with primarily decorative surface requirements which are in direct contact with a normal industrial environment or media such as coolants or lubricating agents.

Accessories, MS series

Mounting attachments MS6/MS9

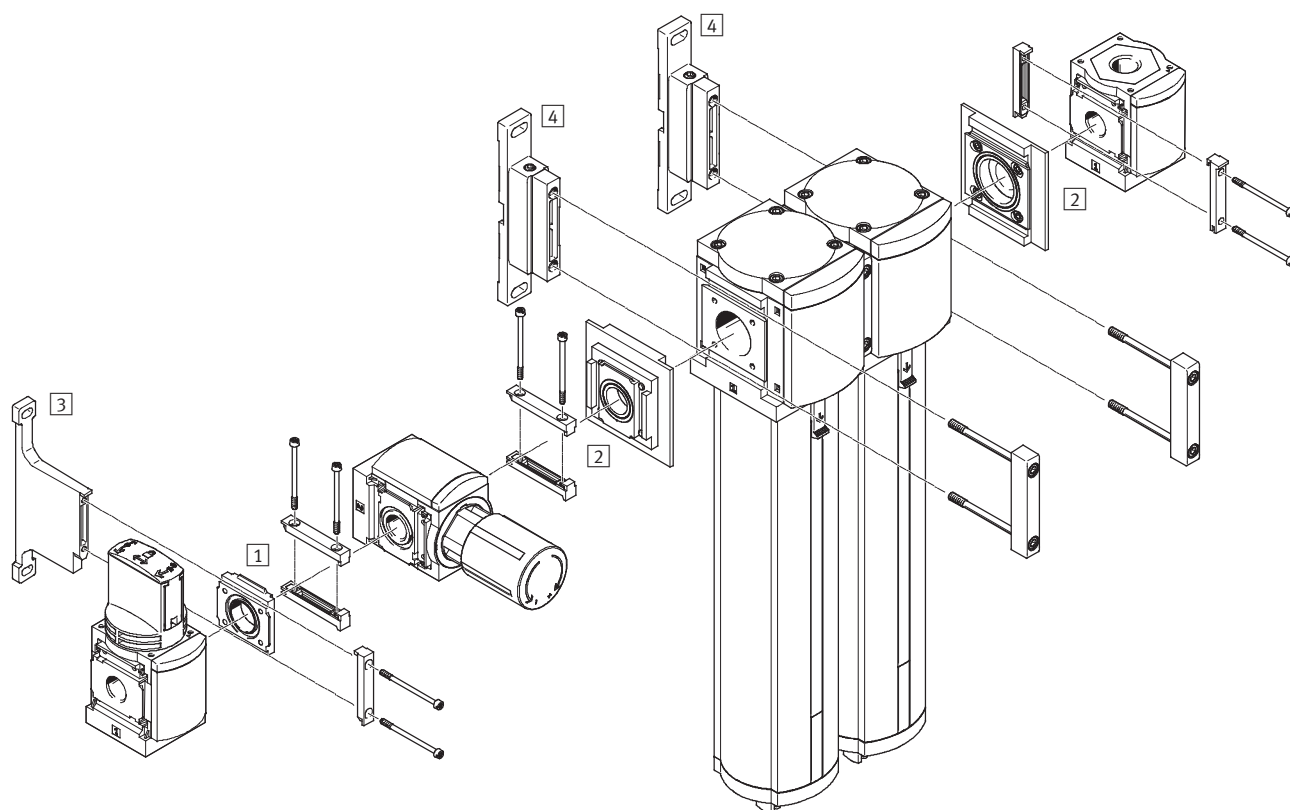

Mounting attachments		→ Page/Internet
1	Module connector MS6-RMV	17
2	Module connector MS6-9-ARMV	20
3	Mounting bracket MS6-WPB	8
4	Mounting bracket MS9-WPM	14

Accessories, MS series

Module connector MS6/MS9

FESTO

Module connector MS6-9-ARMV

- For connecting MS6 and MS9 service units into one unit
- Rotation of service unit at right angles to the axis of connection possible

Material:

Connecting plate, module connector:

Die-cast aluminium

Screws: Steel

Seals: Nitrile rubber

RoHS-compliant

Free of copper and PTFE

Temperature of medium:

-10 ... +60 °C

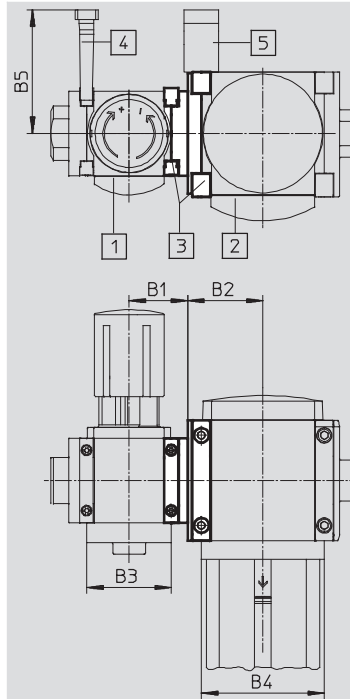

- 1 Service unit size MS6
- 2 Service unit size MS9
- 3 Module connector
- 4 Mounting bracket MS6-WPB
- 5 Mounting bracket MS9-WPM

Note

The larger mounting bracket must always be used on the module connector. The mounting bracket must be ordered separately.

Dimensions and ordering data									
Size	B1	B2	B3	B4	B5	CRC ¹⁾	Weight [g]	Part No.	Type
MS6/9	43	55	62	90	90.5	2	350	552951	MS6-9-ARMV

1) Corrosion resistance class 2 as per Festo standard 940 070

Components subject to moderate corrosion stress. Externally visible parts with primarily decorative surface requirements which are in direct contact with a normal industrial environment or media such as coolants or lubricating agents.

Accessories, MS series

Mounting attachments MS9/MS12

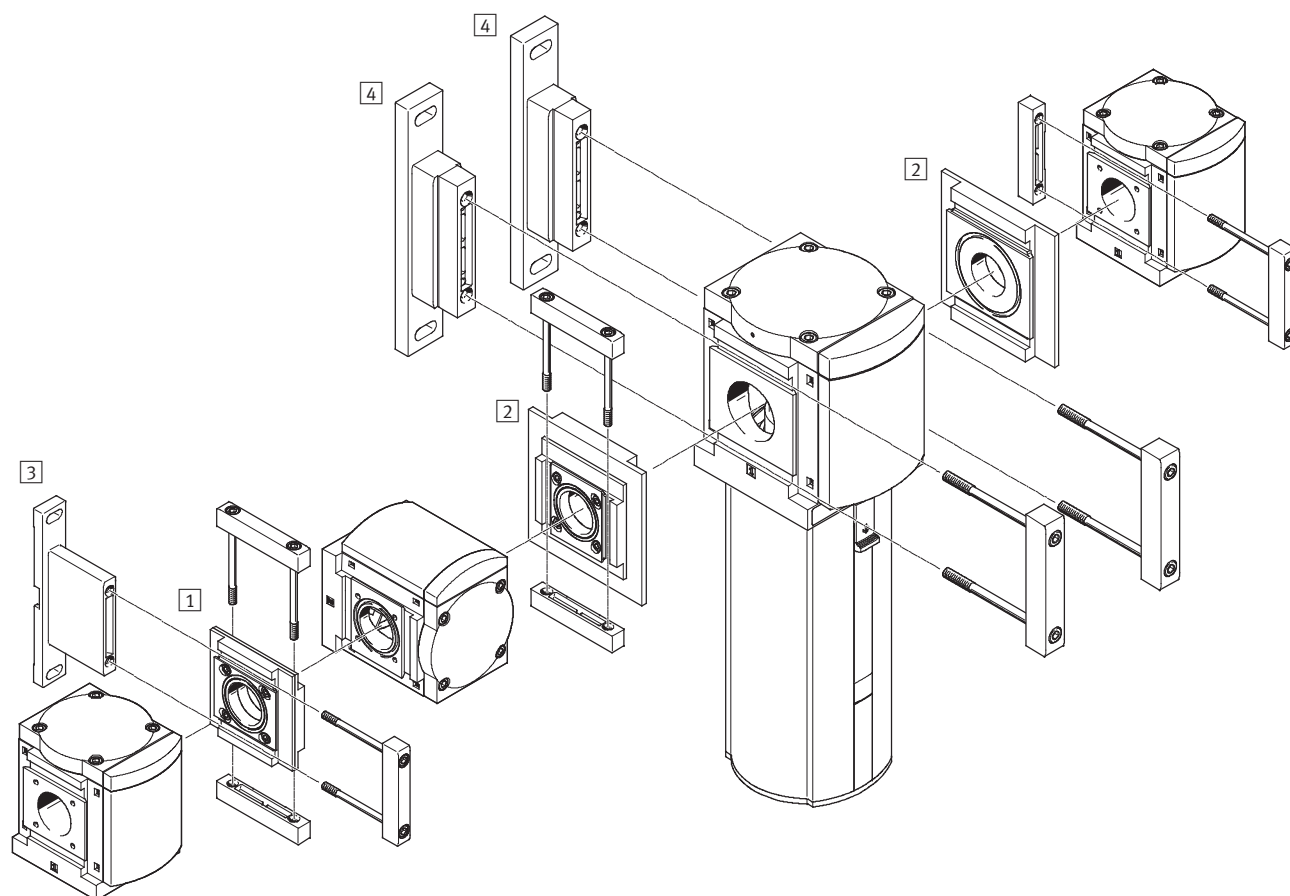

Mounting attachments		→ Page/Internet
1	Module connector MS9-RMV	22
2	Module connector MS9-12-ARMV	23
3	Mounting bracket MS9-WPB	13
4	Mounting bracket MS12-WP	15

Accessories, MS series

Mounting attachments MS9/MS12

FESTO

Module connector MS9-RMV

- For connecting service units at right angles to the axis of connection

Material:

Connecting plate, module connector:

Die-cast aluminium

Screws: Steel

Seals: Nitrile rubber

RoHS-compliant

Free of copper and PTFE

Temperature of medium:

-10 ... +60 °C

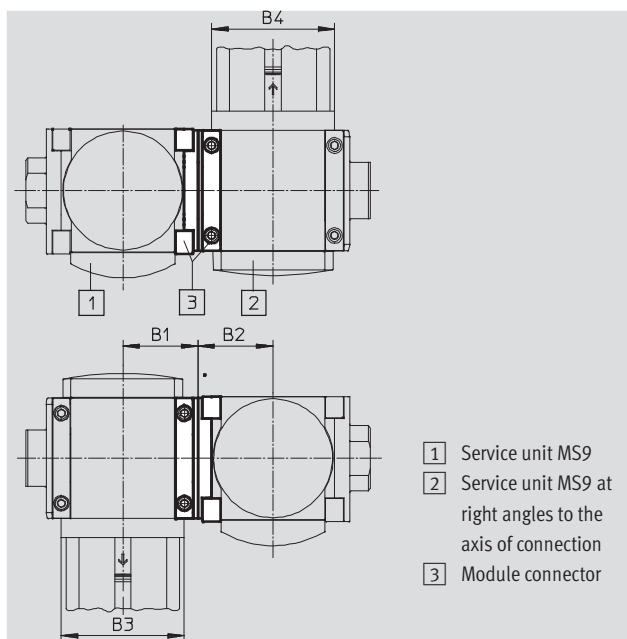

Dimensions and ordering data

Size	B1	B2	B3	B4	CRC ¹⁾	Weight [g]	Part No.	Type
MS9	55	55	90	90	2	920	552952	MS9-RMV

1) Corrosion resistance class 2 as per Festo standard 940 070

Components subject to moderate corrosion stress. Externally visible parts with primarily decorative surface requirements which are in direct contact with a normal industrial environment or media such as coolants or lubricating agents.

Accessories, MS series

Mounting attachments MS9/MS12

Module connector MS9-12-ARMV

- For connecting MS9 and MS12 service units into one unit
- Rotation of service unit at right angles to the axis of connection possible

Material:

Connecting plate, module connector:

Die-cast aluminium

Screws: Steel

Seals: Nitrile rubber

RoHS-compliant

Free of copper and PTFE

Temperature of medium:

-10 ... +60 °C

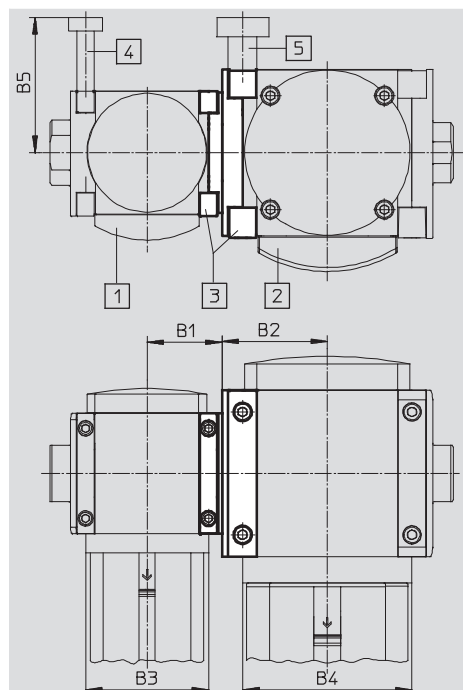

- 1 Service unit size MS9
- 2 Service unit size MS12
- 3 Module connector
- 4 Mounting bracket MS9-WPB
- 5 Mounting bracket MS12-WP

Note

The larger mounting bracket must always be used on the module connector. The mounting bracket must be ordered separately.

Dimensions and ordering data

Size	B1	B2	B3	B4	B5	CRC ¹⁾	Weight [g]	Part No.	Type
MS9/12	55	77	90	124	99	2	990	552953	MS9-12-ARMV

1) Corrosion resistance class 2 as per Festo standard 940 070

Components subject to moderate corrosion stress. Externally visible parts with primarily decorative surface requirements which are in direct contact with a normal industrial environment or media such as coolants or lubricating agents.

Accessories, MS series

Mounting attachments MS4/MS6

FESTO

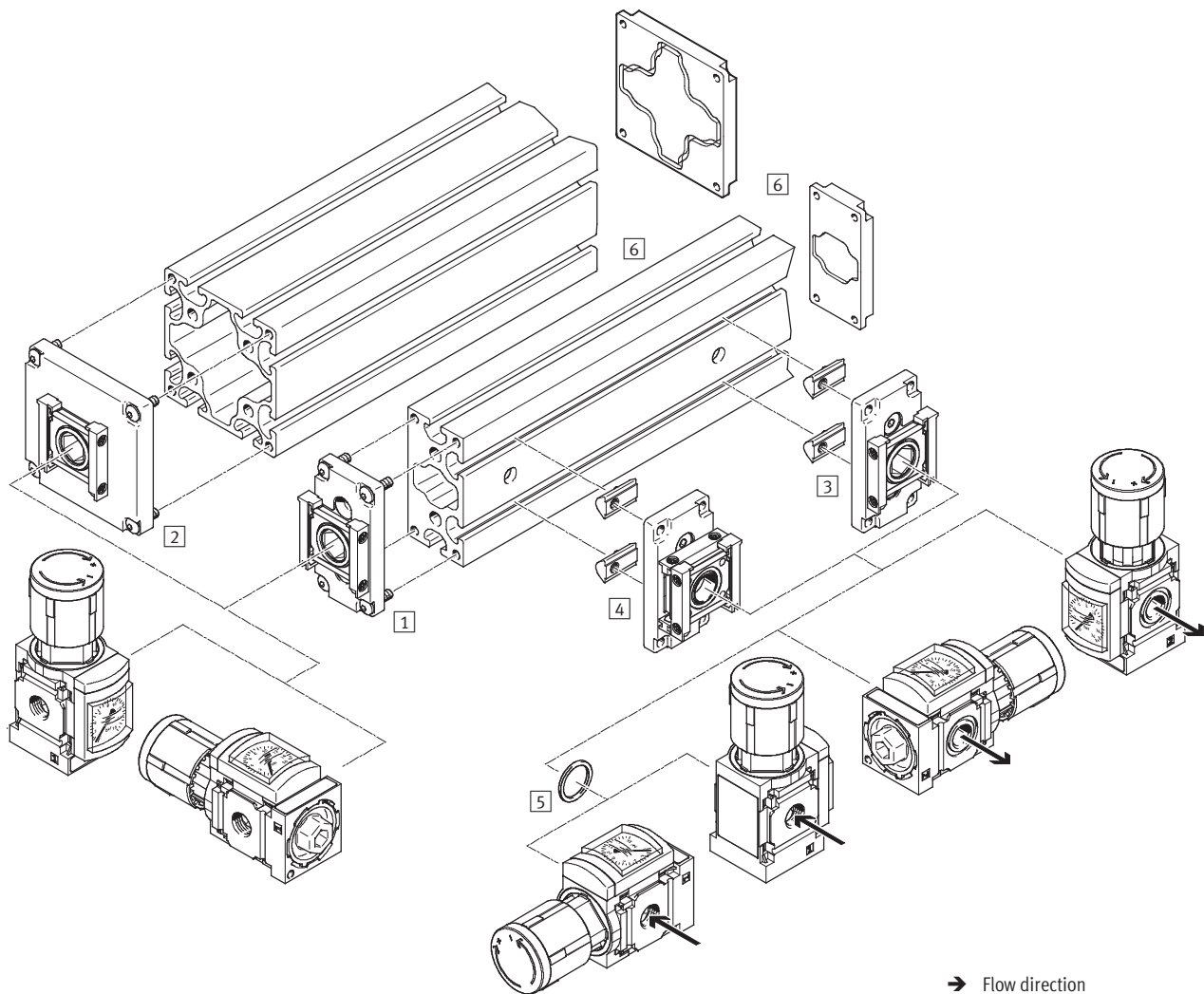

Mounting attachments		→ Page/Internet
1	Power supply module MS4/6-E-IPM-40-80	25
2	Power supply module MS4/6-E-IPM-80-80	26
3	Branching module MS4/6-A-IPM-80	27
4	Branching module MS4/6-A-RMV-IPM-80	28
5	Sealing ring MS4/6-NNR	29
6	Profile 40x80/80x80, cover plate, supply plate, drilling jig	On request

Note

Further mounting attachments are required for mounting a service unit combination → 6

Accessories, MS series

Mounting attachments MS4/MS6

FESTO

Power supply module

MS4/6-E-IPM-40-80

- For mounting a service unit to the front of a profile of size 40x80
- Module connector can be repositioned by 90° for horizontal mounting of a service unit

Material:

Connecting plate, hollow bolt, module connector: Die-cast aluminium

Screws: Steel

Seals: Nitrile rubber

RoHS-compliant

Temperature of medium:

-10 ... +60 °C

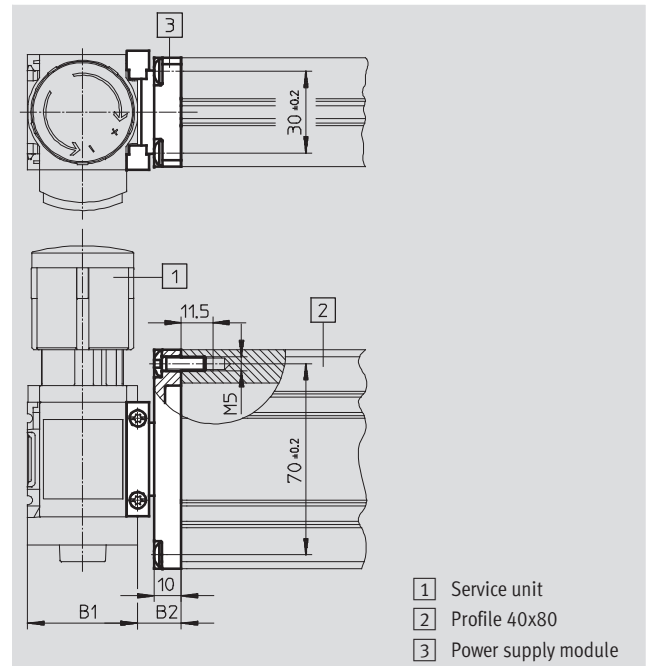

Dimensions and ordering data						
Size	B1	B2	CRC ¹⁾	Weight [g]	Part No.	Type
MS4	40.2	16	2	109	543494	MS4-E-IPM-40-80
MS6	62	16	2	141	543496	MS6-E-IPM-40-80

1) Corrosion resistance class 2 as per Festo standard 940 070
Components subject to moderate corrosion stress. Externally visible parts with primarily decorative surface requirements which are in direct contact with a normal industrial environment or media such as coolants or lubricating agents.

Accessories, MS series

Mounting attachments MS4/MS6

FESTO

Power supply module

MS4/6-E-IPM-80-80

- For mounting a service unit to the front of a profile of size 80x80
- Module connector can be repositioned by 90° for horizontal mounting of a service unit

Material:

Connecting plate, hollow bolt, module

connector: Die-cast aluminium

Screws: Steel

Seals: Nitrile rubber

RoHS-compliant

Temperature of medium:

-10 ... +60 °C

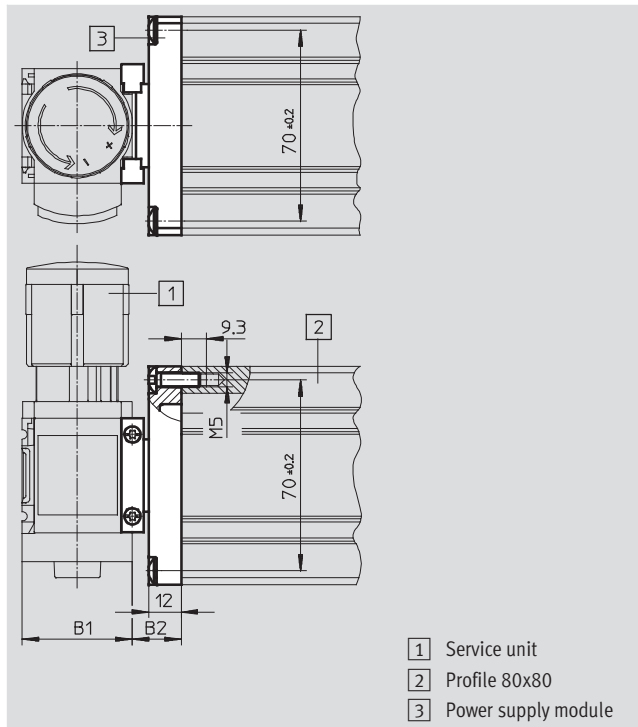

Dimensions and ordering data						
Size	B1	B2	CRC ¹⁾	Weight [g]	Part No.	Type
MS4	40.2	18	2	186	543495	MS4-E-IPM-80-80
MS6	62	18	2	218	543497	MS6-E-IPM-80-80

1) Corrosion resistance class 2 as per Festo standard 940 070

Components subject to moderate corrosion stress. Externally visible parts with primarily decorative surface requirements which are in direct contact with a normal industrial environment or media such as coolants or lubricating agents.

Accessories, MS series

Mounting attachments MS4/MS6

FESTO

Branching module MS4/6-A-IPM-80

- For mounting a service unit on the long side of a profile
- Module connector can be repositioned by 90° for horizontal mounting of a service unit

Material:

Connecting plate, hollow bolt, module connector: Die-cast aluminium

Screws: Steel

Seals: Nitrile rubber

RoHS-compliant

Temperature of medium:

-10 ... +60 °C

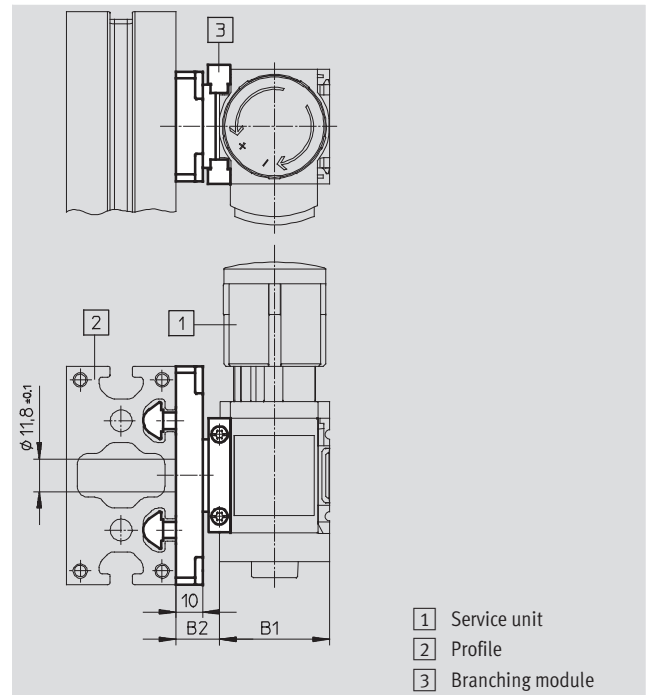
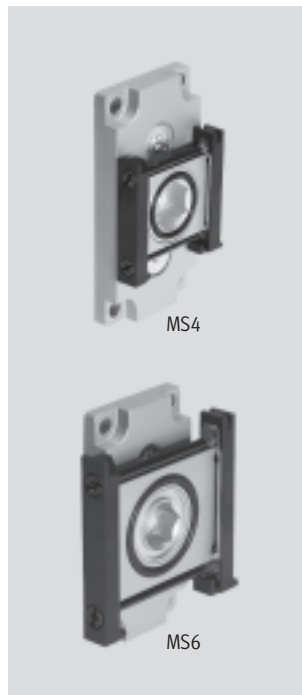

Dimensions and ordering data						
Size	B1	B2	CRC ¹⁾	Weight [g]	Part No.	Type
MS4	40.2	16	2	124	543498	MS4-A-IPM-80
MS6	62	16	2	156	543499	MS6-A-IPM-80

1) Corrosion resistance class 2 as per Festo standard 940 070

Components subject to moderate corrosion stress. Externally visible parts with primarily decorative surface requirements which are in direct contact with a normal industrial environment or media such as coolants or lubricating agents.

Accessories, MS series

Mounting attachments MS4/MS6

FESTO

Branching module

MS4/6-A-RMV-IPM-80

- For mounting a service unit on the long side of a profile
- Suitable for manifold mounting (the fittings on the module connector can be accessed from above for fast replacement of an individual component)
- Module connector can be repositioned by 90° for horizontal mounting of a service unit

Material:

Connecting plate, hollow bolt,

module connector:

Die-cast aluminium

Screws: Steel

Seals: Nitrile rubber

RoHS-compliant

Temperature of medium:

-10 ... +60 °C

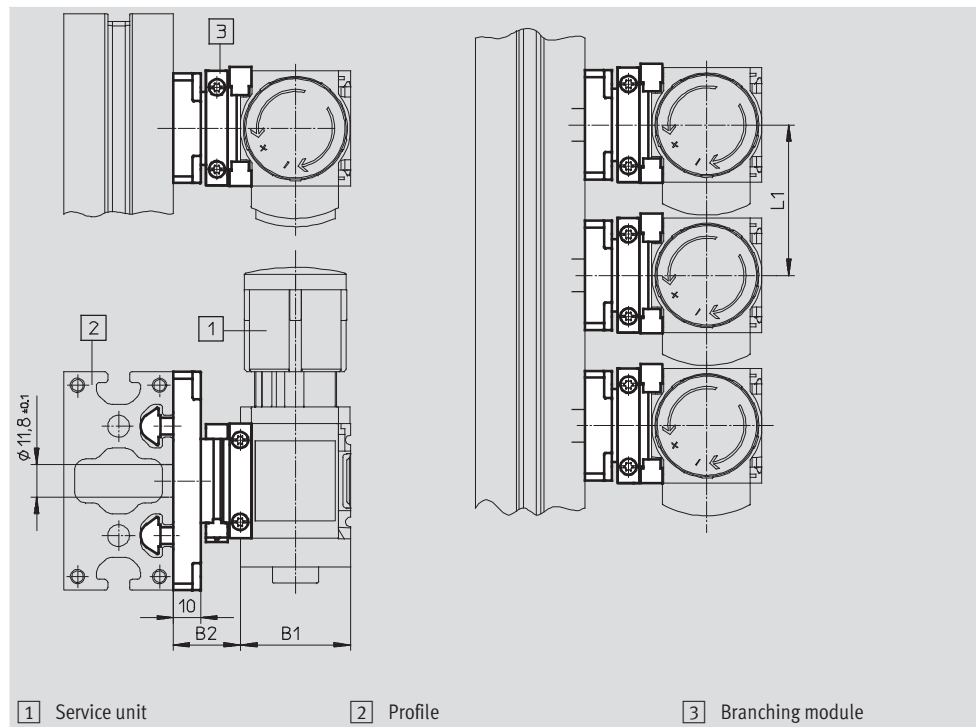
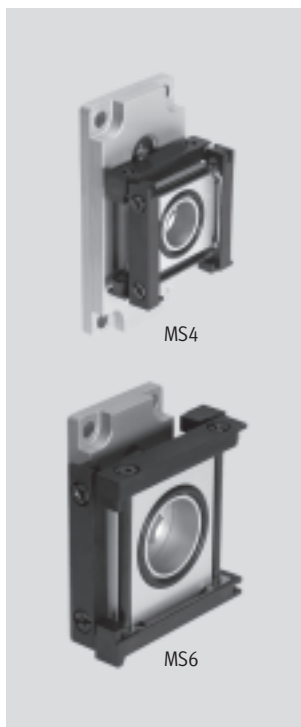

Dimensions and ordering data							
Size	B1	B2	L1	CRC ¹⁾	Weight [g]	Part No.	Type
MS4	40.2	24.5	55	2	150	543500	MS4-A-RMV-IPM-80
MS6	62	27	77	2	236	543501	MS6-A-RMV-IPM-80

1) Corrosion resistance class 2 as per Festo standard 940 070

Components subject to moderate corrosion stress. Externally visible parts with primarily decorative surface requirements which are in direct contact with a normal industrial environment or media such as coolants or lubricating agents.

Accessories, MS series

Mounting attachments MS4/MS6

Sealing ring MS4/6-NNR

- For sealing a branching module
MS-A-IPM when used as a power
supply module

Material:

Nitrile rubber

RoHS-compliant

Temperature of medium:

-10 ... +60 °C



Dimensions and ordering data			
Size	CRC ¹⁾	Part No.	Type
MS4	2	543492	MS4-NNR
MS6	2	543493	MS6-NNR

1) Corrosion resistance class 2 as per Festo standard 940 070

Components subject to moderate corrosion stress. Externally visible parts with primarily decorative surface requirements which are in direct contact with a normal industrial environment or media such as coolants or lubricating agents.

Accessories, MS series

Connecting plates MS4/MS6

FESTO

Connecting plate MS4/6-AG...

(order code: AG...)

- Adapter for pneumatic connection
- MS6-AGE for implementing threaded connection G $\frac{3}{4}$

Material:
Aluminium

Note on materials:
RoHS-compliant (MS6-AG... only)
Free of copper and PTFE

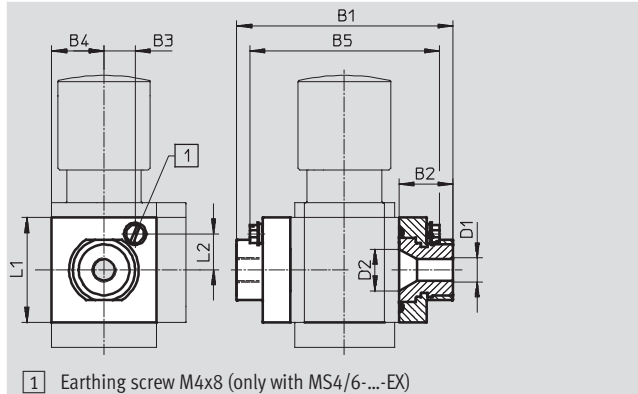

Dimensions and ordering data													
Size	B1	B2	B3	B4	B5	D1	D2	L1	L2	CRC ¹⁾	Weight [g]	Part No.	Type
MS4	83.5	21.5	–	21	–	G ¹ / ₈	16.8	42	–	2	128	526068	MS4-AGA
						G ¹ / ₄				2	128	526069	MS4-AGB
						G ³ / ₈				2	128	526070	MS4-AGC
MS6	115	26.5	–	31	–	G ¹ / ₄	24	62	–	2	300	526080	MS6-AGB
						G ³ / ₈				2	300	526081	MS6-AGC
						G ¹ / ₂				2	300	526082	MS6-AGD
						G ³ / ₄				2	300	526083	MS6-AGE
For use in explosive areas in zones 2 and 22													
MS4	83.5	21.5	12.5	21	72.5	G ¹ / ₈	16.8	42	14.5	2	128	541549	MS4-AGA-EX
						G ¹ / ₄				2	128	541550	MS4-AGB-EX
						G ³ / ₈				2	128	541551	MS4-AGC-EX
MS6	115	26.5	20.5	31	98.3	G ¹ / ₄	24	62	15.5	2	300	541538	MS6-AGB-EX
						G ³ / ₈				2	300	541539	MS6-AGC-EX
						G ¹ / ₂				2	300	541540	MS6-AGD-EX
						G ³ / ₄				2	300	541541	MS6-AGE-EX

1) Corrosion resistance class 2 as per Festo standard 940 070

Components subject to moderate corrosion stress. Externally visible parts with primarily decorative surface requirements which are in direct contact with a normal industrial environment or media such as coolants or lubricating agents.

Note: This product conforms to ISO 1179-1 and ISO 228-1

Accessories, MS series

FESTO

Connecting plates MS4/MS6

Cover plate MS4/6-END

- Can be used to cover the body sides of the first and last module if connecting plates are not used

Material:

Reinforced polyamide

Free of copper and PTFE

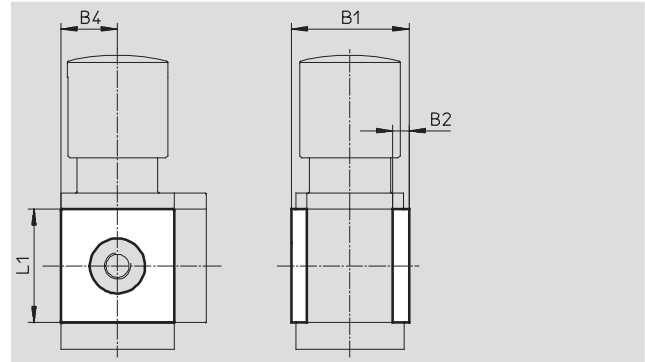
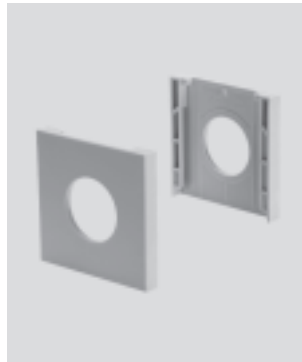

Dimensions and ordering data						
Size	B1	B2	B4	L1	Part No.	Type
MS4	43.6	6	21	42	538779	MS4-END
MS6	67	8	31	62	538780	MS6-END

Mounting plate MS4/6-AEND

(order code: WBE; scope of delivery includes wall mounting plate MS6-WPB)

- In combination with mounting bracket MS-WP or MS-WPB for individual wall mounting via direct thread

Material:

Reinforced polyamide

RoHS-compliant

Free of copper and PTFE

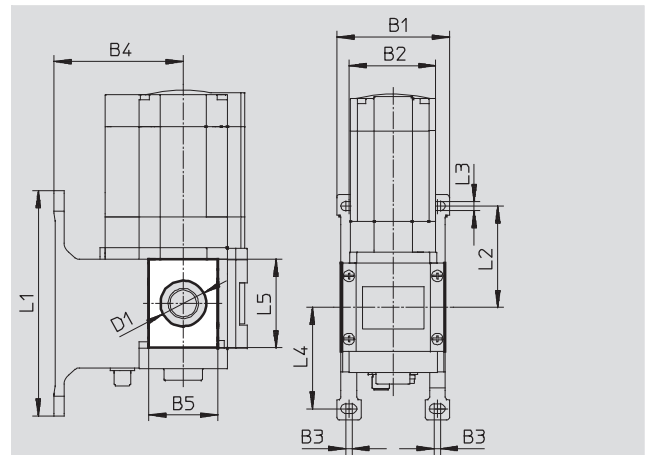
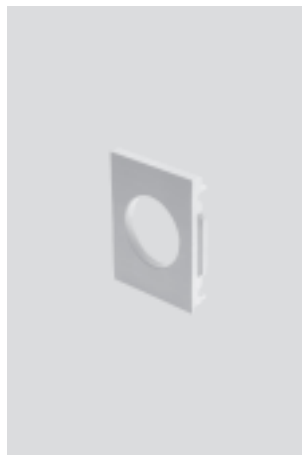

Dimensions and ordering data																
Size	B1	B2	B3	B4		B5	D1	L1	L2	L3	L4	L5	CRC ¹⁾	Weight [g]	Part No.	Type
				WP	WPB											
MS4	55.2	40.2	4	44	66	30.4	20.3	106	46.5	5.6	46.7	42	2	4	542966	MS4-AEND
MS6	79	62	4.5	54	90.5	48.4	32	158	71	6.6	71	62	2	17	535408	MS6-AEND

1) Corrosion resistance class 2 as per Festo standard 940 070

Components subject to moderate corrosion stress. Externally visible parts with primarily decorative surface requirements which are in direct contact with a normal industrial environment or media such as coolants or lubricating agents.

Accessories, MS series

Connecting plates MS9

FESTO

Connecting plate MS9-AG...

(order code: AG...)

- Adapter for pneumatic connection

Material:

Connecting plate, hollow bolt:

Die-cast aluminium

Seals: Nitrile rubber

RoHS-compliant

Free of copper and PTFE

Temperature of medium:

-10 ... +60 °C

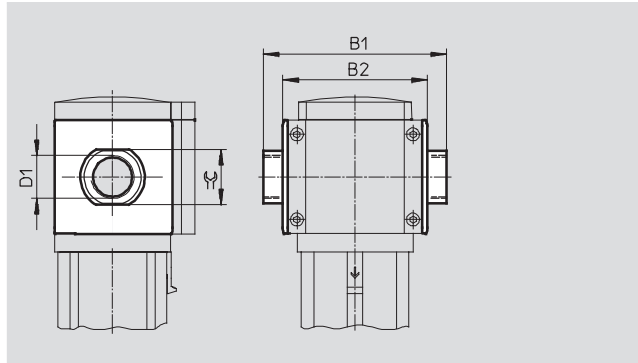

Dimensions and ordering data								
Size	B1	B2	D1	$\approx \text{C}$	KBK1)	Weight [g]	Part No.	Type
MS9	132	112	G1/2	30	2	300	552954	MS9-AGD
	132	112	G3/4	36	2	300	552955	MS9-AGE
	142	112	G1	41	2	300	552956	MS9-AGF
	162	112	G1 1/4	50	2	400	552957	MS9-AGG
	176	112	G1 1/2	55	2	400	552958	MS9-AGH

1) Corrosion resistance class 2 as per Festo standard 940 070

Components subject to moderate corrosion stress. Externally visible parts with primarily decorative surface requirements which are in direct contact with a normal industrial environment or media such as coolants or lubricating agents.

Note: This product conforms to ISO 1179-1 and ISO 228-1

Accessories, MS series



Connecting plates MS12

Connecting plate MS12-AG...
(order code: AG...)

- Adapter for pneumatic connection

Material:
Die-cast aluminium
Free of copper and PTFE

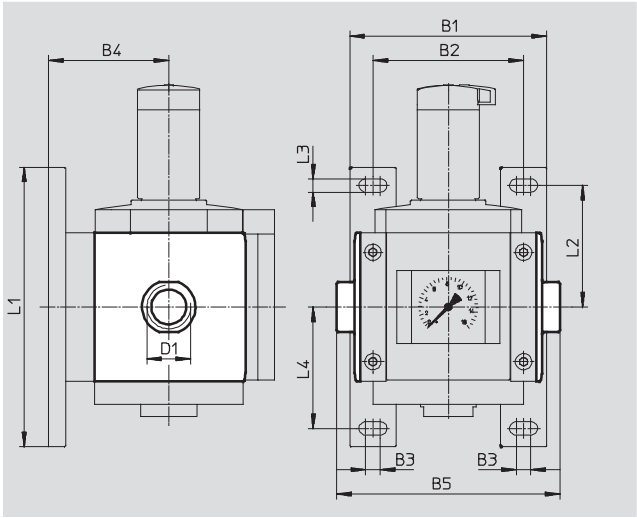

Dimensions and ordering data													
Size	B1	B2	B3	B4	B5	D1	L1	L2	L3	L4	Weight [g]	Part No.	Type
MS12	162	124	12	99	184	G1	230	100	11	100	1,300	537135	MS12-AGF
					184	G1¼						537136	MS12-AGG
					184	G1½						537137	MS12-AGH
					196	G2						537138	MS12-AGI

Note: This product conforms to ISO 1179-1 and ISO 228-1

Accessories, MS series

Security components MS4/MS6/MS9/MS12

FESTO

Padlock LRV5-D

Material:

Housing: Brass

Ambient temperature:

-20 ... +60 °C



Ordering data			
Size	Weight [g]	Part No.	Type
MS4/MS6/ MS9/MS12	120	193786	LRV5-D

Product Range and Company Overview

A Complete Suite of Automation Services

Our experienced engineers provide complete support at every stage of your development process, including: conceptualization, analysis, engineering, design, assembly, documentation, validation, and production.



Custom Automation Components
Complete custom engineered solutions



Custom Control Cabinets
Comprehensive engineering support and on-site services



Complete Systems
Shipment, stocking and storage services

The Broadest Range of Automation Components

With a comprehensive line of more than 30,000 automation components, Festo is capable of solving the most complex automation requirements.



Electromechanical
Electromechanical actuators, motors, controllers & drives



Pneumatics
Pneumatic linear and rotary actuators, valves, and air supply



PLCs and I/O Devices
PLC's, operator interfaces, sensors and I/O devices

Supporting Advanced Automation... As No One Else Can!

Festo is a leading global manufacturer of pneumatic and electromechanical systems, components and controls for industrial automation, with more than 12,000 employees in 56 national headquarters serving more than 180 countries. For more than 80 years, Festo has continuously elevated the state of manufacturing with innovations and optimized motion control solutions that deliver higher performing, more profitable automated manufacturing and processing equipment. Our dedication to the advancement of automation extends beyond technology to the education and development of current and future automation and robotics designers with simulation tools, teaching programs, and on-site services.

Quality Assurance, ISO 9001 and ISO 14001 Certifications

Festo Corporation is committed to supply all Festo products and services that will meet or exceed our customers' requirements in product quality, delivery, customer service and satisfaction.

To meet this commitment, we strive to ensure a consistent, integrated, and systematic approach to management that will meet or exceed the requirements of the ISO 9001 standard for Quality Management and the ISO 14001 standard for Environmental Management.



© Copyright 2008, Festo Corporation. While every effort is made to ensure that all dimensions and specifications are correct, Festo cannot guarantee that publications are completely free of any error, in particular typing or printing errors. Accordingly, Festo cannot be held responsible for the same. For Liability and Warranty conditions, refer to our "Terms and Conditions of Sale", available from your local Festo office. All rights reserved. No part of this publication may be reproduced, distributed, or transmitted in any form or by any means, electronic, mechanical, photocopying or otherwise, without the prior written permission of Festo. All technical data subject to change according to technical update.



Printed on recycled paper at New Horizon Graphic, Inc., FSC certified as an environmentally friendly printing plant.

Festo North America

Festo Regional Contact Center

5300 Explorer Drive
Mississauga, Ontario L4W 5G4
Canada

USA Customers:

For ordering assistance,

Call: 1.800.99.FESTO (1.800.993.3786)

Fax: 1.800.96.FESTO (1.800.963.3786)

Email: customer.service@us.festo.com

For technical support,

Call: 1.866.GO.FESTO (1.866.463.3786)

Fax: 1.800.96.FESTO (1.800.963.3786)

Email: product.support@us.festo.com

Canadian Customers:

Call: 1.877.GO.FESTO (1.877.463.3786)

Fax: 1.877.FX.FESTO (1.877.393.3786)

Email: festo.canada@ca.festo.com

USA Headquarters

Festo Corporation
395 Moreland Road
P.O. Box 18023
Hauppauge, NY 11788, USA
www.festo.com/us

USA Sales Offices

Appleton

North 922 Tower View Drive, Suite N
Greenville, WI 54942, USA

Boston

120 Presidential Way, Suite 330
Woburn, MA 01801, USA

Chicago

1441 East Business Center Drive
Mt. Prospect, IL 60056, USA

Dallas

1825 Lakeway Drive, Suite 600
Lewisville, TX 75057, USA

Detroit – Automotive Engineering Center

2601 Cambridge Court, Suite 320
Auburn Hills, MI 48326, USA

New York

395 Moreland Road
Hauppauge, NY 11788, USA

Silicon Valley

4935 Southfront Road, Suite F
Livermore, CA 94550, USA

United States



USA Headquarters, East: Festo Corp., 395 Moreland Road, Hauppauge, NY 11788

Phone: 1.631.435.0800; Fax: 1.631.435.8026;

Email: info@festo-usa.com

www.festo.com/us

Canada



Headquarters: Festo Inc., 5300 Explorer Drive, Mississauga, Ontario L4W 5G4

Phone: 1.905.624.9000; Fax: 1.905.624.9001;

Email: festo.canada@ca.festo.com

www.festo.ca

Mexico



Headquarters: Festo Pneumatic, S.A., Av. Ceylán 3, Col. Tequesquahuac,
54020 Tlalneapantla, Edo. de México

Phone: 011 52 [55] 53 21 66 00; Fax: 011 52 [55] 53 21 66 65;

Email: festo.mexico@mx.festo.com

www.festo.com/mx

Central USA

Festo Corporation
1441 East Business
Center Drive
Mt. Prospect, IL 60056, USA
Phone: 1.847.759.2600
Fax: 1.847.768.9480



Western USA

Festo Corporation
4935 Southfront Road,
Suite F
Livermore, CA 94550, USA
Phone: 1.925.371.1099
Fax: 1.925.245.1286



Festo Worldwide

Argentina Australia Austria Belarus Belgium Brazil Bulgaria Canada Chile China Colombia Croatia Czech Republic Denmark
Estonia Finland France Germany Great Britain Greece Hong Kong Hungary India Indonesia Iran Ireland Israel Italy Japan Latvia
Lithuania Malaysia Mexico Netherlands New Zealand Norway Peru Philippines Poland Romania Russia Serbia Singapore
Slovakia Slovenia South Africa South Korea Spain Sweden Switzerland Taiwan Thailand Turkey Ukraine United States Venezuela

www.festo.com