

Exhaust air flow control valves



FESTO



Exhaust air flow control valves

FESTO

Product range overview and type codes

Version	Valve function	Version	Type	Connection direction	Pneumatic connection 1	qnN ¹⁾ [l/min]	Adjustment component	→ Page/ Internet
Exhaust air flow control valve	Metal							
	Flow control/silencer function		GRE	Inline	G1/8, G1/4, G3/8, G1/2	520 ... 3,600	Slotted head screw	3
Flow control/silencer	Polymer							
	Flow control/silencer function		GRU	Inline	G1/8, G1/4, G3/8, G1/2, G3/4	1,000 ... 8,000	Slotted head screw	5

1) Standard nominal flow rate in direction of flow control.

Type codes

		GRU	-	1/4	-	B
Type						
GRE	Exhaust air flow control valve					
GRU	Flow control/silencer					
Pneumatic connection 1						
1/8	Thread G1/8					
1/4	Thread G1/4					
3/8	Thread G3/8					
1/2	Thread G1/2					
3/4	Thread G3/4					
Generation						
B	B series					

Exhaust air flow control valves GRE

FESTO

Technical data

Function

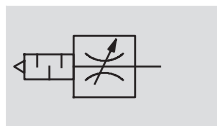

Flow rate

520 ... 3,600 l/min

Temperature range

-10 ... +70 °C

Pressure

0 ... 10 bar



General technical data				
Valve function	Flow control/silencer function			
Pneumatic connection 1	G $\frac{1}{8}$	G $\frac{1}{4}$	G $\frac{3}{8}$	G $\frac{1}{2}$
Adjustment component	Slotted head screw			
Type of mounting	Screw-in			
Mounting position	Any			
Max. tightening torque [Nm]	–	–	15	–

Operating and environmental conditions				
Pneumatic connection 1	G $\frac{1}{8}$	G $\frac{1}{4}$	G $\frac{3}{8}$	G $\frac{1}{2}$
Operating pressure [bar]	0 ... 10			
Operating medium	Compressed air in accordance with ISO 8573-1:2010 [7:-:-]	Compressed air in accordance with ISO 8573-1:2010 [7:-:-]	Compressed air in accordance with ISO 8573-1:2010 [7:4:4]	Compressed air in accordance with ISO 8573-1:2010 [7:-:-]
Note on operating/pilot medium	Operation with lubricated medium possible (in which case lubricated operation will always be required)			
Ambient temperature [°C]	-10 ... +70			
Temperature of medium [°C]	-10 ... +70			

Standard nominal flow rate q_{nN} at 6 bar → 5 bar as a function of spindle rotations n

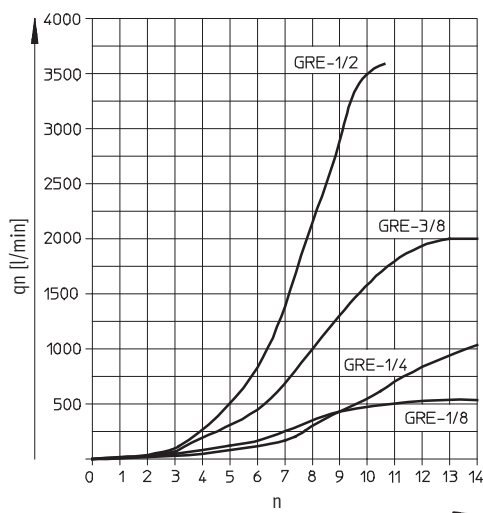

Exhaust air flow control valves GRE

Technical data

FESTO

Materials

Sectional view

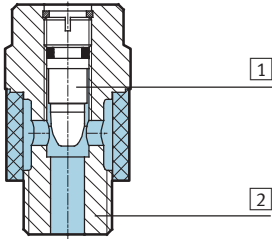

Exhaust air flow control valve

1	Adjusting screw	Brass
2	Threaded plug	Wrought aluminium alloy
–	Seals	NBR
Note on materials		
GRE-3/8		RoHS-compliant

Dimensions

Download CAD Data → www.festo.com/us/cad

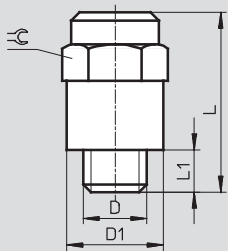

Type	Connection D	D1 Ø	L	L1	≡
GRE-1/8	G1/8	15	28.5	6.5	14
GRE-1/4	G1/4	18.2	34	8	17
GRE-3/8	G3/8	25	42	8	22
GRE-1/2	G1/2	27	48	12	24

Ordering data

	Pneumatic connection 1	Standard nominal flow rate qnN at 6 bar → 5 bar in direction of flow control [l/min]	Standard flow rate qn at 6 bar → 0 bar in direction of flow control [l/min]	Weight [g]	Part No.	Type
	G1/8	520	0 ... 520	15	10351	GRE-1/8
	G1/4	996	0 ... 996	25	10352	GRE-1/4
	G3/8	2,000	3 ... 2,000	50	35310	GRE-3/8
	G1/2	3,600	0 ... 3,600	75	10353	GRE-1/2

Flow control/silencers GRU

FESTO

Technical data

Function

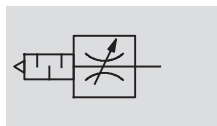

Flow rate

1,000 ... 8,000 l/min

Temperature range

-10 ... +70 °C

Pressure

0 ... 10 bar



General technical data					
Valve function	Flow control/silencer function				
Pneumatic connection 1	G1/8	G1/4	G3/8	G1/2	G3/4
Adjustment component	Slotted head screw				
Type of mounting	Screw-in				
Mounting position	Any				

Operating and environmental conditions	
Operating pressure [bar]	0 ... 10
Operating medium	Filtered compressed air, lubricated or unlubricated
Ambient temperature [°C]	-10 ... +70
Temperature of medium [°C]	-10 ... +70

Standard nominal flow rate q_{nN} at 6 bar \rightarrow 5 bar as a function of spindle rotations n

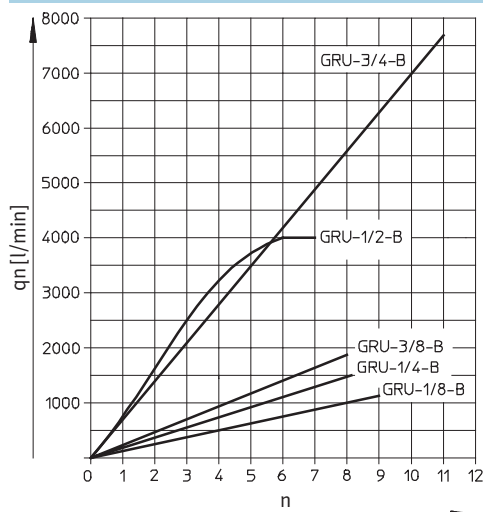

Materials

Sectional view

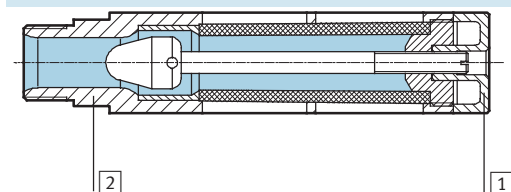

Flow control/silencer		
1	Adjusting screw	PA
2	Threaded plug	Die-cast aluminium

Flow control/silencers GRU

Technical data

FESTO

Dimensions

Download CAD Data → www.festo.com/us/cad

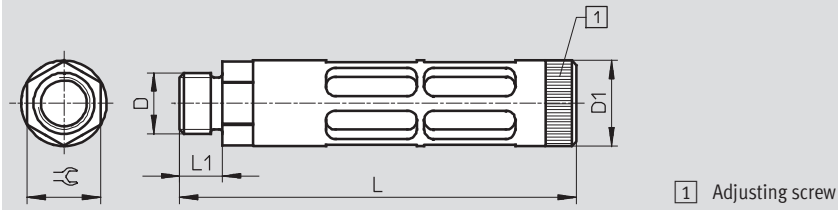

Type	Connection D	D1 Ø	L	L1	↗
GRU-1/8	G1/8	16	46	5.4	14
GRU-1/4	G1/4	19.5	63.3	6.4	17
GRU-3/8	G3/8	25	95.3	7.5	19
GRU-1/2	G1/2	28	130	14	24
GRU-3/4	G3/4	38	157	16	32

Ordering data

	Pneumatic connection 1	Standard nominal flow rate q _{nN} at 6 bar → 5 bar in direction of flow control [l/min]	Standard flow rate q _n at 6 bar → 0 bar in direction of flow control [l/min]	Weight [g]	Part No.	Type
	G1/8	1,000	0 ... 1,000	10	9516	GRU-1/8-B
	G1/4	1,500	0 ... 1,500	25	9517	GRU-1/4-B
	G3/8	1,700	0 ... 1,700	55	9518	GRU-3/8-B
	G1/2	4,000	0 ... 4,000	100	9519	GRU-1/2-B
	G3/4	8,000	0 ... 8,000	170	9520	GRU-3/4-B

Product Range and Company Overview

A Complete Suite of Automation Services

Our experienced engineers provide complete support at every stage of your development process, including: conceptualization, analysis, engineering, design, assembly, documentation, validation, and production.



Custom Automation Components
Complete custom engineered solutions



Custom Control Cabinets
Comprehensive engineering support and on-site services



Complete Systems
Shipment, stocking and storage services

The Broadest Range of Automation Components

With a comprehensive line of more than 30,000 automation components, Festo is capable of solving the most complex automation requirements.



Electromechanical
Electromechanical actuators, motors, controllers & drives



Pneumatics
Pneumatic linear and rotary actuators, valves, and air supply



PLCs and I/O Devices
PLC's, operator interfaces, sensors and I/O devices

Supporting Advanced Automation... As No One Else Can!

Festo is a leading global manufacturer of pneumatic and electromechanical systems, components and controls for industrial automation, with more than 12,000 employees in 56 national headquarters serving more than 180 countries. For more than 80 years, Festo has continuously elevated the state of manufacturing with innovations and optimized motion control solutions that deliver higher performing, more profitable automated manufacturing and processing equipment. Our dedication to the advancement of automation extends beyond technology to the education and development of current and future automation and robotics designers with simulation tools, teaching programs, and on-site services.

Quality Assurance, ISO 9001 and ISO 14001 Certifications

Festo Corporation is committed to supply all Festo products and services that will meet or exceed our customers' requirements in product quality, delivery, customer service and satisfaction.

To meet this commitment, we strive to ensure a consistent, integrated, and systematic approach to management that will meet or exceed the requirements of the ISO 9001 standard for Quality Management and the ISO 14001 standard for Environmental Management.



© Copyright 2008, Festo Corporation. While every effort is made to ensure that all dimensions and specifications are correct, Festo cannot guarantee that publications are completely free of any error, in particular typing or printing errors. Accordingly, Festo cannot be held responsible for the same. For Liability and Warranty conditions, refer to our "Terms and Conditions of Sale", available from your local Festo office. All rights reserved. No part of this publication may be reproduced, distributed, or transmitted in any form or by any means, electronic, mechanical, photocopying or otherwise, without the prior written permission of Festo. All technical data subject to change according to technical update.



Printed on recycled paper at New Horizon Graphic, Inc., FSC certified as an environmentally friendly printing plant.

Festo North America

Festo Regional Contact Center

5300 Explorer Drive
Mississauga, Ontario L4W 5G4
Canada

USA Customers:

For ordering assistance,

Call: 1.800.99.FESTO (1.800.993.3786)

Fax: 1.800.96.FESTO (1.800.963.3786)

Email: customer.service@us.festo.com

For technical support,

Call: 1.866.GO.FESTO (1.866.463.3786)

Fax: 1.800.96.FESTO (1.800.963.3786)

Email: product.support@us.festo.com

Canadian Customers:

Call: 1.877.GO.FESTO (1.877.463.3786)

Fax: 1.877.FX.FESTO (1.877.393.3786)

Email: festo.canada@ca.festo.com

USA Headquarters

Festo Corporation
395 Moreland Road
P.O. Box 18023
Hauppauge, NY 11788, USA
www.festo.com/us

USA Sales Offices

Appleton

North 922 Tower View Drive, Suite N
Greenville, WI 54942, USA

Boston

120 Presidential Way, Suite 330
Woburn, MA 01801, USA

Chicago

1441 East Business Center Drive
Mt. Prospect, IL 60056, USA

Dallas

1825 Lakeway Drive, Suite 600
Lewisville, TX 75057, USA

Detroit – Automotive Engineering Center

2601 Cambridge Court, Suite 320
Auburn Hills, MI 48326, USA

New York

395 Moreland Road
Hauppauge, NY 11788, USA

Silicon Valley

4935 Southfront Road, Suite F
Livermore, CA 94550, USA

United States



USA Headquarters, East: Festo Corp., 395 Moreland Road, Hauppauge, NY 11788

Phone: 1.631.435.0800; Fax: 1.631.435.8026;

Email: info@festo-usa.com

www.festo.com/us

Canada



Headquarters: Festo Inc., 5300 Explorer Drive, Mississauga, Ontario L4W 5G4

Phone: 1.905.624.9000; Fax: 1.905.624.9001;

Email: festo.canada@ca.festo.com

www.festo.ca

Mexico



Headquarters: Festo Pneumatic, S.A., Av. Ceylán 3, Col. Tequesquahuac,
54020 Tlalneapantla, Edo. de México

Phone: 011 52 [55] 53 21 66 00; Fax: 011 52 [55] 53 21 66 65;

Email: festo.mexico@mx.festo.com

www.festo.com/mx

Central USA

Festo Corporation
1441 East Business
Center Drive
Mt. Prospect, IL 60056, USA
Phone: 1.847.759.2600
Fax: 1.847.768.9480



Western USA

Festo Corporation
4935 Southfront Road,
Suite F
Livermore, CA 94550, USA
Phone: 1.925.371.1099
Fax: 1.925.245.1286



Festo Worldwide

Argentina Australia Austria Belarus Belgium Brazil Bulgaria Canada Chile China Colombia Croatia Czech Republic Denmark
Estonia Finland France Germany Great Britain Greece Hong Kong Hungary India Indonesia Iran Ireland Israel Italy Japan Latvia
Lithuania Malaysia Mexico Netherlands New Zealand Norway Peru Philippines Poland Romania Russia Serbia Singapore
Slovakia Slovenia South Africa South Korea Spain Sweden Switzerland Taiwan Thailand Turkey Ukraine United States Venezuela

www.festo.com