

Plastic tubing

FESTO

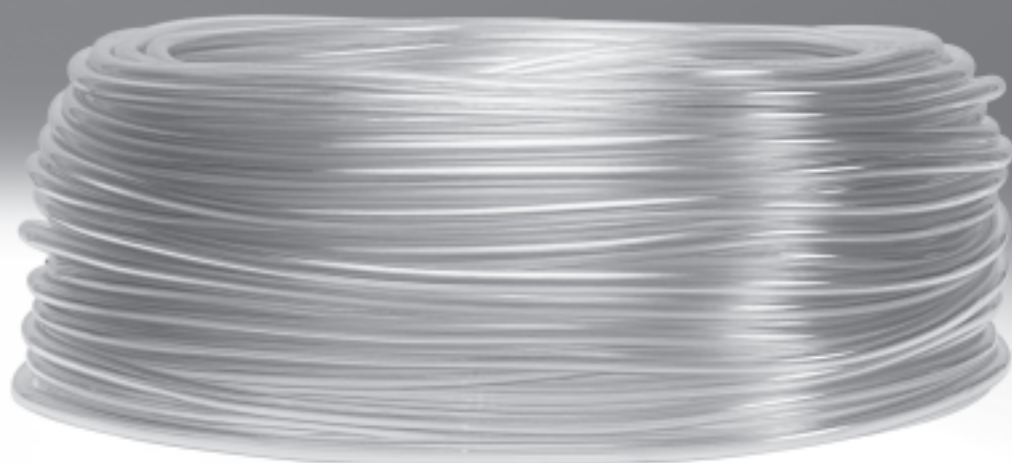

Plastic tubing

Product range overview and Type codes

FESTO

Version	Type	Inside Ø [mm]	Colour			Operating medium			Shore hardness	→ Page/ Internet
			Blue	Black	Natural	Compressed air	Vacuum	Water (not drinking water)		
	PCN Polyvinyl chloride	4	–	–	■	■	–	■	76	4
	P Nitrile rubber	6, 9	■	■	–	■	■	■	68	3
		13, 19							71	

PCN	4	NT								
<table border="1"> <thead> <tr> <th colspan="2">Material</th> </tr> </thead> <tbody> <tr> <td>PCN</td> <td>Polyvinyl chloride</td> </tr> <tr> <td>P</td> <td>Nitrile rubber</td> </tr> </tbody> </table>			Material		PCN	Polyvinyl chloride	P	Nitrile rubber		
Material										
PCN	Polyvinyl chloride									
P	Nitrile rubber									
<table border="1"> <thead> <tr> <th colspan="2">Internal Ø [mm]</th> </tr> </thead> <tbody> <tr><td> </td><td> </td></tr> <tr><td> </td><td> </td></tr> <tr><td> </td><td> </td></tr> </tbody> </table>			Internal Ø [mm]							
Internal Ø [mm]										
<table border="1"> <thead> <tr> <th colspan="2">Colour</th> </tr> </thead> <tbody> <tr> <td>SW</td> <td>Black</td> </tr> <tr> <td>BL</td> <td>Blue</td> </tr> <tr> <td>NT</td> <td>Natural</td> </tr> </tbody> </table>			Colour		SW	Black	BL	Blue	NT	Natural
Colour										
SW	Black									
BL	Blue									
NT	Natural									

Measuring methods

Flow-relevant bending radius Rd

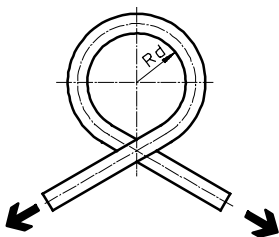

The tubing is bent in the direction of its inherent flexion until a 5% flattening of the tubing O.D. occurs. The Rd is then calculated.

There is no reduction in the flow rate up until the Rd is reached.

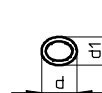

Cross section flattened as a result of bended tubing

d = non deformed tubing OD

d1 = deformed tubing OD

Minimum bending radius Rmin

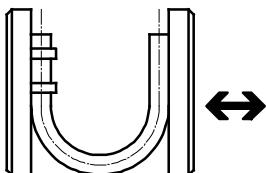

The tubing attached to a movable plate is bent until the deformation results in a kink.

The measured value is the minimum bending radius Rmin. This Rmin leads to considerable reductions in flow.

Rubber hoses P

Technical data

FESTO

Rubber hose P, with textile reinforcement

Compressed air tubing with textile reinforcement, for female hose connector type N

-  - Ambient temperature
-20 ... +80 °C

-  - Temperature dependent
operating pressure
-0.95 ... 16 bar

Material:
P-6/P-9: Nitrile rubber
P-13/P-19: Ethylene propylene
rubber, styrene-butadiene rubber

Note on material:
Free of copper and PTFE
RoHS-conform

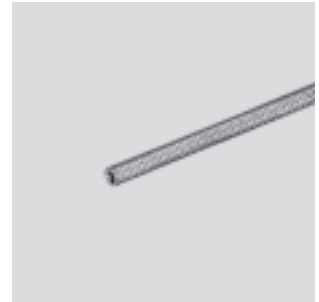

Dimensions and ordering data								
O.D. [mm]	I.D. [mm]	Min. bending radius [mm]	Flow-relevant bending radius [mm]	Weight [kg/m]	Colour	Part No.	Type	PU ¹⁾ [m]
13	6	20	45	0.144	Blue	2231	P-6-BL	40
16	9	30	60	0.186	Blue	2232	P-9-BL	40
23	13	50	100	0.400	Black	2234	P-13-SW	40
31	19	60	200	0.649	Black	2235	P-19-SW	40

1) Packaging unit

Plastic tubing PCN

Technical data

FESTO

Plastic tubing PCN

for use with condensate drains on D series service units

-  - Ambient temperature
-10 ... +60 °C

-  - Temperature dependent
operating pressure
-0.5 ... +0.25 bar

Material:
Polyvinyl chloride with reinforcing
fabric



Dimensions and ordering data						
O.D. [mm]	I.D. [mm]	Weight [kg/m]	Colour	Part No.	Type	PU ¹⁾ [m]
6.5	4	0.025	Natural	7134	PCN-4-NT	50

1) Packaging unit