



- Quick connection couplings with shut-off on one/both sides
- Safety couplings
- Simple release principle
- High flow rates
- Many variants

Quick coupling sockets/plugs

Key features

FESTO

Mode of operation

Quick connection coupling, shut-off on one/both sides

Coupling

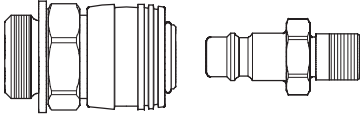

When coupling, the plug is pushed into the socket.

The plug engages automatically when it reaches a certain position.

Decoupling

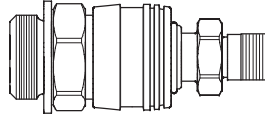

The plug is unlocked by pressing the releasing sleeve.

When decoupling, it is important to make sure that the quick coupling plug is held until the coupling plug is fully exhausted.

Safety coupling

Coupling

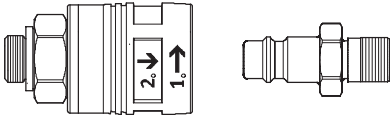

When coupling, the plug is pushed into the socket.

The plug engages automatically when it reaches a certain position.

Decoupling

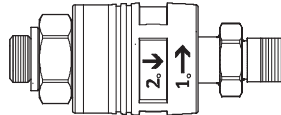

The releasing sleeve is first turned. This is to release the compressed air from the system.

The plug is then unlocked by pulling the releasing sleeve.

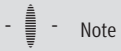



Note

When inserting and releasing couplings, the maximum pressure should be 10 bar.

Quick coupling sockets/plugs

Product range overview

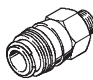
FESTO

Function	Version	Type	Brief description	Max. standard nominal flow rate [l/min]	Nominal size [mm]	→ Page
Quick connection coupling	Shut-off on one side					
		KD1/KS1	For standard applications, without safety function	44	1.5	3 / 5.7-5
		KD2/KS2		139	2.7	3 / 5.7-7
		KD3/KS3		666	5	3 / 5.7-10
		KD4/KS4		1,350	7.2	3 / 5.7-13
		KD5/KS5		2,043	13	3 / 5.7-16
	Shut-off on both sides					
		KD3-A-R/ KS3-A-R	Both ends are sealed during unlocking	666	5	3 / 5.7-18
		KD4-A-R/KS4-A-R		1,350	7.2	3 / 5.7-18
	Safety coupling		KDMS6	The compressed air is released from the system by turning the releasing sleeve. Only then can the coupling be unlocked	2,043	7.8
KDS6/KSS6			1,818			

Coupling/tubing combination options							
Tubing		Quick coupling socket/plug					
		KD1/KS1	KD2/KS2	KD3/KS3	KD4/KS4	KD5/KS5	KDS6/KSS6
Standard I.D.	Polyurethane						
	PU-2	■	—	—	—	—	—
	PU-3	—	■	—	—	—	—
	PU-4	—	■	■	■	—	—
	PU-6	—	—	■	■	—	—
	PU-9	—	—	—	■	—	■
	PU-13	—	—	—	—	■	■
	Nitrile rubber						
	P-6	—	—	—	■	—	—
	P-9	—	—	—	■	—	■
	P-13	—	—	—	—	■	—
	Polyamide						
	PP-3	—	■	—	—	—	—
	PP-4	—	■	■	■	—	—
	PP-6	—	—	■	■	—	—
Standard O.D.	Polyurethane						
	PUN-3	■	—	—	—	—	—
	PUN-4	—	■	—	—	—	—
	PUN-6	—	■	■	■	—	—
	PUN-8	—	—	■	■	—	—
	Polyamide						
	PAN-4	—	■	—	—	—	—
	PAN-6	—	■	■	■	—	—
	PAN-8	—	—	■	■	—	—
	Nitrile rubber with metal braiding (only with KS...-CX quick coupling plug)						
	PX-4	—	—	■	—	—	—
	PX-6	—	—	—	■	—	—
	PX-9	—	—	—	■	—	—

Quick coupling sockets/plugs

Product range overview

FESTO

Quick coupling socket/plug combination options												
Connection	Size 1		Size 2		Size 3 ¹⁾		Size 4 ¹⁾		Size 5		Size 6 ²⁾	
	Socket	Plug	Socket	Plug	Socket	Plug	Socket	Plug	Socket	Plug	Socket	Plug
Male thread												
M3	■	–	–	–	–	–	–	–	–	–	–	–
M5	–	–	■	■	–	–	–	–	–	–	–	–
G ¹ / ₈	–	–	–	–	■	■	–	–	–	–	–	■
G ¹ / ₄	–	–	–	–	■	■	■	■	–	–	■	■
G ³ / ₈	–	–	–	–	–	–	■	■	–	–	■	■
G ¹ / ₂	–	–	–	–	–	–	■	■	–	■	■	■
Female thread												
M5	–	–	■	■	–	–	–	–	–	–	–	–
G ¹ / ₈	–	–	–	–	■	■	–	–	–	–	–	–
G ¹ / ₄	–	–	–	–	■	■	■	■	–	–	■	■
G ³ / ₈	–	–	–	–	–	–	■	■	–	–	■	■
G ¹ / ₂	–	–	–	–	–	–	■	■	■	–	■	■
Quick connector with union nut												
CK-3	–	–	■	■	–	–	–	–	–	–	–	–
CK-4	–	–	■	■	■	■	–	■	–	–	–	–
CK-6	–	–	–	–	■	■	■	■	–	–	–	–
CK-9	–	–	–	–	–	–	■	■	–	–	■	■
CK-13	–	–	–	–	–	–	–	–	–	■	■	■
CX-4	–	–	–	–	–	■ ³⁾	–	–	–	–	–	–
CX-6	–	–	–	–	–	–	–	■ ³⁾	–	–	–	–
CX-9	–	–	–	–	–	–	–	■ ³⁾	–	–	–	–
Bulkhead quick connector												
CK-9-S	–	–	–	–	–	–	■	■	–	–	■	■
Barbed fitting												
CN-2	–	■	–	–	–	–	–	–	–	–	–	–
CN-4	–	–	■	■	–	–	–	–	–	–	–	–
CN-6	–	–	–	–	■	■	–	–	–	–	–	–
N-6	–	–	–	–	–	–	–	■	–	–	–	–
N-9	–	–	–	–	–	–	■	■	–	–	■	■
N-13	–	–	–	–	–	–	–	–	–	■	–	–
Barbed bulkhead connector												
CN-4-S	–	–	■	■	–	–	–	–	–	–	–	–
CN-6-S	–	–	–	–	■	■	–	–	–	–	–	–

1) Quick coupling socket, shut-off on both sides, KD-...-A-R, G¹/₈, G¹/₄ thread only

2) Quick coupling socket KDMS6, G¹/₄, G³/₈, G¹/₂ male thread only

3) For PX tubing only

Quick coupling sockets/plugs KD/KS, shut-off on one side

FESTO

Technical data

Quick connection coupling KD1/KS1



Normal size
1.5 mm

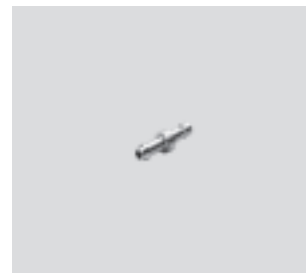

Technical data		
Operating medium		Filtered compressed air, lubricated or unlubricated
Operating pressure ¹⁾	[bar]	-0.95 ... 12
Ambient temperature	[°C]	-10 ... +60
Standard nominal flow rate ²⁾	[l/min]	Max. 44
Corrosion resistance classification	CRC ³⁾	1

1) Safety factor 2.5

2) Measured at p₁ = 6 bar and Δp = 1 bar

3) Corrosion resistance class 1 according to Festo standard 940 070

Components requiring low corrosion resistance. Transport and storage protection. Parts that do not have primarily decorative surface requirements, e.g. in internal areas that are not visible or behind covers.

Weights [g]	With male thread M3	
	With barbed connector CN-2	
Coupling socket	29	–
Coupling plug	–	4

Materials	Coupling socket	
	Coupling plug	
Housing	Brass, nickel-plated	Brass, nickel-plated
Releasing sleeve	Brass, nickel-plated	–

Quick coupling sockets/plugs KD/KS, shut-off on one side

Technical data

FESTO

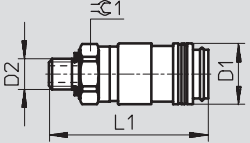
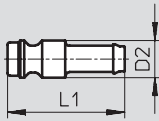
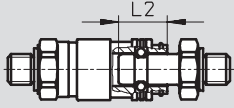
Dimensions		Download CAD data → www.festo.com/en/engineering
Coupling socket Male thread	Coupling plug Barbed fitting	Insertion depth
		

Type	D1 Ø	D2	L1	L2	⌀ 1
Coupling socket					
M3	6.5	M3	18.5	4.6	6
Coupling plug					
CN-2	4	–	12	4.6	–

Ordering data			
Connection	Coupling socket		Coupling plug
	Part No.	Type	Part No. Type
Male thread			
M3	151 995	KD1-M3-A	–
Barbed fitting			
CN-2	–		151 996 KS1-CN-2

Quick coupling sockets/plugs KD/KS, shut-off on one side

FESTO

Technical data

Quick connection coupling KD2/KS2

Ø - Nominal size
2.7 mm

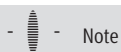

Note

All quick coupling socket types of the same size are compatible with all plugs of this size.



Technical data	
Operating medium	Filtered compressed air, lubricated or unlubricated
Operating pressure ¹⁾ [bar]	-0.95 ... 12
Ambient temperature [°C]	-10 ... +60
Standard nominal flow rate ²⁾ [l/min]	Max. 139
Corrosion resistance classification CRC ³⁾	1

1) Safety factor 2.5

2) Measured at p₁ = 6 bar and Δp = 1 bar

3) Corrosion resistance class 1 according to Festo standard 940 070

Components requiring low corrosion resistance. Transport and storage protection. Parts that do not have primarily decorative surface requirements, e.g. in internal areas that are not visible or behind covers.

Weights [g]	Male thread	Female thread	Quick connector	
	M5	M5	CK-3	CK-4
Quick coupling sockets	10	12	11	16
Quick coupling plugs	5	5	4	11

Weights [g]	Barbed fitting	Barbed bulkhead connector
	CN4	CN-4-S
Quick coupling sockets	11	21
Quick coupling plugs	5	16

Materials		
	Quick coupling socket	Quick coupling plug
Housing	Brass, nickel-plated	Brass, nickel-plated
Releasing sleeve	Brass, nickel-plated	-

Quick coupling sockets/plugs KD/KS, shut-off on one side

Technical data

FESTO

Dimensions – Quick coupling socket

Download CAD data → www.festo.com/en/engineering

Male thread

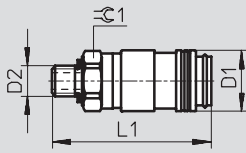

Female thread

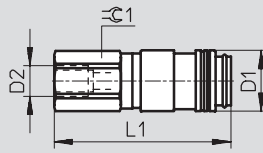

Quick connector

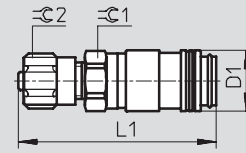

Barbed fitting

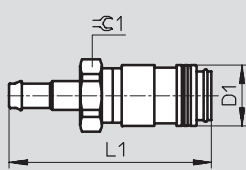

Barbed bulkhead connector

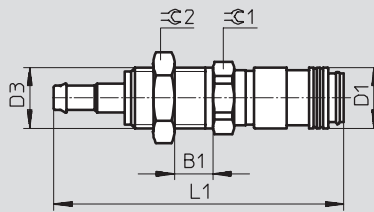

Dimensions – Quick coupling plug

Download CAD data → www.festo.com/en/engineering

Male thread

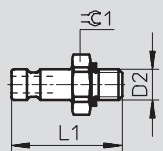

Female thread

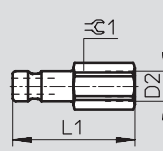

Quick connector

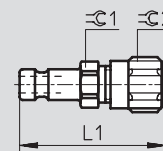

Barbed fitting

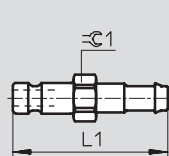

Barbed bulkhead connector

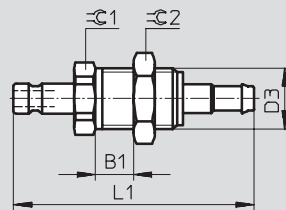

Insertion depth

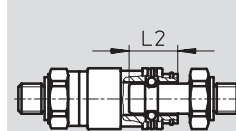

Type	B1	D1 Ø	D2	D3	L1		L2	≙ 1		≙ 2
					Quick coupling socket	Quick coupling plug		Quick coupling socket	Quick coupling plug	
Male thread										
M5	–	10	M5	–	26.25	18.2	7.95	9	9	–
Female thread										
M5	–	10	M5	–	29.05	20	7.95	9	7	–
Quick connector with union nut										
CK-3	–	10	–	–	32.55	24	7.95	9	7	8
CK-4					35.75	27.2		11	11	12
Barbed fitting										
CN-4	–	10	–	–	33.25	25.4	7.95	11	7	–
Barbed bulkhead connector										
CN-4-S	1 ... 10	10	–	M10x1	47.75	39.7	7.95	11	11	13

Quick coupling sockets/plugs KD/KS, shut-off on one side

Technical data

FESTO

Ordering data			
Type	Quick coupling socket		Quick coupling plug
	Part No.	Type	Part No. Type
Male thread			
M5	4 087	KD2-M5-A	531 658 KS2-M5-A
Female thread			
M5	531 620	KD2-M5-I	531 660 KS2-M5-I
Quick connector with union nut			
CK-3	531 621	KD2-CK-3	4 091 KS2-CK-3
CK-4	531 622	KD2-CK-4	4 090 KS2-CK-4
Barbed fitting			
CN-4	531 623	KD2-CN-4	531 663 KS2-CN-4
Barbed bulkhead connector			
CN-4-S	531 624	KD2-CN-4-S	531 664 KS2-CN-4-S

Quick coupling sockets/plugs KD/KS, shut-off on one side

Technical data

FESTO

Quick connection coupling KD3/KS3

-  - Nominal size
5 mm

-  - Note
All quick coupling socket types of the same size are compatible with all plugs of this size.



Technical data	
Operating medium	Filtered compressed air, lubricated or unlubricated
Operating pressure ¹⁾ [bar]	-0.95 ... 12
Ambient temperature [°C]	-10 ... +60
Standard nominal flow rate ²⁾ [l/min]	Max. 666
Corrosion resistance classification CRC ³⁾	1

1) Safety factor 2.5

2) Measured at p₁ = 6 bar and Δp = 1 bar

3) Corrosion resistance class 1 according to Festo standard 940 070

Components requiring low corrosion resistance. Transport and storage protection. Parts that do not have primarily decorative surface requirements, e.g. in internal areas that are not visible or behind covers.

Weights [g]	Male thread		Female thread	
	G ¹ / ₈	G ¹ / ₄	G ¹ / ₈	G ¹ / ₄
Quick coupling sockets	28	35	32	47
Quick coupling plugs	13	23	16	27

Weights [g]	Quick connector			Barbed fitting	Barbed bulkhead connector
	CK-4	CK-6	CX-4	CN-6	CN-6-S
Quick coupling sockets	31	32	–	27	44
Quick coupling plugs	16	21	16	8	32

Materials	
	Quick coupling socket
Housing	Brass, nickel-plated
Releasing sleeve	Brass, nickel-plated
	Quick coupling plug
Housing	Brass, nickel-plated ¹⁾
Releasing sleeve	–

1) KS...-CX quick coupling plug; brass

Quick coupling sockets/plugs KD/KS, shut-off on one side

Technical data

FESTO

Dimensions – Quick coupling socket

Download CAD data → www.festo.com/en/engineering

Male thread

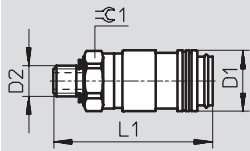

Female thread

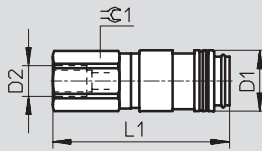

Quick connector

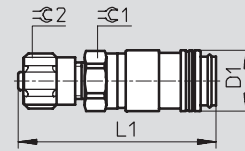

Barbed fitting

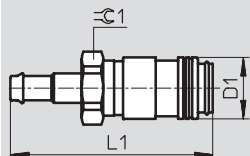

Barbed bulkhead connector

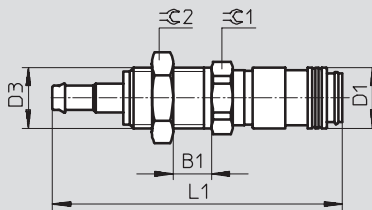

Dimensions – Quick coupling plug

Download CAD data → www.festo.com/en/engineering

Male thread

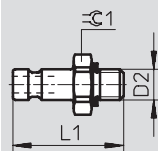

Female thread

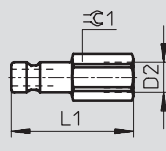

Quick connector

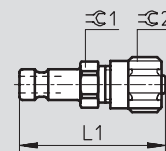

Barbed fitting

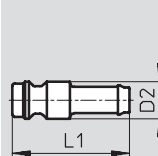

Barbed bulkhead connector

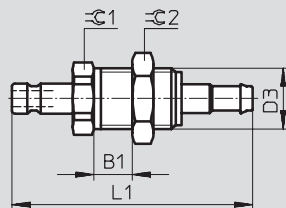

Insertion depth

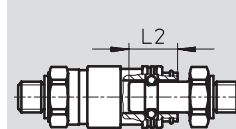

Type	B1	D1 Ø	D2	D3	L1		L2	≈ 1		≈ 2
					Quick coupling socket	Quick coupling plug		Quick coupling socket	Quick coupling plug	
Male thread										
G1/8	–	16	G1/8	–	36	25	13.6	14	13	–
G3/4			G1/4	–	37.6	27.6		17	17	
Female thread										
G1/8	–	16	G1/8	–	38.2	28	13.6	14	13	–
G3/4			G1/4	–	45.2	32.6	13.6	17	17	
Quick connector with union nut										
CK-4	–	16	–	–	43.1	34.5	13.6	14	12	12
CK-6					43.2	34.6			14	14
CX-4	–	–	–	–	–	43	–	–	14	14
Barbed fitting										
CN-6	–	16	9 d10	–	43.2	28.6	13.6	14	–	–
Barbed bulkhead connector										
CN-6-S	1,1 ... 10	16	–	M12x1	58.2	48.6	13.6	17	17	17

Quick coupling sockets/plugs KD/KS, shut-off on one side

FESTO

Technical data

Ordering data			
	Quick coupling socket		Quick coupling plug
	Part No.	Type	Part No. Type
Male thread			
G $\frac{1}{8}$	2 142	KD3- $\frac{1}{8}$ -A	3 492 KS3- $\frac{1}{8}$ -A
G $\frac{1}{4}$	531 626	KD3- $\frac{1}{4}$ -A	531 666 KS3- $\frac{1}{4}$ -A
Female thread			
G $\frac{1}{8}$	531 627	KD3- $\frac{1}{8}$ -I	531 668 KS3- $\frac{1}{8}$ -I
G $\frac{1}{4}$	531 628	KD3- $\frac{1}{4}$ -I	531 669 KS3- $\frac{1}{4}$ -I
Quick connector with union nut			
CK-4	531 629	KD3-CK-4	3 326 KS3-CK-4
CK-6	531 630	KD3-CK-6	3 478 KS3-CK-6
CX-4	–		4 047 KS3-CX-4
Barbed fitting			
CN-6	531 631	KD3-CN-6	531 672 KS3-CN-6
Barbed bulkhead connector			
CN-6-S	531 632	KD3-CN-6-S	531 673 KS3-CN-6-S

Quick coupling sockets/plugs KD/KS, shut-off on one side

FESTO

Technical data

Quick connection coupling KD4/KS4

- Releasing sleeve made from polymer material

Ø - Nominal size
7.2 mm



Note

All quick coupling socket types of the same size are compatible with all plugs of this size.



Technical data	
Operating medium	Filtered compressed air, lubricated or unlubricated
Operating pressure ¹⁾ [bar]	-0.95 ... 12
Ambient temperature [°C]	-10 ... +60
Standard nominal flow rate ²⁾ [l/min]	Max. 1,350
Corrosion resistance classification CRC ³⁾	1

1) Safety factor 2.5

2) Measured at p₁ = 6 bar and Δp = 1 bar

3) Corrosion resistance class 1 according to Festo standard 940 070

Components requiring low corrosion resistance. Transport and storage protection. Parts that do not have primarily decorative surface requirements, e.g. in internal areas that are not visible or behind covers.

Weights [g]	Male thread			Female thread		
	G1/4	G3/8	G1/2	G1/4	G3/8	G1/2
Quick coupling sockets	57	62	78	88	82	86
Quick coupling plugs	21	29	55	31	32	57

Weights [g]	Quick connector					Bulkhead quick connector	Barbed fitting	
	CK-4	CK-6	CK-9	CX-6	CX-9	CK-9-S	N-6	N-9
Quick coupling sockets	-	63	71	-	-	97	-	57
Quick coupling plugs	26	26	26	34	61	69	15	18

Materials		Quick coupling socket	Quick coupling plug
Housing		Brass, nickel-plated	Brass, nickel-plated ¹⁾
Releasing sleeve		Polypropylene	-

1) KS...-CX quick coupling plug: brass

Quick coupling sockets/plugs KD/KS, shut-off on one side

Technical data

FESTO

Dimensions – Quick coupling socket

Download CAD data → www.festo.com/en/engineering

Male thread

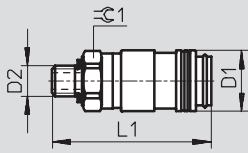

Female thread

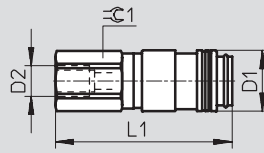

Quick connector

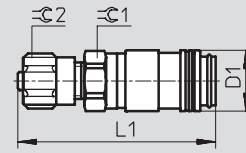

Bulkhead quick connector

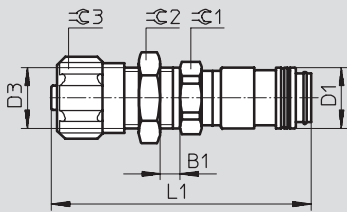

Barbed fitting

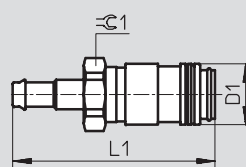

Dimensions – Quick coupling plug

Download CAD data → www.festo.com/en/engineering

Male thread

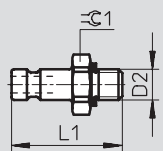

Female thread

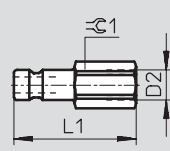

Quick connector

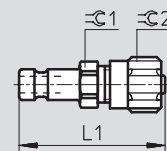

Bulkhead quick connector

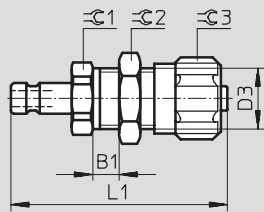

Barbed fitting

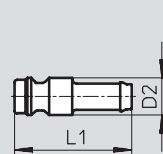

Insertion depth

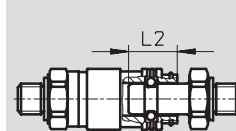

Quick coupling sockets/plugs KD/KS, shut-off on one side

Technical data

FESTO

Type	B1	D1 Ø	D2	D3	L1		L2	≈C 1		≈C 2	≈C 3
					Quick coupling socket	Quick coupling plug		Quick coupling socket	Quick coupling plug		
Male thread											
G¼	-	26.4	G¼	-	40.5	32.5	14.95	22	17	-	-
G¾			G¾		41.5	34			19		
G½			G½		43	37.5			24		
Female thread											
G¼	-	26.4	G¼	-	46	38.5	14.95	22	17	-	-
G¾			G¾		47.5	39.5			19		
G½			G½		50.5	44			24		
Quick connector with union nut											
CK-4	-	-	-	-	-	40.2	14.95	-	17	12	-
CK-6		26.4			46.4	40.3		22		14	
CK-9					49.8	43.7				19	
CX-6		-			-	53	-	17	17		
CX-9						60		19	22		
Bulkhead quick connector with union nut											
CK-9-S	1,2 ... 18,2	26.4	-	M16x1	64.8	57.7	14.95	22	22	19	22
Barbed fitting											
N-6	-	26.4	12	-	-	47	14.95	-	-	-	-
N-9					56.2			21			

Ordering data											
						Quick coupling socket			Quick coupling plug		
						Part No.	Type		Part No.	Type	
Male thread											
G $\frac{1}{4}$		2 143	KD4- $\frac{1}{4}$ -A						2 154	KS4- $\frac{1}{4}$ -A	
G $\frac{3}{8}$		2 144	KD4- $\frac{3}{8}$ -A						2 155	KS4- $\frac{3}{8}$ -A	
G $\frac{1}{2}$		2 145	KD4- $\frac{1}{2}$ -A						531 676	KS4- $\frac{1}{2}$ -A	
Female thread											
G $\frac{1}{4}$		531 636	KD4- $\frac{1}{4}$ -I						531 678	KS4- $\frac{1}{4}$ -I	
G $\frac{3}{8}$		531 637	KD4- $\frac{3}{8}$ -I						531 679	KS4- $\frac{3}{8}$ -I	
G $\frac{1}{2}$		531 638	KD4- $\frac{1}{2}$ -I						531 680	KS4- $\frac{1}{2}$ -I	
Quick connector with union nut											
CK-4		-							2 150	KS4-CK-4	
CK-6		531 639	KD4-CK-6						2 151	KS4-CK-6	
CK-9		531 640	KD4-CK-9						531 683	KS4-CK-9	
CX-6		-							4 048	KS4-CX-6	
CX-9		-							4 049	KS4-CX-9	
Bulkhead quick connector with union nut											
CK-9-S		531 642	KD4-CK-9-S						531 686	KS4-CK-9-S	
Barbed fitting											
N-6		-							2 152	KS4-N-6	
N-9		531 641	KD4-N-9						2 153	KS4-N-9	

Quick coupling sockets/plugs KD/KS, shut-off on one side

Technical data

FESTO

Quick connection coupling KD5/KS5

Ø - Nominal size
13 mm

⌀ - Note

All quick coupling socket types of the same size are compatible with all plugs of this size.



Technical data

Operating medium	Filtered compressed air, lubricated or unlubricated
Operating pressure ¹⁾	[bar] -0.95 ... +12
Ambient temperature	[°C] -10 ... +60
Standard nominal flow rate ²⁾	[l/min] Max. 2 043
Corrosion resistance classification	CRC ³⁾ 1

1) Safety factor 2.5

2) Measured at p₁ = 6 bar and Δp = 1 bar

3) Corrosion resistance class 1 according to Festo standard 940 070

Components requiring low corrosion resistance. Transport and storage protection. Parts that do not have primarily decorative surface requirements, e.g. in internal areas that are not visible or behind covers.

Weights [g]

	Male thread	Female thread	Quick connector	Barbed fitting
	G½	G½	CK-13	N-13
Quick coupling socket	–	413	–	–
Quick coupling plug	255	–	251	256

Materials

	Quick coupling socket	Quick coupling plug
Housing	Galvanised steel	Galvanised steel
Releasing sleeve	Galvanised steel	–

⌀ - Note

The non-return function means that the direction of flow must always follow the direction of the arrow.

Quick coupling sockets/plugs KD/KS, shut-off on one side

Technical data

FESTO

Dimensions – Quick coupling socket

Download CAD data → www.festo.com/en/engineering

Female thread

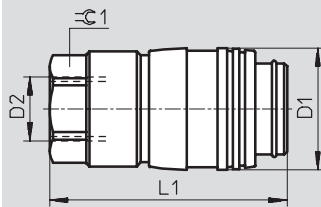

Insertion depth

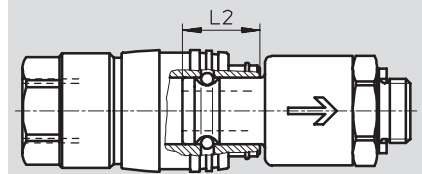

Dimensions – Quick coupling plug

Download CAD data → www.festo.com/en/engineering

Male thread

Quick connector

Barbed fitting

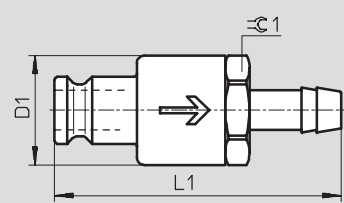
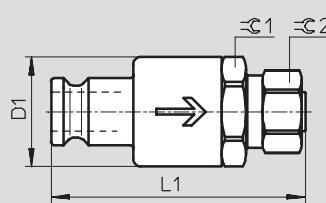
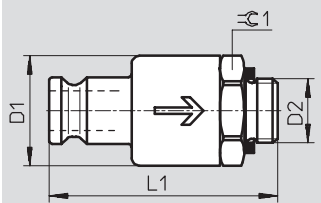

Type	D1 Ø	D2	L1		L2	≈G 1		≈G 2
			Quick coupling socket	Quick coupling plug		Quick coupling socket	Quick coupling plug	
Female thread								
G½	40	G½	78	–	25.5	32	–	–
Male thread								
G½	36	G½	–	74.9	25.5	–	32	–
Quick connector with union nut								
CK-13	36	–	–	83.2	25.5	–	32	24
Barbed fitting								
N-13	36	–	–	94	25.5	–	32	–

Ordering data

	Quick coupling sockets		Quick coupling plugs	
	Part No.	Type	Part No.	Type
Female thread				
G½	4 088	KD5-½-I	–	–
Male thread				
G½	–	–	531 687	KS5-½-A
Quick connector with union nut				
CK-13	–	–	4 096	KS5-CK-13
Barbed fitting				
N-13	–	–	4 089	KS5-N-13

Quick coupling sockets/plugs KD/KS, shut-off on both sides

Technical data

FESTO

Quick connection coupling

KD3-A-R/KS3-A-R

- For applications involving liquid media

Ø - Nominal size
5 mm

⌀ - Note

Only coupling plugs and sockets of the same function and size may be combined.

Ø - Nominal size
7.2 mm



KD3-...-A-R



KS3-...-A-R



KD4-...-A-R



KS4-...-A-R

Technical data		
	KD3/KS3	KD4/KS4
Operating medium	Filtered compressed air, lubricated or unlubricated	
Operating pressure ¹⁾	[bar]	-0.95 ... 12
Ambient temperature	[°C]	-10 ... +60
Standard nominal flow rate ²⁾	[l/min]	Max. 666
Corrosion resistance classification	CRC ³⁾	1

1) Safety factor 2.5

2) Measured at p₁ = 6 bar and Δp = 1 bar

3) Corrosion resistance class 1 according to Festo standard 940 070

Components requiring low corrosion resistance. Transport and storage protection. Parts that do not have primarily decorative surface requirements, e.g. in internal areas that are not visible or behind covers.

Weights [g]		
	KD3/KS3	KD4/KS4
	G ¹ / ₈	G ¹ / ₄
Quick coupling socket	28	58
Quick coupling plug	32	46

Materials				
	Quick coupling socket	Quick coupling plug	Quick coupling socket	Quick coupling plug
	KD3	KS3	KD4	KS4
Housing	Brass		Brass	
Releasing sleeve	Brass	-	Polypropylene	-

Quick coupling sockets/plugs KD/KS, shut-off on both sides

Technical data

FESTO

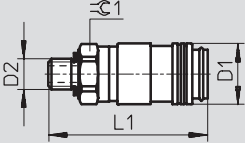
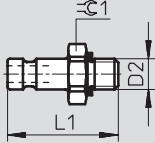
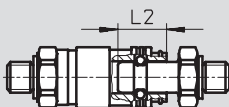
Dimensions		Download CAD data → www.festo.com/en/engineering
Quick coupling socket	Quick coupling plug	Insertion depth
Male thread		
		

Type	D1 Ø	D2	L1		L2	± 0.1	
			Quick coupling socket	Quick coupling plug		Quick coupling socket	Quick coupling plug
male thread							
G1/8	16	G1/8	36	39.8	13.6	14	14
G1/4	26.4	G1/4	40.5	42.5	14.95	22	22

Ordering data				
Connection	Quick coupling socket		Quick coupling plug	
	Part No.	Type	Part No.	Type
G $\frac{1}{8}$	531 659	KD3- $\frac{1}{8}$ -A-R	531 667	KS3- $\frac{1}{8}$ -A-R
G $\frac{1}{4}$	531 694	KD4- $\frac{1}{4}$ -A-R	531 677	KS4- $\frac{1}{4}$ -A-R

Quick coupling sockets/plugs KDMS/KDS/KSS, shut-off on one side

FESTO

Technical data

Safety coupling

- Releasing sleeve made from brass material

Ø - Nominal size
7.8 mm

Ø - Note

All quick coupling socket types of the same size are compatible with all plugs of this size.



KDMS



KSS

Safety coupling

- Releasing sleeve made from polymer material

Ø - Nominal size
7.8 mm

Ø - Note

All quick coupling socket types of the same size are compatible with all plugs of this size.



KDS



KSS

Technical data		
	KDMS	KDS/KSS
Operating medium	Filtered compressed air, lubricated or unlubricated	
Operating pressure ¹⁾ [bar]	-0.95 ... 12	
Ambient temperature [°C]	-10 ... +60	
Standard nominal flow rate ²⁾ [l/min]	Max. 2,043	Max. 1,818
Corrosion resistance classification	1	

1) Safety factor 2.5

2) Measured at p₁ = 6 bar and Δp = 1 bar

3) Corrosion resistance class 1 according to Festo standard 940 070

Components requiring low corrosion resistance. Transport and storage protection. Parts that do not have primarily decorative surface requirements, e.g. in internal areas that are not visible or behind covers.

Weights [g]							
	Male thread				Female thread		
	G ¹ / ₈	G ¹ / ₄	G ³ / ₈	G ¹ / ₂	G ¹ / ₄	G ³ / ₈	G ¹ / ₂
Quick coupling sockets KDMS-...	-	167	170	175	-	-	-
Quick coupling sockets KDS-...	-	93	96	111	125	115	121
Quick coupling plugs	19	20	27	50	28	29	49

Weights [g]				
	Quick connector		Bulkhead quick connector	Barbed fitting
	CK-9	CK-13	CK-9-S	N-9
Quick coupling sockets KDMS-...	-	-	-	-
Quick coupling sockets KDS-...	104	121	122	97
Quick coupling plugs	37	50	64	17

Materials			
	Quick coupling socket		Quick coupling plug
	KDMS	KDS	KSS
Housing	Brass, nickel-plated	Brass, nickel-plated	Hardened steel
Releasing sleeve	Brass, nickel-plated	Polyacetal	-

Quick coupling sockets/plugs KDMS/KDS/KSS, shut-off on one side

FESTO

Technical data

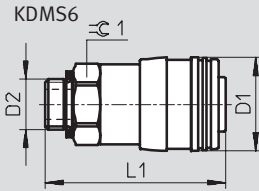
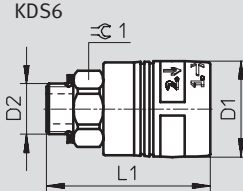
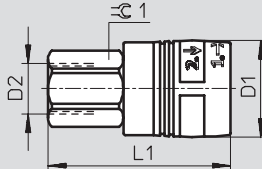
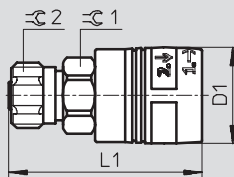
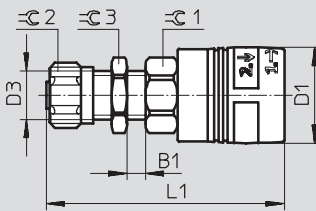
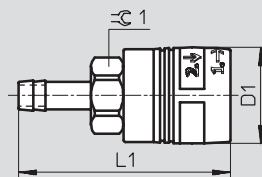
Dimensions – Quick coupling socket					Download CAD data → www.festo.com/en/engineering			
Male thread			Female thread					
								
Quick connector			Bulkhead quick connector			Barbed fitting		
								

Type	B1	D1 Ø	D2	D3	L1	↺ 1	↺ 2	↺ 3
Male thread quick coupling socket KDMS6								
G1/4	–	31	G1/4	–	59	24	–	–
G3/8			G3/8		60			
G1/2			G1/2		61.5			
Male thread quick coupling socket KDS6								
G1/4	–	31.6	G1/4	–	53	22	–	–
G3/8			G3/8		54	22		
G1/2			G1/2		55.5	24		
Female thread								
G1/4	–	31.6	G1/4	–	60	22	–	–
G3/8			G3/8		60	22		
G1/2			G1/2		63	24		
Quick connector with union nut								
CK-9	–	31.6	–	–	63.5	22	19	–
CK-13					64.5	24	24	
Bulkhead quick connector with union nut								
CK-9-S	1,2 ... 18,2	31.6	–	M16x1	78.5	22	19	22
Barbed fitting								
N-9	–	31.6	12	–	69.7	22	–	–

Quick coupling sockets/plugs KDMS/KDS/KSS, shut-off on one side

FESTO

Technical data

Dimensions – Quick coupling plug

Download CAD data → www.festo.com/en/engineering

Male thread

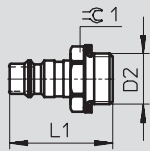

Female thread

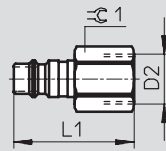

Quick connector

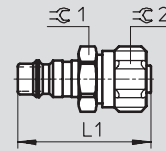

Bulkhead quick connector

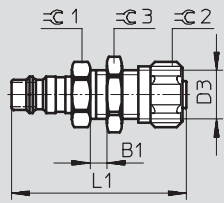

Barbed fitting

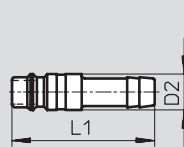

Insertion depth

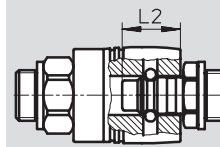

Type	B1	D2	D3	L1	L2	≈G 1	≈G 2	≈G 3
Male thread								
G1/8	-	G1/8	-	30.5	19.1	13	-	-
G1/4		G1/4		32.5		17		
G3/8		G3/8		34		19		
G1/2		G1/2		37.5		24		
Female thread								
G1/4	-	G1/4	-	38.5	19.1	17	-	-
G3/8		G3/8		39.5		19		
G1/2		G1/2		44		24		
Quick connector with union nut								
CK-9	-	-	-	43.7	19.1	19	19	-
CK-13				45.2		24	24	
Bulkhead quick connector with union nut								
CK-9-S	1,2 ... 18,2	-	M16x1	57.5	19.1	22	19	22
Barbed fitting								
N-9	-	12	-	47	19.1	-	-	-

Quick coupling sockets/plugs KDMS/KDS/KSS, shut-off on one side

Technical data

FESTO

Ordering data			
Connection	Quick coupling socket		Quick coupling plug
	Part No.	Type	Part No. Type
Male thread, releasing sleeve made from brass material			
G $\frac{1}{4}$	151 776	KDMS6- $\frac{1}{4}$ -A	151 779 KSS6- $\frac{1}{4}$ -A
G $\frac{3}{8}$	151 777	KDMS6- $\frac{3}{8}$ -A	151 780 KSS6- $\frac{3}{8}$ -A
G $\frac{1}{2}$	151 778	KDMS6- $\frac{1}{2}$ -A	531 693 KSS6- $\frac{1}{2}$ -A
Male thread, releasing sleeve made from polymer material			
G $\frac{1}{8}$	–		151 781 KSS6- $\frac{1}{8}$ -A
G $\frac{1}{4}$	531 647	KDS6- $\frac{1}{4}$ -A	151 779 KSS6- $\frac{1}{4}$ -A
G $\frac{3}{8}$	531 648	KDS6- $\frac{3}{8}$ -A	151 780 KSS6- $\frac{3}{8}$ -A
G $\frac{1}{2}$	531 649	KDS6- $\frac{1}{2}$ -A	531 693 KSS6- $\frac{1}{2}$ -A
Female thread			
G $\frac{1}{4}$	531 650	KDS6- $\frac{1}{4}$ -I	531 695 KSS6- $\frac{1}{4}$ -I
G $\frac{3}{8}$	531 651	KDS6- $\frac{3}{8}$ -I	531 696 KSS6- $\frac{3}{8}$ -I
G $\frac{1}{2}$	531 652	KDS6- $\frac{1}{2}$ -I	531 697 KSS6- $\frac{1}{2}$ -I
Quick connector with union nut			
CK-9	531 653	KDS6-CK-9	531 698 KSS6-CK-9
CK-13	531 654	KDS6-CK-13	531 699 KSS6-CK-13
Bulkhead quick connector with union nut			
CK-9-S	531 656	KDS6-CK-9-S	531 701 KSS6-CK-9-S
Barbed fitting			
N-9	531 655	KDS6-N-9	531 700 KSS6-N-9

Union nut MCK

Accessories



Union nut MCK¹⁾
for quick connector

Material:
Wrought aluminium alloy

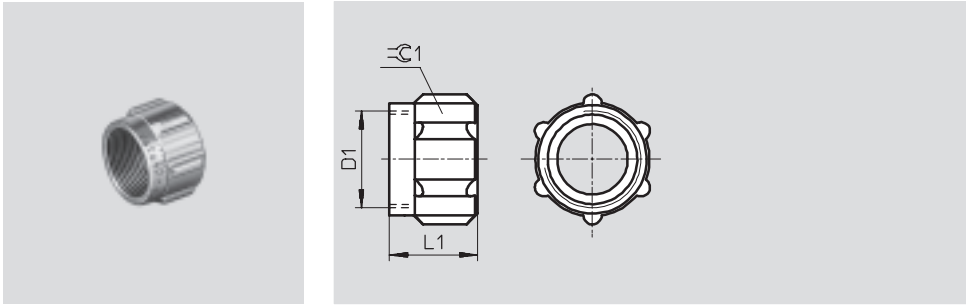

Ordering data						
Nominal size [mm]	D1	L1	≡ 1	Weight [g]	Part No.	Type
3	M6x0.75	8.5	8	0.6	533 672	MCK-PK-3-KD
4	M10x1	11	12	1.6	533 673	MCK-PK-4-KD
6	M12x1	11	14	1.9	533 674	MCK-PK-6-KD
9	M16x1	14.4	19	5	533 675	MCK-PK-9-KD
13	M22x1	18	24	8	533 676	MCK-PK-13-KD

1) Corrosion resistance class 1 according to Festo standard 940 070
Components requiring low corrosion resistance. Transport and storage protection. Parts that do not have primarily decorative surface requirements, e.g. in internal areas that are not visible or behind covers.