

連接電纜

VMPA-KMS1-8-10

料號: 533197

FESTO

用於多針腳插頭連接至閩島 MPA-S.

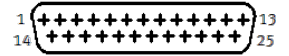
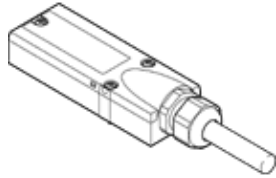

技術參數

特性	值
基於標準	DIN 41652
Cable identification	具配件
連接頻率	50
產品重量	956 g
Electrical connection 1, function	Field device side
Electrical connection 1, design	有角的
Electrical connection 1, connection type	插頭插座
Electrical connection 1, cable outlet	Angled
Electrical connection 1, connection technology	Sub-D
Electrical connection 1, number of pins/wires	25
Electrical connection 1, occupied pins/wires	9
Electrical connection 1, type of mounting	3x M3 screws
Electrical connection 2, function	Controller side
Electrical connection 2, connection type	電纜
Electrical connection 2, connection technology	開放式終端
Electrical connection 2, number of pins/wires	10
Electrical connection 2, occupied pins/wires	9
工作電壓範圍 DC	0 ... 30 V
額定工作電壓 DC	24 V
容許的電流負載	3 A
浪湧強度	1 kV
電纜長度	10 m
電纜屬性	標準
電纜的測試條件	視需求的測試條件
Bending radius, fixed cable installation	28.6 mm
Bending radius, flexible cable installation	71.5 mm
電纜螺紋連接	M20x1,5
電纜直徑	7.15 mm
電纜直徑公差	± 0,3 mm
電纜結構	10x0,34
導體的額定截面	0.34 mm ²
導線末端	Cut off bluntly
防護等級	IP65 符合 IEC 60529
Note on degree of protection	裝配狀態
環境溫度	-25 ... 80 °C
Ambient temperature with flexible cable installation	-5 ... 70 °C
CE 符號 (參見符合的標準)	in accordance with EU RoHS directive
UKCA marking (see declaration of conformity)	To UK RoHS instructions
PWIS conformity	VDMA24364-B2-L
材料備註	符合 RoHS
污染程度	3
耐腐蝕等級 CRC	2 - Moderate corrosion stress
Material cable sheath	PVC

特性	值
電纜外套顏色	灰色
Material housing	PA
外殼顏色	灰色
Material of union nut	PA
Material seals	CR NBR
Material electrical contact	Gold-plated copper alloy