

伺服馬達

EMMT-AS-60-L-HS-RMB

料號: 5242219

FESTO

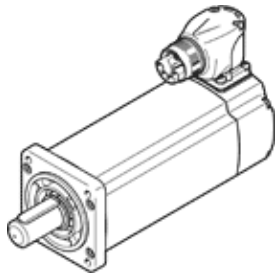
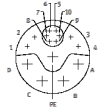

技術參數

特性	值
環境溫度	-15 ... 40 °C
Note on ambient temperature	up to 80°C with derating -1.5%/°C
Max. installation height	4,000 m
Note on max. installation height	As of 1,000 m, only with derating of -1.0% per 100 m
儲藏溫度	-20 ... 70 °C
相對空氣濕度	0 - 90 %
符合標準	IEC 60034
根據EN60034-1的熱量等級	F
Max. winding temperature	155 °C
根據EN60034-1的速率等級	S1
溫度監控	Digital motor temperature transmission via EnDat® 2.2
Motor type to EN 60034-7	IM B5 IM V1 IM V3
裝配位置	任何
防護等級	IP40
Note on degree of protection	IP40 motor shaft without RWDR IP65 motor shaft with RWDR IP67 for motor housing with connection technology
Concentricity, coaxiality, axial runout to DIN SPEC 42955	N
Balance quality	G 2,5
Detent torque	<1.0% of peak torque
Storage lifetime under nominal conditions	20,000 h
Interface code, motor out	60P
Electrical connection 1, connection type	Hybrid plugs
Electrical connection 1, connection technology	M23x1
Electrical connection 1, number of pins/wires	15
污染程度	2
材料備註	符合 RoHS
耐腐蝕等級 CRC	0 - No corrosion stress
PWIS conformity	VDMA24364 zone III
耐振動	傳送應用測試在安全等級 2 符合 FN 942017-4 及 EN 60068-2-6
耐衝擊	Shock test with severity level 2 in accordance with FN 942017-5 and EN 60068-2-27
授權	RCM Mark c UL us - Recognized (OL)
CE 符號 (參見符合的標準)	根據 EU-EMV 指導原則 根據 EU 低電壓設備指導原則 in accordance with EU RoHS directive
UKCA marking (see declaration of conformity)	To UK instructions for electrical equipment To UK instructions for EMC To UK RoHS instructions
認證核發部門	UL E342973
額定工作電壓 DC	680 V
Type of winding switch	Star inside
Number of pole pairs	5

特性	值
靜止扭矩	1.56 Nm
額定扭矩	1.3 Nm
峰值 (最大) 扭矩	5.6 Nm
額定擺動速度	3,000 1/min
最高速度	14,300 1/min
Max. mechanical speed	16,000 1/min
額定馬達功率	410 W
連續的開路電流	3.5 A
額定馬達電流	3 A
峰值 (最大) 電流	18.3 A
馬達恆定	0.44 Nm/A
Standstill torque constant	0.52 Nm/A
Voltage constant, phase-to-phase	31.2 mV/min
Phase-phase winding resistance	2.68 Ohm
Phase-phase winding inductance	12 mH
Winding longitudinal inductivity Ld (phase)	5 mH
Winding cross inductivity Lq (phase)	6 mH
Electric time constant	3 ms
Thermal time constant	44 min
Thermal resistance	1.2 K/W
Measuring flange	250 x 250 x 15 mm, steel
斷電時轉動慣量總和	0.49 kgcm ²
產品重量	2,230 g
容許的軸向驅動軸負載	70 N
容許的徑向軸負載	350 N
轉子位置感測器	Absolute multi-turn encoder
Rotor position sensor, manufacturer designation	EQI 1131
Rotor position sensor, absolute detectable revolutions	4,096
Rotary position encoder interface	EnDat 22
Rotary position encoder measuring principle	電感式
Rotor position sensor, DC operating voltage	5 V
Rotor position sensor, DC operating voltage range	3.6 ... 14 V
Rotor position sensor, position values per revolution	524,288
轉子位置編碼器起動裝置	19 Bit
Rotor position sensor, system accuracy of angle measurement	-120 ... 120 arcsec
剎車保持扭矩	2.5 Nm
制動裝置的DC工作電壓	24 V
Brake current consumption	0.46 A
制動裝置的電力消耗	11 W
Brake coil resistance	52.4 Ohm
Brake coil inductivity	700 mH
Brake separation time	<= 35 ms
Brake closing time	10 ms
DC brake response delay	<= 2 ms
Max. brake no-load speed	10,000 1/min
Max. brake friction work	5,600 J
剎車的質量慣性力矩	0.074 kgcm ²
Switching cycles, holding brake	10 million idle actuations (without friction work)
MTTF, subcomponent	190 years, rotor position sensor