

伺服馬達

EMMS-AS-140-LK-HV-RS-S1

料號: 1574694
將停止供貨的產品
不具齒輪單元。

FESTO

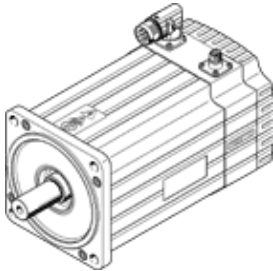

技術參數

| 特性 | 值 |
|--|--|
| 環境溫度 | -10 ... 40 °C |
| 儲藏溫度 | -20 ... 60 °C |
| 相對空氣濕度 | 0 - 90 % |
| 符合標準 | IEC 60034 |
| 絕緣保護等級 | F |
| 根據EN60034-1的速率等級 | S1 |
| 溫度監控 | PTC 電阻 |
| 防護等級 | IP65 |
| Woodruff 軸設計關鍵 | DIN 6885 A 8 x 7 x 40 |
| 電接頭系統 | 插頭 |
| 材料備註 | 符合 RoHS |
| 耐腐蝕等級 CRC | 2 - Moderate corrosion stress |
| PWIS conformity | VDMA24364-B2-L |
| 授權 | RCM Mark c UL us - Recognized (OL) |
| CE 符號 (參見符合的標準) | 根據 EU-EMV 指導原則 根據 EU 低電壓設備指導原則 in accordance with EU RoHS directive |
| UKCA marking (see declaration of conformity) | To UK instructions for electrical equipment To UK instructions for EMC To UK RoHS instructions |
| 額定電壓 DC | 565 V |
| Type of winding switch | Star inside |
| Number of pole pairs | 6 |
| 靜止扭矩 | 25.5 Nm |
| 額定扭矩 | 17.41 Nm |
| 峰值 (最大) 扭矩 | 67.5 Nm |
| 額定擺動速度 | 2,800 1/min |
| 最高速度 | 3,830 1/min |
| 額定馬達功率 | 5,110 W |
| 額定馬達電流 | 9.96 A |
| 峰值 (最大) 電流 | 51.5 A |
| 馬達恆定 | 1.75 Nm/A |
| Voltage constant, phase-to-phase | 104.41 mVmin |
| Phase-phase winding resistance | 0.586 Ohm |
| Phase-phase winding inductance | 4.65 mH |
| 斷電時轉動慣量總和 | 19.027 kgcm ² |
| 產品重量 | 16,200 g |
| 容許的軸向驅動軸負載 | 200 N |
| 容許的徑向軸負載 | 1,060 N |
| 轉子位置感測器 | Absolute single turn encoder |
| Rotary position encoder interface | EnDat 22 |
| Rotary position encoder measuring principle | 電感式 |
| 轉子位置編碼器起動裝置 | 18 Bit |
| MTTF, subcomponent | 76 years, rotary position encoder |
| MTTFd, subcomponent | 152 years, rotary position encoder |
| Energy efficiency | ENEFF (CN) / Class 2 |