

Common supply manifold

PAL-1/8-3

Part number: 8602

FESTO

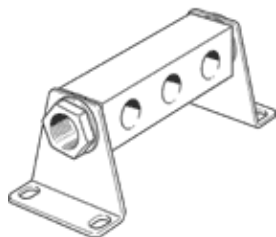

Data sheet

Feature	Value
Assembly position	Any
Max. number of valve positions	3
PWIS conformity	VDMA24364-B1/B2-L
Product weight	170 g
Mounting type	With mounting bracket
Pneumatic connection, port 1	G1/4
Materials note	Conforms to RoHS
Material of connecting plate	Aluminum Anodized