

Gearbox EMGA-80-A-G20-100A

Part number: 8141749

FESTO

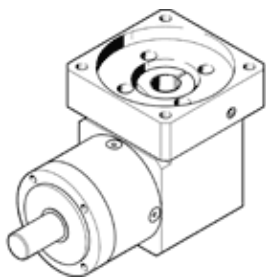

Data sheet

Feature	Value
Gear unit flange size	80 mm
Motor flange size	100 mm
Torsional backlash	0.25 deg
Type of gear unit	Right-angle gear unit
Gear unit ratio	20:1
Max. input speed	7,000 1/min
Temperature range of gear unit	-25 ... 90 °C
PWIS conformity	VDMA24364-B2-L
Protection class	IP54
Continuous output torque	120 Nm
Mass moment of inertia of gear unit	1.013 kgcm ²
Max. output torque	240 Nm
Max. efficiency	93 %
Torsional resistance	5.1 Nm/arcmin
Product weight	5,100 g
Gear unit interface, output shaft	80G
Gear unit interface, drive shaft	100A
Materials note	Conforms to RoHS