

# Gearbox EMGA-60-A-G3-60P

Part number: 8085344

FESTO

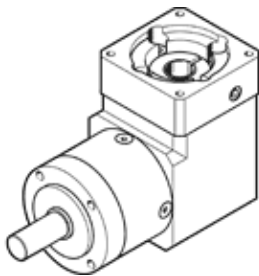

## Data sheet

| Feature                             | Value                   |
|-------------------------------------|-------------------------|
| Gear unit flange size               | 60 mm                   |
| Motor flange size                   | 60 mm                   |
| Torsional backlash                  | 0.27 deg                |
| Type of gear unit                   | Right-angle gear unit   |
| Gear unit ratio                     | 3:1                     |
| Max. input speed                    | 13,000 1/min            |
| Temperature range of gear unit      | -25 ... 90 °C           |
| PWIS conformity                     | VDMA24364-B2-L          |
| Protection class                    | IP54                    |
| Continuous output torque            | 14 Nm                   |
| Mass moment of inertia of gear unit | 0.394 kgcm <sup>2</sup> |
| Max. output torque                  | 22 Nm                   |
| Max. efficiency                     | 95 %                    |
| Torsional resistance                | 2 Nm/arcmin             |
| Product weight                      | 1,700 g                 |
| Gear unit interface, output shaft   | 60G                     |
| Gear unit interface, drive shaft    | 60P                     |
| Materials note                      | Conforms to RoHS        |