

toothed belt axis unit ELGS-TB-KF-45-500-ST-M-H1-PLK-AA

Part number: 8083667

FESTO

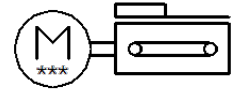
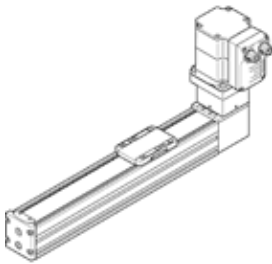

Data sheet

Feature	Value
Effective diameter of drive pinion	19.1 mm
Working stroke	500 mm
Size	45
Stroke reserve	0 mm
Toothed-belt stretch	0.187 %
Toothed-belt pitch	2 mm
Assembly position	Horizontal
Guide	Recirculating ball bearing guide
Design structure	Electromechanical linear axis With toothed belt with integrated drive
Motor type	Stepper motor
Position detection	Motor encoder For proximity sensor
Referencing	Fixed stop block positive Fixed stop block negative
Rotor position sensor	Absolute single turn encoder
Rotary position encoder measuring principle	Magnetic
Temperature monitoring	Shutdown at over-temperature Integrated precise CMOS temperature sensor with analogue output
Additional functions	User interface Integrated end-position sensing
Display	LED
Ready status display	LED
Max. acceleration	6 m/s ²
Max. speed	1.2 m/s
Repetition accuracy	±0,1 mm
Digital logic output characteristics	configurable Not electrically isolated
Duty cycle	100 %
Insulation protection class	B
Max. current, digital logic outputs	100 mA
Max. current consumption	5.3 A
Nominal voltage DC	24 V
Nominal current	5.3 A
Parameters configuring interface	IO-Link User interface
Rotor position encoder resolution	16 Bit
Permissible voltage fluctuation	+/- 15 %
Power supply, type of connection	Plug
Power supply, connection technology	M12x1, T-coded as per EN 61076-2-111
Power supply, number of pins/wires	4
Authorization	RCM Mark
KC mark	KC-EMV
CE symbol (see declaration of conformity)	according to EU-EMV guideline in accordance with EU RoHS directive

Feature	Value
UKCA marking (see declaration of conformity)	To UK instructions for EMC To UK RoHS instructions
Vibration resistance	Transport application test with severity level 1 as per FN 942017-4 and EN 60068-2-6
Shock resistance	Shock test with severity level 1 in accordance with FN 942017-5 and EN 60068-2-27
PWIS conformity	VDMA24364 zone III
Storage temperature	-20 ... 60 °C
Relative air humidity	0 - 90 %
Protection class	IP40
Safety class	III
Ambient temperature	0 ... 50 °C
Note on ambient temperature	Above an ambient temperature of 30 °C, the power must be reduced by 2% per K.
Area moment of inertia 2nd degree Iy	140E+03 mm ⁴
Area moment of inertia 2nd degree Iz	170E+03 mm ⁴
Max. force Fy	300 N
Max. force Fz	600 N
Max. torque Mx	5.5 Nm
Max. torque My	4.7 Nm
Max. torque Mz	4.7 Nm
Max. feed force Fx	75 N
Reference value for working load, horizontal	2.5 kg
Torsional mass moment of inertia It	8.5E+03 mm ⁴
Feed constant	60 mm/U
Moving mass	169 g
Moving mass with 0 mm stroke	169 g
Slide weight	55 g
Product weight	2,940 g
Number of 24 V DC digital logic outputs	2
Number of digital logic inputs	2
Specification, logic input	Based on IEC 61131-2, type 1
Logic input working range	24 V
IO-Link, SIO mode support	Yes
Logic input characteristics	configurable Not electrically isolated
IO-Link, protocol	Device V 1.1
IO-Link, communication mode	COM3 (230.4 kbd)
IO-Link, port type	A
IO-Link, number of ports	1
IO-Link, process data width OUT	2 Byte
IO-Link, process data content OUT	1 bit (Move in) 1 bit (Move out) 1 bit (Quit Error)
IO-Link, process data width IN	2 Byte
IO-Link, process data content IN	1 bit (State Device) 1 bit (State Move) 1 bit (State in) 1 bit (State out)
IO-Link, Service data contents IN	32 bit Force 32 bit Position 32 bit Speed
IO-Link, minimum cycle time	1 ms
IO-Link, data memory required	0.5 Kilobyte
Max. line length	15 m outputs 15 m inputs 20 m with IO-Link operation
Switching logic, outputs	PNP (positive-switching)
Input circuit logic	PNP (positive-switching)
IO-Link, connection technology	Plug
Logic interface, connection type	Plug

Feature	Value
Logic interface, connection technology	M12x1, A-coded in accordance with EN 61076-2-101
Logic interface, number of poles/wires	8
Logic interface, connection pattern	00992264
Material of end caps	Die-cast aluminium, painted
Material of profile	Anodised wrought aluminium alloy
Materials note	Conforms to RoHS
Material cover tape	Stainless steel strip
Material drive cover	Die-cast aluminium, painted
Material guide slide	Heat-treatment steel
Material guide rail	Heat-treatment steel
Material pulleys	High alloy steel, non-corrosive
Material slide	Aluminum die cast
Material toothed belt	Polychloroprene with glass fibers