

# Passive guide axis ELFC-KF-60-100

Part number: 8062812

FESTO

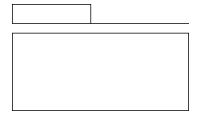
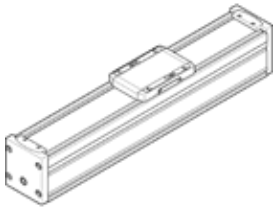

## Data sheet

Feature	Value
Working stroke	100 mm
Size	60
Stroke reserve	0 mm
Assembly position	Any
Guide	Recirculating ball bearing guide
Design structure	Guide
Max. acceleration	500 m/s <sup>2</sup>
Max. speed	1.5 m/s
Duty cycle	100 %
Corrosion resistance classification CRC	0 - No corrosion stress
PWIS conformity	VDMA24364 zone III
RSBP classification to CD-0033	F1a
Cleanroom class	ISO class 7
Protection class	IP40
Ambient temperature	0 ... 50 °C
Area moment of inertia 2nd degree Iy	441E+03 mm <sup>4</sup>
Area moment of inertia 2nd degree Iz	542E+03 mm <sup>4</sup>
Max. force Fy	600 N
Max. force Fz	1,800 N
Max. torque Mx	29.1 Nm
Max. torque My	31.8 Nm
Max. torque Mz	31.8 Nm
Torsional mass moment of inertia It	29.8E+03 mm <sup>4</sup>
Displacement force	6.75 N
Fy with theoretical service life of 100 km (from a guide perspective only)	2,208 N
Fz with theoretical service life of 100 km (from a guide perspective only)	6,624 N
Mx with theoretical service life of 100 km (from a guide perspective only)	107 Nm
My with theoretical service life of 100 km (from a guide perspective only)	117 Nm
Mz with theoretical service life of 100 km (from a guide perspective only)	117 Nm
Moving mass	407 g
Additional weight per 10 mm stroke	43 g
Material of end caps	Die-cast aluminium, painted
Material of profile	Anodised wrought aluminium alloy
Materials note	Conforms to RoHS
Material cover tape	High alloy steel, non-corrosive
Material cover	Die-cast aluminium, painted
Material guide slide	Steel
Material guide rail	Steel
Material slide	Aluminum die cast