

Guide cylinder

DFM-N-63-100-B-P-A-GF

Part number: 570604
Product to be discontinued

FESTO

With integral guide.

The proximity switch, type SMTSO-8E, can be used with this product with stroke lengths equal to or greater than 50 mm. The corresponding mounting kit, type SMB-8E, is mounted inwardly or outwardly.

Type to be discontinued. Available until 2022. See Support Portal for alternative products.

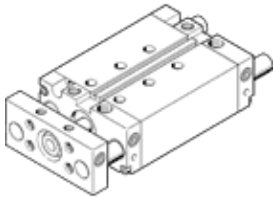

Data sheet

Feature	Value
Stroke	100 mm
Piston diameter	63 mm
Operating mode of drive unit	Yoke
Cushioning	P: Flexible cushioning rings/plates at both ends
Assembly position	Any
Guide	Plain-bearing guide
Design structure	Guide
Position detection	For proximity sensor
Working pressure	1 ... 10 bar
Mode of operation	double-acting
Operating medium	Compressed air in accordance with ISO8573-1:2010 [7:4:4]
Note on operating and pilot medium	Lubricated operation possible (subsequently required for further operation)
Corrosion resistance classification CRC	2 - Moderate corrosion stress
Ambient temperature	-20 ... 80 °C
Theoretical force at 0.6 MPa (6 bar, 87 psi), retracting	1,750 N
Theoretical force at 0.6 MPa (6 bar, 87 psi), advance	1,870 N
alternative connections	See product drawing
Pneumatic connection	1/4 NPT
Materials note	Conforms to RoHS
Material cover	Wrought Aluminum alloy
Material seals	NBR
Material housing	Wrought Aluminum alloy
Material piston rod	High alloy steel, non-corrosive