

Electrical slide EGSP-26- -

Part number: 562755
Product to be discontinued

FESTO

With recirculating ball bearing guide

Type to be discontinued. Available until 2018. See Support Portal for alternative products.

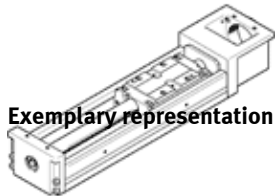
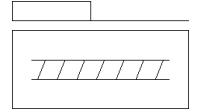

Exemplary representation

Data sheet

Overall data sheet – Individual values depend upon your configuration.

Feature	Value
Working stroke	50 ... 200 mm
Size	26
Spindle diameter	8 mm
Assembly position	Any
Guide	Recirculating ball bearing guide
Design structure	Electromechanical linear axis With ball screw
Referencing	Reference switch
Spindle type	Ball screw
Max. acceleration	10 m/s ²
Max. speed	0.2 ... 0.6 m/s
Repetition accuracy	±0,003 - ±0,01 mm
Corrosion resistance classification CRC	0 - No corrosion stress
Protection class	IP10
Ambient temperature	0 ... 40 °C
Fixed bearing dynamic basic load rating	2,000 N
Linear guide dynamic basic load rating	10,318 N
Area moment of inertia 2nd degree Iy	16.6E+03 mm ⁴
Area moment of inertia 2nd degree Iz	148E+03 mm ⁴
Max. feed force Fx	164 ... 212 N
Linear guide statistical basic load rating	16,500 N
Mass moment of inertia JH per meter of stroke	0.0316 kgcm ²
Feed constant	2 ... 6 mm/U
Fixed bearing statistical basic load rating	1,230 N
Mounting type	With internal thread and dowel pin
Material of end caps	Aluminum die cast coated
Material of profile	High alloy steel, non-corrosive
Materials note	Contains PWIS substances Conforms to RoHS
Material drive cover	Aluminum die cast coated
Material slide	Steel
Material spindle nut	Steel
Material spindle	Steel