

Semi-rotary actuator

DAPS-0240-090-R-F0507-CR

Part number: 552873

FESTO

double-acting, air connection according to VDI/VDE 3845 Namur valves,
direct flange mounting, stainless steel version.

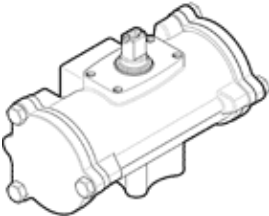

Data sheet

Feature	Value
Size of actuator	0240
Flange hole pattern	F05 F07
Swivel angle	90 deg
Shaft connection depth	19.3 mm
Fitting connection conforms to standard	ISO 5211
Cushioning	No cushioning
Assembly position	Any
Mode of operation	double-acting
Design structure	Yoke kinematics
Position detection	No
Closing direction	right-closing
Valve connection conforms to standard	VDI/VDE 3845 (NAMUR)
Safety Integrity Level (SIL)	Product can be used in SRP/CS up to SIL 2 (high demand) Product can be used in SRP/CS up to SIL 2 low demand
Operating pressure MPa	0.25 ... 0.84 MPa
Working pressure	2.5 ... 8.4 bar
Nominal operating pressure	0.56 MPa
Nominal working pressure	5.6 bar
CE symbol (see declaration of conformity)	according to EU-Ex protection guideline (ATEX)
UKCA marking (see declaration of conformity)	To UK EX instructions
Certificate issuing department	TÜV Nord 212170801
ATEX category Gas	II 2G
ATEX category Dust	II 2D
Explosion ignition protection type Gas	Ex h IIC T6...T3 Gb X
Explosion ignition protection type Dust	Ex h IIIC T85°C...T200°C Db X
Explosion-proof ambient temperature	-20°C ≤ Ta ≤ +60°C
Operating medium	Compressed air in accordance with ISO8573-1:2010 [7:4:4]
Note on operating and pilot medium	Lubricated operation possible (subsequently required for further operation)
Corrosion resistance classification CRC	3 - High corrosion stress
PWIS conformity	VDMA24364-B1/B2-L
Ambient temperature	-20 ... 80 °C
Torque at rated working pressure and 0° rotation angle	240 Nm
Torque at nominal operating pressure with 50° swivel angle	120 Nm
Torque at nominal operating pressure with 90° swivel angle	180 Nm
Air consumption at 0.6 MPa (6 bar, 87 psi) per cycle 0°-nominal swivel angle-0°	8.26 l
Product weight	5,600 g
Shaft connection	T17
Pneumatic connection	G1/8
Materials note	Conforms to RoHS
Material cover	High alloy steel, non-corrosive

Feature	Value
Material number, cover	1.4408
Material seals	FPM NBR PUR
Material housing	High alloy steel, non-corrosive
Material number for housing	1.4408
Material screws	High alloy steel, non-corrosive
Material shaft	High alloy steel, non-corrosive
Material number for shaft	1.4301