

Precision flow control valve GRPO-160-1/8-AL

Part number: 542025

FESTO

is used for precise adjustment of flow rate.

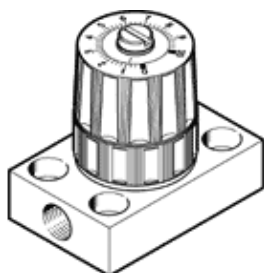

Data sheet

Feature	Value
Valve function	Throttle function
Pneumatic connection, port 1	G1/8
Pneumatic connection, port 2	G1/8
Type of actuation	manual
Adjusting element	Rotary knob with scale
Mounting type	On subbase
Standard nominal flow rate in flow control direction	75.8 l/min
Working pressure	0 ... 8 bar
Ambient temperature	-10 ... 50 °C
Material housing	PA-reinforced
Assembly position	Any
Working pressure from 2 to 1	0 ... 0.5 bar
Standard nominal flow rate in flow control direction from 0.1-→0 MPa (1-→0 bar, 14.5-→0 psi)	38 l/min
Standard flow rate in flow control direction 0.6-→0 MPa (6-→0 bar, 87-→0 psi)	129 l/min
Operating medium	Compressed air to ISO8573-1:2010 [5:4:3] Inert gases
Note on operating and pilot medium	Lubricated operation not possible
PWIS conformity	VDMA24364 zone III
Medium temperature	-10 ... 50 °C
Product weight	110 g
Materials note	Conforms to RoHS
Material of connecting plate	Wrought Aluminum alloy
Material seals	NBR PVC
Material screws	Steel