

Proximity Sensor SIEH-M18B-NS-S-L-CR

Part number: 538257

FESTO

Inductive, for large switching distances.

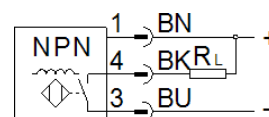
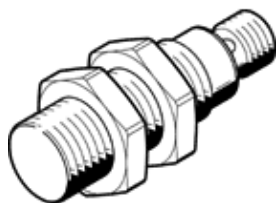

Data sheet

Feature	Value
Conforms to standard	EN 60947-5-2
Authorization	RCM Mark c UL us - Listed (OL)
CE symbol (see declaration of conformity)	according to EU-EMV guideline
Nominal switching distance	10 mm
Guaranteed switching distance	8.1 mm
Reduction factors	Aluminum = 1.0 stainless steel 1 mm thick = 0.4 stainless steel 2 mm thick = 0.8 copper = 0.85 brass = 1.3 Steel, St 37 = 1.0
Ambient temperature	-25 ... 70 °C
Switch output	NPN
Switching element function	Normally open contact
Reproducibility, switching value FS	0.5 mm
Hysteresis	≤ 1.22 mm
Max. switching frequency	200 Hz
Max. output current	200 mA
Voltage drop	≤ 2 V
Inductive protective circuit	Integrated output current < 100mA and switching frequency < 10Hz
Short circuit strength	Pulsing
Operating voltage range DC	10 ... 30 V
Residual ripple	20 %
Idle current	≤ 17 mA
Polarity protected	for all electrical connections
Electrical connection	3-pin M12x1 Plug
Size	M18
Mounting type	with lock nut
Type of installation	flush
Product weight	53 g
Material housing	High alloy steel
Operating status display	Yellow LED
Ambient temperature with flexible cable installation	-5 ... 70 °C
Protection class	IP67 IP69K
Sensor assembly pressure resistance	60 bar
Corrosion resistance classification CRC	2 - Moderate corrosion stress
PWIS conformity	VDMA24364-B2-L