

# Connecting cable

## VMPA-KMS2-8-10-PUR

Part number: 533506

FESTO

For multi-pin plug connection to valve manifold MPA-S, appropriate for energy chain.

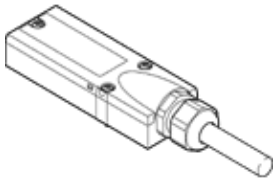

## Data sheet

| Feature  | Value                                |
|--|--------------------------------------|
| Based on the standard                                | DIN 41652                            |
| Cable identification                                 | with accessories                     |
| Connection frequency                                 | 50                                   |
| Product weight                                       | 906 g                                |
| Electrical connection 1, function                    | Field device side                    |
| Electrical connection 1, design                      | Angular                              |
| Electrical connection 1, connection type             | Plug socket                          |
| Electrical connection 1, cable outlet                | Angled                               |
| Electrical connection 1, connection technology       | Sub-D                                |
| Electrical connection 1, number of pins/wires        | 25                                   |
| Electrical connection 1, occupied pins/wires         | 9                                    |
| Electrical connection 1, type of mounting            | 3x M3 screws                         |
| Electrical connection 2, function                    | Controller side                      |
| Electrical connection 2, connection type             | Cable                                |
| Electrical connection 2, connection technology       | Open end                             |
| Electrical connection 2, number of pins/wires        | 10                                   |
| Electrical connection 2, occupied pins/wires         | 9                                    |
| Operating voltage range DC                           | 0 ... 30 V                           |
| Nominal operating voltage DC                         | 24 V                                 |
| Permissible current load                             | 3 A                                  |
| Surge strength                                       | 1 kV                                 |
| Cable length   | 10 m                                 |
| Cable attribute                                      | Suitable for energy chains           |
| Test conditions of cable                             | Test conditions on request           |
| Bending radius, fixed cable installation             | 21 mm                                |
| Bending radius, flexible cable installation          | 35 mm                                |
| Cable gland connection                               | M20x1,5                              |
| Cable diameter                                       | 7 mm                                 |
| Cable structure                                      | 10x0,25                              |
| Nominal conductor cross-section                      | 0.25 mm <sup>2</sup>                 |
| Wire ends  | Cut off bluntly                      |
| Protection class                                     | IP65<br>to IEC 60529                 |
| Note on degree of protection                         | in assembled condition               |
| Ambient temperature                                  | -25 ... 80 °C                        |
| Ambient temperature with flexible cable installation | -25 ... 80 °C                        |
| CE symbol (see declaration of conformity)            | in accordance with EU RoHS directive |
| UKCA marking (see declaration of conformity)         | To UK RoHS instructions              |
| PWIS conformity                                      | VDMA24364-B2-L                       |
| Materials note                                       | Conforms to RoHS                     |
| Degree of contamination                              | 3                                    |
| Corrosion resistance classification CRC              | 2 - Moderate corrosion stress        |
| Material cable sheath                                | TPE-U(PUR)                           |

| Feature                     | Value                    |
|-----------------------------|--------------------------|
| Cable sheath color          | Grey                     |
| Material housing            | PA                       |
| Housing color               | Grey                     |
| Material of union nut       | PA                       |
| Material seals              | CR<br>NBR                |
| Material electrical contact | Gold-plated copper alloy |