

Servomotor EMMB-AS-40-01-S

Part number: 5219168

FESTO

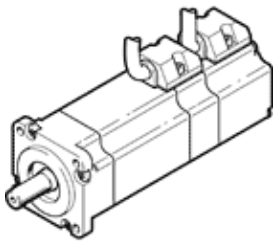

Data sheet

| Feature | Value |
|--|--|
| Ambient temperature | -20 ... 40 °C |
| Storage temperature | -20 ... 70 °C |
| Relative air humidity | 0 - 90 % |
| Conforms to standard | IEC 60034 |
| Insulation protection class | F |
| Rating class according to EN 60034-1 | S1 |
| Protection class | IP50 |
| Electrical connector system | Plug |
| Materials note | Contains PWIS substances Conforms to RoHS |
| Corrosion resistance classification CRC | 0 - No corrosion stress |
| CE symbol (see declaration of conformity) | according to EU-EMV guideline according to EU low voltage guideline |
| Nominal operating voltage DC | 300 V |
| Nominal voltage DC | 300 V |
| Standstill torque | 0.352 Nm |
| Nominal torque | 0.32 Nm |
| Peak torque | 0.96 Nm |
| Nominal rotary speed | 3,000 1/min |
| Max. speed | 6,500 1/min |
| Nominal motor power | 100 W |
| Continuous open-circuit current | 1.54 A |
| Nominal motor current | 1.4 A |
| Peak current | 4.2 A |
| Motor constant | 0.265 Nm/A |
| Voltage constant, phase-to-phase | 16 mVmin |
| Phase-phase winding resistance | 5.53 Ohm |
| Phase-phase winding inductance | 6 mH |
| Overall mass moment of inertia at power take-off | 0.059 kgcm ² |
| Product weight | 800 g |
| Permissible axial shaft load | 40 N |
| Permissible radial shaft load | 80 N |
| Rotor position sensor | Absolute single turn encoder |
| Rotary position encoder interface | Nikon A format |
| Rotary position encoder measuring principle | Optical |
| Rotor position encoder, typical resolution | 20 Bit |
| Rotor position encoder, typical angular accuracy | 20 arcmin |