

Compact cylinder DPDM-6-25-PA

Part number: 4830904

FESTO

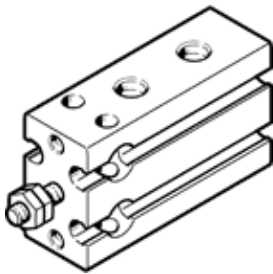

Data sheet

Feature	Value
Stroke	25 mm
Piston diameter	6 mm
Cushioning	P: Flexible cushioning rings/plates at both ends
Assembly position	Any
Mode of operation	double-acting
Design structure	Piston Piston rod Profile barrel
Position detection	For proximity sensor
Variants	Single-ended piston rod
Operating pressure MPa	0.18 ... 0.8 MPa
Working pressure	1.8 ... 8 bar
Operating medium	Compressed air in accordance with ISO8573-1:2010 [7:4:4]
Note on operating and pilot medium	Lubricated operation possible (subsequently required for further operation)
Corrosion resistance classification CRC	1 - Low corrosion stress
PWIS conformity	VDMA24364-B2-L
Cleanroom class	ISO class 6
Ambient temperature	-10 ... 80 °C
Theoretical force at 0.6 MPa (6 bar, 87 psi)	17 N
Theoretical force at 0.6 MPa (6 bar, 87 psi), retracting	13 N
Theoretical force at 0.6 MPa (6 bar, 87 psi), advance	17 N
Moving mass with 0 mm stroke	2.8 g
Additional mass factor per 10 mm of stroke	0.6 g
Basic weight for 0 mm stroke	20.7 g
Additional weight per 10 mm stroke	6.3 g
Mounting type	with through hole with internal (female) thread Optional
Pneumatic connection	M5
Materials note	Conforms to RoHS
Material cover	Wrought Aluminum alloy
Material seals	NBR TPE-U(PU)
Material housing	Anodised wrought aluminium alloy
Material piston rod	High alloy steel, non-corrosive