

# Semi-rotary actuator DRQ-50-270-PPVJ-A

Part number: 30601  
Product to be discontinued

FESTO

For proximity sensing, with adjustable end position cushioning and backlash-compensating gearing.

Type to be discontinued. Available until 2017. See Support Portal for alternative products.

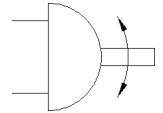
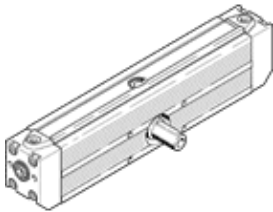

## Data sheet

Feature	Value
Size	50
Cushioning angle	84 deg
Setting range of swivel angle on both sides	-7 / + 8 deg
Swivel angle	270 deg
Cushioning	PPVJ: Pneumatic cushioning, adjustable
Assembly position	Any
Design structure	Rack and pinion
Position detection	For proximity sensor
Working pressure	2.5 ... 10 bar
Max. swivel frequency at 6 bar	1.5 Hz
Mode of operation	double-acting
Operating medium	Compressed air in accordance with ISO8573-1:2010 [7:-:-]
Ambient temperature	-10 ... 60 °C
Theoretical torque at 6 bar	19 Nm
Permissible mass moment of inertia	0.016 kgm <sup>2</sup>
Product weight	6,900 g
Mounting type	with internal (female) thread
Pneumatic connection	G1/4
Materials information for drive shaft	Case-hardened steel
Materials information for seals	TPE-U(PU)