

# Ball valve

## VZBC-40-FF-40-22-F0507-V4V4T

Part number: 1692204

FESTO

Stainless steel, 2/2-way, nominal width DN40, head flange F0507, PN40, DIN 1092-1.

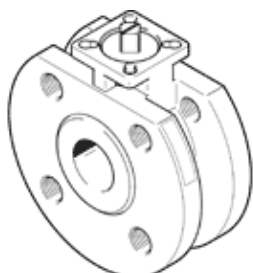

### Data sheet

| Feature                                      | Value                                                                                                                                         |
|----------------------------------------------|-----------------------------------------------------------------------------------------------------------------------------------------------|
| Design structure                             | 2-way ball valve                                                                                                                              |
| Type of actuation                            | mechanical                                                                                                                                    |
| Sealing principle                            | soft                                                                                                                                          |
| Assembly position                            | Any                                                                                                                                           |
| Mounting type                                | Line installation                                                                                                                             |
| Process valve connection                     | Ring housing with screw connection                                                                                                            |
| Switching position indicator                 | Slot direction = flow direction                                                                                                               |
| Flange hole pattern                          | F05<br>F07                                                                                                                                    |
| Inside diameter                              | 38 mm                                                                                                                                         |
| Nominal diameter DN                          | 40                                                                                                                                            |
| Valve function                               | 2/2                                                                                                                                           |
| Manual override                              | None                                                                                                                                          |
| Flow direction                               | reversible                                                                                                                                    |
| Nominal pressure of process valve            | 40                                                                                                                                            |
| Actuation torque                             | 35 Nm                                                                                                                                         |
| Based on the standard                        | EN 1092-1<br>ISO 5211                                                                                                                         |
| Medium                                       | Compressed air in accordance with ISO8573-1:2010 [-:--]<br>Inert gases<br>Water (no water vapour)<br>Neutral fluids<br>Other media on request |
| Medium temperature                           | -10 ... 200 °C                                                                                                                                |
| Flow rate Kv                                 | 170 m <sup>3</sup> /h                                                                                                                         |
| Materials note                               | Conforms to RoHS                                                                                                                              |
| PWIS conformity                              | VDMA24364 zone III                                                                                                                            |
| Material housing                             | High alloy steel, non-corrosive                                                                                                               |
| Material number for housing                  | 1.4408                                                                                                                                        |
| Material seals                               | PTFE<br>PTFE reinforced                                                                                                                       |
| Material ball                                | High alloy steel, non-corrosive                                                                                                               |
| Material number for ball                     | 1.4408                                                                                                                                        |
| Material shaft                               | High alloy steel, non-corrosive                                                                                                               |
| Material number for shaft                    | 1.4401                                                                                                                                        |
| Product weight                               | 4,400 g                                                                                                                                       |
| CE symbol (see declaration of conformity)    | according to EU printing device guideline                                                                                                     |
| UKCA marking (see declaration of conformity) | UK regulation for pressure equipment                                                                                                          |
| Corrosion resistance classification CRC      | 3 - High corrosion stress                                                                                                                     |