

# Swivel/linear unit DSL-25-100-270-P-S2-CL

Part number: 163086

FESTO

For proximity sensing. Rotary and linear movement can be actuated simultaneously or independently of one another. Rotary movement of 0° - 270° infinitely adjustable.

The maximum rotary angle play at the piston rod is 2°. When mounting additional components on the drive shaft, never exceed the maximum permitted tightening torque of 48.4 in lb / 5.5 Nm.

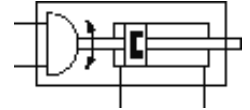
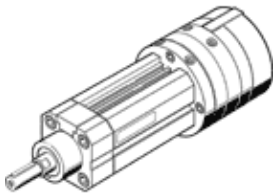

## Data sheet

Feature	Value
Cushioning angle	10 deg
Rotation angle adjustment range	270 deg
Stroke	100 mm
Piston diameter	25 mm
Swivel angle	258 deg
Cushioning	CL: shock absorber left P: Flexible cushioning rings/plates at both ends
Assembly position	Any
Fine adjustment	1.5 deg
Mode of operation	double-acting
Design structure	Rotary vane
Position detection	For inductive sensors For proximity sensor
Variants	S2: through piston rod
Protection against torque/guide	with plain-bearing guide
Operating pressure	2.5 ... 8 bar
Max. impact speed	500 mm/s
Max. swivel frequency at 6 bar	1 Hz
Operating medium	Dried compressed air, lubricated or unlubricated
Ambient temperature	-10 ... 60 °C
Cushioning length	5 mm
Torque at 6 bar	5 Nm
Theoretical force at 6 bar, return stroke	174 N
Theoretical force at 6 bar, advance stroke	246 N
Permissible mass moment of inertia	0.0016 kgm <sup>2</sup>
Additional weight per 10 mm stroke	67 g
Basic weight for 0 mm stroke	1,610 g
Mounting type	Clamped in T-slot with external (male) thread Optional
Pneumatic connection	M5
Materials information for cover	Wrought Aluminum alloy Anodized
Materials information for seals	TPE-U(PU)
Materials information, housing	Wrought Aluminum alloy Smooth anodized
Materials information for piston rod	Heat-treatment steel