

Guide unit SPZ-16-40-P-A-KF

Part number: 162173
Product to be discontinued

FESTO

With 2 piston rods (Twin slide), for proximity sensing.
Type to be discontinued. Available until 2019. See Support Portal for alternative products.

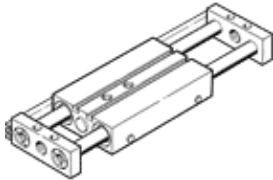

Data sheet

| Feature | Value |
|--|---|
| Stroke | 40 mm |
| Adjustable end-position range/length | 10 mm |
| Piston diameter | 16 mm |
| Operating mode of drive unit | Slide |
| Cushioning | Pneumatic cushioning with fixed metallic stop |
| Assembly position | Any |
| Guide | Recirculating ball bearing guide |
| Design structure | Guide |
| Position detection | For proximity sensor |
| Working pressure | 1 ... 10 bar |
| Mode of operation | double-acting |
| Operating medium | Compressed air in accordance with ISO8573-1:2010 [7:4:4] |
| Note on operating and pilot medium | Lubricated operation possible (subsequently required for further operation) |
| Corrosion resistance classification CRC | 0 - No corrosion stress |
| Ambient temperature | -20 ... 80 °C |
| Theoretical force at 6 bar, return stroke | 180 N |
| Theoretical force at 6 bar, advance stroke | 180 N |
| Pneumatic connection | M5 |
| Material cover | Wrought Aluminum alloy |
| Material seals | NBR |
| Material housing | Wrought Aluminum alloy |
| Material piston rod | Case-hardened steel |