

Guide unit

SPZ-20-100-P-A-S6

Part number: 159748

FESTO

With 2 piston rods (Twin slide), for proximity sensing.

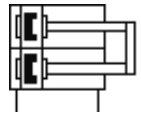
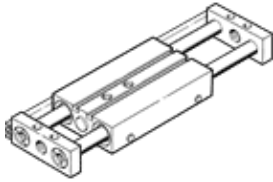

Data sheet

| Feature | Value |
|--|--|
| Stroke | 100 mm |
| Adjustable end-position range/length | 10 mm |
| Piston diameter | 20 mm |
| Operating mode of drive unit | Slide |
| Cushioning | P: Flexible cushioning rings/plates at both ends |
| Assembly position | Any |
| Guide | Plain-bearing guide |
| Design structure | Guide |
| Position detection | For proximity sensor |
| Variants | S6: heat-resistant seals to max. 120 °C |
| Working pressure | 1 ... 10 bar |
| Mode of operation | double-acting |
| Operating medium | Dried compressed air, lubricated or unlubricated |
| Corrosion resistance classification CRC | 2 |
| Ambient temperature | -20 ... 120 °C |
| Theoretical force at 6 bar, return stroke | 282 N |
| Theoretical force at 6 bar, advance stroke | 282 N |
| Pneumatic connection | M5 |
| Materials information for cover | Wrought Aluminum alloy |
| Materials information for seals | FPM |
| Materials information, housing | Wrought Aluminum alloy |
| Materials information for piston rod | High alloy steel, non-corrosive |