

# Precision pressure regulator MS6-LRPB

Part number: 535007

**FESTO**

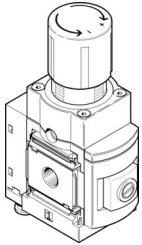

## Data sheet

Feature	Value
Size	6
Series	MS
Actuator lock	Rotary knob with detent Rotary knob with integrated lock can be closed with accessories
Mounting position	optional
Design	Piloted precision diaphragm control valve Piloted precision pressure regulator
Controller function	Output pressure constant With secondary venting
Pressure gauge (ANALOG) or Pressure display (DIGITAL)	Prepared for G1/4 Prepared for G1/8 Via pressure sensor With pressure gauge Via operational status indicator
Operating pressure	0.1 MPa...1.4 MPa 1 bar...14 bar
Pressure regulation range	0.05 bar...12 bar
Max. pressure hysteresis	0.02 bar...0.05 bar
Flow rate of secondary exhaust	220 l/min...900 l/min
Standard nominal flow rate (standardised to DIN 1343)	1600 l/min...9000 l/min
Operational voltage range DC	21.6 V...26.4 V
Max. electrical power consumption	4.2 W
Max. current consumption	0.16 A
Nominal operating voltage DC	24 V
Residual ripple	10 %
Signal range analogue input	0 - 10 V 4 - 20 mA
Approval	c UL us - Recognized (OL)
CE mark (see declaration of conformity)	To EU EMC Directive To EU Explosion Protection Directive (ATEX) In accordance with EU RoHS Directive
UKCA marking (see declaration of conformity)	To UK instructions for EMC To UK EX instructions To UK RoHS instructions

Feature	Value
Explosion protection certification outside the EU	EPL Db (GB) EPL Gb (GB)
Explosion protection	Zone 1 (ATEX) Zone 1 (UKEX) Zone 2 (ATEX) Zone 21 (ATEX) Zone 21 (UKEX) Zone 22 (ATEX)
ATEX category gas	II 2G
ATEX category dust	II 2D
Explosion ignition protection type for gas	Ex h IIC T6 Gb X
Explosion ignition protection type for dust	Ex h IIIC T60°C Db X
Explosion ambient temperature	-10 °C ≤ Ta ≤ +60 °C
Operating medium	Compressed air to ISO 8573-1:2010 [7:4:4] Inert gases
Note on operating and pilot medium	Lubricated operation not possible
Corrosion resistance class CRC	2 - Moderate corrosion stress
LABS (PWIS) conformity	VDMA24364-B1/B2-L
Storage temperature	-10 °C...60 °C
Media temperature	-10 °C...60 °C
Ambient temperature	-10 °C...60 °C
Product weight	800 g...1120 g
Type of mounting	Front panel mounting In-line installation With accessories Either:
Pilot air port 12	G1/8 1/8 NPT
Pneumatic connection, port 1	G1/4 G3/8 G1/2 G3/4 1/4 NPT 3/8 NPT 1/2 NPT 3/4 NPT
Pneumatic connection, port 2	G1/2 1/2 NPT QS-8 QS-10 QS-3/8
Pneumatic connection, port 3	G1/4
Note on materials	RoHS-compliant
Material seals	NBR
Material housing	Aluminium