

Manifold block
PRS-1/4-5-B
Part number: 15864

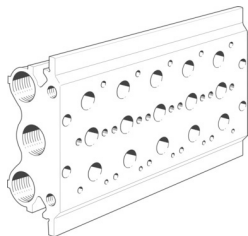

Data sheet

Feature	Value
Max. number of valve positions	5
LABS (PWIS) conformity	VDMA24364-B1/B2-L
Product weight	1900 g
Type of mounting	With through-hole
Pilot exhaust port 82	G1/8
Pilot exhaust port 84	G1/8
Pneumatic connection, port 1	G1/2
Pneumatic connection, port 3	G1/2
Pneumatic connection, port 5	G1/2
Note on materials	RoHS-compliant
Material sub-base	Aluminium