

Colour sensor SOEC

FESTO



Type code

001	Series
SOEC	Colour sensor, optoelectronic
002	Sensor function
RT	Diffuse sensor
003	Design type
Q50	Block design, 50x50x17 mm

004	Switching output
PS	3-wire PNP N/O contact
005	Electrical connection
S	Plug
006	Display
7L	7 light emitting diodes

Datasheet

General technical data

Design	Block design
Size	50x50x17 mm
Type of mounting	With through-hole
Measurement method	Colour sensor
Measured variable	Position
Measuring principle	Optoelectronic
Type of light	White
Max. light spot	Ø 4 mm at a sensing range of 22 mm

Electrical data

Setting options	Teach-in, Teach-in via electrical connection
Electrical connection	8-pin, M12x1, Plugs
Setting range upper limit	32 mm
Setting range lower limit	12 mm
Operational voltage range DC	10 ... 30 V
Voltage drop	≤2.4
Max. output current	100 mA
No-load supply current	40 mA
Switching element function	Light switching
Max. switching frequency	500 Hz
Short circuit current rating	Pulsed
Residual ripple	10%
Reverse polarity protection	For all electrical connections
Degree of protection	IP67
Ready status indication	Green LED
Switching status indication	LED

Operating and environmental conditions

Ambient temperature	-10 ... 55°C
Ambient temperature with moving cable	-5 ... 55°C
CE mark (see declaration of conformity)	To EU EMC Directive, In accordance with EU RoHS Directive
UKCA marking (see declaration of conformity)	To UK instructions for EMC, To UK RoHS instructions
Approval	RCM trademark, c UL us listed (OL)
Conforms to standard	EN 60947-5-2
Corrosion resistance class CRC ¹⁾	4 - Very high corrosion stress
LABS (PWIS) conformity	VDMA24364-B2-L

1) More information www.festo.com/x/topic/crc

Materials

Material housing	ABS
Note on materials	RoHS-compliant

Ordering data

Ordering data					
	Operating distance	Switching output	Product weight	Part no.	Type
	12 ... 32 mm	PNP	38 g	538236	SOEC-RT-Q50-PS-S-7L

Peripherals

Peripherals overview

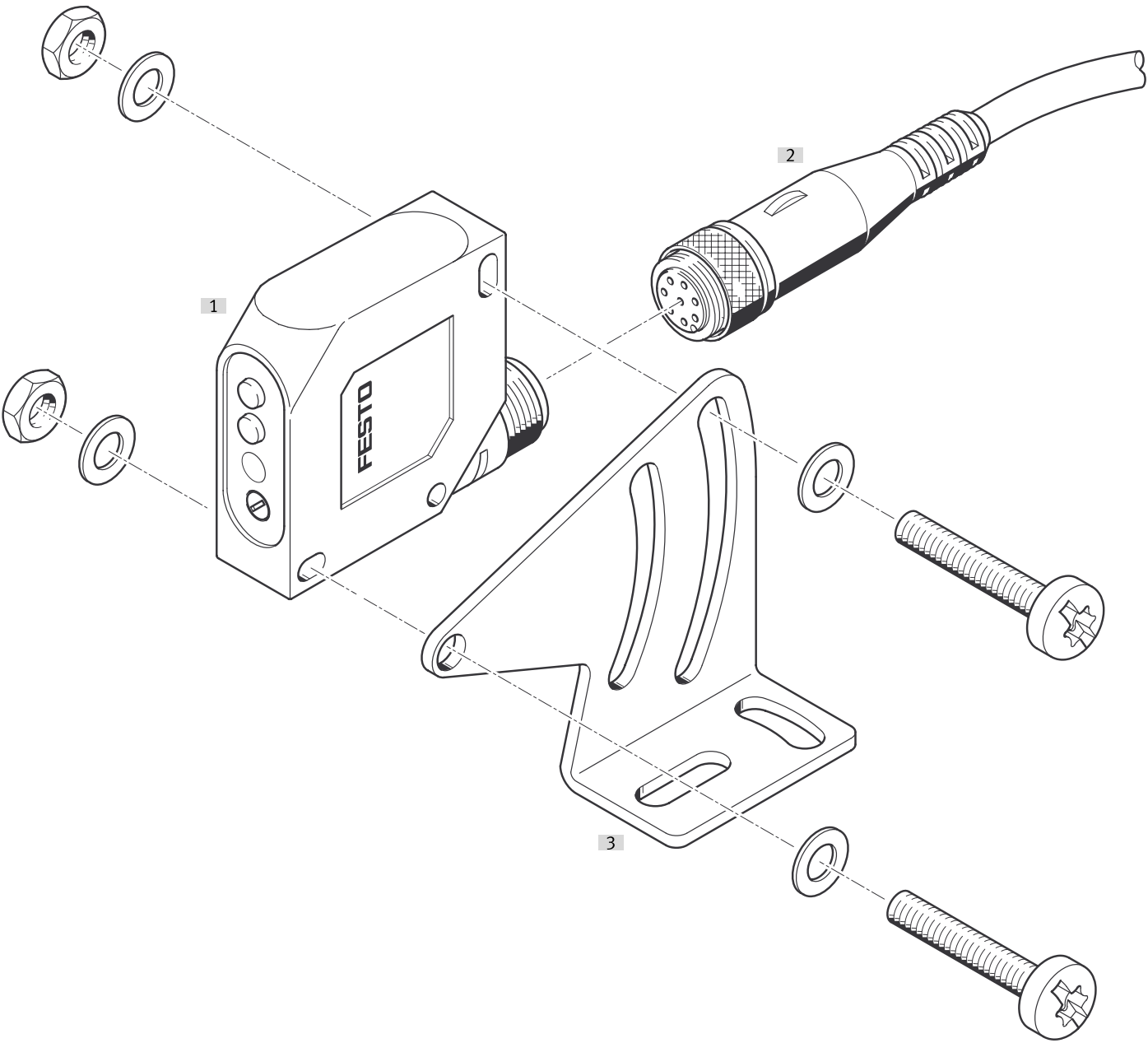

Accessories		→ Link
Type/order code	Description	
[1] SOEC:...	Block design, 50x50x17 mm, with plug	soec
[2] SIM connecting cables	Straight socket	6
[3] Mounting bracket SOEZ-HW-Q50	–	6

Accessories

Connecting cable SIM, socket M12x1, 8-pin, straight						
	Connection technology left, field device side	Electrical connection 1, cable outlet	Connection technology right, controller side	Cable length	Part no.	Type
	Socket M12x1 A-coded, EN 61076-2-101	Straight	Open end	2 m	525616	SIM-M12-8GD-2-PU
				5 m	525618	SIM-M12-8GD-5-PU

Mounting bracket SOEZ-HW-Q50					
	Size	Type of mounting	Product weight	Part no.	Type
	50x50x17 mm	With through-hole	33 g	537786	SOEZ-HW-Q50