

Activated carbon filter MS6N-LFX

FESTO



Characteristics

At a glance

- Removes liquid and gaseous oil particles from compressed air using activated carbon
- Elimination of odours and vapours
- Available with filter cartridge for low flow rates, suitable for sealing air and purge air applications
- Prefiltration with micro filter MS-LFM-A (grade of filtration 0.01 µm) is recommended
- Air purity class at the output [1.4.1] acc. to ISO 8573-1

Ordering data - modular system

Link [ms6n-lfx](#)

Configurable product

This product and all its product options can be ordered online via the configurator.

Size

Grid dimension: 62 mm

Standard nominal flow rate:

- 24.7 ... 42.4 scfm

Pneumatic connection

Depending on the size, different connection types can be selected:

- Individual fittings that are fastened via a female thread
- Connecting plates with female thread

Bowl type

Bowl guard can be selected either as a plastic bowl guard or integrated as a metal bowl guard.

Type of mounting

[WP]

Mounting bracket basic design

[WB]

Mounting centrally at rear (wall mounting top and bottom),
connecting plates not required



- For connecting the modules for wall mounting
- In combination with connecting plate MS6-AQ... for mounting an individual device on a wall
- In combination with mounting plate MS6-AEND for wall mounting of a single device
- Same wall distance for mixing combination with MS4 and MS6 series

- For wall mounting an individual device
- For size 4 or 6

[WPM]

Mounting bracket for hooking in service unit components



- Mounting attachment and connector for service unit combination
- Mount and dismount the service unit combination quickly
- Spacer for maintaining the mounting gap
- For size 4, 6, or 9

Type code

001	Series	
MS	MS series	
002	Size	
6	Grid dimension 62 mm	
003	Thread type	
N	NPT thread	
004	Function	
LFX	Activated carbon filter	
005	Pneumatic connection	
N14	1/4 NPT	
N12	1/2 NPT	
N38	3/8 NPT	
N34	3/4 NPT	
006	Bowl type	
R	Plastic tray with plastic basket	
U	Aluminium	

007	Flow rate	
	Standard	
HF	High flow rate	
008	Range of applications	
	None	
HP	Suitable for sealing air and purge air	
009	Type of mounting	
	Without mounting bracket	
WP	Mounting bracket basic design	
WPM	Mounting bracket for hooking in service unit components	
WB	Mounting centrally at rear (wall mounting top and bottom), connecting plates not required	
010	UL certification	
	None	
UL1	cULus ordinary location for Canada and USA	
011	Flow direction	
	Flow direction from left to right	
Z	Flow direction from right to left	

Datasheet

General technical data

Pneumatic connection, port 1	G1/4	G3/8	G1/2
Pneumatic connection, port 2	G1/4	G3/8	G1/2
Size	6		
Design	Activated carbon filter		
Type of mounting	Either: In-line installation With accessories		
Mounting position	Vertical +/- 5°		
Air purity class at output	Compressed air according to ISO 8573-1:2010 [3:4:1]		
Bowl guard	Plastic bowl guard, Integrated as metal bowl		
Residual oil content	0.003 mg/m ³		

Standard nominal flow rate q_N

Pneumatic connection, port 1	G1/4	G3/8	G1/2
Max. standard flow rate for clean air class	900 l/min		

Operating and environmental conditions

Operating pressure	0 ... 20 bar
Operating medium	Compressed air according to ISO 8573-1:2010 [3:4:2]
Ambient temperature	-10 ... 60°C
Media temperature	5 ... 30°C
Storage temperature	-10 ... 60°C
Corrosion resistance class CRC ¹⁾	2 - Moderate corrosion stress
Suitable for use with food ²⁾	See supplementary material information
Approval ³⁾	c UL us - Recognized (OL)
UL certification	None, cULus ordinary location for Canada and USA

1) More information www.festo.com/x/topic/crc

2) More information www.festo.com/catalogue/ms6n-lfx → Support/Downloads.

3) More information www.festo.com/catalogue/ms6n-lfx → Support/Downloads.

Materials

Bowl type	Plastic tray with plastic basket [R]	Aluminium [U]
Material housing	Die-cast aluminium	
Material bowl	PC	Wrought aluminium alloy
Material filter	Activated carbon	
Note on materials	RoHS-compliant	
LABS (PWIS) conformity	VDMA24364-B1/B2-L	

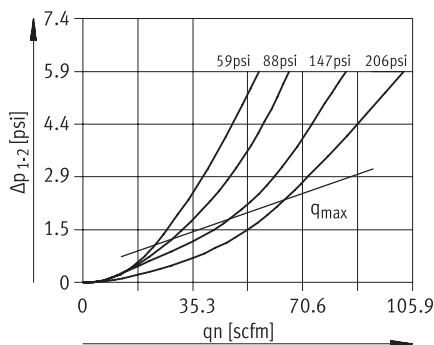
Standard flow rate q_N as a function of differential pressure Δp₁₋₂ (MS6N-LFM-3/8)

Datasheet

Standard flow rate q_n as a function of differential pressure Δp_{1-2} (MS6N-LFM-3/8)

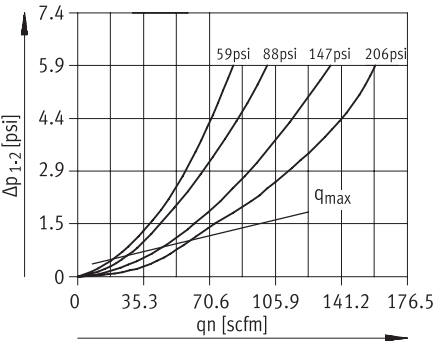

Standard flow rate q_n as a function of differential pressure Δp_{1-2} (MS6N-LFM-3/8)

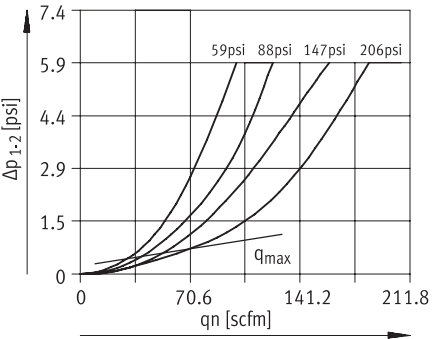

Dimensions

Dimensions – Standard/application range HP Download CAD data www.festo.com

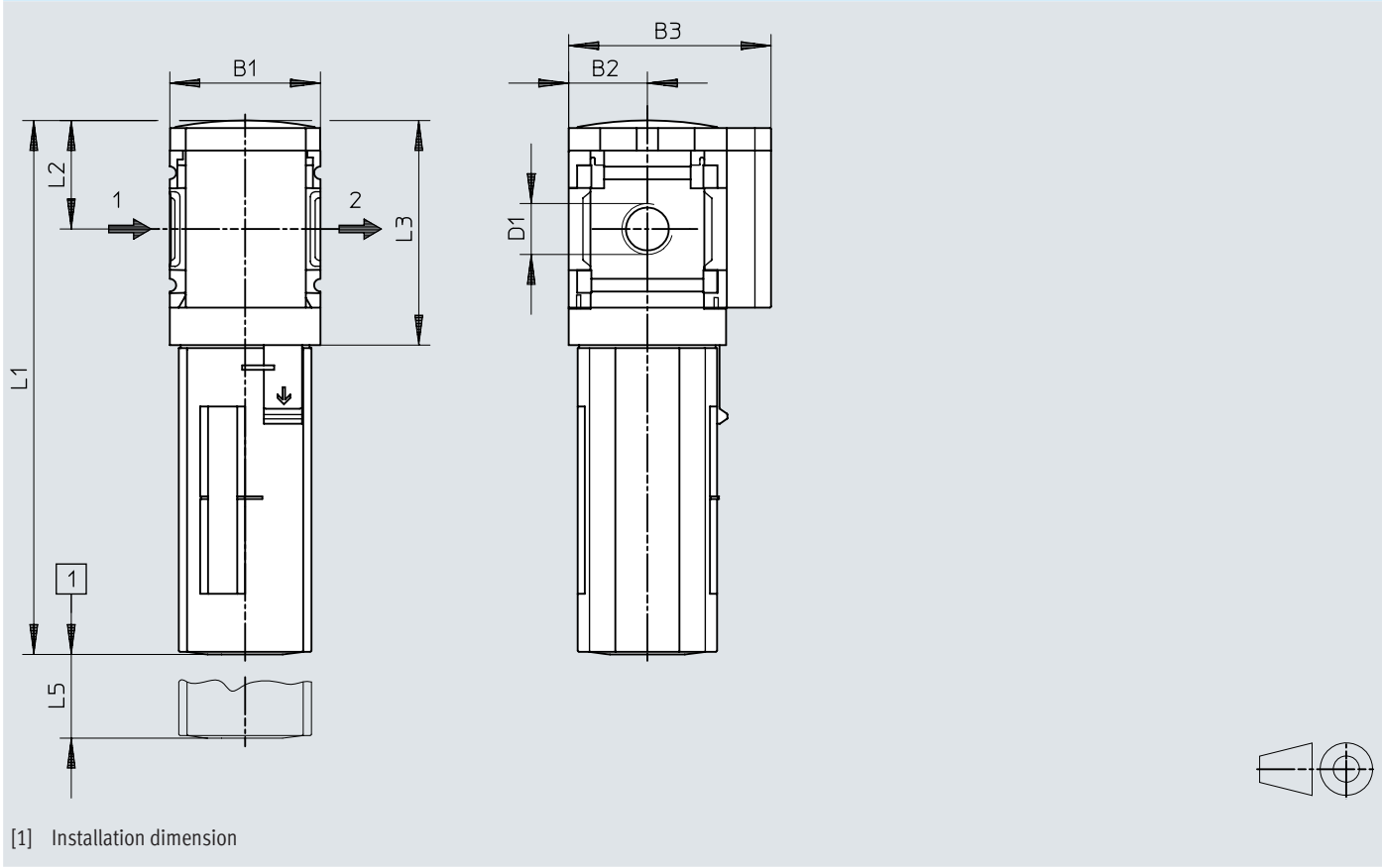

	B1	B2	B3	D1	L1		L2	L3	L5
	[inch]	[inch]	[inch]		1) [inch]	2) [inch]	[inch]	[inch]	[inch]
MS6N-LFX-1/4	2,44	1,22	2,99	1/4 NPT	7,56	7,80	1,65	3,43	3,94
MS6N-LFX-3/8				3/8 NPT					
MS6N-LFX-1/2				1/2 NPT					

- 1) Bowl guard, polymer
- 2) Bowl guard, metal

Dimensions

Dimensions – High flow rate HF

Download CAD data www.festo.com

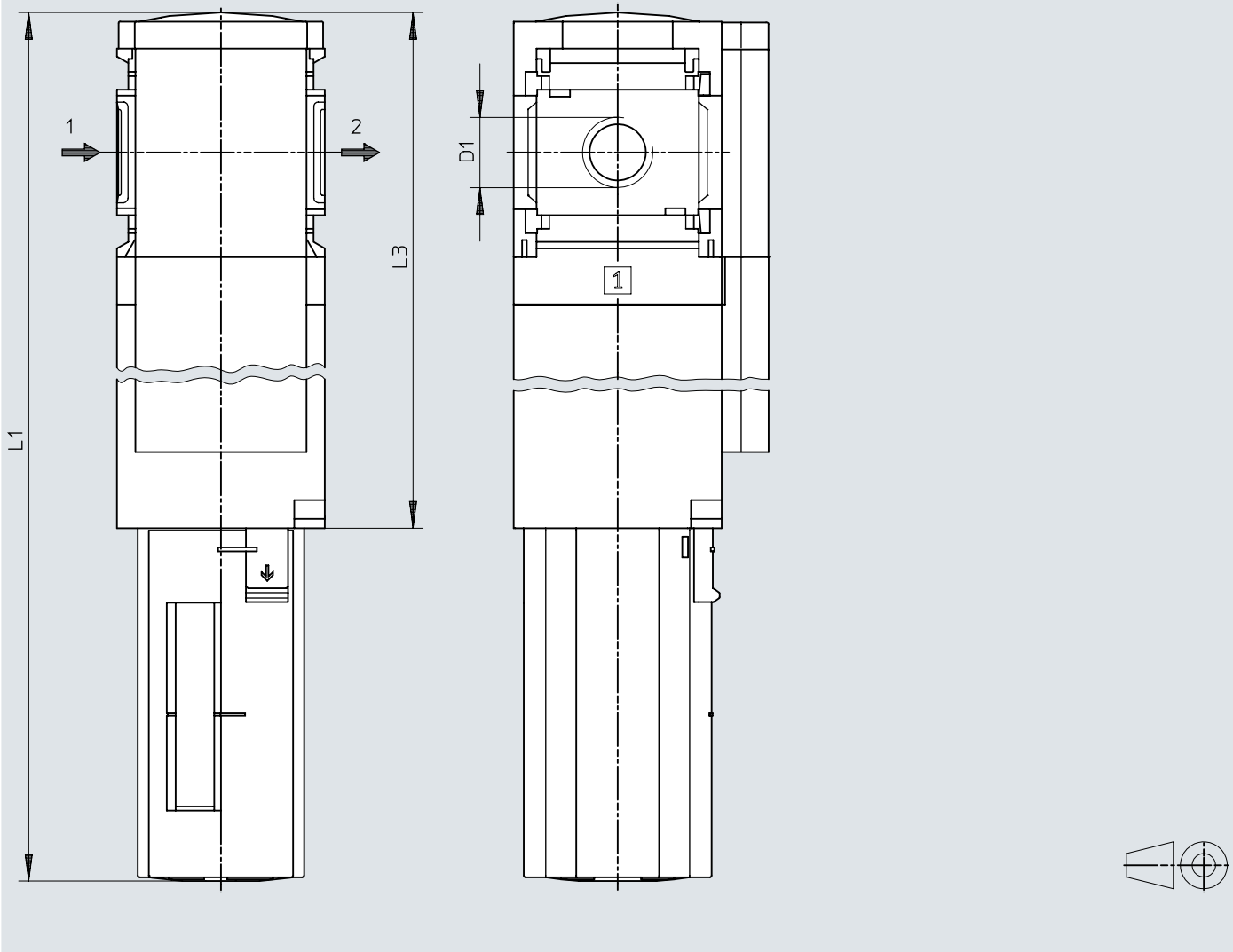

	B1	B2	B3	D1	L1		L2	L3	L5
	[inch]	[inch]	[inch]		1)	2)	[inch]	[inch]	[inch]
					[inch]	[inch]			
MS6N-LFX-1/4-...-HF	2,44	1,22	2,99	1/4 NPT	12,28	12,52	1,65	8,15	3,94
MS6N-LFX-3/8-...-HF				3/8 NPT					
MS6N-LFX-1/2-...-HF				1/2 NPT					

- 1) Bowl guard, polymer
2) Bowl guard, metal

Ordering data

Ordering data				
	Pneumatic connection, port 1	Product weight	Part no.	Type
	G1/4	600 g	531920	MS6N-LFX-1/4-R
		820 g	531926	MS6N-LFX-1/4-U
	G3/8	600 g	531922	MS6N-LFX-3/8-R
		820 g	531928	MS6N-LFX-3/8-U
	G1/2	600 g	531921	MS6N-LFX-1/2-R
		820 g	531927	MS6N-LFX-1/2-U

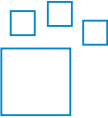
Ordering data – Modular product system			
	Short type code	Part no.	Type
	MS6N-LFX	527673	MS6N-LFX

Peripherals

Peripherals overview

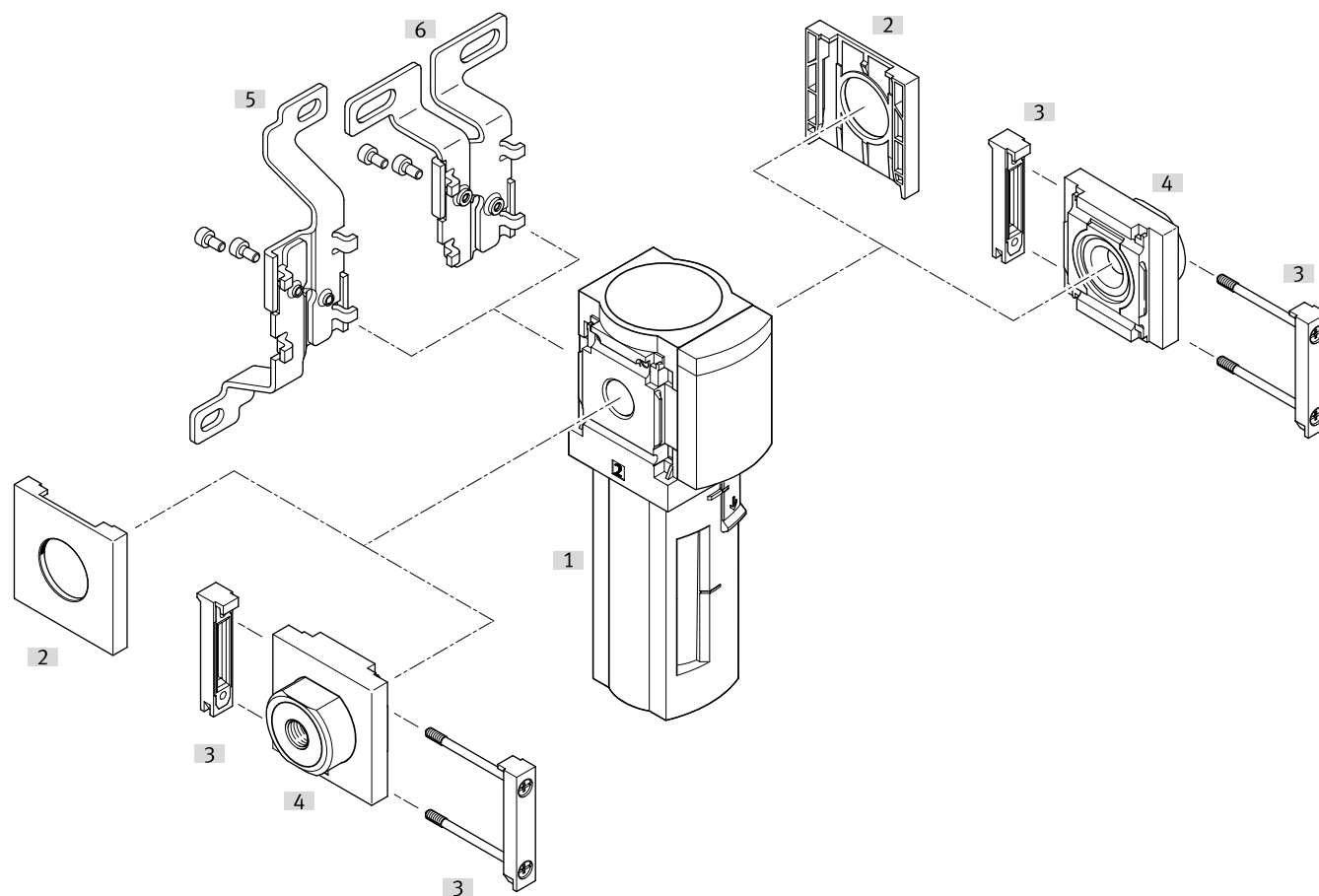



Accessories			→ Link
Type/order code	Description		
[1] Activated carbon filter MS6N-LFX	Illustration based on MS4N-LF as an example		ms6n-lfx
[2] Cover cap MS6-END	For devices without connecting plate		11
[3] Module connector MS6-MV1	For device combinations and individual devices with connecting plate		10
[4] Connecting plate SET MS6-AQ...	Order code [AG...]; for device combinations		10
[5] Mounting bracket MS6-WB	For individual device		10
[6] Mounting bracket MS...-WBM	Only available for size 4		-
[7] Mounting bracket MS6-WP/WPB/WPE/WPM	Not shown		ms6-wp
[8] Activated carbon filter cartridge	Not shown		10

Accessories

Activated carbon filter cartridge						
	Size	Material filter	LABS (PWIS) conformity	Part no.	Type	
	6	Activated carbon	VDMA24364-B1/B2-L	532911	MS6-LFX	
				547925	MS6-LFX-AKI	
				552094	MS6-LFX-HF	

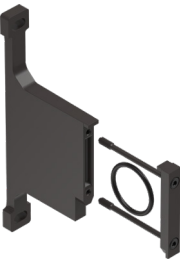
Module connector MS6-MV1						
	Size	Material module connector	LABS (PWIS) conformity	Product weight	Part no.	Type
	6	POM, High-alloy stainless steel	VDMA24364-B1/B2-L	33 g	8119204	MS6-MV1

Mounting bracket MS6-WP...						
	Size	Material bracket	LABS (PWIS) conformity	Product weight	Part no.	Type
	6	Die-cast aluminium	VDMA24364-B1/B2-L		1025936	MS6-WPE
				76 g	532195	MS6-WP
				115 g	526074	MS6-WPB
				144 g	526073	MS6-WPM-D
				154 g	532186	MS6-WPM-2D

Mounting bracket MS6-WB						
	Size	Material bracket	LABS (PWIS) conformity	Product weight	Part no.	Type
	6	Steel	VDMA24364-B1/B2-L	121 g	532196	MS6-WB

Connecting plate SET MS6-AQ...						
	Size	Pneumatic connection, port 1		Part no.	Type	
	6	1/4 NPT		526076	MS6N-AQN	

Accessories

Connecting plate SET MS6-AQ...				
	Size	Pneumatic connection, port 1	Part no.	Type
	6	3/8 NPT	526077	MS6N-AQP
		1/2 NPT	526078	MS6N-AQR
		3/4 NPT	526079	MS6N-AQS

Cover cap MS6-END			
	Size	Part no.	Type
	6	538780	MS6-END