

## Limit switch attachments DAPZ

**FESTO**



## Type codes

<b>001</b>	<b>Series</b>	
<b>DAPZ</b>	Limit switch attachment	
<b>002</b>	<b>Design type</b>	
<b>SB</b>	Sensor box	
<b>003</b>	<b>Sensor principle</b>	
<b>I</b>	Proximity switch, inductive	
<b>M</b>	Micro switch, antivalent	

<b>004</b>	<b>Nominal operating voltage</b>	
<b>30DC</b>	30 V DC	
<b>250AC</b>	250 V AC	
<b>005</b>	<b>Display type</b>	
<b>D</b>	Switching position indication	
<b>006</b>	<b>Housing shape</b>	
<b>R</b>	Round	
<b>007</b>	<b>Additional features</b>	
<b>AR</b>	Foot height adjustable	

## Data sheet

- Actuator interface to Namur VDI/VDE 3845
- Quick and easy assembly and connection
- Integrated solenoid valve control



General technical data		DAPZ-SB-M-250AC-DR-AR	DAPZ-SB-I-30DC-DR-AR
Measuring principle		Mechanical, electrical	Inductive
Based on standard		EN 60947-5-1 VDI/VDE 3845 (NAMUR)	EN 60947-5-2
Design		Round	
Mounting position		Any	
Short circuit current rating		No	Pulsed
Switching element function		Changeover switch	N/O contact
Reverse polarity protection		No	For all electrical connections
Switching position indication		Yes	
Switching output		–	PNP
Operating voltage range	Direct current DC [V]	4 ... 250	10 ... 30
	Alternating current AC [V]	4 ... 250	–
Intrinsic current consumption at operating voltage	[mA]	1 ... 5	0 ... 100
Insulation voltage	[V]	250	50
Surge resistance	[kV]	2.5	0.5
Max. output current	[mA]	5 000	100
Minimum load current		1 mA at 4 V / DC	–
Electrical connection		Screw terminal	
Permissible cable diameter	[mm]	7 ... 13	
Cable connector		M20x1.5	

Operating and environmental conditions		DAPZ-SB-M-250AC-DR-AR	DAPZ-SB-I-30DC-DR-AR
Ambient temperature	[°C]	–20 ... +70 °C	
Degree of protection		IP67	
CE marking (see declaration of conformity)		To EU Low Voltage Directive	–
Pollution degree		3	
Corrosion resistance CRC <sup>1)</sup>		2	

1) Corrosion resistance class CRC 2 to Festo standard FN 940070

Moderate corrosion stress. Indoor applications in which condensation can occur. External visible parts with primarily decorative surface requirements which are in direct contact with a normal industrial environment.

Materials	
Housing cover	PC
Housing socket, console	ABS, PC
Seals	NBR
Note on materials	RoHS-compliant

Data sheet

Dimensions

Download CAD data → [www.festo.com](http://www.festo.com)

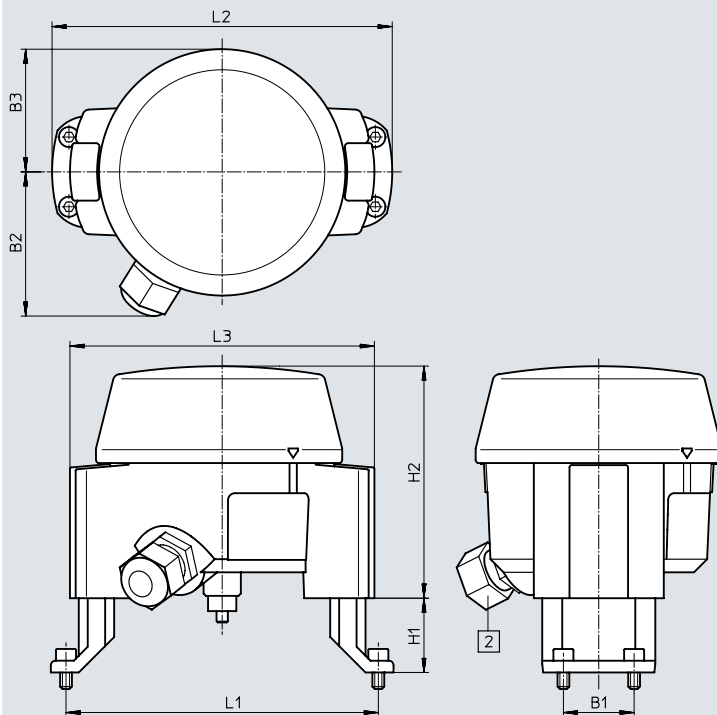





[2] Cable connector M20x1.5

	B1	B2	B3	H1	H2	L1	L2	L3
<b>Feet mounted inwards</b>								
Foot height adjustable	30	62	52.5	20, 30, 50	100	80	66	130
<b>Feet mounted outwards</b>								
Foot height adjustable	30	62	52.5	20, 30, 50	100	130	144	130

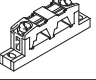
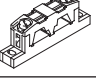
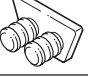
<b>Ordering data</b>				
Sensing type	Variant	Measuring principle	Part no.	Type
Mechanical	Basic type	Mechanical, electrical	534474	DAPZ-SB-M-250AC-DR-AR
Non-contacting	Basic type	Inductive	534475	DAPZ-SB-I-30DC-DR-AR

## Accessories

Ordering data	Brief description	Part no.	Type
<b>Bus connection</b>			
	Flat cable for AS-Interface components, yellow, 100 m	18940	KASI-1.5-Y-100
	Cable distributor for flat cables, rotatable cables	18786	ASI-KVT-FK
	Cable distributor for flat cables, symmetrical cables	18797	ASI-KVT-FK-S
	Cable cap for flat cable (50 included in the scope of delivery)	18787	ASI-KK-FK
	Cable sleeve (20 included in the scope of delivery)	165593	ASI-KT-FK
<b>Other</b>			
	Addressing device for AS-Interface stations	18959	ASI-PRG-ADR
	Addressing cable for addressing device	18960	KASI-ADR

# Festo - Your Partner in Automation



**1 Festo Inc.**  
5300 Explorer Drive  
Mississauga, ON L4W 5G4  
Canada

**Festo Customer Interaction Center**  
Tel: 1 877 463 3786  
Fax: 1 877 393 3786  
Email: [customer.service.ca@festo.com](mailto:customer.service.ca@festo.com)



**2 Festo Pneumatic**  
Av. Ceylán 3,  
Col. Tequesquináhuac  
54020 Tlalneptla,  
Estado de México

**Multinational Contact Center**  
01 800 337 8669  
[ventas.mexico@festo.com](mailto:ventas.mexico@festo.com)



**3 Festo Corporation**  
1377 Motor Parkway  
Suite 310  
Islandia, NY 11749

**Festo Customer Interaction Center**  
1 800 993 3786  
1 800 963 3786  
[customer.service.us@festo.com](mailto:customer.service.us@festo.com)



**4 Regional Service Center**  
7777 Columbia Road  
Mason, OH 45040

Connect with us



[www.festo.com/socialmedia](http://www.festo.com/socialmedia)



[www.festo.com](http://www.festo.com)

Subject to change