

Connecting cables for valves, Sub-D socket

Type codes – Connecting cable for valve terminal MPA-L

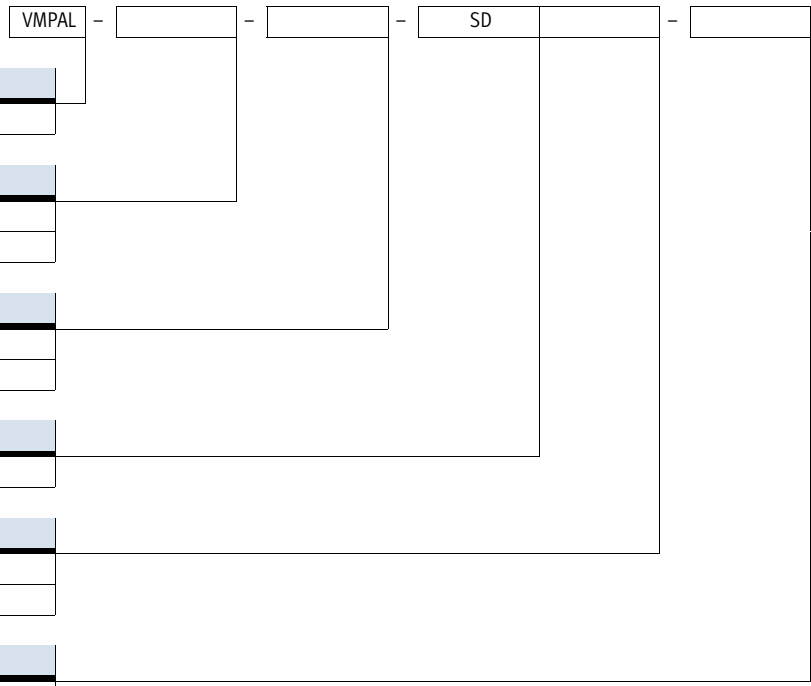

Function

VMPAL	Connecting cables for valve terminal MPA-L
-------	--

Cable characteristic

KM	Standard
KMSK	Suitable for use with energy chains

Cable outlet on the left

V	At the front
S	At the side

Connection technology on the left, field device side

SD	Sub-D socket
----	--------------

Number of pins/wires, left

25	25-pin
44	44-pin

Cable length

2,5	2.5 m
5	5 m
10	10 m
X	0.5 ... 30 m

Connecting cables for valves, Sub-D socket

Technical data

Connecting cable VMPAL

- Connecting cable for multi-pin plug connection
- Pre-assembled
- Socket at the side or angled forward
- Cable lengths 2.5 m, 5 m, 10 m or any length from 0.5 ... 30 mm

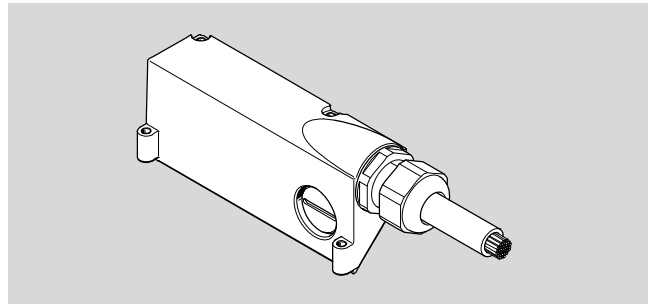

General technical data		
Type	VMPAL-KM	VMPAL-KMSK
Electrical connection	Sub-D socket	Sub-D socket
	Open end	Open end
Cable characteristic	Standard	Suitable for use with energy chains

Technical data				
Type		VMPAL-KM-...-SD25	VMPAL-KM-...-SD44	VMPAL-KMSK
Cable composition	[mm ²]	25 x 0.34	36 x 0.25	25 x 0.34
Cable diameter	[mm]	10.2	9.6	12.5
Min. cable bending radius	[mm]	122	115	63
Degree of protection to EN 60529		IP67	IP67	IP67

Materials		
Type	VMPAL-KM	VMPAL-KMSK
Cable sheath	PVC	TPE-U(PU)
Note on materials	RoHS-compliant	

Operating and environmental conditions		
Ambient temperature with flexible cable installation	[°C]	-5 ... +80
Corrosion resistance class CRC ¹⁾		2

1) Corrosion resistance class CRC 2 to Festo standard FN 940070
Moderate corrosion stress. Indoor applications in which condensation may occur. External visible parts with primarily decorative requirements for the surface and which are in direct contact with the ambient atmosphere typical for industrial applications.

Connecting cables for valves, Sub-D socket

Technical data

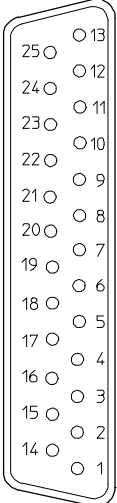
Circuitry (view of socket), 25-wire connecting cable				
	Pin	Wire colour ¹⁾	Pin	Wire colour ¹⁾
	1	WH	14	BN YE
	2	GN	15	GY WH
	3	YE	16	BN GY
	4	GY	17	WH PK
	5	PK	18	BN PK
	6	BU	19	BU WH
	7	RD	20	BN BU
	8	VT	21	RD WH
	9	GY PK	22	BN RD
	10	RD BU	23	BK WH
	11	GN WH	24	BN
	12	BN GN	25	BK
	13	YE WH		

1) To IEC 757

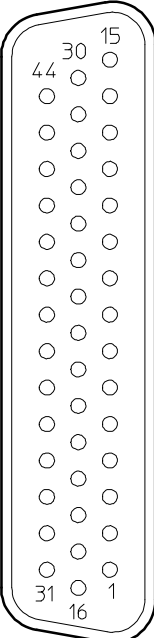
Circuitry (view of socket), 36-wire connecting cable						
	Pin	Wire colour ¹⁾	Pin	Wire colour ¹⁾	Pin	Wire colour ¹⁾
	1	WH	18	BN PK	35	n.c.
	2	GN	19	BU WH	36	n.c.
	3	YE	20	BN BU	37	n.c.
	4	GY	21	RD WH	38	n.c.
	5	PK	22	BN RD	39	n.c.
	6	BU	23	BK WH	40	n.c.
	7	RD	24	BN	41	RD YE
	8	VT	25	BK BN	42	BK GN
	9	GY PK	26	GN GY	43	BK YE
	10	RD BU	27	YE GY	44	BK
	11	GN WH	28	GN PK		
	12	BN GN	29	YE PK		
	13	YE WH	30	GN BU		
	14	BN YE	31	YE BU		
	15	GY WH	32	RD GN		
	16	BN GY	33	n.c.		
	17	WH PK	34	n.c.		

1) To IEC 757

Connecting cables for valves, Sub-D socket

Ordering data

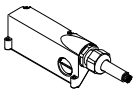
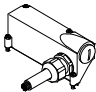
Electrical multi-pin plug connection – Ordering data						
	Description		Connection	Cable length	Part No.	Type
Connecting cable for multi-pin plug connection, with Sub-D socket						
	Cable outlet to front	Cable characteristic: suitable for use with energy chains	25-pin	2.5 m	560410	VMPAL-KMSK-V-SD25-IP67-2,5
				5 m	560411	VMPAL-KMSK-V-SD25-IP67-5
				10 m	560412	VMPAL-KMSK-V-SD25-IP67-10
				0.5 ... 30 m	562391	VMPAL-KMSK-V-SD25-IP67-X
		Cable characteristic: standard	25-pin	2.5 m	560416	VMPAL-KM-V-SD25-IP67-2,5
				5 m	560417	VMPAL-KM-V-SD25-IP67-5
				10 m	560418	VMPAL-KM-V-SD25-IP67-10
				0.5 ... 30 m	562389	VMPAL-KM-V-SD25-IP67-X
	44-pin	2.5 m	560422	VMPAL-KM-V-SD44-IP67-2,5		
		5 m	560423	VMPAL-KM-V-SD44-IP67-5		
		10 m	560424	VMPAL-KM-V-SD44-IP67-10		
		0.5 ... 30 m	562390	VMPAL-KM-V-SD44-IP67-X		
	Cable outlet to side	Cable characteristic: suitable for use with energy chains	25-pin	2.5 m	560413	VMPAL-KMSK-S-SD25-IP67-2.5
				5 m	560414	VMPAL-KMSK-S-SD25-IP67-5
				10 m	560415	VMPAL-KMSK-S-SD25-IP67-10
				0.5 ... 30 m	562394	VMPAL-KMSK-S-SD25-IP67-X
		Cable characteristic: standard	25-pin	2.5 m	560419	VMPAL-KM-S-SD25-IP67-2.5
				5 m	560420	VMPAL-KM-S-SD25-IP67-5
				10 m	560421	VMPAL-KM-S-SD25-IP67-10
				0.5 ... 30 m	562392	VMPAL-KM-S-SD25-IP67-X
	44-pin	2.5 m	560425	VMPAL-KM-S-SD44-IP67-2.5		
		5 m	560426	VMPAL-KM-S-SD44-IP67-5		
		10 m	560427	VMPAL-KM-S-SD44-IP67-10		
		0.5 ... 30 m	562393	VMPAL-KM-S-SD44-IP67-X		

Festo North America

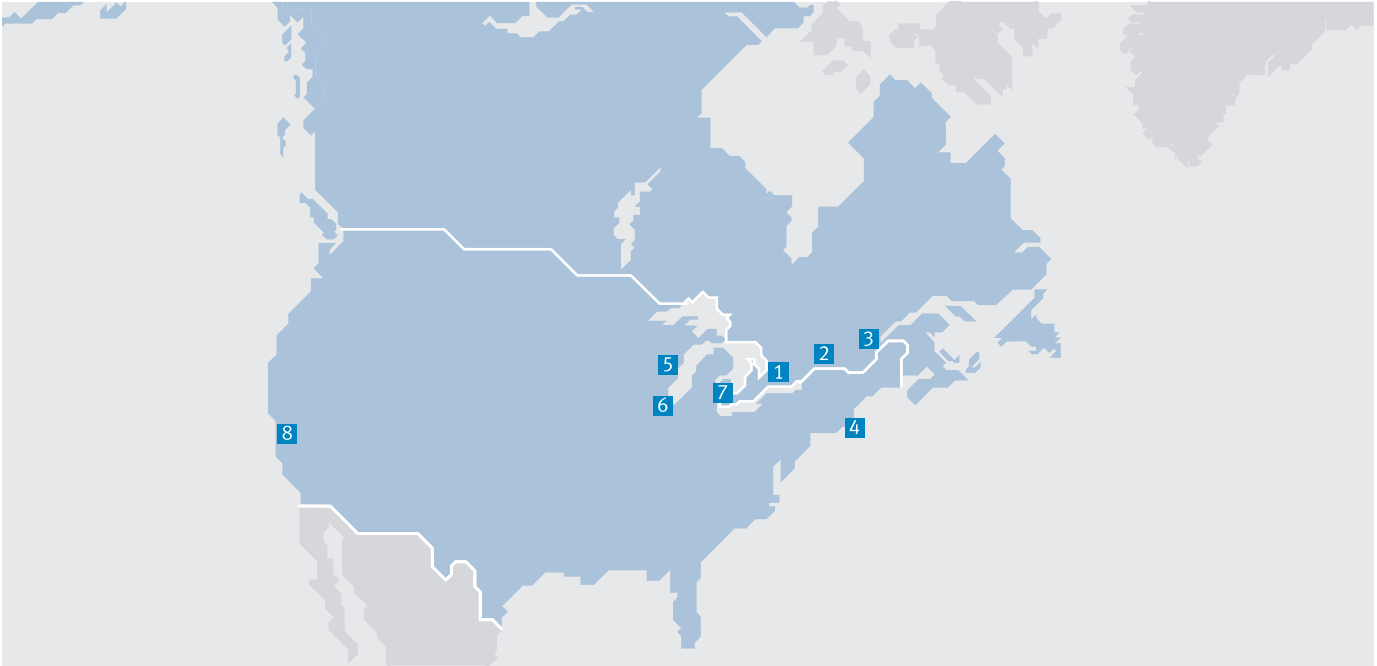

**1 Festo Canada
Headquarters
Festo Inc.**
5300 Explorer Drive
Mississauga, ON
L4W 5G4

2 Montréal
5600, Trans-Canada
Pointe-Claire, QC
H9R 1B6

3 Québec City
2930, rue Watt#117
Québec, QC
G1X 4G3



**4 Festo United States
Headquarters
Festo Corporation**
395 Moreland Road
Hauppauge, NY
11788

5 Appleton
North 922 Tower View Drive, Suite N
Greenville, WI
54942

7 Detroit
1441 West Long Lake Road
Troy, MI
48098

6 Chicago
85 W Algonquin - Suite 340
Arlington Heights, IL
60005

8 Silicon Valley
4935 Southfront Road, Suite F
Livermore, CA
94550

Festo Regional Contact Center

Canadian Customers

Commercial Support:
Tel: 1 877 GO FESTO (1 877 463 3786)
Fax: 1 877 FX FESTO (1 877 393 3786)
Email: festo.canada@ca.festo.com

Technical Support:
Tel: 1 866 GO FESTO (1 866 463 3786)
Fax: 1 877 FX FESTO (1 877 393 3786)
Email: technical.support@ca.festo.com

USA Customers

Commercial Support:
Tel: 1 800 99 FESTO (1 800 993 3786)
Fax: 1 800 96 FESTO (1 800 963 3786)
Email: customer.service@us.festo.com

Technical Support:
Tel: 1 866 GO FESTO (1 866 463 3786)
Fax: 1 800 96 FESTO (1 800 963 3786)
Email: product.support@us.festo.com