

# Accessories

## Silencers G 1/8 to G 1 and 1/8" to 1/2" NPT

### Silencer

Diecast Al

Type U-...-B

U-...-B-NPT



Silencers are used to reduce the noise at the outlet ports of valves.

These slim, rugged, die-cast components are used where space is limited.

The silencing effect is achieved by reducing air speed. The silencers achieve a considerable reduction in exhaust air noise without affecting the speed of the piston rod of a cylinder.

Important: Clean silencers in kerosene or naptha (not with trichloroethylene).

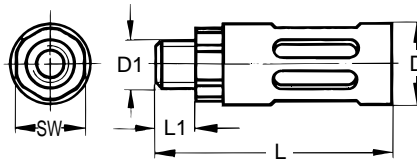

SW = wrench size (mm)

Type	D diameter in / mm	D1	L in / mm	L1 in / mm	SW in / mm
U-1/8-B	0.63 / 16.0	G 1/8 ISO	1.56 / 39.5	0.26 / 6.5	0.55 / 14
U-1/8-B-NPT	0.63 / 16.0	1/8 NPT	1.56 / 39.5	0.26 / 6.5	0.55 / 14
U-1/4-B	0.77 / 19.5	G 1/4 ISO	2.22 / 56.5	0.33 / 8.5	0.67 / 17
U-1/4-B-NPT	0.77 / 19.5	1/4 NPT	2.22 / 56.5	0.33 / 8.5	0.67 / 17
U-3/8-B	0.98 / 25.0	G 3/8 ISO	3.48 / 88.5	0.41 / 10.5	0.75 / 19
U-3/8-B-NPT	0.98 / 25.0	3/8 NPT	3.48 / 88.5	0.41 / 10.5	0.75 / 19
U-1/2-B	1.10 / 28.0	G 1/2 ISO	4.72 / 120.0	0.55 / 14	0.94 / 24
U-1/2-B-NPT	1.10 / 28.0	1/2 NPT	4.72 / 120.0	0.55 / 14	0.94 / 24
U-3/4-B	1.50 / 38.0	G 3/4 ISO	5.59 / 142.0	0.63 / 16	1.26 / 32
U-1-B	1.88 / 47.8	G1 ISO	7.06 / 179.4	0.59 / 15	1.42 / 36

Pressure Range			0 to 150 psi / 0 to 10 bar				
Temperature Range			-50°F to +158°F / -10°C to +70°C				
Order No.	Type	Thread	Noise level at 90 psi / 6 bar to atmosphere* dB (A)	Orifice size at inlet in / mm	C <sub>v</sub> factor** C <sub>v</sub> / l/min	Weight lb / kg	Materials
Part No.							
6841	U-1/8-B	G 1/8 ISO	74	0.21 / 5.3	1.45 / 1450	0.018 / 0.008	Housing: Diecast Aluminum Insert: Plastic
12638	U-1/8-B-NPT	1/8 NPT	74	0.21 / 5.3	1.45 / 1450	0.018 / 0.008	
6842	U-1/4-B	G 1/4 ISO	78	0.30 / 7.5	3.00 / 3000	0.037 / 0.017	
12639	U-1/4-B-NPT	1/4 NPT	78	0.30 / 7.5	3.00 / 3000	0.037 / 0.017	
6843	U-3/8-B	G 3/8 ISO	80	0.35 / 9.0	4.50 / 4500	0.082 / 0.037	
12740	U-3/8-B-NPT	3/8 NPT	80	0.35 / 9.0	4.50 / 4500	0.082 / 0.037	
6844	U-1/2-B	G 1/2 ISO	80	0.55 / 14.0	6.00 / 6500	0.165 / 0.075	
12741	U-1/2-B-NPT	1/2 NPT	80	0.55 / 14.0	6.00 / 6500	0.165 / 0.075	
6845	U-3/4-B	G 3/4 ISO	81	0.67 / 17.0	11.0 / 11000	0.265 / 0.120	
151990	U-1-B	G 1 ISO	82	0.93 / 23.5	17.3 / 17300	0.514 / 0.233	

\* Measured at a distance of 3 ft / 1 m

\*\* At 90 psi / 6 bar



# Product Range and Company Overview

## A Complete Suite of Automation Services

Our experienced engineers provide complete support at every stage of your development process, including: conceptualization, analysis, engineering, design, assembly, documentation, validation, and production.



**Custom Automation Components**  
Complete custom engineered solutions



**Custom Control Cabinets**  
Comprehensive engineering support and on-site services



**Complete Systems**  
Shipment, stocking and storage services

## The Broadest Range of Automation Components

With a comprehensive line of more than 30,000 automation components, Festo is capable of solving the most complex automation requirements.



**Electromechanical**  
Electromechanical actuators, motors, controllers & drives



**Pneumatics**  
Pneumatic linear and rotary actuators, valves, and air supply



**PLCs and I/O Devices**  
PLC's, operator interfaces, sensors and I/O devices

## Supporting Advanced Automation... As No One Else Can!

Festo is a leading global manufacturer of pneumatic and electromechanical systems, components and controls for industrial automation, with more than 12,000 employees in 56 national headquarters serving more than 180 countries. For more than 80 years, Festo has continuously elevated the state of manufacturing with innovations and optimized motion control solutions that deliver higher performing, more profitable automated manufacturing and processing equipment. Our dedication to the advancement of automation extends beyond technology to the education and development of current and future automation and robotics designers with simulation tools, teaching programs, and on-site services.

## Quality Assurance, ISO 9001 and ISO 14001 Certifications

Festo Corporation is committed to supply all Festo products and services that will meet or exceed our customers' requirements in product quality, delivery, customer service and satisfaction.

To meet this commitment, we strive to ensure a consistent, integrated, and systematic approach to management that will meet or exceed the requirements of the ISO 9001 standard for Quality Management and the ISO 14001 standard for Environmental Management.



© Copyright 2008, Festo Corporation. While every effort is made to ensure that all dimensions and specifications are correct, Festo cannot guarantee that publications are completely free of any error, in particular typing or printing errors. Accordingly, Festo cannot be held responsible for the same. For Liability and Warranty conditions, refer to our "Terms and Conditions of Sale", available from your local Festo office. All rights reserved. No part of this publication may be reproduced, distributed, or transmitted in any form or by any means, electronic, mechanical, photocopying or otherwise, without the prior written permission of Festo. All technical data subject to change according to technical update.



Printed on recycled paper at New Horizon Graphic, Inc., FSC certified as an environmentally friendly printing plant.

# Festo - Your Partner in Automation



**1 Festo Inc.**  
5300 Explorer Drive  
Mississauga, ON L4W 5G4  
Canada

**Festo Customer Interaction Center**  
Tel: 1 877 463 3786  
Fax: 1 877 393 3786  
Email: [customer.service.ca@festo.com](mailto:customer.service.ca@festo.com)



**2 Festo Pneumatic**  
Av. Ceylán 3,  
Col. Tequesquináhuac  
54020 Tlalnepantla,  
Estado de México

**Multinational Contact Center**  
01 800 337 8669  
[ventas.mexico@festo.com](mailto:ventas.mexico@festo.com)



**3 Festo Corporation**  
1377 Motor Parkway  
Suite 310  
Islandia, NY 11749

**Festo Customer Interaction Center**  
1 800 993 3786  
1 800 963 3786  
[customer.service.us@festo.com](mailto:customer.service.us@festo.com)



**4 Regional Service Center**  
7777 Columbia Road  
Mason, OH 45040

Connect with us



[www.festo.com/socialmedia](http://www.festo.com/socialmedia)



[www.festo.com](http://www.festo.com)

Subject to change