

Parallel grippers HGPC



-  - Type discontinued  
Available up until 2018

## Parallel grippers HGPC

Key features

FESTO

### At a glance

#### General

The compact and low-cost parallel gripper consists of a two-part symmetrical housing. The piston moves traverse to the half-shell casing in an optimum housing design that

guarantees reliable operation, long service life and convenient sensing. The gripper jaws move along the half shells in backlash-free, preloaded ball bearing guides.

- Double-acting gripper
- Compression spring for supplementary or retaining gripping forces
- Internal fixed flow control, does away with the need for external flow control in 80% of applications
- High force with minimal volume

- Suitable for external and internal gripping
- Wide range of options for attaching drive units
- Repetition accuracy of 0.05 mm
- Slot for proximity sensor  
SME/SMT-10

-  - Note

Sizing software  
Gripper selection  
→ [www.festo.com](http://www.festo.com)

### Details

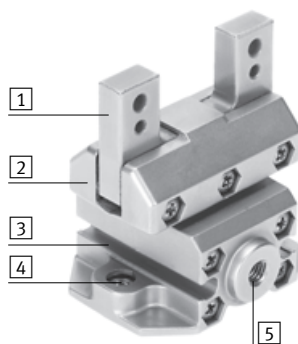

- 1 Gripper jaw with ball bearing guide
- 2 Housing based on half-shell principle
- 3 Slot for proximity sensor, for sensing the piston position
- 4 Mounting option
- 5 Supply port

### Mounting option from underneath

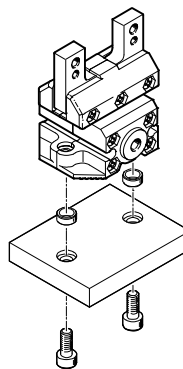

### from above

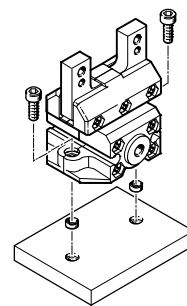

-  - Note

Parallel grippers are not designed for the following applications:

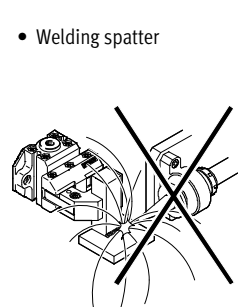
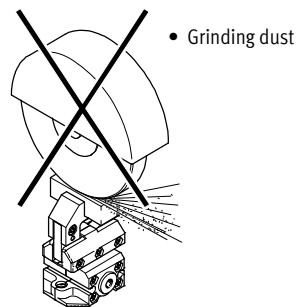
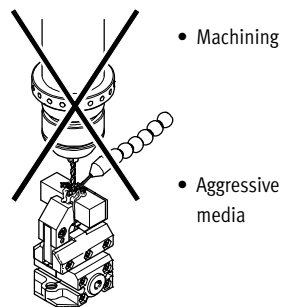

## Parallel grippers HGPC

Peripherals overview and type codes

### Peripherals overview

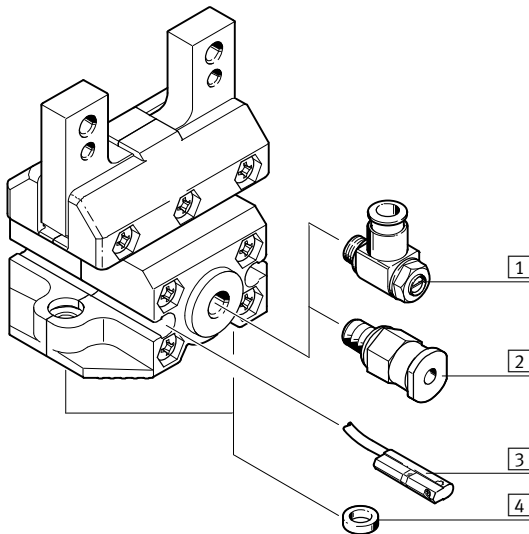

### System product for handling and assembly technology

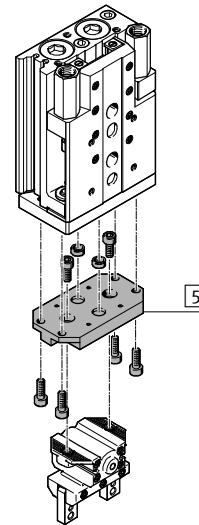

Accessories			
Type	Description	→ Page/Internet	
1 One-way flow control valve GRLA	For regulating speed	grla	
2 Push-in fitting QS	For connecting compressed air tubing with standard O.D.	qs	
3 Proximity sensor SME/SMT-10	For sensing the piston position	13	
4 Centring sleeve ZBH	For centring when attaching to a drive (2 included in the scope of delivery)	13	
5 Adapter kit HMSV, HAPG	Drive/gripper connections	12	

### Type codes

HGPC		–	12	–	A	–	G2
<b>Type</b>							
HGPC	Parallel gripper						
<b>Size</b>							
<b>Position sensing</b>							
A	Via proximity sensor						
<b>Gripping force backup</b>							
G2	Closing						

- 1 - Type discontinued  
Available up until 2018

## Parallel grippers HGPC

Technical data

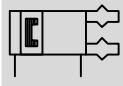

FESTO

Function  
Double-acting  
HGPC-...-A



Single-acting or  
with gripping force retention  
closing HGPC-...-G2



 Size  
12, 16, 20 mm  
 Stroke  
6 ... 14 mm



General technical data				
Size	12	16	20	
Constructional design	Wedge-shaped drive Guided motion sequence			
Mode of operation	Double-acting			
Gripper function	Parallel			
Number of gripper jaws	2			
Max. load per external gripper finger <sup>1)</sup>	[g]	20	50	80
Stroke per gripper jaw	[mm]	3	5	7
Pneumatic connection	M5			
Repetition accuracy <sup>2)</sup>	[mm]	≤ 0.05		
Max. interchangeability	[mm]	≤ 0.2		
Max. gripper jaw backlash <sup>3)</sup>	[mm]	0		
Max. gripper jaw angular backlash <sup>4)</sup>	[°]	0		
Max. operating frequency	[Hz]	4		
Rotational symmetry	[mm]	< Ø 0.2		
Position sensing	For proximity sensing			
Type of mounting	With female thread and centring sleeve			
Mounting position	Any			

- 1) Valid for unthrottled operation
- 2) End-position drift under constant conditions of use with 100 consecutive strokes in the direction of movement of the gripper jaws
- 3) Perpendicular to the direction of motion of the gripper jaws
- 4) Pretensioned, backlash-free ball bearing guide

Operating and environmental conditions			
Min. operating pressure	HGPC-...-A	[bar]	2
	HGPC-...-G2	[bar]	4
Max. operating pressure		[bar]	8
Operating medium	Compressed air in accordance with ISO 8573-1:2010 [7:4:4]		
Note on operating/pilot medium	Operation with lubricated medium possible (in which case lubricated operation will always be required)		
Ambient temperature <sup>1)</sup>		[°C]	+5 ... +60
Corrosion resistance class CRC <sup>2)</sup>			2

- 1) Note operating range of proximity sensors
- 2) Corrosion resistance class 2 according to Festo standard 940 070  
Components requiring moderate corrosion resistance. Externally visible parts with primarily decorative surface requirements which are in direct contact with a normal industrial environment or media such as coolants or lubricating agents

Weights [g]			
Size	12	16	20
HGPC-...-A	152	241	473
HGPC-...-G2	154	244	477

## Parallel grippers HGPC

Technical data

### Materials

Sectional view

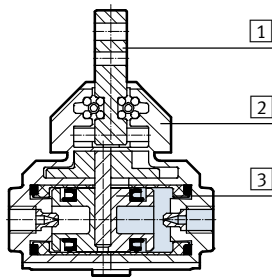

Parallel gripper		
1	Gripper jaw	High-alloy steel
2	Housing	Die-cast zinc
3	Piston	Polyamide
-	Seals	Polyurethane, nitrile rubber
-	Note on materials	Copper and PTFE-free Conforms to RoHS

### Gripping force [N] at 6 bar

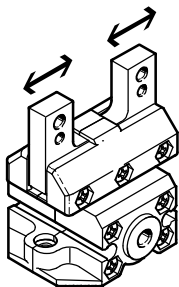

Size	12	16	20
Gripping force per gripper jaw			
Opening	22	41.5	63
Closing	22	41.5	63
Total gripping force			
Opening	44	83	126
Closing	44	83	126

### Static characteristic load values at the gripper jaws

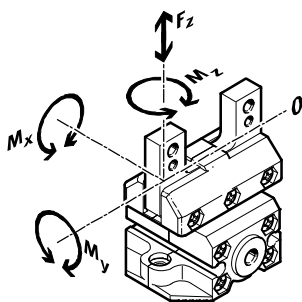

Indicated permissible forces and torques apply to a single gripper jaw. The indicated values include the lever arm, additional applied loads caused by the workpiece or external gripper fingers, as well as forces which occur

during movement. The zero coordinate line (gripper finger guide) must be taken into consideration for the calculation of torques.

Size	12	16	20	
Max. permissible force $F_z$	[N]	40	80	120
Max. permissible torque $M_x$	[Nm]	1	2,5	5
Max. permissible torque $M_y$	[Nm]	1	2,5	5
Max. permissible torque $M_z$	[Nm]	1	2,5	5

- 1 - Type discontinued  
Available up until 2018

## Parallel grippers HGPC

Technical data

FESTO

### Mass moment of inertia [kgm<sup>2</sup>x10<sup>-4</sup>]

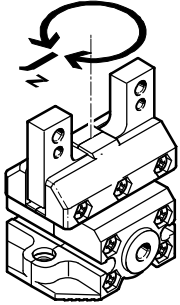

Mass moment of inertia [kgm<sup>2</sup>x10<sup>-4</sup>] of the parallel gripper in relation to the central axis with no load.

Size	12	16	20
HGPC-...-A	0.272	0.679	2.095
HGPC-...-G2	0.274	0.683	2.105

### Opening and closing times [ms] at 6 bar

without external gripper fingers

with external gripper fingers

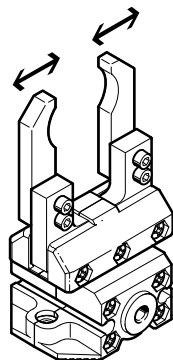
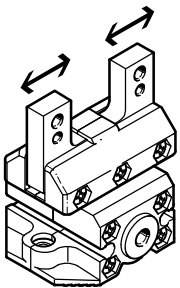

The indicated opening and closing times [ms] have been measured at room temperature and at 6 bar operating pressure with horizontally mounted gripper without additional

gripper fingers. The grippers must be throttled for greater loads [g]. Opening and closing times must then be adjusted correspondingly.

Size		12	16	20
without external gripper fingers				
HGPC-...-A	Opening	30	60	90
	Closing	30	60	90
HGPC-...-G2	Opening	30	70	105
	Closing	30	50	75
with external gripper fingers (as a function of the load per gripper finger)				
HGPC-...	40 g	40	-	-
	50 g	60	-	-
	60 g	80	-	-
	70 g	-	80	-
	100 g	-	100	-
	120 g	-	-	100

## Parallel grippers HGPC

Technical data

### Gripping force $F_{Grip}$ per gripper jaw as a function of operating pressure and lever arm $x$

Gripping forces as a function of the operating pressure and the lever arm can be determined for the size using the following graph.

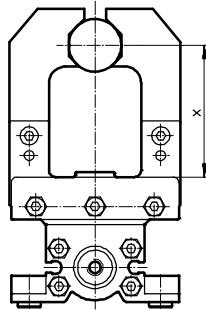

HGPC-12-A

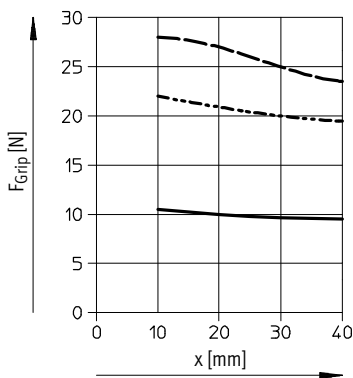

HGPC-16-A

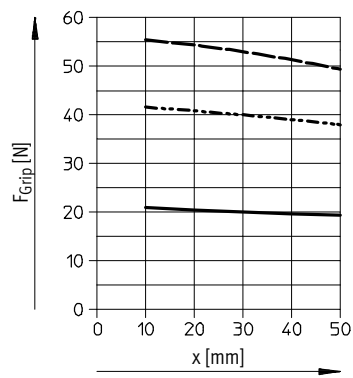

HGPC-20-A

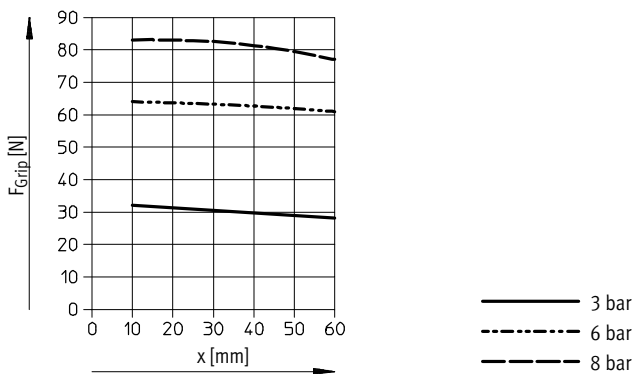

## Parallel grippers HGPC

Technical data

FESTO

### Spring force $F_S$ as a function of the gripper size and the overall stroke $l$

Gripping force retention for HGPC-...-G2

Spring forces  $F_S$  as a function of the gripper size and the overall stroke  $l$  for various gripper types (HGPC-...-G2) can be determined using the following graphs.

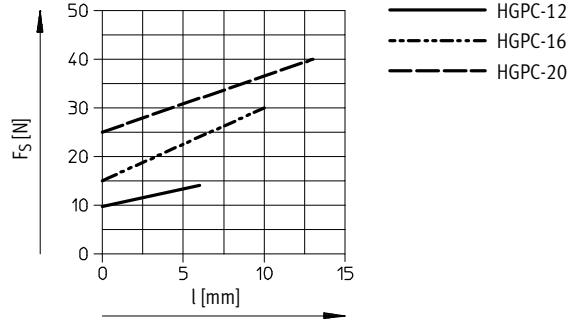
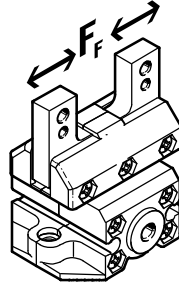

The lever arm  $x$  must be taken into consideration when determining the actual spring force  $F_{Stotal}$ . The formulae for calculating the spring force are provided in the table opposite.

Size	$F_{Stotal} =$
12	$-0.02 * x + 0.5 * F_S$
16	$-0.05 * x + 0.5 * F_S$
20	$-0.05 * x + 0.5 * F_S$

### Determination of the actual gripping forces $F_{Gr}$ for HGPC-...-G2 depending on the application

Parallel grippers with integrated spring type HGPC-...-G2 (closing gripping force retention) can be used as:

- single-acting grippers

- grippers with supplementary gripping force
- grippers with gripping force retention

In order to calculate available gripping forces  $F_{Gr}$  (per gripper jaw), the gripping force ( $F_{Grip}$ ) and spring

force ( $F_{Stotal}$ ) must be combined accordingly.

#### Application

Single-acting

Supplementary gripping force

Gripping force retention

- Gripping with spring force:

$$F_{Gr} = F_{Stotal}$$

- Gripping with pressure and spring force:

$$F_{Gr} = F_{Grip} + F_{Stotal}$$

- Gripping with spring force:

$$F_{Gr} = F_{Stotal}$$

- Gripping with pressure force:

$$F_{Gr} = F_{Grip} - F_{Stotal}$$



## Parallel grippers HGPC

Technical data

### Gripping force $F_{Grip}$ per gripper jaw at 6 bar as a function of lever arm $x$ and eccentricity $y$

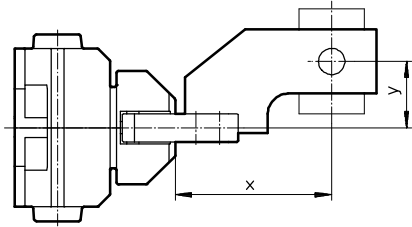

Gripping forces at 6 bar dependent upon eccentric application of force and the maximum permissible off-centre point of force application can be determined for the size using the following graph.

#### Calculation example

Given:

Lever arm  $x = 20$  mm

Eccentricity  $y = 22$  mm

To be found:

Gripping force at 6 bar

Procedure:

- Determine the intersection  $xy$  between lever arm  $x$  and eccentricity  $y$  in the graph for HGPC-12-A...
- Draw an arc (with centre at origin) through intersection  $xy$ .
- Determine the intersection between the arc and the X axis.
- Read the gripping force.

Result:

Gripping force  $F =$  approx. 20.5 N

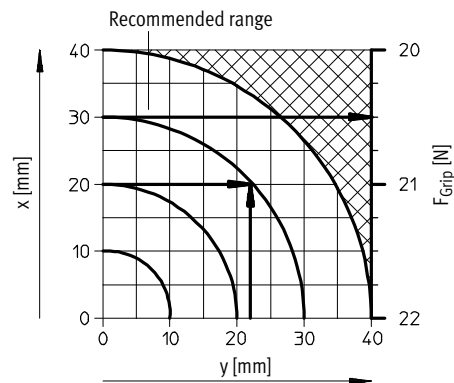

#### HGPC-12-A

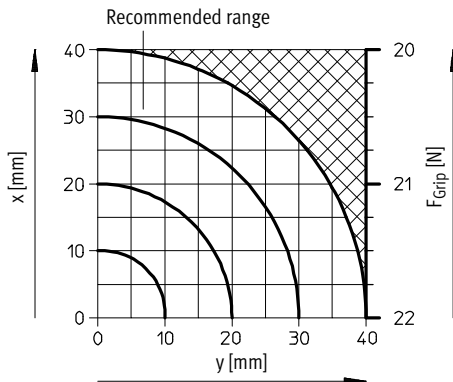

#### HGPC-16-A

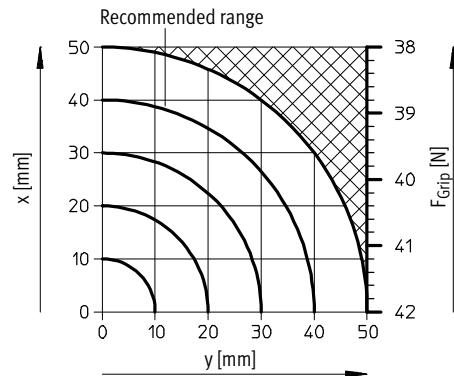

#### HGPC-20-A

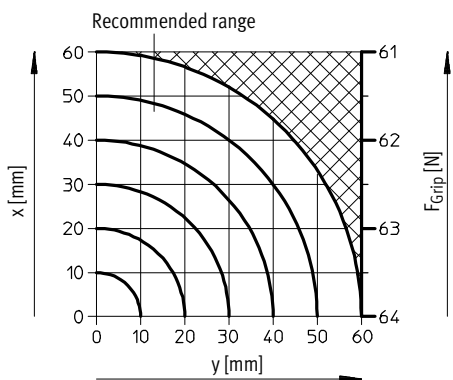

- 1 - Type discontinued  
Available up until 2018

## Parallel grippers HGPC

Technical data

FESTO

### Dimensions

Download CAD data → [www.festo.com](http://www.festo.com)

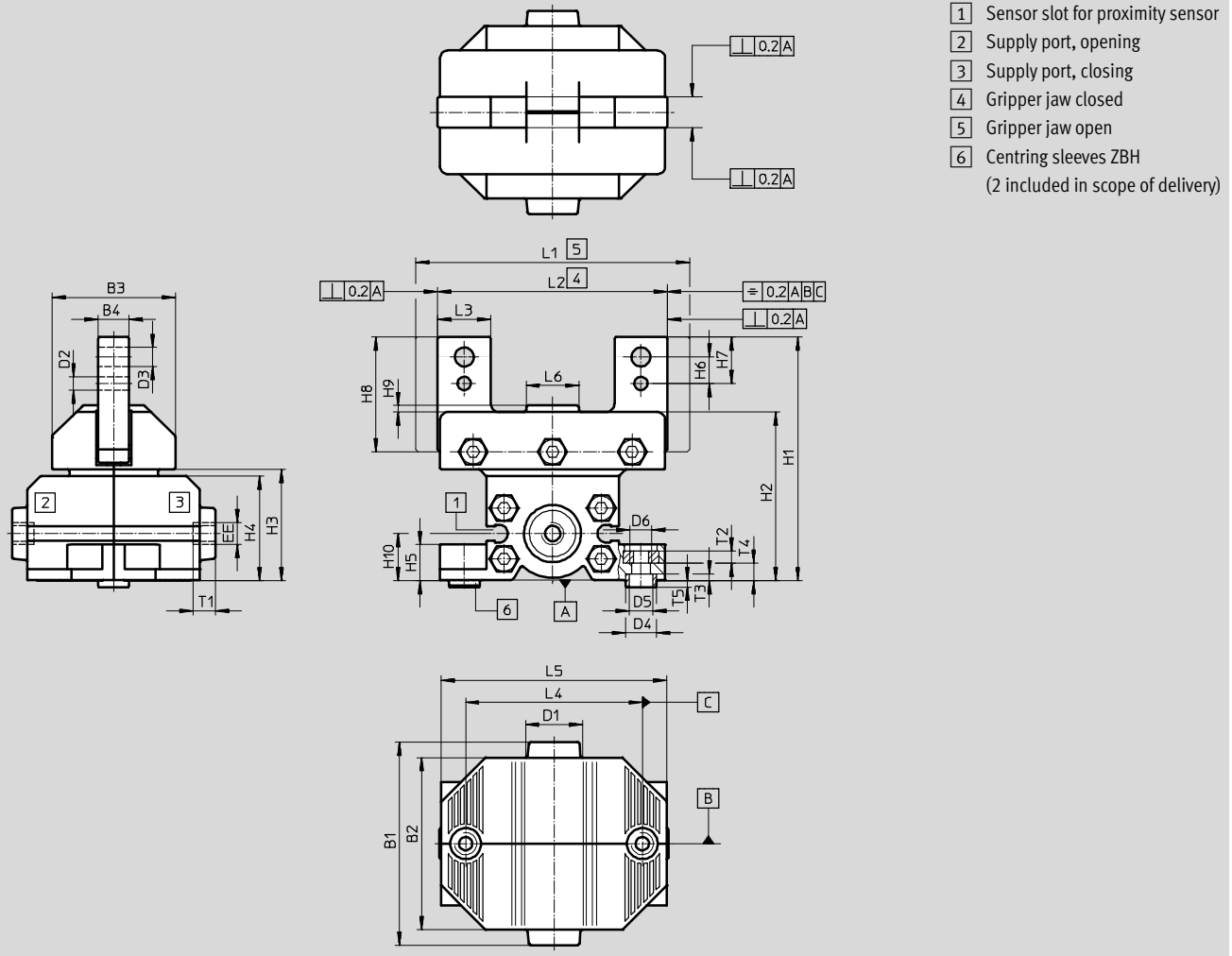

Size	B1	B2	B3	B4	D1	D2	D3	D4	D5	D6
[mm]				±0.1			±0.1	∅ F10/h7	∅	
12	38	33	22.4	6	12	2.5 <sup>+0.04/+0.01</sup>	3.3	7	5.3	M4
16	46	39	28	7	12	3 <sup>H8</sup>	4.3	7	5.3	M5
20	57	50	35	8	12	4 <sup>H8</sup>	5.3	9	6.4	M6

Size	EE	H1	H2	H3	H4	H5	H6	H7	H8	H9	H10
[mm]		±0.5							-0.2		
12	M5	48.2	33.6	21.7	20.2	6.9	5 <sup>+0.05/-0.1</sup>	9 <sup>+0.05/-0.1</sup>	25	1.2	9.2
16	M5	55.2	38.2	25.2	23.7	8.2	6±0.1	10.5±0.4	28.5	1.5	10.7
20	M5	68.7	48.2	32.5	30.5	10.2	7.5±0.1	13±0.4	34.5	1.5	13.7

Size	L1	L2	L3	L4 <sup>1)</sup>	L5	L6	T1	T2	T3	T4	T5
[mm]	±0.5	±0.5					min.		±0.1	+0.4 -0.3	+0.1 -0.3
12	45	39	10 <sup>-0.02/-0.06</sup>	33	42	10	4.5	2.2	1.7	3.1	1.3
16	62	52	12 <sup>-0.05</sup>	40	51	12	4.5	2.7	1.8	3.8	1.2
20	77	63	14 <sup>-0.05</sup>	50	65	16	4.5	3.2	2.3	5.2	1.7

1) Tolerance for centring hole ±0.03  
Tolerance for thread ±0.1

- 1 - Type discontinued  
Available up until 2018

FESTO

## Parallel grippers HGPC

Technical data

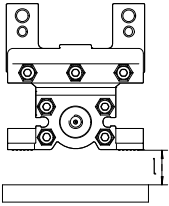

Minimum distance l between gripper and ferritic object				
		12	16	20
Distance	[mm]	10		

Ordering data					
	Size [mm]	Double-acting Without compression spring		Single-acting or with gripping force retention Closing	
		Part No.	Type	Part No.	Type
	12	539 267	HGPC-12-A	539 268	HGPC-12-A-G2
	16	539 269	HGPC-16-A	539 270	HGPC-16-A-G2
	20	539 271	HGPC-20-A	539 272	HGPC-20-A-G2

**- 1 - Type discontinued**  
**Available up until 2018**

## Parallel grippers HGPC

Accessories

FESTO

**Adapter kit**  
**HAPG**

Material:  
 Wrought aluminium alloy  
 Free of copper and PTFE  
 RoHS-compliant



Note

The kit includes the individual mounting interface as well as the necessary mounting material.

Permissible drive/gripper combinations with adapter kit						Download CAD data → <a href="http://www.festo.com">www.festo.com</a>	
Combination	Drive	Gripper	Mounting option		Adapter kit		
			Size	Size	CRC <sup>1)</sup>	Part No.	Type
	DGSL	HGPC			HAPG		
	12, 16	12	■	■	2	529018	HAPG-58
	20, 25	16	■	■		191267	HAPG-49
	20, 25	20	■	■		191269	HAPG-51
	SLT	HGPC			HAPG		
	10	12	■	–	2	542670	HAPG-100
	16	12	■	–		529018	HAPG-58
	16	16	■	–		542666	HAPG-101
	20	16	■	–		191267	HAPG-49
	20	20	■	–		542667	HAPG-102
	25	20	■	–		191269	HAPG-51
	HSP	HGPC				HAPG	
	16	16	■	–	2	191901	HAPG-55
	25	20	■	–		540882	HAPG-71-B
						191901	HAPG-55
540883						HAPG-72-B	
	HSW	HGPC			HAPG		
	12, 16	16	■	–	2	191901	HAPG-55
			■	–		540882	HAPG-71-B
	ERMB	HGPC			HAPG		
	20	16	■	■	2	542668	HAPG-SD2-42
	20	20	■	■		542669	HAPG-SD2-43
	25	20	■	■		542758	HAPG-SD2-44

1) Corrosion resistance class 2 according to Festo standard 940 070

Components subject to moderate corrosion stress. Externally visible parts with primarily decorative surface requirements which are in direct contact with a normal industrial environment or media such as coolants or lubricating agents.

- 2 - Type discontinued  
Available up until 2018

FESTO

## Parallel grippers HGPC



Accessories

Ordering data – Centring sleeves				Technical data → Internet: zbh	
	For size [mm]	Weight [g]	Part No.	Type	PU <sup>1)</sup>
	12, 16	1	186717	ZBH-7	10
	20	1	150927	ZBH-9	10

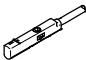
1) Packaging unit

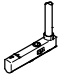
Ordering data – Proximity sensors for C-slot					
	Type of mounting	Electrical connection, connection direction	Switching output	Cable length [m]	Part No. Type
	N/O contact, magneto-resistive <span style="float: right;">Technical data → Internet: smt</span>				
	Insertable in the slot from above	Cable, 3-wire, in-line	PNP	2.5	551373 SMT-10M-PS-24V-E-2,5-L-OE
		Plug M8x1, 3-pin, in-line		0.3	551375 SMT-10M-PS-24V-E-0,3-L-M8D
	N/O contact, magnetic reed <span style="float: right;">Technical data → Internet: sme</span>				
Insertable in the slot lengthwise	Cable, 3-wire, in-line	Contacting	2.5	173210 SME-10-KL-LED-24	
	Plug M8x1, 3-pin, in-line		0.3	173212 SME-10-SL-LED-24	

Ordering data – Proximity sensors for C-slot					
	Type of mounting	Electrical connection, connection direction	Switching output	Cable length [m]	Part No. Type
	N/O contact, magneto-resistive <span style="float: right;">Technical data → Internet: smt</span>				
	Insertable in the slot from above	Cable, 3-wire, lateral	PNP	2.5	551374 SMT-10M-PS-24V-E-2,5-Q-OE
		Plug M8x1, 3-pin, lateral		0.3	551376 SMT-10M-PS-24V-E-0,3-Q-M8D
	N/O contact, magnetic reed <span style="float: right;">Technical data → Internet: sme</span>				
Insertable in the slot lengthwise	Cable, 3-wire, lateral	Contacting	2.5	173211 SME-10-KQ-LED-24	
	Plug M8x1, 3-pin, lateral		0.3	173213 SME-10-SQ-LED-24	

Ordering data – Connecting cables					Technical data → Internet: nebu
	Electrical connection, left	Electrical connection, right	Cable length [m]	Part No.	Type
	Straight socket, M8x1, 3-pin	Cable, open end, 3-wire	2.5	541333	NEBU-M8G3-K-2.5-LE3
			5	541334	NEBU-M8G3-K-5-LE3
	Angled socket, M8x1, 3-pin	Cable, open end, 3-wire	2.5	541338	NEBU-M8W3-K-2.5-LE3
			5	541341	NEBU-M8W3-K-5-LE3

# Festo - Your Partner in Automation



**1 Festo Inc.**  
5300 Explorer Drive  
Mississauga, ON L4W 5G4  
Canada

**Festo Customer Interaction Center**  
Tel: 1 877 463 3786  
Fax: 1 877 393 3786  
Email: [customer.service.ca@festo.com](mailto:customer.service.ca@festo.com)



**2 Festo Pneumatic**  
Av. Ceylán 3,  
Col. Tequesquináhuac  
54020 Tlalnepantla,  
Estado de México

**Multinational Contact Center**  
01 800 337 8669  
[ventas.mexico@festo.com](mailto:ventas.mexico@festo.com)



**3 Festo Corporation**  
1377 Motor Parkway  
Suite 310  
Islandia, NY 11749

**Festo Customer Interaction Center**  
1 800 993 3786  
1 800 963 3786  
[customer.service.us@festo.com](mailto:customer.service.us@festo.com)



**4 Regional Service Center**  
7777 Columbia Road  
Mason, OH 45040

Connect with us



[www.festo.com/socialmedia](http://www.festo.com/socialmedia)



[www.festo.com](http://www.festo.com)

Subject to change