



## **Coalescing Filter LFMA – Basic Version**



# Coalescing Microfilter, Type LFMA

1/8" to 1" NPT, G 1/8 to G 1 ISO, INCH and Metric Series

## Coalescing Microfilter

0.01 micron average pore size

with Metal Bowl Guard  
with manual bowl drain

Type LFMA-...-D-...(-NPT)

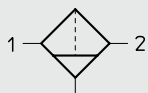

with integrated, automatic bowl drain

Type LFMA-...-D-...-A(-NPT)

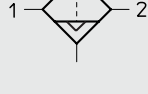

### Accessories:

Mounting brackets, Type HFOE-...  
(see page 67)

Replacement filter cartridge,  
Type LFMAP-D-... (see page 67)

Threaded bolt set, Type FRB-... used to  
combine the Microfilter with another D-Series  
unit (see page 66).

Type LFMA-...-D-...(-NPT)  
LFMA-...-D-...-A(-NPT)

Various branches of industry often require finely or very finely filtered air: chemical, pharmaceutical, process engineering, food processing, etc. In addition, finely and very finely filtered air is also required for low pressure controls.

Festo fine filters and microfilters remove almost all of even the smallest water and oil droplets as well as dirt particles from the compressed air. In this way, the compressed air is filtered to at least 99.999% (99.9999% when a microfilter is used).

To prevent the oil-water emulsion which collects in the foam jacket from being recombined with the compressed air, the flow rate recommended for the units should be observed.

When fine filters and microfilters are used, the compressed air should be pre-filtered (5 micron) to increase the service life of the borosilicate filter cartridge.



Order Number Part No. / Type	Microfilter 0.01 micron Manual bowl drain	NPT	With Threaded Connection Plate						173736	173738										
			173724 LFMA-1/8-D- MINI-NPT	173726 LFMA-1/4-D- MINI-NPT	173728 LFMA-3/8-D- MINI-NPT	173730 LFMA-3/8-D- MIDI-NPT	173732 LFMA-1/2-D- MIDI-NPT	173734 LFMA-3/4-D- MIDI-NPT												
		ISO	162642 LFMA-1/8-D- MINI	162643 LFMA-1/4-D- MINI	162644 LFMA-3/8-D- MINI	162645 LFMA-3/8-D- MIDI	162646 LFMA-1/2-D- MIDI	162647 LFMA-3/4-D- MIDI	162648 LFMA-3/4-D- MAXI	162649 LFMA-1-D- MAXI										
	Microfilter 0.01 micron Automatic bowl drain	NPT	173723 LFMA-1/8-D- MINI-A-NPT	173727 LFMA-1/4-D- MINI-A-NPT	173729 LFMA-3/8-D- MINI-A-NPT	173731 LFMA-3/8-D- MIDI-A-NPT	173733 LFMA-1/2-D- MIDI-A-NPT	173735 LFMA-3/4-D- MIDI-A-NPT	173737 LFMA-3/4-D- MAXI-A-NPT	173739 LFMA-1-D- MAXI-A-NPT										
		ISO	162650 LFMA-1/8-D- MINI-A	162651 LFMA-1/4-D- MINI-A	162652 LFMA-3/8-D- MINI-A	162653 LFMA-3/8-D- MIDI-A	162654 LFMA-1/2-D- MIDI-A	162655 LFMA-3/4-D- MIDI-A	162656 LFMA-3/4-D- MAXI-A	162657 LFMA-1-D- MAXI-A										
Medium	Prefiltered, compressed air																			
Design	Filter with Borosilicate filter material																			
Mounting	In-line assembly or mounting brackets																			
Assembly Position	Vertical ± 5°																			
Connection	1/8 NPT / G 1/8 ISO		1/4 NPT / G 1/4 ISO		3/8 NPT / G 3/8 ISO		3/8 NPT / G 3/8 ISO		1/2 NPT / G 1/2 ISO		3/4 NPT / G 3/4 ISO		1 NPT / G 1 ISO							
Nominal Flow*	4.59 scfm / 130 l/min		6.65 scfm / 160 l/min		6.36 scfm / 180 l/min		13.42 scfm / 380 l/min		14.12 scfm / 400 l/min		16.24 scfm / 460 l/min		31.78 scfm / 900 l/min		33.54 scfm / 950 l/min					
Filter Pore Size	micron		0.01																	
Residual Oil Concentration	[mg/m <sup>3</sup> ]		≤0.01																	
Filter Efficiency	[%]		99.9999																	
Air Purity Class per ISO 8573-1	Particle		1																	
	Oil Aerosol		2																	
Condensate Capacity	13 cu in / 22 ml					26 cu in / 43 ml					49 cu in / 80 ml									
Primary Pressure Range	Manual Bowl Drain		232 psi / max. 16 bar																	
	Automatic Bowl Drain**		22 to 180 psi / 1.5 to 12 bar																	
Temperature Range	Medium		35 to 140°F / +1.5 to +60°C																	
	Ambient		14 to 140°F / -10 to +60°C																	
Material	Housing: GD-Zn; Seals: NBR; Filter bowl: Polycarbonate; Metal bowl guard: Al																			
Weight	0.551 lb / 0.250 kg					1.433 lb / 0.650 kg					2.425 lb / 1.100 kg					2.646 lb / 1.200 kg				

Delivery: Short lead time

\* At upstream pressure of 90 psi / 6 bar and Δ p = 1.05 psi / 0.07 bar.

\*\* A minimum flow of 4 scfm / 125 l/min is required for the proper result.

# Coalescing Fine Filter, Type LFMB

1/8" to 1" NPT, G 1/8 to G 1 ISO, INCH and Metric Series

## Coalescing Fine Filter

1 micron

with Metal Bowl Guard  
with manual bowl drain

Type LFMB-...-D-...(-NPT)

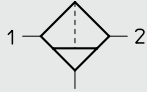

with integrated, automatic bowl drain

Type LFMB-...-D-...-A(-NPT)

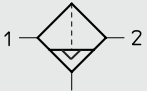

### Accessories:

Mounting brackets, Type HFOE-...  
(see page 67)

Replacement filter cartridge,  
Type LFMBP-D-... (see page 67)

Threaded bolt set, Type FRB-... used to  
combine the Fine Filter with another D-Series  
unit (see page 66).

Type LFMB-...-D-...(-NPT)  
LFMB-...-D-...-A(-NPT)

Various branches of industry often require finely or very finely filtered air: chemical, pharmaceutical, process engineering, food processing, etc. In addition, finely and very finely filtered air is also required for low pressure controls.

Festo fine filters and microfilters remove almost all of even the smallest water and oil droplets as well as dirt particles from the compressed air. In this way, the compressed air is filtered to at least 99.999% (99.9999% when a microfilter is used).

To prevent the oil-water emulsion which collects in the foam jacket from being recombined with the compressed air, the flow rate recommended for the units should be observed.

When fine filters and microfilters are used, the compressed air should be pre-filtered (5 micron) to increase the service life of the borosilicate filter cartridge.



Order Number Part No. / Type	Microfilter 1 micron Manual bowl drain	NPT	With Threaded Connection Plate							
			173708 LFMB-1/8-D- MINI-NPT	173710 LFMB-1/4-D- MINI-NPT	173712 LFMB-3/8-D- MINI-NPT	173714 LFMB-3/8-D- MIDI-NPT	173716 LFMB-1/2-D- MIDI-NPT	173718 LFMB-3/4-D- MIDI-NPT	173720 LFMB-3/4-D- MAXI-NPT	173722 LFMB-1-D- MAXI-NPT
		ISO	162626 LFMB-1/8-D- MINI	162627 LFMB-1/4-D- MINI	162628 LFMB-3/8-D- MINI	162629 LFMB-3/8-D- MIDI	162630 LFMB-1/2-D- MIDI	162631 LFMB-3/4-D- MIDI	162632 LFMB-3/4-D- MAXI	162633 LFMB-1-D- MAXI
	Microfilter 1 micron Automatic bowl drain	NPT	173709 LFMB-1/8-D- MINI-A-NPT	173711 LFMB-1/4-D- MINI-A-NPT	173713 LFMB-3/8-D- MINI-A-NPT	173715 LFMB-3/8-D- MIDI-A-NPT	173717 LFMB-1/2-D- MIDI-A-NPT	173719 LFMB-3/4-D- MIDI-A-NPT	173721 LFMB-3/4-D- MAXI-A-NPT	173723 LFMB-1-D- MAXI-A-NPT
		ISO	162634 LFMB-1/8-D- MINI-A	162635 LFMB-1/4-D- MINI-A	162636 LFMB-3/8-D- MINI-A	162637 LFMB-3/8-D- MIDI-A	162638 LFMB-1/2-D- MIDI-A	162639 LFMB-3/4-D- MIDI-A	162640 LFMB-3/4-D- MAXI-A	162641 LFMB-1-D- MAXI-A
Medium	Prefiltered, compressed air									
Design	Filter with Borosilicate filter material									
Mounting	In-line assembly or mounting brackets									
Assembly Position	Vertical ± 5°									
Connection			1/8 NPT / G 1/8 ISO	1/4 NPT / G 1/4 ISO	3/8 NPT / G 3/8 ISO	3/8 NPT / G 3/8 ISO	1/2 NPT / G 1/2 ISO	3/4 NPT / G 3/4 ISO	3/4 NPT / G 3/4 ISO	1 NPT / G 1 ISO
Nominal Flow*			8.83 scfm / 250 l/min	10.59 scfm / 300 l/min	10.95 scfm / 310 l/min	24.72 scfm / 700 l/min	31.78 scfm / 900 l/min	35.31 scfm / 1000 l/min	42.39 scfm / 1200 l/min	44.14 scfm / 1250 l/min
Filter Pore Size	micron	1								
Residual Oil Concentration	[mg/m <sup>3</sup> ]	≤0.05								
Filter Efficiency	[%]	99.99								
Air Purity Class per ISO 8573-1	Particle	2								
	Oil Aerosol	3								
Condensate Capacity			13 cu in / 22 ml			26 cu in / 43 ml		49 cu in / 80 ml		
Primary Pressure Range	Manual Bowl Drain	232 psi / max. 16 bar								
	Automatic Bowl Drain**	22 to 180 psi / 1.5 to 12 bar								
Temperature Range	Medium	35 to 140°F / +1.5 to +60°C								
	Ambient	14 to 140°F / -10 to +60°C								
Material	Housing: GD-Zn; Seals: NBR; Filter bowl: Polycarbonate; Metal bowl guard: Al									
Weight			0.551 lb / 0.250 kg		1.433 lb / 0.650 kg		2.425 lb / 1.100 kg		2.646 lb / 1.200 kg	

Delivery: Short lead time

\* At upstream pressure of 90 psi / 6 bar and Δ p = 1.05 psi / 0.07 bar.

\*\* A minimum flow of 4 scfm / 125 l/min is required for the proper result.

# Micro and Fine Filters, Types LFMA, LFMB

## Dimensions, INCH and Metric Series

Type LFMA-...-D-...  
LFMB-...-D-...

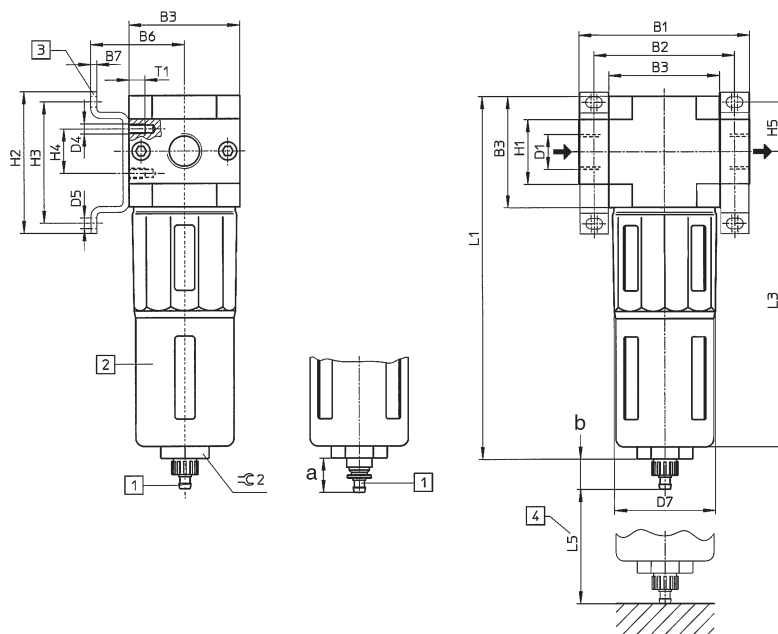

- 1 Drain connector for plastic tubing (Order number 7134 PCN-4)
  - 2 Metal bowl guard
  - 3 Mounting brackets Type HFOE (order separately)
  - 4 Clearance required to remove bowl for servicing
- ➔ Flow direction

### Dimensions

- a 0.59 in / 15 mm
- b 0.67 in / 17 mm

Type Inch and Metric Series	B1 in / mm	B2 in / mm	B3 in / mm	B6 in / mm	B7 in / mm	D1 Inch / Metric	D4	D5 dia in / mm	D7 dia in / mm	
LFMA/B-1/8-D-MINI(A)	2.52 / 64	2.05 / 52	1.57 / 40	1.54 / 39	0.08 / 2	1/8 NPT / G 1/8 ISO	M4	0.17 / 4.3	1.50 / 38	
LFMA/B-1/4-D-MINI(A)	2.52 / 64	2.05 / 52	1.57 / 40	1.54 / 39	0.08 / 2	1/4 NPT / G 1/4 ISO	M4	0.17 / 4.3	1.50 / 38	
LFMA/B-3/8-D-MINI(A)	3.35 / 85	2.76 / 70	2.17 / 55	1.54 / 39	0.12 / 3	3/8 NPT / G 3/8 ISO	M5	0.21 / 5.3	1.50 / 38	
LFMA/B-3/8-D-MIDI(A)	3.35 / 85	2.76 / 70	2.17 / 55	1.85 / 47	0.12 / 3	3/8 NPT / G 3/8 ISO	M5	0.21 / 5.3	2.05 / 52	
LFMA/B-1/2-D-MIDI(A)	3.35 / 85	2.76 / 70	2.17 / 55	1.85 / 47	0.12 / 3	1/2 NPT / G 1/2 ISO	M5	0.21 / 5.3	2.05 / 52	
LFMA/B-3/4-D-MIDI(A)	3.78 / 96	3.15 / 80	2.60 / 66	1.85 / 47	0.12 / 3	3/4 NPT / G 3/4 ISO	M5	0.21 / 5.3	2.05 / 52	
LFMA/B-3/4-D-MAXI(A)	3.78 / 96	3.15 / 80	2.60 / 66	2.09 / 53	0.12 / 3	3/4 NPT / G 3/4 ISO	M5	0.21 / 5.3	2.56 / 65	
LFMA/B-1-D-MAXI(A)	4.57 / 116	3.58 / 91	2.60 / 66	2.09 / 53	0.12 / 3	1 NPT / G 1 ISO	M5	0.21 / 5.3	2.56 / 65	
Type Inch and Metric Series	H1 in / mm	H2 in / mm	H3 in / mm	H4 in / mm	H5 in / mm	L1 in / mm	L3 in / mm	L5 in / mm	T1	⌀ 2
LFMA/B-1/8-D-MINI(A)	0.79 / 20	1.69 / 43	1.38 / 35	0.43 / 11	0.69 / 17.5	5.67 / 144	4.88 / 124	2.36 / 60	0.28 / 7	22
LFMA/B-1/4-D-MINI(A)	0.79 / 20	1.69 / 43	1.38 / 35	0.43 / 11	0.69 / 17.5	5.67 / 144	4.88 / 124	2.36 / 60	0.28 / 7	22
LFMA/B-3/8-D-MINI(A)	0.79 / 20	1.69 / 43	1.38 / 35	0.43 / 11	0.69 / 17.5	5.67 / 144	4.88 / 124	2.36 / 60	0.28 / 7	22
LFMA/B-3/8-D-MIDI(A)	1.26 / 32	2.76 / 70	2.36 / 60	0.87 / 22	0.96 / 24.5	7.05 / 179	5.94 / 151	3.15 / 80	0.31 / 8	24
LFMA/B-1/2-D-MIDI(A)	1.26 / 32	2.76 / 70	2.36 / 60	0.87 / 22	0.96 / 24.5	7.05 / 179	5.94 / 151	3.15 / 80	0.31 / 8	24
LFMA/B-3/4-D-MIDI(A)	1.26 / 32	2.76 / 70	2.36 / 60	0.87 / 22	0.96 / 24.5	7.05 / 179	6.69 / 170	3.54 / 90	0.31 / 8	24
LFMA/B-3/4-D-MAXI(A)	1.26 / 32	2.76 / 70	2.36 / 60	0.87 / 22	0.96 / 24.5	7.99 / 203	6.69 / 170	3.54 / 90	0.31 / 8	24
LFMA/B-1-D-MAXI(A)	1.57 / 40	2.76 / 70	2.36 / 60	0.87 / 22	0.96 / 24.5	7.99 / 203	6.69 / 170	3.54 / 90	0.31 / 8	24

# Microfilters, Type LFMA

## Servicing Information

For economic considerations, the filter cartridge should be replaced when the pressure difference (pressure drop) of the filter is 6 psi / 0.41 bar. After disconnection of the compressed air supply, the filter bowl should be vented and removed, and the filter cartridge unscrewed from inside the filter housing.

### Pressure drop as a function of input pressure at different normal flow rates for Microfilters (0.01 micron)

Type LFMA-1/8-D-MINI  
LFMA-1/8-D-MINI-A

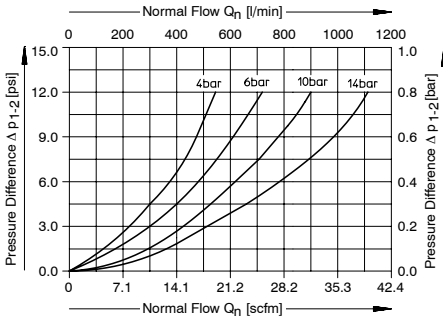

Type LFMA-1/4-D-MINI  
LFMA-1/4-D-MINI-A

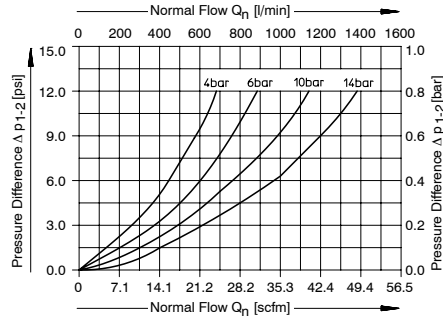

Type LFMA-3/8-D-MINI  
LFMA-3/8-D-MINI-A

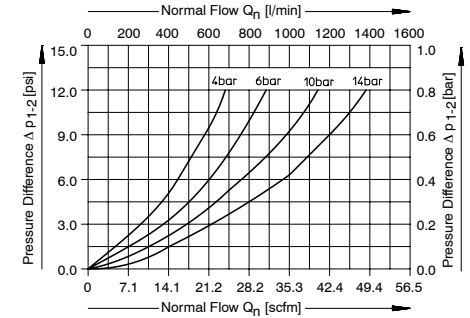

Type LFMA-3/8-D-MIDI  
LFMA-3/8-D-MIDI-A

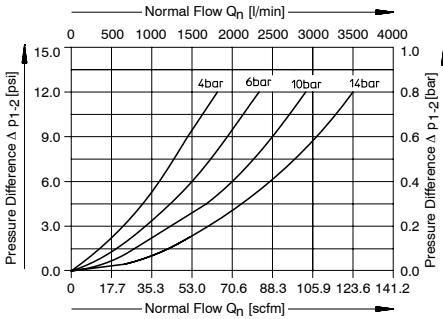

Type LFMA-3/4-D-MIDI  
LFMA-3/4-D-MIDI-A

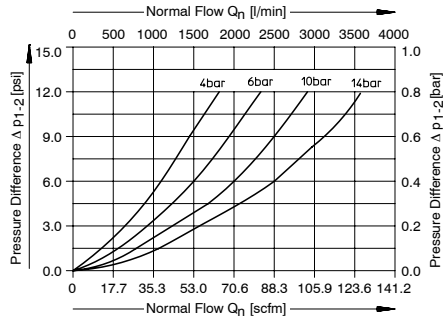

Type LFMA-1/2-D-MIDI  
LFMA-1/2-D-MIDI-A

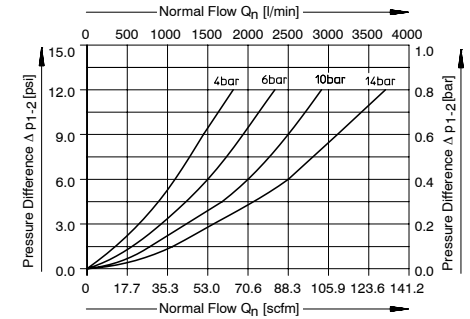

Type LFMA-3/4-D-MAXI  
LFMA-3/4-D-MAXI-A

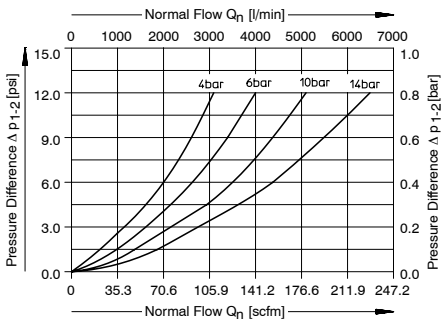

Type LFMA-1-D-MAXI  
LFMA-1-D-MAXI-A

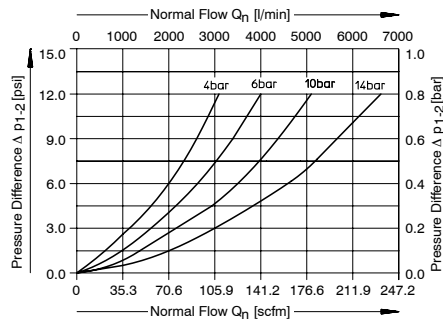

# Fine Filters, Type LFMB

## Servicing Information

For economic considerations, the filter cartridge should be replaced when the pressure difference (pressure drop) of the filter is 6 psi / 0.41 bar. After disconnection of the compressed air supply, the filter bowl should be vented and removed, and the filter cartridge unscrewed from inside the filter housing.

### Pressure drop as a function of input pressure at different normal flow rates for Fine Filters (1 micron)

Type LFMB-1/8-D-MINI  
LFMB-1/8-D-MINI-A

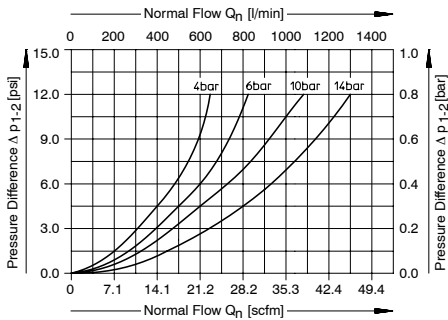

Type LFMB-1/4-D-MINI  
LFMB-1/4-D-MINI-A

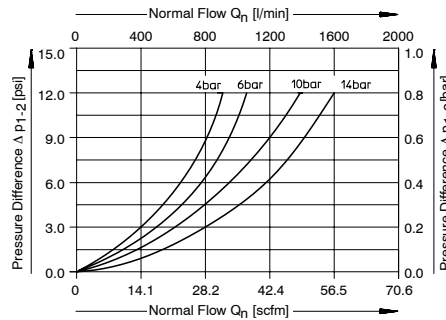

Type LFMB-3/8-D-MINI  
LFMB-3/8-D-MINI-A

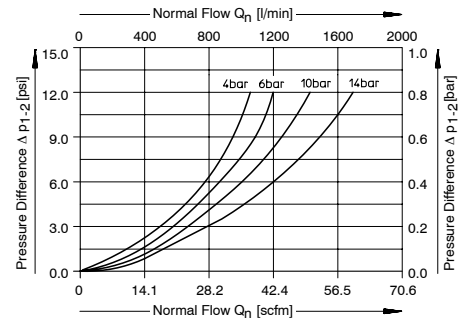

Type LFMB-3/8-D-MIDI  
LFMB-3/8-D-MIDI-A

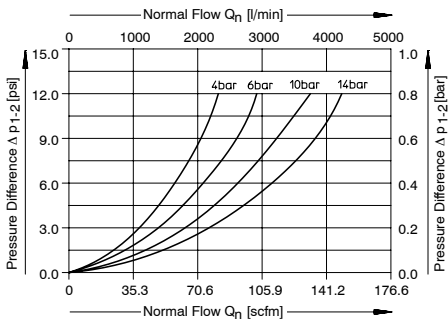

Type LFMB-1/2-D-MIDI  
LFMB-1/2-D-MIDI-A

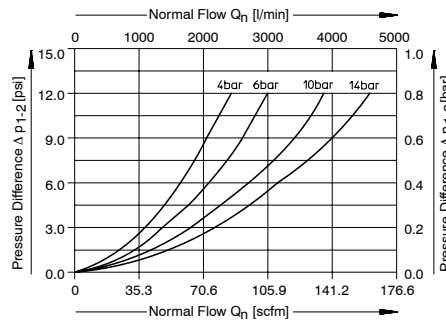

Type LFMB-3/4-D-MIDI  
LFMB-3/4-D-MIDI-A

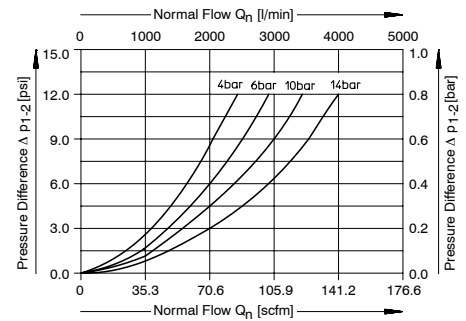

Type LFMB-3/4-D-MAXI  
LFMB-3/4-D-MAXI-A

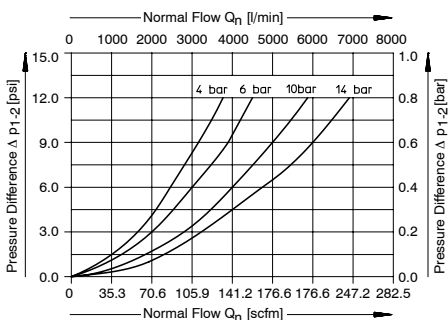

Type LFMB-1-D-MAXI  
LFMB-1-D-MAXI-A

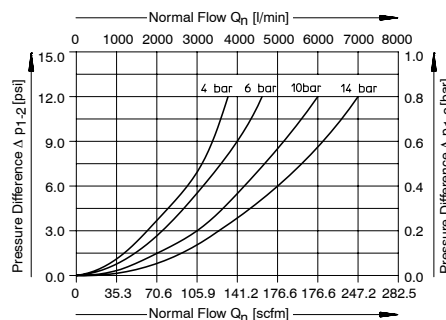

# Filter Combination, Type LFMB

1/8" to 1" NPT, G 1/8 to G 1 ISO, INCH and Metric Series

## Filter Combination

0.01 micron average pore size  
with Metal Bowl Guards  
with manual bowl drains  
Type LFMB-...-D-...(-NPT)



with integrated, automatic bowl drains  
Type LFMB-...-D-...-A(-NPT)

### Accessories:

Mounting brackets, Type HFOE-...  
(see page 67)

Threaded bolt set, Type FRB-... used to  
combine the Filter Combination with  
another D-Series unit (see page 66).

Type LFMB-...-D-...(-NPT)  
LFMB-...-D-...-A(-NPT)



The combination of a fine filter (1 micron) and a microfilter (0.01 micron) provides 2-stage filtration of the compressed air. In this arrangement, the output of the fine filter cannot be used by any other system components.

Order Number Part No. / Type	Filter Combination Manual Bowl Drains	NPT	173740	173742	173744	173746	173748	173750	173752	173754
			LFMBA-1/8-D-MINI-NPT	LFMBA-1/4-D-MINI-NPT	LFMBA-3/8-D-MINI-NPT	LFMBA-3/8-D-MIDI-NPT	LFMBA-1/2-D-MIDI-NPT	LFMBA-3/4-D-MIDI-NPT	LFMBA-3/4-D-MAXI-NPT	LFMBA-1-D-MAXI-NPT
		ISO	162658	162659	162660	162661	162662	162663	162664	162665
			LFMBA-1/8-D-MINI	LFMBA-1/4-D-MINI	LFMBA-3/8-D-MINI	LFMBA-3/8-D-MIDI	LFMBA-1/2-D-MIDI	LFMBA-3/4-D-MIDI	LFMBA-3/4-D-MAXI	LFMBA-1-D-MAXI
	Filter Combination Automatic Bowl Drains	NPT	173741	173743	173745	173747	173749	173751	173753	173755
			LFMBA-1/8-D-MINI-A-NPT	LFMBA-1/4-D-MINI-A-NPT	LFMBA-3/8-D-MINI-A-NPT	LFMBA-3/8-D-MIDI-A-NPT	LFMBA-1/2-D-MIDI-A-NPT	LFMBA-3/4-D-MIDI-A-NPT	LFMBA-3/4-D-MAXI-A-NPT	LFMBA-1-D-MAXI-A-NPT
		ISO	162666	162667	162668	162669	162670	162671	162672	162673
			LFMBA-1/8-D-MINI-A	LFMBA-1/4-D-MINI-A	LFMBA-3/8-D-MINI-A	LFMBA-3/8-D-MIDI-A	LFMBA-1/2-D-MIDI-A	LFMBA-3/4-D-MIDI-A	LFMBA-3/4-D-MAXI-A	LFMBA-1-D-MAXI-A
	Mounting Brackets		159638 HFOE-D-MINI			159593 HFOE-D-MIDI/MAXI				
	Threaded Bolt Set		159642 FRB-D-MINI						159643 FRB-D-MAXI	
	Filter Cartridge 1 micron		162677 LFMBP-D-MINI			162678 LFMBP-D-MIDI			162679 LFMBP-D-MAXI	
	Filter Cartridge 0.01 micron		162674 LFMAP-D-MINI			162675 LFMAP-D-MIDI			162676 LFMAP-D-MAXI	
Medium			Prefiltered, compressed air							
Design			Filter with Borosilicate filter material							
Mounting			In-line assembly or mounting brackets							
Assembly Position			Vertical ± 5°							
Connection			1/8 NPT / G 1/8 ISO	1/4 NPT / G 1/4 ISO	3/8 NPT / G 3/8 ISO	3/8 NPT / G 3/8 ISO	1/2 NPT / G 1/2 ISO	3/4 NPT / G 3/4 ISO	3/4 NPT / G 3/4 ISO	1 NPT / G 1 ISO
Normal Flow*			4.41 scfm / 125 l/min	4.59 scfm / 130 l/min	4.94 scfm / 140 l/min	9.89 scfm / 280 l/min	10.59 scfm / 300 l/min	12.36 scfm / 350 l/min	19.42 scfm / 550 l/min	21.19 scfm / 600 l/min
Filter Pore Size	micron		1 and 0.01							
Residual Oil Concentration	[mg/m <sup>3</sup> ]		≤0.01							
Filter Efficiency	[%]		99.99							
Air Purity Class per ISO 8573-1	Particle		1							
	Oil Aerosol		2							
Condensate Capacity			13 cu in / 22 ml			26 cu in / 43 ml		49 cu in / 80 ml		
Primary Pressure Range	Manual Bowl Drain		232 psi / max. 16 bar							
	Automatic Bowl Drain**		22 to 180 psi / 1.5 to 12 bar							
Temperature Range	Medium		35 to 140°F / +1.5 to +60°C							
	Ambient		14 to 140°F / -10 to +60°C							
Material			Housing: GD-Zn; Seals: NBR; Filter bowl: Polycarbonate; Metal bowl guard: Al							
Weight			1.102 lb / 0.5 kg			2.866 lb / 1.3 kg		4.850 lb / 2.2 kg		5.291 lb / 2.4 kg

Delivery: Short lead time

\* At upstream pressure of 90 psi / 6 bar and Δ p = 1.05 psi / 0.07 bar.

\*\* A minimum flow of 4 scfm / 125 l/min is required for the proper result.



# Filter Combination, Type LFMBA

## Dimensions, INCH and Metric Series

Type LFMBA-...-D-...

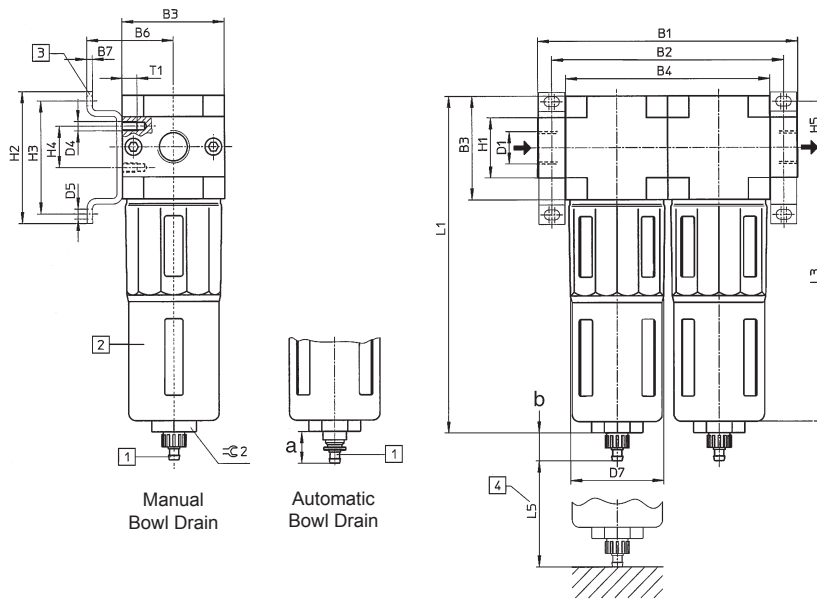

- 1 Drain connector for plastic tubing (Order number 7134 PCN-4)
- 2 Metal bowl guard
- 3 Mounting brackets Type HFOE (order separately)
- 4 Clearance required to remove bowl for servicing

### Dimensions

- a 0.59 in / 15 mm
- b 0.67 in / 17 mm

→ Flow direction

Type Inch and Metric Series	B1 in / mm	B2 in / mm	B3 in / mm	B6 in / mm	B7 in / mm	D1	D4	D5 dia in / mm	D7 dia in / mm
LFMBA-1/8-D-MINI(A)	4.09 / 104	3.62 / 92	1.57 / 40	1.54 / 39	0.08 / 2	1/8 NPT / G 1/8 ISO	M4	0.17 / 4.3	1.50 / 38
LFMBA-1/4-D-MINI(A)	4.09 / 104	3.62 / 92	1.57 / 40	1.54 / 39	0.08 / 2	1/4 NPT / G 1/4 ISO	M4	0.17 / 4.3	1.50 / 38
LFMBA-3/8-D-MINI(A)	5.51 / 140	4.92 / 125	1.57 / 40	1.54 / 39	0.12 / 3	3/8 NPT / G 3/8 ISO	M5	0.17 / 4.3	1.50 / 38
LFMBA-3/8-D-MIDI(A)	5.51 / 140	4.92 / 125	2.17 / 55	1.85 / 47	0.12 / 3	3/8 NPT / G 3/8 ISO	M5	0.21 / 5.3	2.05 / 52
LFMBA-1/2-D-MIDI(A)	5.51 / 140	4.92 / 125	2.17 / 55	1.85 / 47	0.12 / 3	1/2 NPT / G 1/2 ISO	M5	0.21 / 5.3	2.05 / 52
LFMBA-3/4-D-MIDI(A)	5.51 / 140	4.92 / 125	2.17 / 55	1.85 / 47	0.12 / 3	3/4 NPT / G 3/4 ISO	M5	0.21 / 5.3	2.05 / 52
LFMBA-3/4-D-MAXI(A)	6.38 / 162	5.75 / 146	2.60 / 66	2.09 / 53	0.12 / 3	3/4 NPT / G 3/4 ISO	M5	0.21 / 5.3	2.56 / 65
LFMBA-1-D-MAXI(A)	7.17 / 182	6.18 / 157	2.60 / 66	2.09 / 53	0.12 / 3	1 NPT / G 1 ISO	M5	0.21 / 5.3	2.56 / 65
Type Inch and Metric Series	H1 in / mm	H2 in / mm	H3 in / mm	H4 in / mm	H5 in / mm	L1 in / mm	L3 in / mm	T1 in / mm	∅ 2
LFMBA-1/8-D-MINI(A)	0.79 / 20	1.69 / 43	1.38 / 35	0.43 / 11	0.69 / 17.5	5.67 / 144	4.88 / 124	0.28 / 7	22
LFMBA-1/4-D-MINI(A)	0.79 / 20	1.69 / 43	1.38 / 35	0.43 / 11	0.69 / 17.5	5.67 / 144	4.88 / 124	0.28 / 7	22
LFMBA-3/8-D-MINI(A)	0.79 / 20	1.69 / 43	1.38 / 35	0.43 / 11	0.69 / 17.5	5.67 / 144	5.94 / 151	0.31 / 8	22
LFMBA-3/8-D-MIDI(A)	1.26 / 32	2.76 / 70	2.36 / 60	0.87 / 22	0.96 / 24.5	7.05 / 179	5.94 / 151	0.31 / 8	24
LFMBA-1/2-D-MIDI(A)	1.26 / 32	2.76 / 70	2.36 / 60	0.87 / 22	0.96 / 24.5	7.05 / 179	5.94 / 151	0.31 / 8	24
LFMBA-3/4-D-MIDI(A)	1.26 / 32	2.76 / 70	2.36 / 60	0.87 / 22	0.96 / 24.5	7.05 / 179	5.94 / 151	0.31 / 8	24
LFMBA-3/4-D-MAXI(A)	1.26 / 32	2.76 / 70	2.36 / 60	0.87 / 22	0.96 / 24.5	7.99 / 203	6.69 / 170	0.31 / 8	24
LFMBA-1-D-MAXI(A)	1.57 / 40	2.76 / 70	2.36 / 60	0.87 / 22	0.96 / 24.5	7.99 / 203	6.69 / 170	0.31 / 8	24

# Filter Combination, Type LFMBA

## Servicing Information

For economic considerations, the filter cartridge should be replaced when the pressure difference (pressure drop) of the filter is 6 psi / 0.41 bar. After disconnection of the compressed air supply, the filter bowl should be vented and removed, and the filter cartridge unscrewed from inside the filter housing.

### Pressure drop as a function of input pressure at different normal flow rates for Fine Combinations (1 micron and 0.01 micron)

Type LFMBA-1/8-D-MINI  
LFMBA-1/8-D-MINI-A

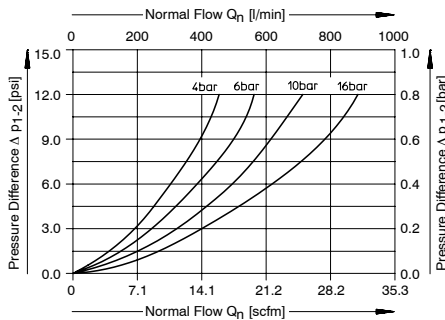

Type LFMBA-1/4-D-MINI  
LFMBA-1/4-D-MINI-A

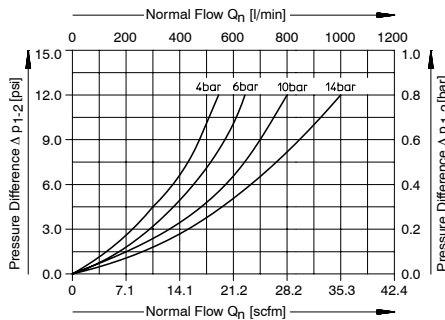

Type LFMBA-3/8-D-MINI  
LFMBA-3/8-D-MINI-A

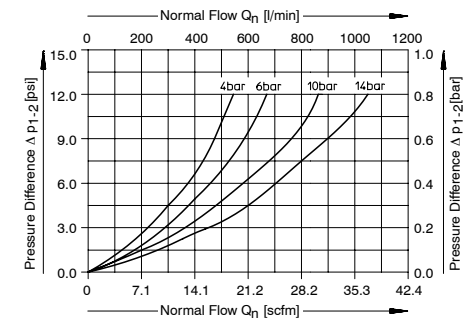

Type LFMBA-3/8-D-MIDI  
LFMBA-3/8-D-MIDI-A

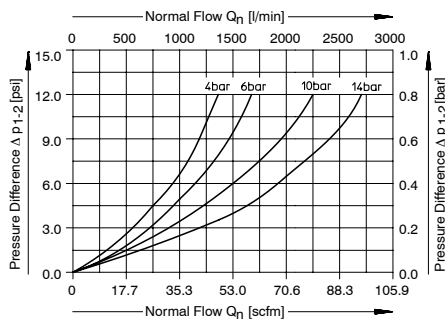

Type LFMBA-1/2-D-MIDI  
LFMBA-1/2-D-MIDI-A

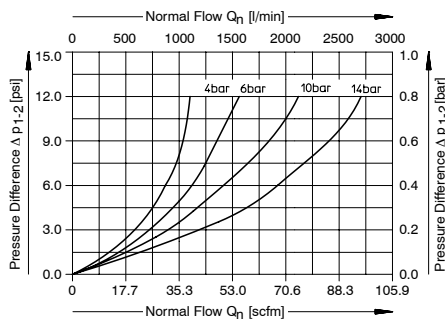

Type LFMBA-3/4-D-MIDI  
LFMBA-3/4-D-MIDI-A

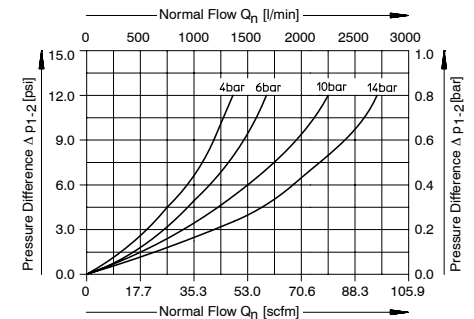

Type LFMBA-3/4-D-MAXI  
LFMBA-3/4-D-MAXI-A

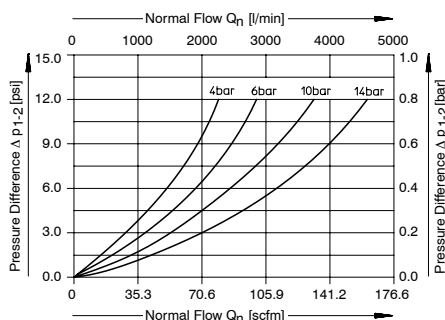

Type LFMBA-1-D-MAXI  
LFMBA-1-D-MAXI-A

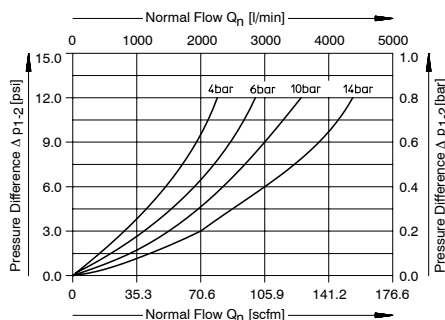

## Micro and Fine Filter Selector Guide

D-Series Service Units Port Sizes 1/8" to 3/8"

Ship From Stock

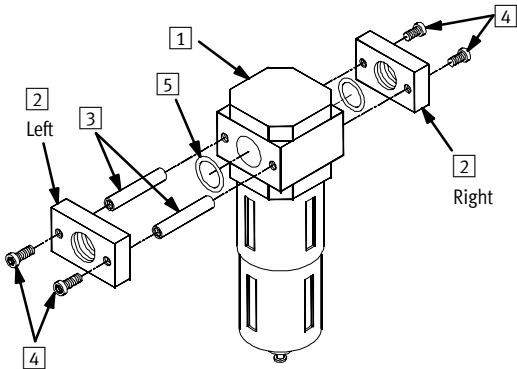

A complete filter assembly consists of the following items:

Item	Description	Qty Required per Assy
1	Main Unit	1
2	Port Block	2 [one left, one right]
3	Single Unit Joining Rod	2
4	Port Block Screw	4
5	Port Block Seal	2
6	Mounting Bracket Kit [Not shown]	1

**Step 1:** Based upon the required Port Size, Maximum Flow, Filtration Level, Drain Type, and Thread Type, select the Main Unit [Item 1] and the Left and Right Port Block [Item 2]. Note the Product Type/Description for the next step.

Port size	Max. Flow (l/min/sfcm)	Filtration Level (µm)	Drain	Item						Product Type/Description
				1	2					
				Main Unit	NPT Thread	BSP Thread				
					Left Connection Port Block	Right Connection Port Block	Left Connection Port Block	Right Connection Port Block		
1/8	130/4.6	0.01	Man.	126 036	372 030	372 038	380 285	380 287	LFMA-...-D-MINI-...	
			Auto	126 038					LFMB-...-D-MINI-...	
	250/8.8	1	Man.	126 037						
			Auto	126 039						
1/4	160/5.7	0.01	Man.	126 036	372 031	372 039	380 289	380 291	LFMA-...-D-MINI-...	
			Auto	126 038						
	380/13.4		Man.	126 040	-	-	380 902	380 903	LFMA-...-D-MIDI-...	
			Auto	126 043						
	300/10.6	1	Man.	126 037	372 031	372 039	380 289	380 291	LFMB-...-D-MINI-...	
			Auto	126 039						
	500/17.6		Man.	126 041	-	-	380 902	380 903	LFMB-...-D-MIDI-...	
			Auto	126 042						
3/8	180/6.4	0.01	Man.	126 036	372 032	372 040	380 293	380 295	LFMA-...-D-MINI-...	
			Auto	126 038						
	380/13.4		Man.	126 040	372 035	372 043	380 297	380 299	LFMA-...-D-MIDI-...	
			Auto	126 043						
	310/10.9	1	Man.	126 037	372 032	372 040	380 293	380 295	LFMB-...-D-MINI-...	
			Auto	126 039						
	500/17.6		Man.	126 041	372 035	372 043	380 297	380 299	LFMB-...-D-MIDI-...	
			Auto	126 042						

☐ Not available

Next...Step 2

# Micro and Fine Filter Selector Guide

D-Series Service Units Port Sizes 1/8" to 3/8"

Ship From Stock

**Step 2:** Based upon the Product Type/Description from Step 1, select the Joining Rods [Item 3], the Port Block Screws [Item 4], the Port Block Seals [Item 5], and the Mounting Bracket Kit [Item 6].

	Item [3]	[4]	[5]	[6] [Not shown]
Product Type/ Description	Single Unit Joining Rod	Port Block Screw	Port Block Seal	Mounting Bracket Kit
LFMA-...-D-MINI-...	359 787	200 664	235 260	159 638
LFMB-...-D-MINI-...				
LFMA-...-D-MIDI-...	369 989	202 824	200 950	159 593
LFMB-...-D-MIDI-...				

**Step3:** Determine the appropriate quantity of each Item.

**Ordering Example:**

Required: 1/4 port size, 250 l/min flow, 1 µm filtration, automatic drain, BSP threads.

	Item	Part No.	Qty	Description
Order:	[1]	126 039	1	Main Unit
	[2]	380 289	1	Left Port Block
		380 291	1	Right Port Block
	[3]	359 787	2	Single Unit Joining Rod
	[4]	200 664	4	Port Block Screws
	[5]	235 260	3	Port Block Seals
	[6]	159 638	1	Mounting Bracket Kit

**Note:** For combination units please see pages 76 - 79.

## Micro and Fine Filter Selector Guide

D-Series Service Units Port Sizes 1/2" to 1"

Ship From Stock

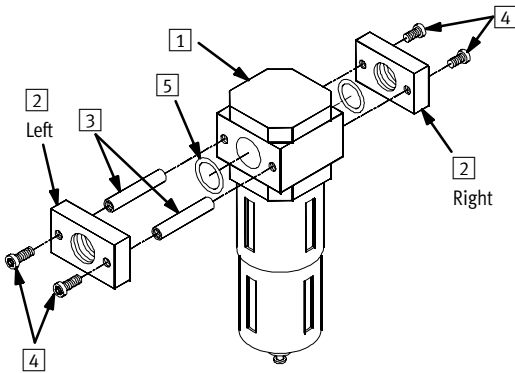

A complete filter assembly consists of the following items:

Item	Description	Qty Required per Assy
1	Main Unit	1
2	Port Block	2 [one left, one right]
3	Single Unit Joining Rod	2
4	Port Block Screw	4
5	Port Block Seal	2
6	Mounting Bracket Kit [Not shown]	1

**Step 1:** Based upon the required Port Size, Maximum Flow, Filtration Level, Drain Type, and Thread Type, select the Main Unit [Item 1] and the Left and Right Port Block [Item 2]. Note the Product Type/Description for the next step.

Port size	Max. Flow (l/min/sfcm)	Filtration Level [µm]	Drain	Item						Product Type/Description
				Main Unit	NPT Thread		BSP Thread			
					Left Connection Port Block	Right Connection Port Block	Left Connection Port Block	Right Connection Port Block		
1/2	400/14.1	0.01	Man.	126 040	372 033	372 041	380 301	380 303	LFMA-...-D-MIDI-...	
			Auto	126 043						
	750/24.5	1	Man.	126 044	-	-	381 529	381 530	LFMA-...-D-MAXI-...	
			Auto	126 046						
	900/31.8	1	Man.	126 041	372 033	372 041	380 301	380 303	LFMB-...-D-MIDI-...	
			Auto	126 042						
	1150/40.6	1	Man.	126 045	-	-	381 529	381530	LFMB-...-D-MAXI-...	
			Auto	126 047						
3/4	460/16.2	0.01	Man.	126 040	372 034	372 042	380 305	380 307	LFMA-...-D-MIDI-...	
			Auto	126 043						
	900/31.8	1	Man.	126 044	372 036	372 044	380 309	380 311	LFMA-...-D-MAXI-...	
			Auto	126 046						
	1000/35.3	1	Man.	126 041	372 034	372 042	380 305	380 307	LFMB-...-D-MIDI-...	
			Auto	126 042						
	1200/42.4	1	Man.	126 045	372 036	372 044	380 309	380 311	LFMB-...-D-MAXI-...	
			Auto	126 047						
1	460/16.2	0.01	Man.	126 044	372 037	372 045	380 313	380 315	LFMA-...-D-MAXI-...	
			Auto	126 046						
	1000/35.3	1	Man.	126 045					LFMB-...-D-MAXI-...	
			Auto	126 047						

☐ Not available

Next...Step 2

# Micro and Fine Filter Selector Guide

D-Series Service Units Port Sizes 1/2" to 1"

Ship From Stock

**Step 2:** Based upon the Product Type/Description from Step 1, select the Joining Rods [Item **3**], the Port Block Screws [Item **4**], the Port Block Seals [Item **5**], and the Mounting Bracket Kit [Item **6**].

	Item <b>3</b>	<b>4</b>	<b>5</b>	<b>6</b> [Not shown]
Product Type/Description	Single Unit Joining Rod	Port Block Screw	Port Block Seal	Mounting Bracket Kit
LFMA-...-D-MIDI-...	369 989	202 824	200 950	159 593
LFMB-...-D-MIDI-...				
LFMA-...-D-MAXI-...	373 059		234 380	
LFMB-...-D-MAXI-...				

**Step 3:** Determine the appropriate quantity of each Item.

**Ordering Example:**

Required: 3/4 port size, 950 l/min flow, 1 µm filtration, automatic drain, BSP threads.

	Item	Part No.	Qty	Description
Order:	<b>1</b>	126 042	1	Main Unit
	<b>2</b>	372 034	1	Left Port Block
		372 042	1	Right Port Block
	<b>3</b>	369 989	2	Single Unit Joining Rod
	<b>4</b>	200 824	4	Port Block Screws
	<b>5</b>	200 950	3	Port Block Seals
<b>6</b>	159 593	1	Mounting Bracket Kit	

**Note:** For combination units please see pages 76 - 79.

# Product Range and Company Overview

## A Complete Suite of Automation Services

Our experienced engineers provide complete support at every stage of your development process, including: conceptualization, analysis, engineering, design, assembly, documentation, validation, and production.



**Custom Automation Components**  
Complete custom engineered solutions



**Custom Control Cabinets**  
Comprehensive engineering support and on-site services



**Complete Systems**  
Shipment, stocking and storage services

## The Broadest Range of Automation Components

With a comprehensive line of more than 30,000 automation components, Festo is capable of solving the most complex automation requirements.



**Electromechanical**  
Electromechanical actuators, motors, controllers & drives



**Pneumatics**  
Pneumatic linear and rotary actuators, valves, and air supply



**PLCs and I/O Devices**  
PLC's, operator interfaces, sensors and I/O devices

## Supporting Advanced Automation... As No One Else Can!

Festo is a leading global manufacturer of pneumatic and electromechanical systems, components and controls for industrial automation, with more than 12,000 employees in 56 national headquarters serving more than 180 countries. For more than 80 years, Festo has continuously elevated the state of manufacturing with innovations and optimized motion control solutions that deliver higher performing, more profitable automated manufacturing and processing equipment. Our dedication to the advancement of automation extends beyond technology to the education and development of current and future automation and robotics designers with simulation tools, teaching programs, and on-site services.

## Quality Assurance, ISO 9001 and ISO 14001 Certifications

Festo Corporation is committed to supply all Festo products and services that will meet or exceed our customers' requirements in product quality, delivery, customer service and satisfaction.

To meet this commitment, we strive to ensure a consistent, integrated, and systematic approach to management that will meet or exceed the requirements of the ISO 9001 standard for Quality Management and the ISO 14001 standard for Environmental Management.



© Copyright 2008, Festo Corporation. While every effort is made to ensure that all dimensions and specifications are correct, Festo cannot guarantee that publications are completely free of any error, in particular typing or printing errors. Accordingly, Festo cannot be held responsible for the same. For Liability and Warranty conditions, refer to our "Terms and Conditions of Sale", available from your local Festo office. All rights reserved. No part of this publication may be reproduced, distributed, or transmitted in any form or by any means, electronic, mechanical, photocopying or otherwise, without the prior written permission of Festo. All technical data subject to change according to technical update.



Printed on recycled paper at New Horizon Graphic, Inc., FSC certified as an environmentally friendly printing plant.

# Festo North America

## United States

**Customer Resource Center**  
502 Earth City Expy., Suite 125  
Earth City, MO 63045

For ordering assistance, or to find  
your nearest Festo Distributor,

**Call:** 1.800.99.FESTO

**Fax:** 1.800.96.FESTO

**Email:** customer.service@us.festo.com

For technical support,

**Call:** 1.866.GO.FESTO

**Fax:** 1.800.96.FESTO

**Email:** product.support@us.festo.com

### Headquarters

Festo Corporation  
395 Moreland Road  
P.O. Box 18023  
Hauppauge, NY 11788  
[www.festo.com/us](http://www.festo.com/us)

---

### Sales Offices

#### Appleton

N. 922 Tower View Drive, Suite N  
Greenville, WI 54942

#### Boston

120 Presidential Way, Suite 330  
Woburn, MA 01801

#### Chicago

1441 East Business Center Drive  
Mt. Prospect, IL 60056

#### Dallas

1825 Lakeway Drive, Suite 600  
Lewisville, TX 75057

#### Detroit - Automotive Engineering Center

2601 Cambridge Court, Suite 320  
Auburn Hills, MI 48326

#### New York

395 Moreland Road  
Hauppauge, NY 11788

#### Silicon Valley

4935 Southfront Road, Suite F  
Livermore, CA 94550

## Design and Manufacturing Operations



**East:** 395 Moreland Road, Hauppauge, NY 11788



**Central:** 1441 East Business Center Drive, Mt. Prospect, IL 60056



**West:** 4935 Southfront Road, Suite F, Livermore, CA 94550

---

## Mexico

### Headquarters

Festo Pneumatic, S.A.  
Av. Ceylán 3, Col. Tequesquahuac  
54020 Tlalnepantla, Edo. de México  
**Call:** 011 52 [55] 53 21 66 00  
**Fax:** 011 52 [55] 53 21 66 65  
**Email:** festo.mexico@mx.festo.com  
[www.festo.com/mx](http://www.festo.com/mx)



---

## Canada

### Headquarters

Festo Inc.  
5300 Explorer Drive  
Mississauga, Ontario L4W 5G4  
**Call:** 1.905.624.9000  
**Fax:** 1.905.624.9001  
**Email:** info.ca@ca.festo.com  
[www.festo.com/ca](http://www.festo.com/ca)



---

## Festo Worldwide

Argentina Australia Austria Belarus Belgium Brazil Bulgaria Canada Chile China Colombia Croatia Czech Republic Denmark  
Estonia Finland France Germany Great Britain Greece Hong Kong Hungary India Indonesia Iran Ireland Israel Italy Japan  
Latvia Lithuania Malaysia Mexico Netherlands New Zealand Norway Peru Philippines Poland Romania Russia Serbia Singapore  
Slovakia Slovenia South Africa South Korea Spain Sweden Switzerland Taiwan Thailand Turkey Ukraine United States Venezuela

[www.festo.com](http://www.festo.com)