

Camera head SBPB

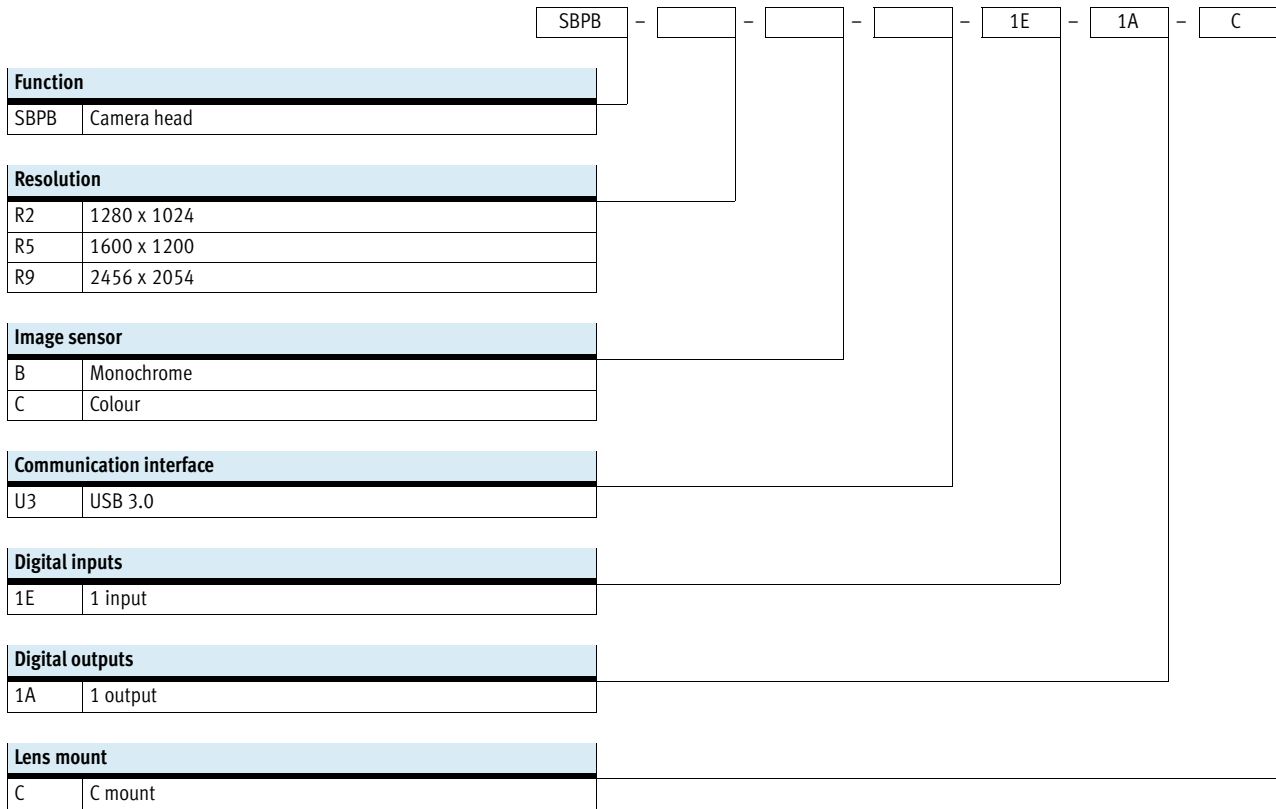



Camera head SBPB

Type codes



Camera head SBPB

Technical data

-  Voltage
5 V
-  Temperature range
0 ... +40 °C



General technical data		
Sensor resolution	-R2	1280 x 1024 pixels (SXGA)
	-R5	1600 x 1200 pixels (UXGA)
	-R9	2456 x 2054 pixels (5 megapixel)
Sensor type	-B	Monochrome
	-C	Colour
Lens mounting		C mount
Field of view	[mm]	Depends on the lens chosen
Width	[mm]	29
Height	[mm]	29
Length	[mm]	49
Type of mounting		Via through-hole for M3 screw
Product weight	[g]	52
CE marking (see declaration of conformity)		To EU EMC Directive

USB interface		
Function		Power supply
		Communication
Connection type		Socket
Connection technology		USB 3.0 type B micro
Number of poles/wires		10
Nominal operating voltage DC	[V]	5
Permissible voltage fluctuations	[%]	+/- 5
Electrical power consumption	-R2 [W]	1.3 ... 1.5
	-R5 [W]	1.3 ... 1.5
	-R9 [W]	2.3 ... 3

Input/output interface	
Function	No function

Immissions/emissions	
Degree of protection	IP30 in assembled state
Storage temperature	[°C] -20 ... +60
Ambient temperature	[°C] 0 ... +40

Electronics		
Working distance	[mm]	Depends on the lens chosen
Frame rate (full image)	[fps]	60
Exposure time	-R2	9 µs - 2000 ms
	-R5	20 µs - 10000 ms
	-R9	27 µs - 999 ms

Camera head SBPB

Technical data

Operating and environmental conditions	
Ambient conditions	Screened from extreme external light sources
	Cleanest possible ambient air
	Dry
Relative humidity	[%] 20 ... 80
Material of housing	Anodised wrought aluminium alloy
Note on materials	RoHS-compliant

Dimensions Download CAD data → www.festo.com

SBPB-R...-U3-1E1A-C

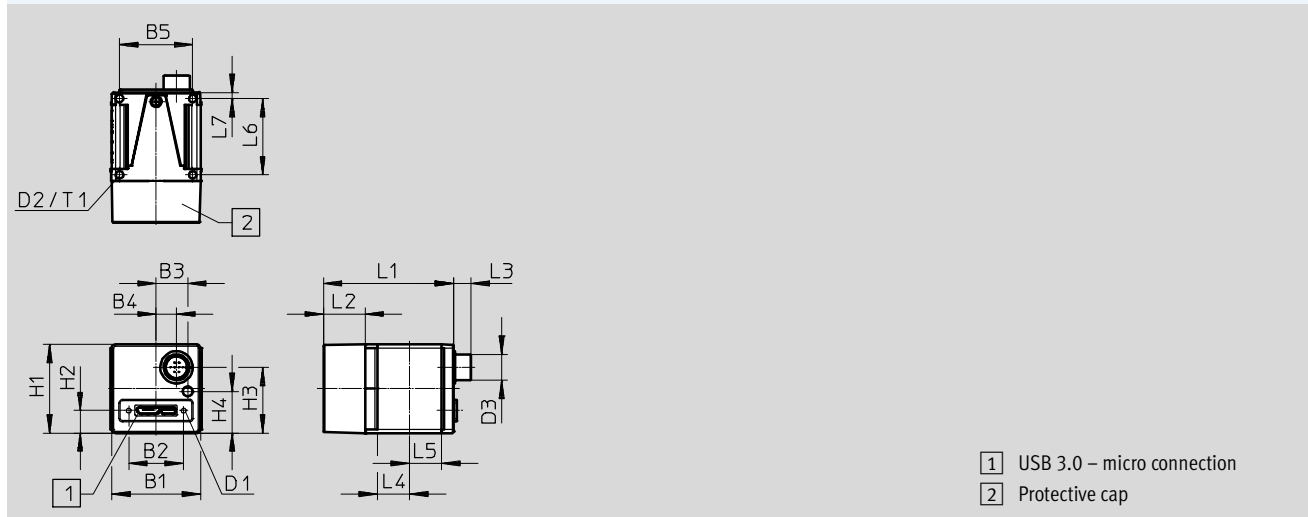

Type code	B1	B2	B3	B4	B5	D1	D2	D3	H1	H2
SBPB-R ... -U3-1E1A-C	45	30.5	14	31.9	13.1	M2x4	M3	8.5	29	7.3

Type code	H3	H4	L1	L2	L3	L4	L5	L6	L7	T1
SBPB-R ... -U3-1E1A-C	21.5	13.6	42.6	13.6	5.7	10.5	10.5	25	2	3.5

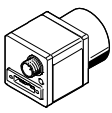
Ordering data				
Camera head	Sensor resolution	Exposure time	Part No.	Type code
	1280 x 1024 pixels (SXGA)	9 µs - 2000 ms	8066466	SBPB-R2B-U3-1E1A-C
			8066467	SBPB-R2C-U3-1E1A-C
	1600 x 1200 pixels (UXGA)	20 µs - 10000 ms	8066468	SBPB-R5B-U3-1E1A-C
			8066469	SBPB-R5C-U3-1E1A-C
	2456 x 2054 pixels (5 megapixel)	27 µs - 999 ms	8066470	SBPB-R9B-U3-1E1A-C
			8066471	SBPB-R9C-U3-1E1A-C

Camera head SBPB

Accessories

Mounting SBAM-C11-CP

Type of mounting: Clamped with thread

Material: Anodised wrought aluminium alloy

Note on materials:
RoHS-compliant

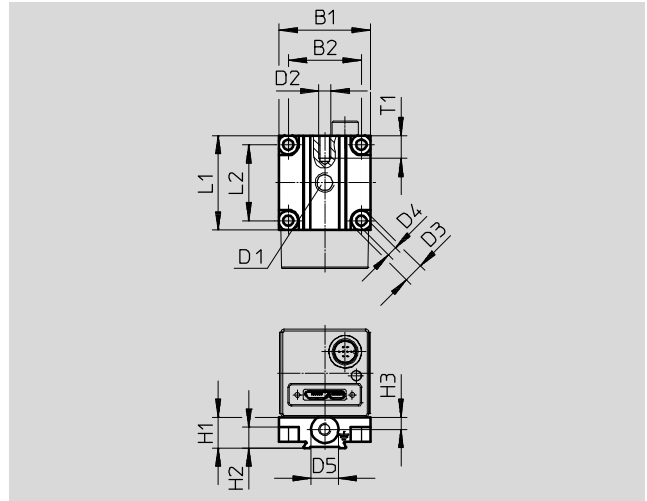
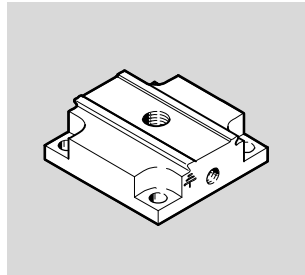

Type code	B1	B2	D1	D2	D3	D4	D5	H1	H2	H3	L1	L2	T1
SBAM-C11-CP	30	24	1/4-20 UNC	M4	6.5	3.4	9	10.2	6.9	4	31	25	7.5

Ordering data			
Mounting	Weight [g]	Part No.	Type code
	19	8066474	SBAM-C11-CP