

- 2 - Type discontinued
Available up until 2015

FESTO

Electrical connection technology, for multi-pin plug connection

Technical data – KMP1-...

- Plug socket with cable for multi-pin connection (to valve terminal type 02)
- Pre-assembled
- Cable lengths of 5 m, 10 m or by customer request
- 25-pin, 40-pin or 72-pin socket
- Not suitable for chain link trunking





General technical data		
Type	KMP1-...	
Type of mounting	Clamping strap	
Mounting position	Any	
Operating voltage range	[V]	300 AC
	[V]	250 DC
Current-carrying capacity	[A]	4
Protection class to EN 60 529		IP65 (assembled)
Material of housing		Die-cast light metal alloy
Material of contacts		Silver-plated copper base alloy
Material of cable sheath		Polyethylene
Ambient temperature	[°C]	-30 ... +70
Ambient temperature of flexible cable installation	[°C]	+5 ... +70

- 7 - Type discontinued
Available up until 2015

Electrical connection technology, for multi-pin plug connection

FESTO

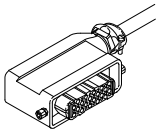
Technical data – KMP1-...

Ordering data								
	Electrical connection	Cable composition [mm ²]	Cable diameter [mm]	Product weight		Cable length [m]	Type	Part No.
				Cable [g/m]	Total [g]			
	25-pin plug socket	25x0.75	13		1,933	5	KMP1-02-II-4-5	175 654
	25-pin plug socket	25x0.75	13		3,676	10	KMP1-02-II-4-10	175 655
	25-pin plug socket	25x0.75	13	Approx. 370	Acc. to length	Any	KMP1-02-II-4-X	158 988
	40-pin plug socket	39x0.75	17		2,995	5	KMP1-02-II-8-5	175 656
	40-pin plug socket	39x0.75	17		5,672	10	KMP1-02-II-8-10	175 657
	40-pin plug socket	39x0.75	17	Approx. 570	Acc. to length	Any	KMP1-02-II-8-X	158 989
	72-pin plug socket	50x0.75	19		3,908	5	KMP1-02-II-10-5	175 658
	72-pin plug socket	50x0.75	19		7,300	10	KMP1-02-II-10-10	175 659
	72-pin plug socket	50x0.75	19	Approx. 700	Acc. to length	Any	KMP1-02-II-10-X	158 990
	72-pin plug socket	65x0.75	22		6,000	5	KMP1-02-II-14-5	175 660
	72-pin plug socket	65x0.75	22		11,300	10	KMP1-02-II-14-10	175 661
	72-pin plug socket	65x0.75	22	Approx. 930	Acc. to length	Any	KMP1-02-II-14-X	158 991
	72-pin plug socket	80x0.75	24		5,326	5	KMP1-02-II-16-5	175 662
	72-pin plug socket	80x0.75	24		10,650	10	KMP1-02-II-16-10	175 663
	72-pin plug socket	80x0.75	24	Approx. 1160	Acc. to length	Any	KMP1-02-II-16-X	158 992
	25-pin plug socket	13x0.75	10		1,200	5	KMP1-02-VI-6-5	175 585
	25-pin plug socket	13x0.75	10		2,188	10	KMP1-02-VI-6-10	175 586
	25-pin plug socket	13x0.75	10	Approx. 180	Acc. to length	Any	KMP1-02-VI-6-X	158 984
	25-pin plug socket	25x0.75	13		1,967	5	KMP1-02-VI-12-5	175 587
	25-pin plug socket	25x0.75	13		3,667	10	KMP1-02-VI-12-10	175 588
	40-pin plug socket	39x0.75	17		3,016	5	KMP1-02-VI-16-5	175 589
	40-pin plug socket	39x0.75	17		5,800	10	KMP1-02-VI-16-10	175 590
	40-pin plug socket	39x0.75	17	Approx. 570	Acc. to length	Any	KMP1-02-VI-16-X	158 987

- 2 - Type discontinued
Available up until 2015

Electrical connection technology, for multi-pin plug connection

FESTO

Technical data – KMP1-...

Dimensions

Download CAD data → www.festo.com

KMP1-...

Cable assembled

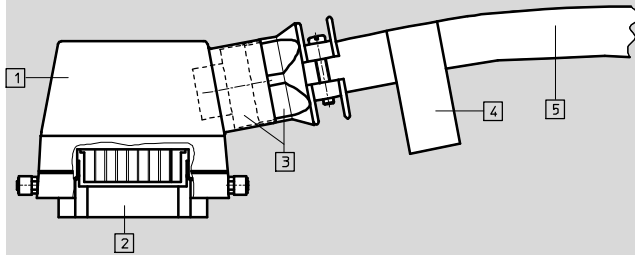

- 1 Housing
- 2 Socket insert with protective earth connection
- 3 Cable gland fitting with sealing set
- 4 Label with part number, type and cable length
- 5 Cable

Housing

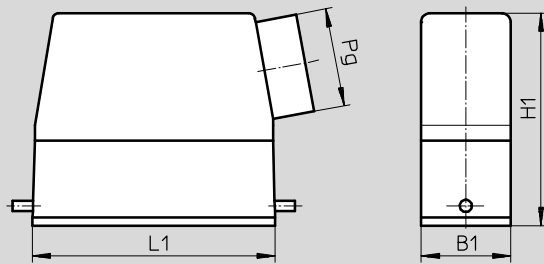

	25-pin	40-pin	72-pin
L1	79.5 mm	93.5 mm	93.5 mm
B1	29.5 mm	43 mm	43 mm
H1	54.5 mm	60 mm	76 mm
Pg	16	21	29

Socket insert, 72-pin

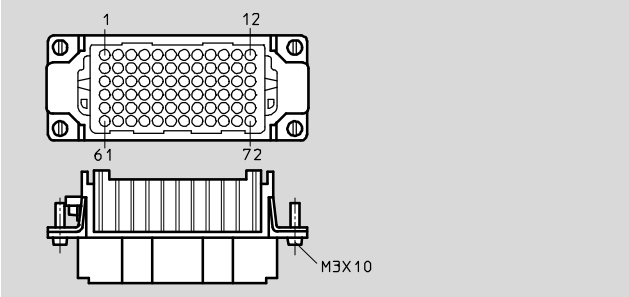

Socket insert, 40-pin

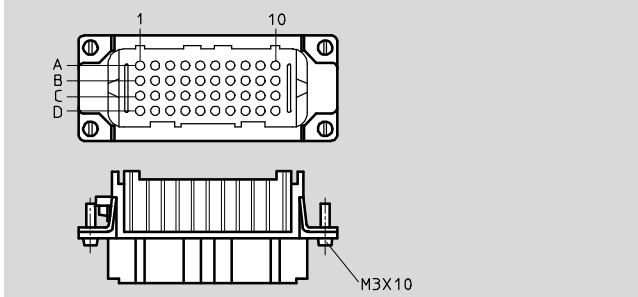

Socket insert, 25-pin

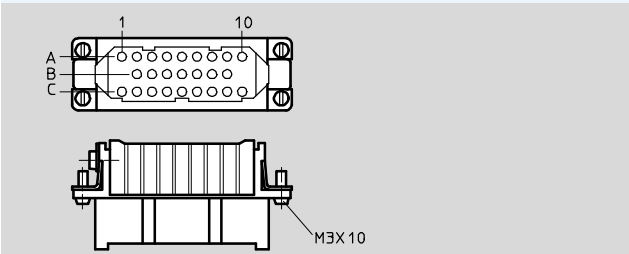

- 7 - Type discontinued
Available up until 2015

Electrical connection technology, for multi-pin plug connection

FESTO

Technical data – KMP1-...

Wiring allocation (socket view)						
KMP1-02-II-4-...						
	Pin Row A	Wire number	Pin Row B	Wire number	Pin Row C	Wire number
	1	4			1	20
	2	5	2	13	2	21
	3	6	3	14	3	22
	4	7	4	15	4	23
	5	8	5	16	5	24
	6	9	6	17	6	25
	7	10	7	18	7	1
	8	11	8	19	8	2
9	12			9	3	
KMP1-02-VI-6-...						
	Pin Row A	Wire number	Pin Row B	Wire number	Pin Row C	Wire number
	1	2			1	-
	2	3	2	11	2	-
	3	4	3	12	3	-
	4	5	4	13	4	-
	5	6	5	-	5	-
	6	7	6	-	6	-
	7	8	7	-	7	-
	8	9	8	-	8	-
9	10			9	1	
KMP1-02-VI-12-...						
	Pin Row A	Wire number	Pin Row B	Wire number	Pin Row C	Wire number
	1	2			1	18
	2	3			2	19
	3	4			3	20
	4	5			4	21
	5	6			5	22
	6	7			6	23
	7	8			7	24
	8	9			8	25
9	10			9	1	

- 2 - Type discontinued
Available up until 2015

Electrical connection technology, for multi-pin plug connection

FESTO

Technical data – KMP1-...

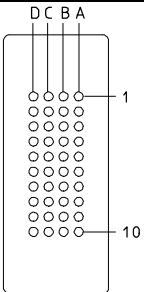
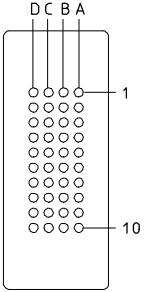
Wiring allocation (socket view)								
KMP1-02-II-8-...								
	Pin Row A	Wire number	Pin Row B	Wire number	Pin Row C	Wire number	Pin Row D	Wire number
	1	4	1	14	1	22	1	32
	2	5	2	15	2	23	2	33
	3	6	3	16	3	24	3	34
	4	7	4	17	4	25	4	35
	5	8	5	18	5	26	5	36
	6	9	6	19	6	27	6	37
	7	10	7	20	7	28	7	38
	8	11	8	21	8	29	8	39
	9	12	9	-	9	30	9	2
	10	13	10	1	10	31	10	3
KMP1-02-VI-16-...								
	Pin Row A	Wire number	Pin Row B	Wire number	Pin Row C	Wire number	Pin Row D	Wire number
	1	3	1	13	1	23	1	33
	2	4	2	14	2	24	2	34
	3	5	3	15	3	25	3	35
	4	6	4	16	4	26	4	36
	5	7	5	17	5	27	5	37
	6	8	6	18	6	28	6	38
	7	9	7	19	7	29	7	39
	8	10	8	20	8	30	8	-
	9	11	9	21	9	31	9	1
	10	12	10	22	10	32	10	2

- 1 - Type discontinued
Available up until 2015

Electrical connection technology, for multi-pin plug connection

FESTO

Technical data – KMP1-...

Wiring allocation (socket view)												
KMP1-02-II-10-...												
	Pin	Wire number	Pin	Wire number	Pin	Wire number	Pin	Wire number	Pin	Wire number	Pin	Wire number
	1	4	13	16	25	-	37	26	49	38	61	50
	2	5	14	17	26	-	38	27	50	39	62	-
	3	6	15	18	27	-	39	28	51	40	63	-
	4	7	16	19	28	-	40	29	52	41	64	-
	5	8	17	20	29	-	41	30	53	42	65	-
	6	9	18	21	30	-	42	31	54	43	66	-
	7	10	19	22	31	-	43	32	55	44	67	-
	8	11	20	23	32	-	44	33	56	45	68	-
	9	12	21	24	33	-	45	34	57	46	69	-
	10	13	22	25	34	-	46	35	58	47	70	-
	11	14	23	-	35	-	47	36	59	48	71	2
	12	15	24	-	36	1	48	37	60	49	72	3
KMP1-02-II-14-...												
	Pin	Wire number	Pin	Wire number	Pin	Wire number	Pin	Wire number	Pin	Wire number	Pin	Wire number
	1	4	13	16	25	28	37	34	49	46	61	58
	2	5	14	17	26	29	38	35	50	47	62	59
	3	6	15	18	27	30	39	36	51	48	63	60
	4	7	16	19	28	31	40	37	52	49	64	61
	5	8	17	20	29	32	41	38	53	50	65	62
	6	9	18	21	30	33	42	39	54	51	66	63
	7	10	19	22	31	-	43	40	55	52	67	64
	8	11	20	23	32	-	44	41	56	53	68	65
	9	12	21	24	33	-	45	42	57	54	69	-
	10	13	22	25	34	-	46	43	58	55	70	-
	11	14	23	26	35	-	47	44	59	56	71	2
	12	15	24	27	36	1	48	45	60	57	72	3
KMP1-02-II-16-...												
	Pin	Wire number	Pin	Wire number	Pin	Wire number	Pin	Wire number	Pin	Wire number	Pin	Wire number
	1	4	13	16	25	28	37	38	49	50	61	62
	2	5	14	17	26	29	38	39	50	51	62	63
	3	6	15	18	27	30	39	40	51	52	63	64
	4	7	16	19	28	31	40	41	52	53	64	65
	5	8	17	20	29	32	41	42	53	54	65	66
	6	9	18	21	30	33	42	43	54	55	66	67
	7	10	19	22	31	34	43	44	55	56	67	68
	8	11	20	23	32	35	44	45	56	57	68	69
	9	12	21	24	33	36	45	46	57	58	69	70
	10	13	22	25	34	37	46	47	58	59	70	71
	11	14	23	26	35	72	47	48	59	60	71	2
	12	15	24	27	36	1	48	49	60	61	72	3