

Plug connectors NECV for valves, for self-assembly

Technical data

Multi-pin plug socket IMP1-SD

- Plug socket for multi-pin plug connection
- Can be assembled with any cable lengths
- 25-pin, 40-pin or 72-pin socket
- Wire cross section 0.75 and 1.5 mm² can be used



General technical data			
Type	IMP1-SD-25...	IMP1-SD-40...	IMP1-SD-72...
Electrical connection	25-pin socket	40-pin socket	72-pin socket
Type of mounting	Via clamp strap		
Mounting position	Any		
Operating voltage range	[V AC]	Max. 300	
	[V DC]	Max. 250	
Acceptable current load	[A]	10	
Protection class to EN 60529	IP65 (assembled)		

Materials	
Type	IMP1-SD-...
Housing	Plastic, die-cast light metal
Pin contact	Silver-plated copper alloy

Operating and environmental conditions		
Ambient temperature	[°C]	-40 ... +125

- 7 - Type discontinued
Available up until 2012

Plug connectors NECV for valves, for self-assembly

Technical data

FESTO

Dimensions

Download CAD data → www.festo.com

IMP1-...

Cable assembled

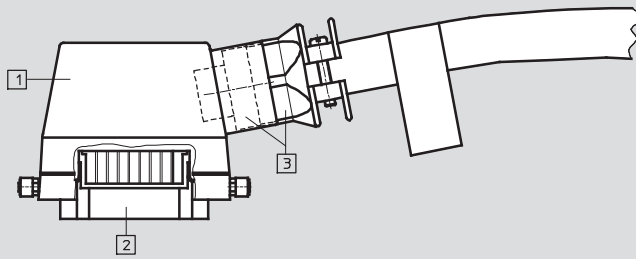

- 1 Housing
- 2 Socket insert with protective earth connection
- 3 Protective cable fitting with sealing set

Housing

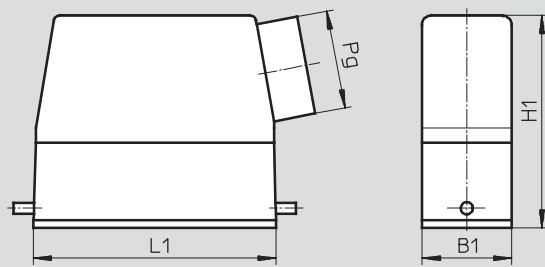

	25-pin	25-pin	40-pin	72-pin
L1	79.5 mm	79.5 mm	93.5 mm	93.5 mm
B1	29.5 mm	36 mm	43 mm	43 mm
H1	54.5 mm	70.5 mm	60 mm	76 mm
Pg	16	21	21	29

72-pin socket insert

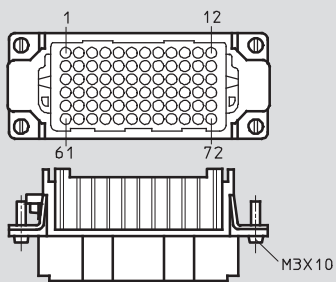

40-pin socket insert

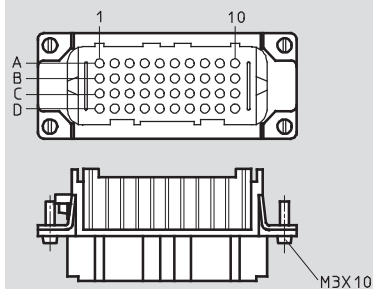

25-pin socket insert

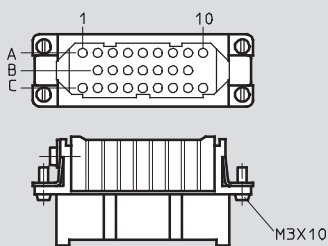

- 1 - Type discontinued
Available up until 2012

Plug connectors NECV for valves, for self-assembly

FESTO

Technical data

Ordering data						
Electrical connection	Protective cable fitting	Perm. cable Ø [mm]	Max. wire cross section [mm ²]	Product weight [g]	Part No.	Type
25-pin socket	Pg21	11 ... 21	1.5	315	18317	IMP1-SD-25
25-pin socket	Pg16	7.5 ... 15	0.75	210	18321	IMP1-SD-25-0,75
40-pin socket	Pg29	18 ... 27	1.5	395	18318	IMP1-SD-40
40-pin socket	Pg21	10 ... 19	0.75	325	18322	IMP1-SD-40-0,75
72-pin socket	Pg29	18 ... 27	1.5	401	18319	IMP1-SD-72
72-pin socket	SW50	22 ... 32	1.75	550	18320	IMP1-SD-72-36